

Location: COLORADO
Field: WELD COUNTY (KERR MCGEE)
Facility: SEC.08-T3N-R67W

Slot: SLOT#30 HOUSTON 12C-8HZ
Well: HOUSTON 12C-8HZ
Wellbore: HOUSTON 12C-8HZ PWB

True vertical depths are referenced to Rig on SLOT#10 HOUSTON 12C-8HZ (RKB)	Grid System: NAD83 / Lambert Colorado SP, Northern Zone (501), US feet
Measured depths are referenced to Rig on SLOT#10 HOUSTON 12C-8HZ (RKB)	North Reference: True north
Rig on SLOT#10 HOUSTON 12C-8HZ (RKB) to Mean Sea Level: 4824 feet	Scale: True distance
Mean Sea Level to Mud line (At Slot: SLOT#30 HOUSTON 12C-8HZ): 0 feet	Depths are in feet
Coordinates are in feet referenced to Slot	Created by: inqjamm on 7/3/2014

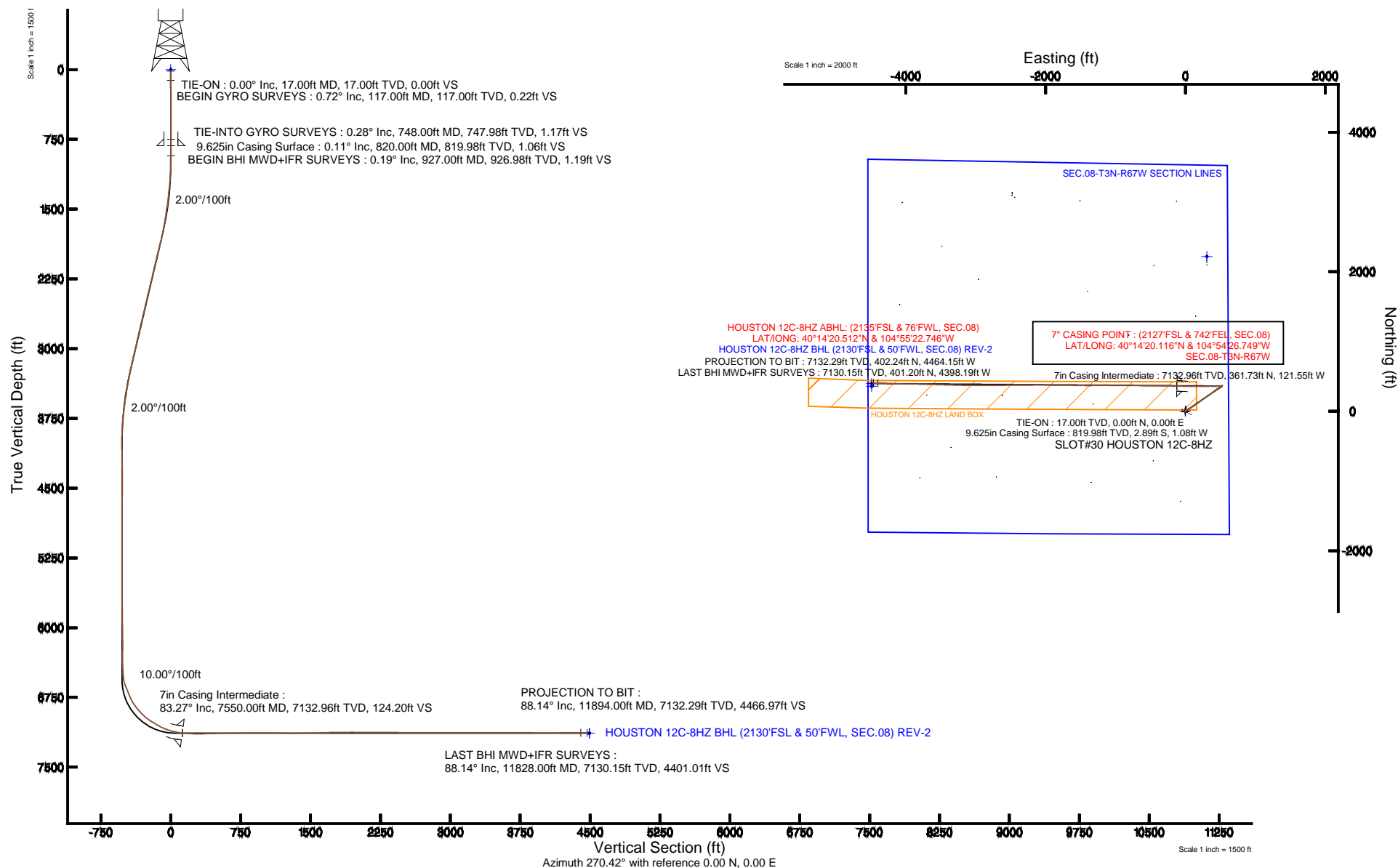

Actual Wellpath Report

HOUSTON 12C-8HZ AWP

Page 1 of 8

REFERENCE WELLPATH IDENTIFICATION

Operator	KERR-MCGEE OIL & GAS ONSHORE LP	Slot	SLOT#30 HOUSTON 12C-8HZ
Area	COLORADO	Well	HOUSTON 12C-8HZ
Field	WELD COUNTY (KERR MCGEE)	Wellbore	HOUSTON 12C-8HZ AWB
Facility	SEC.08-T3N-R67W		

REPORT SETUP INFORMATION

Projection System	NAD83 / Lambert Colorado SP, Northern Zone (501), US feet	Software System	WellArchitect® 4.0.0
North Reference	True	User	Ingmjmr
Scale	0.999957	Report Generated	7/3/2014 at 10:09:40 AM
Convergence at slot	n/a	Database/Source file	Anadarko Map Checks/HOUSTON_12C-8HZ_AWB.xml

WELLPATH LOCATION

	Local coordinates		Grid coordinates		Geographic coordinates	
	North[ft]	East[ft]	Easting[US ft]	Northing[US ft]	Latitude	Longitude
Slot Location	-2218.60	-307.03	3165551.63	1330072.61	40°14'16.541"N	104°54'25.182"W
Facility Reference Pt			3165843.78	1332293.12	40°14'38.465"N	104°54'21.223"W
Field Reference Pt			3197771.84	1268891.29	40°04'09.600"N	104°47'36.000"W

WELLPATH DATUM

Calculation method	Minimum curvature	Rig on SLOT#10 HOUSTON 12C-8HZ (RKB) to Facility Vertical Datum	4824.00ft
Horizontal Reference Pt	Slot	Rig on SLOT#10 HOUSTON 12C-8HZ (RKB) to Mean Sea Level	4824.00ft
Vertical Reference Pt	Rig on SLOT#10 HOUSTON 12C-8HZ (RKB)	Rig on SLOT#10 HOUSTON 12C-8HZ (RKB) to Mud Line at Slot (SLOT#30 HOUSTON 12C-8HZ)	4824.00ft
MD Reference Pt	Rig on SLOT#10 HOUSTON 12C-8HZ (RKB)	Section Origin	N 0.00, E 0.00 ft
Field Vertical Reference	Mean Sea Level	Section Azimuth	275.15°

REFERENCE WELLPATH IDENTIFICATION

Operator	KERR-MCGEE OIL & GAS ONSHORE LP	Slot	SLOT#30 HOUSTON 12C-8HZ
Area	COLORADO	Well	HOUSTON 12C-8HZ
Field	WELD COUNTY (KERR MCGEE)	Wellbore	HOUSTON 12C-8HZ AWB
Facility	SEC.08-T3N-R67W		

WELLPATH DATA (139 stations) † = interpolated/extrapolated station

MD [ft]	Inclination [°]	Azimuth [°]	TVD [ft]	Vert Sect [ft]	North [ft]	East [ft]	Latitude	Longitude	DLS [°/100ft]	Comments
0.00†	0.000	200.670	0.00	0.00	0.00	0.00	40°14'16.541"N	104°54'25.182"W	0.00	
17.00	0.000	200.670	17.00	0.00	0.00	0.00	40°14'16.541"N	104°54'25.182"W	0.00	TIE-ON
117.00	0.720	200.670	117.00	0.17	-0.59	-0.22	40°14'16.535"N	104°54'25.185"W	0.72	BEGIN GYRO SURVEYS
217.00	0.400	315.570	216.99	0.60	-0.93	-0.69	40°14'16.532"N	104°54'25.191"W	0.96	
317.00	0.630	186.250	316.99	0.88	-1.22	-0.99	40°14'16.529"N	104°54'25.195"W	0.94	
417.00	0.250	10.330	416.99	0.87	-1.56	-1.01	40°14'16.526"N	104°54'25.195"W	0.88	
517.00	0.820	226.570	516.99	1.32	-1.83	-1.49	40°14'16.523"N	104°54'25.201"W	1.03	
617.00	0.600	160.080	616.98	1.57	-2.82	-1.83	40°14'16.513"N	104°54'25.206"W	0.80	
717.00	0.390	71.140	716.98	1.04	-3.20	-1.33	40°14'16.509"N	104°54'25.199"W	0.71	
748.00	0.280	33.810	747.98	0.91	-3.10	-1.19	40°14'16.510"N	104°54'25.197"W	0.77	TIE-INTO GYRO SURVEYS
927.00	0.190	241.320	926.98	0.95	-2.88	-1.21	40°14'16.513"N	104°54'25.198"W	0.26	BEGIN BHI MWD+IFR SURVEYS
1019.00	2.080	38.240	1018.96	0.16	-1.64	-0.31	40°14'16.525"N	104°54'25.186"W	2.45	
1110.00	4.120	45.510	1109.82	-2.86	1.95	3.04	40°14'16.560"N	104°54'25.143"W	2.28	
1201.00	5.690	50.670	1200.49	-8.19	7.10	8.87	40°14'16.611"N	104°54'25.068"W	1.79	
1293.00	7.280	57.090	1291.90	-16.04	13.15	17.29	40°14'16.671"N	104°54'24.959"W	1.90	
1384.00	8.280	55.210	1382.06	-25.60	20.03	27.51	40°14'16.739"N	104°54'24.827"W	1.13	
1476.00	9.280	57.530	1472.98	-36.56	27.79	39.21	40°14'16.816"N	104°54'24.676"W	1.15	
1600.00	10.390	59.920	1595.15	-53.61	38.76	57.32	40°14'16.924"N	104°54'24.443"W	0.95	
1691.00	12.420	58.670	1684.35	-68.18	47.96	72.78	40°14'17.015"N	104°54'24.244"W	2.25	
1782.00	13.870	57.610	1772.97	-84.70	58.89	90.35	40°14'17.123"N	104°54'24.017"W	1.62	
1874.00	16.350	58.030	1861.78	-103.78	71.66	110.65	40°14'17.249"N	104°54'23.755"W	2.70	
1966.00	17.130	56.570	1949.88	-124.69	85.98	132.95	40°14'17.391"N	104°54'23.468"W	0.96	
2057.00	16.540	55.100	2036.98	-145.09	100.77	154.75	40°14'17.537"N	104°54'23.187"W	0.80	
2149.00	16.540	52.240	2125.17	-164.70	116.29	175.85	40°14'17.690"N	104°54'22.915"W	0.88	
2240.00	15.950	54.040	2212.54	-183.61	131.56	196.21	40°14'17.841"N	104°54'22.652"W	0.85	
2332.00	16.310	55.380	2300.92	-203.07	146.32	217.07	40°14'17.987"N	104°54'22.383"W	0.56	
2424.00	16.350	54.750	2389.21	-222.86	161.14	238.28	40°14'18.133"N	104°54'22.110"W	0.20	
2515.00	16.190	53.730	2476.56	-242.12	176.03	258.97	40°14'18.281"N	104°54'21.843"W	0.36	
2607.00	16.740	54.930	2564.79	-261.86	191.23	280.15	40°14'18.431"N	104°54'21.570"W	0.70	
2698.00	15.980	54.850	2652.11	-281.42	205.98	301.12	40°14'18.576"N	104°54'21.299"W	0.84	

REFERENCE WELLPATH IDENTIFICATION

Operator	KERR-MCGEE OIL & GAS ONSHORE LP	Slot	SLOT#30 HOUSTON 12C-8HZ
Area	COLORADO	Well	HOUSTON 12C-8HZ
Field	WELD COUNTY (KERR MCGEE)	Wellbore	HOUSTON 12C-8HZ AWP
Facility	SEC.08-T3N-R67W		

WELLPATH DATA (139 stations)

MD [ft]	Inclination [°]	Azimuth [°]	TVD [ft]	Vert Sect [ft]	North [ft]	East [ft]	Latitude	Longitude	DLS [°/100ft]	Comments
2790.00	16.160	55.580	2740.51	-300.95	220.50	322.04	40°14'18.720"N	104°54'21.029"W	0.29	
2882.00	15.340	54.510	2829.06	-320.05	234.81	342.51	40°14'18.861"N	104°54'20.766"W	0.95	
2973.00	15.790	55.490	2916.72	-338.72	248.81	362.51	40°14'19.000"N	104°54'20.508"W	0.57	
3064.00	16.090	53.530	3004.22	-357.68	263.32	382.85	40°14'19.143"N	104°54'20.245"W	0.68	
3155.00	16.500	52.900	3091.57	-376.67	278.61	403.30	40°14'19.294"N	104°54'19.982"W	0.49	
3247.00	15.430	51.580	3180.02	-395.21	294.10	423.31	40°14'19.447"N	104°54'19.724"W	1.23	
3339.00	13.790	55.240	3269.04	-412.49	307.95	441.91	40°14'19.584"N	104°54'19.484"W	2.04	
3424.00	12.720	53.930	3351.77	-427.30	319.24	457.79	40°14'19.696"N	104°54'19.279"W	1.31	
3510.00	11.290	58.280	3435.89	-441.16	329.24	472.61	40°14'19.794"N	104°54'19.088"W	1.97	
3596.00	10.590	55.450	3520.33	-453.97	338.15	486.28	40°14'19.883"N	104°54'18.912"W	1.03	
3681.00	9.270	53.090	3604.06	-465.06	346.69	498.19	40°14'19.967"N	104°54'18.758"W	1.62	
3766.00	7.940	58.020	3688.10	-474.83	353.91	508.64	40°14'20.038"N	104°54'18.623"W	1.79	
3851.00	5.800	53.220	3772.48	-482.71	359.59	517.06	40°14'20.094"N	104°54'18.515"W	2.60	
3936.00	3.790	63.010	3857.18	-488.28	363.44	523.01	40°14'20.132"N	104°54'18.438"W	2.54	
4021.00	1.270	61.700	3942.09	-491.45	365.16	526.34	40°14'20.149"N	104°54'18.395"W	2.97	
4107.00	0.770	323.570	4028.08	-491.86	366.08	526.84	40°14'20.159"N	104°54'18.389"W	1.83	
4192.00	0.650	298.270	4113.08	-491.04	366.77	526.07	40°14'20.165"N	104°54'18.398"W	0.39	
4279.00	0.850	285.340	4200.07	-489.95	367.17	525.01	40°14'20.169"N	104°54'18.412"W	0.30	
4365.00	1.140	280.740	4286.06	-488.47	367.50	523.56	40°14'20.173"N	104°54'18.431"W	0.35	
4450.00	0.150	330.840	4371.05	-487.56	367.75	522.67	40°14'20.175"N	104°54'18.442"W	1.24	
4535.00	0.350	98.590	4456.05	-487.76	367.81	522.88	40°14'20.176"N	104°54'18.440"W	0.54	
4620.00	0.500	97.210	4541.05	-488.39	367.73	523.50	40°14'20.175"N	104°54'18.432"W	0.18	
4706.00	0.380	108.370	4627.05	-489.04	367.59	524.14	40°14'20.173"N	104°54'18.423"W	0.17	
4876.00	0.340	76.810	4797.04	-490.07	367.53	525.17	40°14'20.173"N	104°54'18.410"W	0.12	
5046.00	0.280	55.650	4967.04	-490.87	367.88	526.00	40°14'20.176"N	104°54'18.399"W	0.08	
5132.00	0.680	190.830	5053.04	-490.98	367.49	526.08	40°14'20.172"N	104°54'18.398"W	1.05	
5217.00	0.830	173.130	5138.03	-491.06	366.39	526.06	40°14'20.162"N	104°54'18.399"W	0.32	
5302.00	0.820	188.610	5223.02	-491.15	365.18	526.04	40°14'20.150"N	104°54'18.399"W	0.26	
5387.00	0.800	180.240	5308.01	-491.16	363.98	525.95	40°14'20.138"N	104°54'18.400"W	0.14	
5558.00	0.650	194.720	5479.00	-491.10	361.85	525.70	40°14'20.117"N	104°54'18.403"W	0.14	

REFERENCE WELLPATH IDENTIFICATION

Operator	KERR-MCGEE OIL & GAS ONSHORE LP	Slot	SLOT#30 HOUSTON 12C-8HZ
Area	COLORADO	Well	HOUSTON 12C-8HZ
Field	WELD COUNTY (KERR MCGEE)	Wellbore	HOUSTON 12C-8HZ AWP
Facility	SEC.08-T3N-R67W		

WELLPATH DATA (139 stations) † = interpolated/extrapolated station

MD [ft]	Inclination [°]	Azimuth [°]	TVD [ft]	Vert Sect [ft]	North [ft]	East [ft]	Latitude	Longitude	DLS [°/100ft]	Comments
5728.00	0.470	233.520	5648.99	-490.42	360.50	524.89	40°14'20.103"N	104°54'18.414"W	0.24	
5994.00	0.890	265.290	5914.97	-487.57	359.68	521.96	40°14'20.095"N	104°54'18.452"W	0.21	
6164.00	0.900	280.100	6084.95	-484.94	359.81	519.33	40°14'20.097"N	104°54'18.485"W	0.14	
6249.00	1.140	354.300	6169.94	-484.12	360.77	518.59	40°14'20.106"N	104°54'18.495"W	1.47	
6335.00	0.740	42.590	6255.93	-484.29	362.03	518.88	40°14'20.118"N	104°54'18.491"W	0.99	
6420.00	0.720	26.140	6340.93	-484.82	362.91	519.48	40°14'20.127"N	104°54'18.483"W	0.25	
6505.00	2.810	283.610	6425.89	-482.95	363.88	517.69	40°14'20.137"N	104°54'18.507"W	3.59	
6590.00	3.320	280.300	6510.77	-478.44	364.81	513.25	40°14'20.146"N	104°54'18.564"W	0.63	
6633.00	8.800	272.090	6553.51	-473.91	365.15	508.73	40°14'20.149"N	104°54'18.622"W	12.87	
6675.00	16.250	265.830	6594.49	-464.89	364.84	499.65	40°14'20.146"N	104°54'18.739"W	18.00	
6718.00	23.100	264.470	6634.95	-450.65	363.59	485.23	40°14'20.134"N	104°54'18.925"W	15.96	
6761.00	22.740	262.810	6674.56	-434.24	361.74	468.59	40°14'20.116"N	104°54'19.140"W	1.72	
6803.00	21.840	260.560	6713.42	-418.75	359.44	452.83	40°14'20.093"N	104°54'19.343"W	2.95	
6846.00	25.150	263.700	6752.85	-402.04	357.13	435.85	40°14'20.070"N	104°54'19.562"W	8.23	
6889.00	28.900	269.780	6791.16	-382.73	356.08	416.37	40°14'20.060"N	104°54'19.813"W	10.82	
6931.00	34.180	272.770	6826.94	-360.82	356.61	394.42	40°14'20.065"N	104°54'20.096"W	13.11	
6974.00	37.510	271.670	6861.79	-335.68	357.58	369.26	40°14'20.075"N	104°54'20.420"W	7.89	
7016.00	40.980	270.630	6894.32	-309.18	358.10	342.70	40°14'20.080"N	104°54'20.763"W	8.41	
7060.00	44.720	269.130	6926.57	-279.39	358.03	312.78	40°14'20.079"N	104°54'21.149"W	8.81	
7104.00	49.130	268.920	6956.61	-247.44	357.48	280.66	40°14'20.074"N	104°54'21.563"W	10.03	
7147.00	53.690	269.050	6983.43	-214.04	356.88	247.06	40°14'20.068"N	104°54'21.996"W	10.61	
7189.00	57.830	269.540	7007.05	-179.50	356.46	212.35	40°14'20.064"N	104°54'22.444"W	9.90	
7232.00	58.270	269.060	7029.81	-143.21	356.02	175.87	40°14'20.059"N	104°54'22.914"W	1.39	
7274.00	60.110	269.740	7051.32	-107.32	355.64	139.80	40°14'20.055"N	104°54'23.379"W	4.60	
7317.00	63.610	270.930	7071.60	-69.54	355.87	101.89	40°14'20.058"N	104°54'23.868"W	8.50	
7360.00	68.050	270.420	7089.20	-30.44	356.33	62.67	40°14'20.062"N	104°54'24.374"W	10.38	
7403.00	72.550	271.710	7103.69	9.93	357.09	22.21	40°14'20.070"N	104°54'24.896"W	10.84	
7447.00	76.590	271.670	7115.39	52.26	358.34	-20.18	40°14'20.082"N	104°54'25.442"W	9.18	
7504.00	80.780	272.160	7126.57	108.05	360.20	-76.03	40°14'20.101"N	104°54'26.162"W	7.40	
7550.00†	83.272	271.669	7132.96	153.53	361.73	-121.55	40°14'20.116"N	104°54'26.749"W	5.52	7" CASING POINT

REFERENCE WELLPATH IDENTIFICATION

Operator	KERR-MCGEE OIL & GAS ONSHORE LP	Slot	SLOT#30 HOUSTON 12C-8HZ
Area	COLORADO	Well	HOUSTON 12C-8HZ
Field	WELD COUNTY (KERR MCGEE)	Wellbore	HOUSTON 12C-8HZ AWB
Facility	SEC.08-T3N-R67W		

WELLPATH DATA (139 stations)

MD [ft]	Inclination [°]	Azimuth [°]	TVD [ft]	Vert Sect [ft]	North [ft]	East [ft]	Latitude	Longitude	DLS [°/100ft]	Comments
7640.00	88.150	270.720	7139.68	243.03	363.59	-211.26	40°14'20.134"N	104°54'27.906"W	5.52	
7725.00	90.180	270.720	7140.92	327.76	364.66	-296.23	40°14'20.145"N	104°54'29.002"W	2.39	
7811.00	91.530	270.490	7139.64	413.48	365.57	-382.22	40°14'20.153"N	104°54'30.111"W	1.59	
7896.00	90.830	270.780	7137.89	498.20	366.51	-467.19	40°14'20.163"N	104°54'31.206"W	0.89	
7981.00	90.890	271.300	7136.61	582.97	368.05	-552.17	40°14'20.178"N	104°54'32.302"W	0.62	
8066.00	91.040	271.350	7135.18	667.77	370.02	-637.14	40°14'20.197"N	104°54'33.398"W	0.19	
8152.00	91.010	271.140	7133.64	753.56	371.89	-723.10	40°14'20.216"N	104°54'34.506"W	0.25	
8237.00	90.860	270.870	7132.26	838.32	373.38	-808.08	40°14'20.231"N	104°54'35.602"W	0.36	
8322.00	90.610	270.900	7131.17	923.08	374.69	-893.06	40°14'20.244"N	104°54'36.698"W	0.30	
8408.00	89.930	270.110	7130.76	1008.80	375.45	-979.05	40°14'20.251"N	104°54'37.807"W	1.21	
8493.00	88.820	269.040	7131.69	1093.39	374.82	-1064.04	40°14'20.245"N	104°54'38.903"W	1.81	
8578.00	88.580	268.990	7133.62	1177.88	373.36	-1149.01	40°14'20.230"N	104°54'39.998"W	0.29	
8663.00	89.100	268.540	7135.34	1262.33	371.53	-1233.97	40°14'20.212"N	104°54'41.094"W	0.81	
8749.00	90.240	268.470	7135.83	1347.75	369.28	-1319.94	40°14'20.190"N	104°54'42.202"W	1.33	
8834.00	90.980	270.560	7134.93	1432.33	368.56	-1404.93	40°14'20.183"N	104°54'43.298"W	2.61	
8919.00	91.570	270.990	7133.04	1517.06	369.71	-1489.90	40°14'20.194"N	104°54'44.394"W	0.86	
9004.00	91.440	271.100	7130.80	1601.82	371.26	-1574.85	40°14'20.209"N	104°54'45.489"W	0.20	
9089.00	91.480	271.130	7128.64	1686.58	372.92	-1659.81	40°14'20.226"N	104°54'46.585"W	0.06	
9174.00	90.800	270.600	7126.95	1771.32	374.20	-1744.78	40°14'20.238"N	104°54'47.680"W	1.01	
9260.00	90.580	270.490	7125.91	1857.04	375.02	-1830.77	40°14'20.246"N	104°54'48.789"W	0.29	
9345.00	90.150	270.370	7125.37	1941.75	375.65	-1915.77	40°14'20.252"N	104°54'49.885"W	0.53	
9515.00	89.220	270.030	7126.30	2111.11	376.25	-2085.76	40°14'20.258"N	104°54'52.077"W	0.58	
9600.00	89.900	269.170	7126.96	2195.71	375.65	-2170.76	40°14'20.252"N	104°54'53.173"W	1.29	
9686.00	89.560	269.720	7127.36	2281.28	374.82	-2256.75	40°14'20.244"N	104°54'54.282"W	0.75	
9771.00	90.060	270.220	7127.64	2365.93	374.78	-2341.75	40°14'20.243"N	104°54'55.378"W	0.83	
9856.00	89.780	270.020	7127.76	2450.61	374.95	-2426.75	40°14'20.245"N	104°54'56.474"W	0.40	
9942.00	89.280	268.480	7128.47	2536.15	373.83	-2512.74	40°14'20.234"N	104°54'57.583"W	1.88	
10027.00	89.440	268.370	7129.42	2620.56	371.49	-2597.70	40°14'20.211"N	104°54'58.679"W	0.23	
10112.00	91.410	269.600	7128.79	2705.06	369.99	-2682.68	40°14'20.196"N	104°54'59.774"W	2.73	
10198.00	89.750	269.720	7127.92	2790.66	369.48	-2768.67	40°14'20.191"N	104°55'00.883"W	1.94	

REFERENCE WELLPATH IDENTIFICATION

Operator	KERR-MCGEE OIL & GAS ONSHORE LP	Slot	SLOT#30 HOUSTON 12C-8HZ
Area	COLORADO	Well	HOUSTON 12C-8HZ
Field	WELD COUNTY (KERR MCGEE)	Wellbore	HOUSTON 12C-8HZ AWP
Facility	SEC.08-T3N-R67W		

WELLPATH DATA (139 stations)

MD [ft]	Inclination [°]	Azimuth [°]	TVD [ft]	Vert Sect [ft]	North [ft]	East [ft]	Latitude	Longitude	DLS [°/100ft]	Comments
10283.00	89.320	270.390	7128.61	2875.32	369.56	-2853.67	40°14'20.191"N	104°55'01.979"W	0.94	
10368.00	89.750	270.450	7129.30	2960.02	370.18	-2938.66	40°14'20.197"N	104°55'03.075"W	0.51	
10454.00	90.370	270.020	7129.21	3045.71	370.53	-3024.66	40°14'20.201"N	104°55'04.184"W	0.88	
10539.00	90.490	270.450	7128.57	3130.39	370.88	-3109.66	40°14'20.204"N	104°55'05.280"W	0.53	
10634.00	89.810	271.640	7128.32	3225.15	372.62	-3204.64	40°14'20.221"N	104°55'06.505"W	1.44	
10709.00	89.260	271.620	7128.93	3300.00	374.75	-3279.60	40°14'20.242"N	104°55'07.472"W	0.73	
10794.00	89.470	271.110	7129.87	3384.81	376.77	-3364.57	40°14'20.262"N	104°55'08.567"W	0.65	
10880.00	89.960	271.480	7130.30	3470.62	378.72	-3450.55	40°14'20.281"N	104°55'09.676"W	0.71	
10965.00	90.760	271.640	7129.76	3555.45	381.03	-3535.52	40°14'20.304"N	104°55'10.771"W	0.96	
11050.00	90.550	271.610	7128.79	3640.28	383.44	-3620.48	40°14'20.328"N	104°55'11.867"W	0.25	
11135.00	90.090	271.680	7128.32	3725.12	385.88	-3705.44	40°14'20.352"N	104°55'12.963"W	0.55	
11220.00	89.280	271.420	7128.78	3809.95	388.18	-3790.41	40°14'20.374"N	104°55'14.058"W	1.00	
11306.00	88.970	270.390	7130.10	3895.70	389.54	-3876.39	40°14'20.387"N	104°55'15.167"W	1.25	
11391.00	89.470	270.580	7131.26	3980.41	390.26	-3961.37	40°14'20.394"N	104°55'16.263"W	0.63	
11476.00	90.370	271.200	7131.37	4065.18	391.58	-4046.36	40°14'20.407"N	104°55'17.359"W	1.29	
11647.00	91.070	272.130	7129.23	4235.84	396.55	-4217.27	40°14'20.456"N	104°55'19.563"W	0.68	
11732.00	89.900	271.470	7128.51	4320.69	399.22	-4302.23	40°14'20.482"N	104°55'20.658"W	1.58	
11828.00	88.140	270.900	7130.15	4416.45	401.20	-4398.19	40°14'20.502"N	104°55'21.895"W	1.93	LAST BHI MWD+IFR SURVEYS
11894.00	88.140	270.900	7132.29	4482.23	402.24	-4464.15	40°14'20.512"N	104°55'22.746"W	0.00	PROJECTION TO BIT

HOLE & CASING SECTIONS - Ref Wellbore: HOUSTON 12C-8HZ AWP Ref Wellpath: HOUSTON 12C-8HZ AWP

String/Diameter	Start MD [ft]	End MD [ft]	Interval [ft]	Start TVD [ft]	End TVD [ft]	Start N/S [ft]	Start E/W [ft]	End N/S [ft]	End E/W [ft]
13.5in Open Hole	17.00	820.00	803.00	17.00	819.98	0.00	0.00	-2.89	-1.08
9.625in Casing Surface	17.00	820.00	803.00	17.00	819.98	0.00	0.00	-2.89	-1.08
8.75in Open Hole	820.00	7565.00	6745.00	819.98	7134.61	-2.89	-1.08	362.14	-136.46
7in Casing Intermediate	17.00	7550.00	7533.00	17.00	7132.96	0.00	0.00	361.73	-121.55
6in Open Hole	7565.00	11894.00	4329.00	7134.61	7132.29	362.14	-136.46	402.24	-4464.15

Actual Wellpath Report

HOUSTON 12C-8HZ AWP

Page 7 of 8

REFERENCE WELLPATH IDENTIFICATION			
Operator	KERR-MCGEE OIL & GAS ONSHORE LP	Slot	SLOT#30 HOUSTON 12C-8HZ
Area	COLORADO	Well	HOUSTON 12C-8HZ
Field	WELD COUNTY (KERR MCGEE)	Wellbore	HOUSTON 12C-8HZ AWB
Facility	SEC.08-T3N-R67W		

WELLPATH COMPOSITION - Ref Wellbore: HOUSTON 12C-8HZ AWB Ref Wellpath: HOUSTON 12C-8HZ AWP				
Start MD [ft]	End MD [ft]	Positional Uncertainty Model	Log Name/Comment	Wellbore
17.00	748.00	Generic gyro - continuous (Standard)	MS ENERGY GYRO SURVEYS <117-748>	HOUSTON 12C-8HZ AWB
748.00	7504.00	NaviTrak (IFR)	BHI MWD/NAVITRAK (IFR) 8.75" HOLE <927-7504>	HOUSTON 12C-8HZ AWB
7504.00	11828.00	NaviTrak (IFR)	BHI MWD/NAVITRAK (IFR) 6" HOLE <7640-11828>	HOUSTON 12C-8HZ AWB
11828.00	11894.00	Blind Drilling (std)	Projection to bit	HOUSTON 12C-8HZ AWB

Actual Wellpath Report

HOUSTON 12C-8HZ AWP

Page 8 of 8

REFERENCE WELLPATH IDENTIFICATION

Operator	KERR-MCGEE OIL & GAS ONSHORE LP	Slot	SLOT#30 HOUSTON 12C-8HZ
Area	COLORADO	Well	HOUSTON 12C-8HZ
Field	WELD COUNTY (KERR MCGEE)	Wellbore	HOUSTON 12C-8HZ AWB
Facility	SEC.08-T3N-R67W		

WELLPATH COMMENTS

MD [ft]	Inclination [°]	Azimuth [°]	TVD [ft]	Comment
17.00	0.000	200.670	17.00	TIE-ON
117.00	0.720	200.670	117.00	BEGIN GYRO SURVEYS
748.00	0.280	33.810	747.98	TIE-INTO GYRO SURVEYS
927.00	0.190	241.320	926.98	BEGIN BHI MWD+IFR SURVEYS
7550.00	83.272	271.669	7132.96	7" CASING POINT
11828.00	88.140	270.900	7130.15	LAST BHI MWD+IFR SURVEYS
11894.00	88.140	270.900	7132.29	PROJECTION TO BIT