

296-6B Location

FORM

15

Rev 6/99

State of Colorado

Oil and Gas Conservation Commission

1120 Lincoln Street, Suite 801, Denver, Colorado 80203 (303)894-2100 Fax: (303)894-2109



FOR OGCC USE ONLY

EARTHEN PIT REPORT/PERMIT

This form is to be used for both reporting and permitting pits. Rule 903 describes when a Permit with prior approval, or a Report within 30 days, is required for pits. Submit required attachments and forms.

Complete the
Attachment Checklist

FORM SUBMITTED FOR:

☐ Pit Report☒ Pit Permit

OGCC Operator Number: 28700

Name of Operator: ExxonMobil Oil Corporation

Address: P.O. Box 4358; CORP-MI-207

City: Houston State: Tx. Zip: 77210-4358

Contact Name and Telephone:

Mark Cornett

No: (281) 654-1925

Fax: (281) 654-1940

	Oper	OGCC
Detailed Site Plan	✓	
Topo Map w/ Pit Location	✓	
Water Analysis (Form 26)		
Source Wells (Form 26)		
Pit Design/Plan & Cross Sect	✓	
Design Calculations		
Sensitive Area Detorm.		
Mud Program		
Form 2A		

API Number (of associated well): 103 11546

OGCC Facility ID (of other associated facility): Piceance Creek Unit 296-6B1, B2, B3, B4, B5, B6, B7, B8, B9, B10

Pit Location (QtrQtr, Sec, Twp, Rng, Meridian): NWSE, Sec. 6, T2S, R96W, 6th P.M.

Latitude: 39.905268

Longitude: 108.204977

County: Rio Blanco Loc ID = 413466

Pit Use: ☐ Production ☒ Drilling (Attach mud program) ☐ Special Purpose (Describe Use)Pit Type: ☒ Lined ☐ Unlined Surface Discharge Permit: ☐ Yes ☒ NoOffsite disposal of pit contents: ☒ Injection ☐ Commercial Pit/Facility Name: Piceance Creek Unit 296-6b Pit/Facility No: _____

Attach Form 26 to identify Source Wells and Form 25 to provide Produced Water Analysis results.

Existing Site Conditions

Is the location in a "Sensitive Area?"

☐ Yes☐ No

Attach data used for determination. NA; Pit will be lined.

Distance (in feet) to nearest surface water: +/- 1500' ground water: unknown water wells: ~2500'

LAND USE (or attach copy of Form 2A if previously submitted for associated well) Select one which best describes land use:

Crop Land: ☐ Irrigated ☐ Dry Land ☐ Improved Pasture ☐ Hay Meadow ☐ CRPNon-Crop Land: ☒ Rangeland ☐ Timber ☐ Recreational ☐ Other (describe): _____Subdivided: ☐ Industrial ☐ Commercial ☐ Residential

SOILS (or attach copy of Form 2A if previously submitted for associated well)

Soil map units from USNRCS survey: Sheet No: 31 Soil Complex/Series No: 64

Soils Series Name: Piceance fine sandy loam, 5 to 15% slopes Horizon thickness (in inches): A: 0-4 ; B: 4-22 ; C: 22-30

Soils Series Name: _____ Horizon thickness (in inches): A: _____ ; B: _____ ; C: _____

Attach detailed site plan and topo map with pit location.

Pit Design and Construction

Size of pit (feet): Length: 190 Width: 120 Depth: 12' & 15'

Calculated pit volume (bbls): 38490 w2 lrbld. Daily inflow rate (bbls/day): Various

Daily disposal rates (attach calculations): Evaporation: N/A bbls/day Percolation: 0 bbls/day

Type of liner material: Impermeable synthetic

Thickness: 24 mil woven coated polyethylene liner with an 8 ounce geotextile felt padding under the liner.

Attach description of proposed design and construction (include sketches and calculations).

Method of treatment of produced water prior to discharge into pit (separator, heater treater, other): separator

Is pit fenced? ☒ Yes ☐ No Is pit netted? ☒ Yes ☐ No

I hereby certify that the statements made in this form are, to the best of my knowledge, true, correct, and complete.

Print Name Mark Cornett

Signed: Mark Cornett

Title: Regulatory Specialist

Date: 04/14/2009

OGCC Approved: Chris Canfield

Title: _____ Date: _____

CONDITIONS OF APPROVAL, IF ANY:

8/28/2009

FACILITY NUMBER: 431149

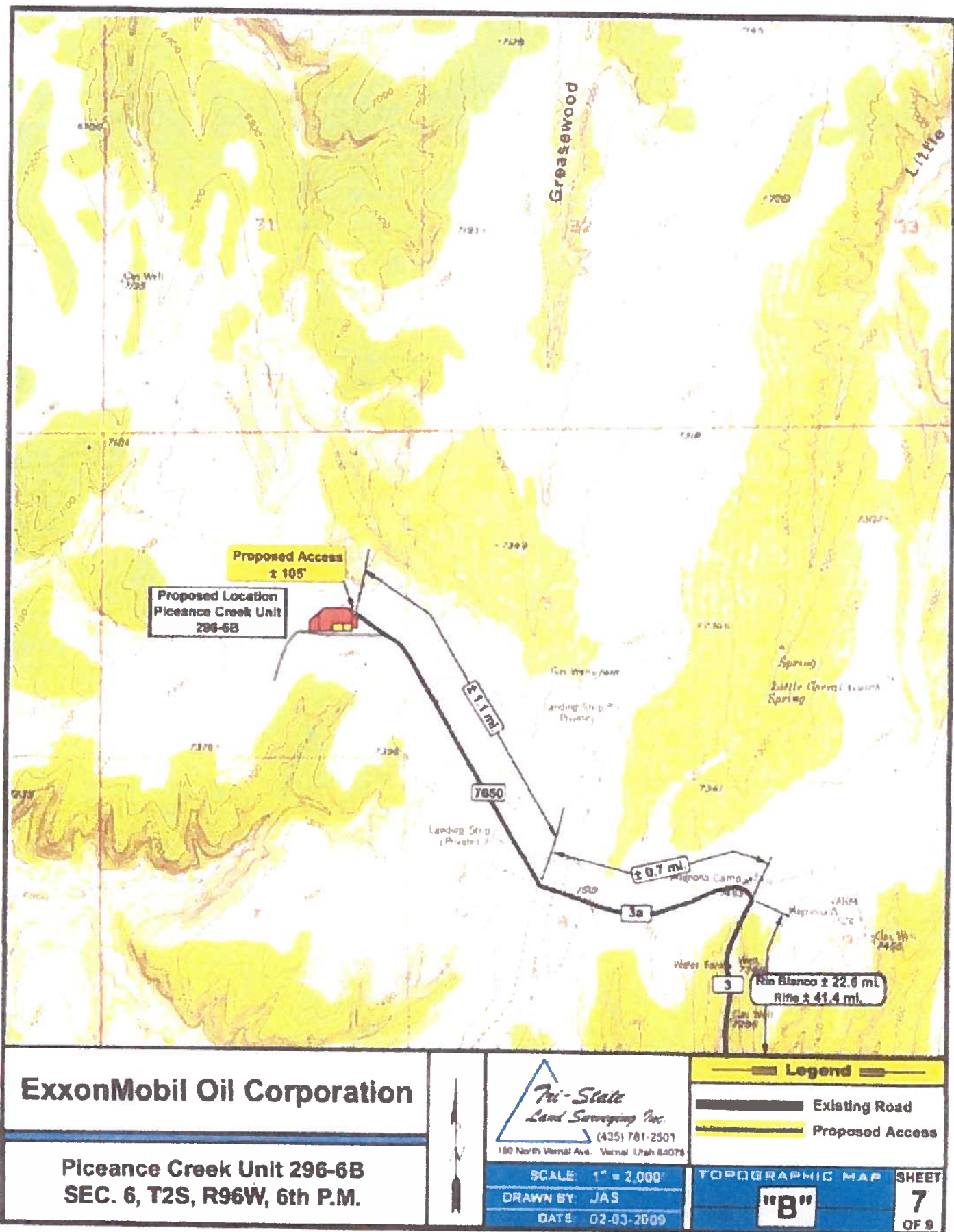

ExxonMobil Oil Corporation

**Piceance Creek Unit 296-6B
SEC. 6, T2S, R96W, 6th P.M.**

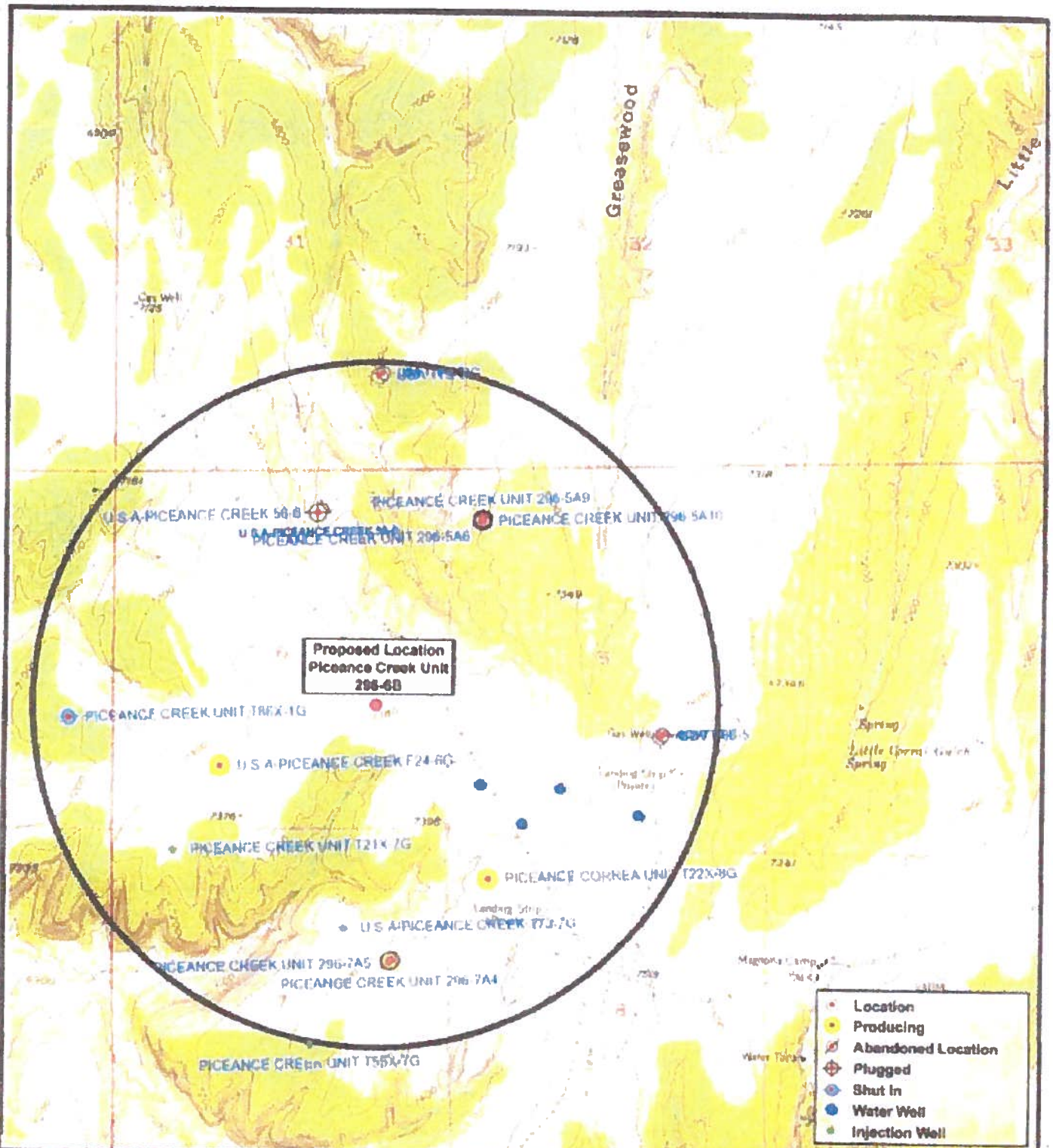

ExxonMobil Oil Corporation

Piceance Creek Unit 296-6B
SEC. 6, T2S, R96W, 6th P.M.

Tri-State
Land Surveying Inc.
(435) 781-2501
180 North Vernal Ave Vernal, Utah 84078

SCALE 1" = 1,000'
DRAWN BY JAS
DATE 03-13-2009

Legend

- Location
- One-Mile Radius

TOPOGRAPHIC MAP
"C"

SHEET
8
OF 9

FIGURE #1

TOPSOIL STOCKPILE
Approx. Area = 6,590 Sq. Ft.
± 1,750 Cu. Yds.

EXCESS MATERIAL
Approx. Area = 29,820 Sq. Ft.
± 10,750 Cu. Yds.

NOTE:
FILL MATERIAL IS REQUIRED WITHIN THE RIG
SUB-STRUCTURE AREAS. COMPACT ALL FILL
AREAS TO A MINIMUM OF 95% OF THE
MAXIMUM DRY DENSITY WHICH IS OBTAINED
BY AASHTO METHOD T-99.

NOTE:
The topsoil, grading stockpile & waste material areas are calculated as being mounds containing 15,760 cubic yards of dirt (a 10% fluff factor is included). The mound areas are calculated with push slopes of 1.5:1 & fill slopes of 1.5:1.

NOTE:
CUTS AND FILLS SHOWN ARE FOR THE INITIAL CONSTRUCTION
OF PAD TO A SINGLE & LEVEL ELEVATION. ADDITIONAL
EARTHWORK IS REQUIRED TO COMPLETE THE FINISH GRADING
PLAN AS SHOWN ON SHEET 5.

SURVEYED BY: T.R.	DATE SURVEYED: 01-27-09
DRAWN BY: D.COX	DATE DRAWN: 01-19-09
SCALE: 1" = 100'	REVISED: 02-03-09

Tri State (435) 731-2
Land Surveying, Inc.
180 NORTH VERNAL AVE. VERNAL, UTAH 84078

SHEET
2
OF 9

ExxonMobil Oil Corporation

FIGURE #2

CROSS SECTIONS

WELL PAD (PICEANCE CREEK UNIT 296-6B)
PICEANCE CREEK UNIT 296-6B1, B2, B3, B4, B5, B6, B7, B8, B9 & B10
Section 8, T2S, R96W, 6th P.M.

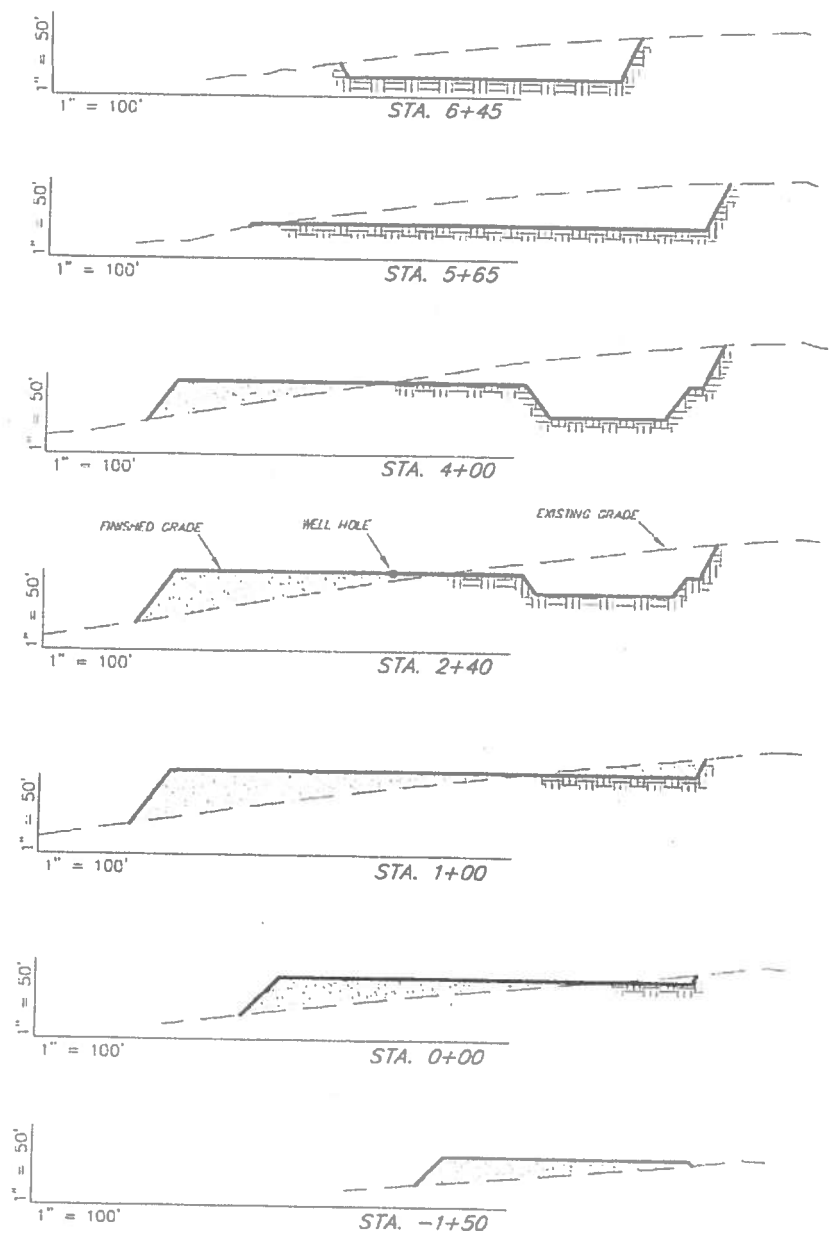

* 3,510 CU. YDS. OF MATERIAL IS REQUIRED TO BE EXCAVATED & STOCKPILED TO COMPLETE THE FINISH GRADING PLAN AS SHOWN ON SHEET 5.

ESTIMATED EARTHWORK QUANTITIES (No Shrink or swell adjustments have been used) (Expressed in Cubic Yards)				
ITEM	CUT	FILL	6" TOPSOIL	EXCESS
FINISH GRADING	4,080	350	Topsoil to fill included in Prod Cut	*3,510
P.T.S.	12,520	0		12,520
PAD	35,280	41,543	5,480	6,260
TOTALS	51,880	42,093	5,480	8,770

SURVEYED BY: T.R. DATE SURVEYED: 01-27-09
DRAWN BY: D.P.OX DATE DRAWN: 01-19-09
SCALE: 1" = 100' REVISED: 02-03-09

Tri State
Land Surveying, Inc.
180 NORTH VERNAL AVE. VERNAL, UTAH 84078
(435) 781-2501

SHEET
3
OF 9