

LEGEND:

 PROPOSED LOCATION

BILL BARRETT CORPORATION

WILL 6-62-15_22 NWNW PAD #6-62-15-0164BH2,
 0148CH2, 0263BH2, 0263CDH2, 0263CH2 & 0362BH2
 SECTION 15, T6N, R62W, 6th P.M.
 NW 1/4 NW 1/4

DRAWN BY: J.L.G.

DATE DRAWN: 05-21-14

SCALE: 1:100,000

REVISED: 06-19-14 T.W.

ACCESS ROAD MAP

TOPO A



UELS, LLC
 Corporate Office * 85 South 200 East
 Vernal, UT 84078 * (435) 789-1017

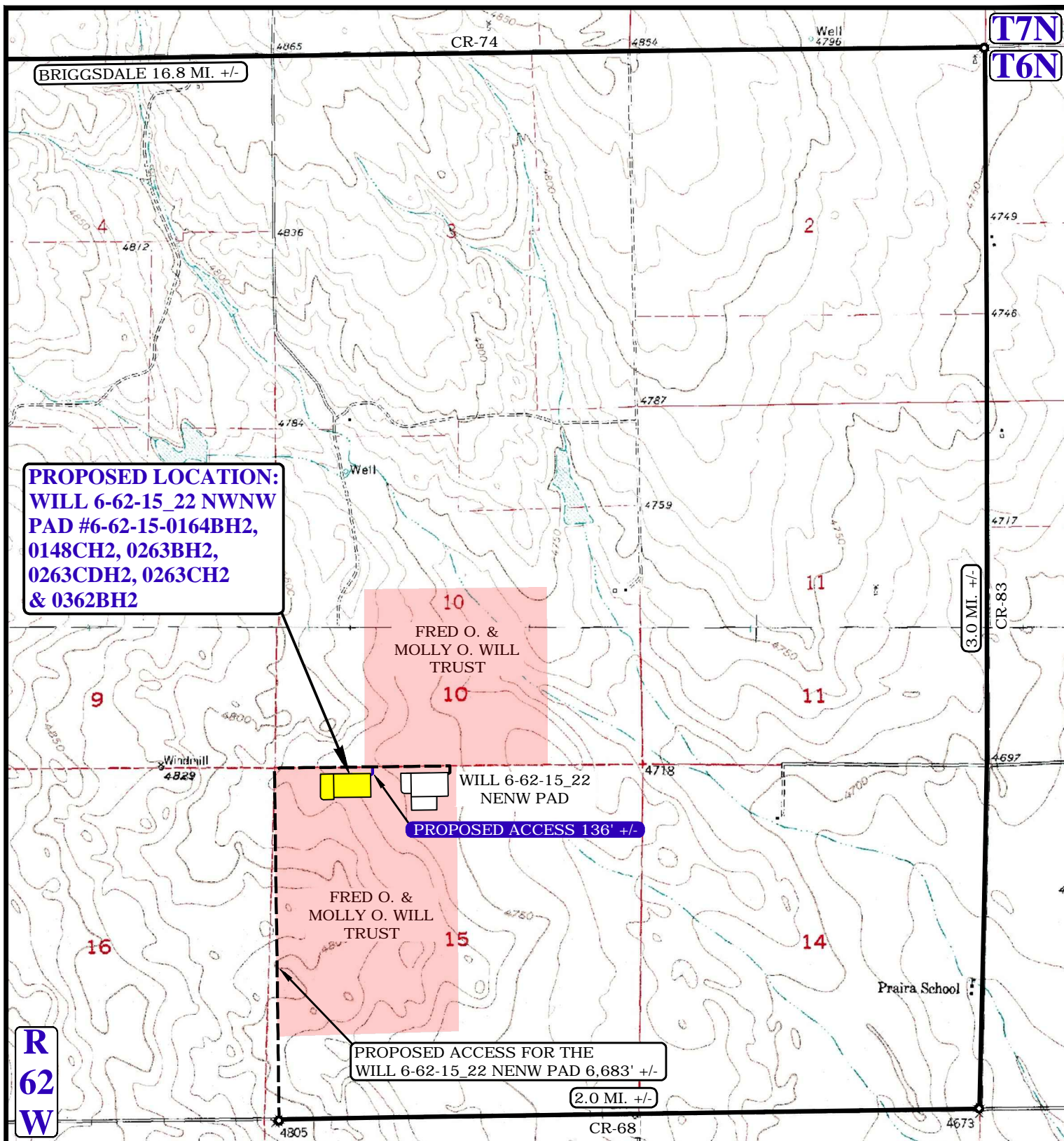

NOTE: PARCEL DATA SHOWN HAS BEEN OBTAINED FROM VARIOUS SOURCES AND SHOULD BE USED FOR MAPPING, GRAPHIC AND PLANNING PURPOSES ONLY. NO WARRANTY IS MADE BY UINTAH ENGINEERING AND LAND SURVEYING (UELS) FOR ACCURACY OF THE PARCEL DATA.

LEGEND:

— EXISTING ROAD
 - - - PROPOSED ROAD

BILL BARRETT CORPORATION

WILL 6-62-15_22 NWNW PAD #6-62-15-0164BH2,
 0148CH2, 0263BH2, 0263CDH2, 0263CH2 & 0362BH2
 SECTION 15, T6N, R62W, 6th P.M.
 NW 1/4 NW 1/4

DRAWN BY: J.L.G.

DATE DRAWN: 05-21-14

SCALE: 1" = 2000'

REVISED: 06-19-14 T.W.

ACCESS ROAD MAP

TOPO B



UELS, LLC
 Corporate Office * 85 South 200 East
 Vernal, UT 84078 * (435) 789-1017



PROCEED IN A SOUTHERLY, THEN SOUTHWESTERLY DIRECTION FROM BRIGGSDALE, COLORADO ALONG HIGHWAY 392 APPROXIMATELY 9.7 MILES TO THE JUNCTION OF THIS ROAD AND COUNTY ROAD 74 TO THE EAST; TURN LEFT AND PROCEED IN AN EASTERLY DIRECTION APPROXIMATELY 7.1 MILES TO THE JUNCTION OF THIS ROAD AND COUNTY ROAD 83 TO THE SOUTH; TURN RIGHT AND PROCEED IN A SOUTHERLY DIRECTION APPROXIMATELY 3.0 MILES TO THE JUNCTION OF THIS ROAD AND COUNTY ROAD 68 TO THE WEST; TURN RIGHT AND PROCEED IN A WESTERLY DIRECTION APPROXIMATELY 2.0 MILES TO THE BEGINNING OF THE PROPOSED ACCESS FOR THE WILL 6-62-15_22 NENW PAD TO THE NORTH; FOLLOW ROAD FLAGS IN A NORTHERLY, THEN EASTERLY DIRECTION APPROXIMATELY 6,683' TO THE BEGINNING OF THE PROPOSED ACCESS ROAD TO THE SOUTH; FOLLOW ROAD FLAGS IN A SOUTHERLY DIRECTION APPROXIMATELY 136' TO THE PROPOSED LOCATION.

TOTAL DISTANCE FROM BRIGGSDALE, COLORADO TO THE PROPOSED WELL LOCATION IS APPROXIMATELY 23.1 MILES.

BILL BARRETT CORPORATION

WILL 6-62-15_22 NWNW PAD #6-62-15-0164BH2,
0148CH2, 0263BH2, 0263CDH2, 0263CH2 & 0362BH2
SECTION 15, T6N, R62W, 6th P.M.
NW 1/4 NW 1/4



UELS, LLC
Corporate Office * 85 South 200 East
Vernal, UT 84078 * (435) 789-1017

DRAWN BY: J.L.G.	DATE DRAWN: 05-21-14
	REVISED: 06-19-14 T.W.
ROAD DESCRIPTION	