



June 25, 2014

7535 Hilltop Circle
Denver, CO 80221
www.petro-fs.com

Mr. Matt Lepore, Director
Colorado Oil and Gas Conservation Commission
1120 Lincoln Street, Suite 801
Denver, Colorado 80203

**RE: COGCC Rule 318A.e.: Proposed Wellbore Spacing Unit
Nelson Farm 4 Well: NWNW, Section 28, Township 7 North, Range 67 West
Weld County, Colorado**

Dear Mr. Lepore:

Extraction Oil and Gas, LLC (Extraction) is planning to drill the above referenced well in accordance with the provisions set out in COGCC Rule 318A.e. Extraction's proposed wellbore spacing unit consists of:

N½N½ of Section 28, Township 7 North, Range 67 West
N½NW¼, NWNE of Section 27, Township 7 North, Range 67 West
Containing 280 acres more or less

Extraction is not the only owner within the proposed wellbore spacing unit and has provided notice to the remaining owners within this spacing unit, as required by COGCC Rule 318A.e.(6). Copies of the required notification letters are on file at Extraction's office. The required thirty (30) day notice period has elapsed absent the receipt by Extraction of any objection to their proposal by the owners within the proposed spacing unit for the subject well.

Enclosed is the Proposed Spacing Unit Plat to assist in your review and approval of Extraction's proposed Application for Permit to Drill (APD) for the Nelson Farm 4 well. Many thanks for your attention to this matter.

Respectfully,

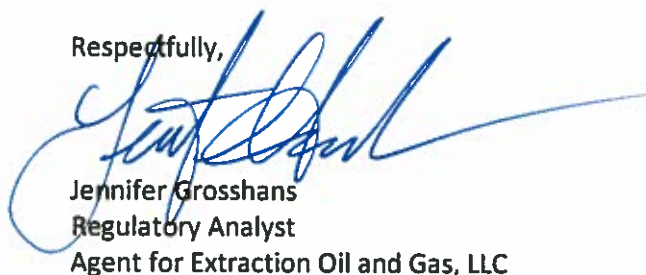

Jennifer Grosshans
Regulatory Analyst
Agent for Extraction Oil and Gas, LLC

:jg

Enclosure: Proposed Spacing Unit Plat

We are what we repeatedly do. Excellence, then, is not an act, but a habit.

-Aristotle

PROPOSED 318A.e. SPACING UNIT

SECTION 28 & 27, TOWNSHIP 7 NORTH, RANGE 67 WEST, 6TH P.M.

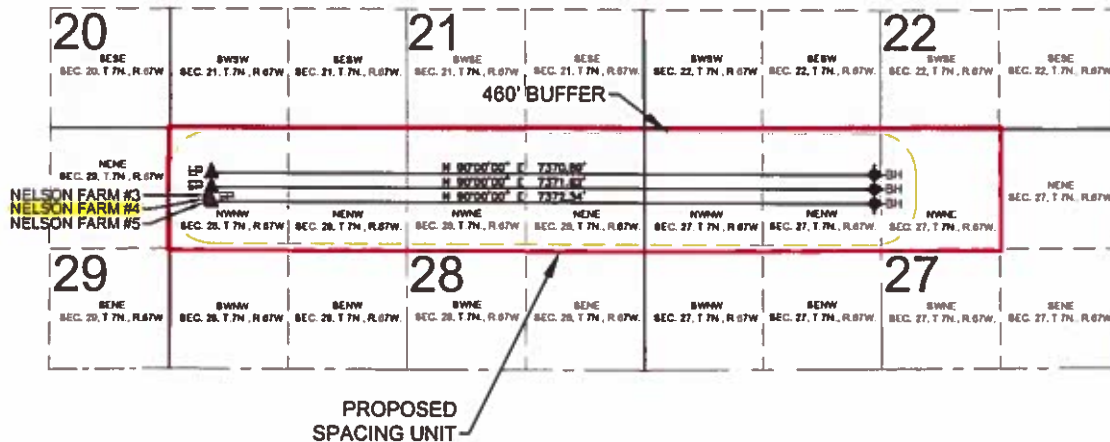

| WELL NAME | SURFACE FOOTAGES | | SURFACE LOCATION (NAD83) | LANDING POINT LOCATION (NAD83) | BOTTOM HOLE LOCATION (NAD83) |
|----------------|------------------|----------|--|--|--|
| NELSON FARM #3 | 760' FNL | 409' FWL | LATITUDE= 40.550455° LONGITUDE= 104.906391° | LATITUDE= 40.551196° LONGITUDE= 104.906197° | LATITUDE= 40.551058° LONGITUDE= 104.879673° |
| NELSON FARM #4 | 788' FNL | 409' FWL | LATITUDE= 40.550378° LONGITUDE= 104.906392° | LATITUDE= 40.550757° LONGITUDE= 104.906203° | LATITUDE= 40.550818° LONGITUDE= 104.879676° |
| NELSON FARM #5 | 816' FNL | 409' FWL | LATITUDE= 40.550301° LONGITUDE= 104.906394° | LATITUDE= 40.550318° LONGITUDE= 104.906208° | LATITUDE= 40.550179° LONGITUDE= 104.879680° |

LEGEND

- = PROPOSED WELL
- ▲ = LANDING POINT
- ◆ = BOTTOM HOLE
- LP = LANDING POINT
- BH = BOTTOM HOLE

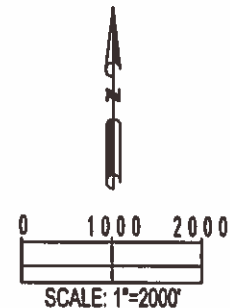

SHEET 2 OF 5

| | | |
|--|---------------------------|---|
| PREPARED BY: PFS Petroleum Field Services, LLC 1531 Hilltop Circle Denver, CO 80221 | FIELD DATE: 04-25-14 | SURFACE LOCATION: NW 1/4 NW 1/4, SEC. 28, T7N, R67W, 6TH P.M. |
| | DRAWING DATE: 05-13-14 | |
| | BY: JLD | CHECKED: MDC |