

Synergy Resources

Well Name: **SRC Phelps 11-32NHZ**

Surface Location: SRC Phelps 11-32CHZ Pad Sec.32-T1N-R66W
North American Datum 1983 , US State Plane 1983 , Colorado Northern Zone
Ground Elevation: 5019.0

+N/-S	+E/-W	Northing	Easting	Latitude	Longitude	Slot
0.0	0.0	1247310.67	3198212.27	40.010083	-104.792375	

Ensign Rig #17 RKB - 12' WELL @ 5031.0ft (Ensign Rig #17 RKB - 12')

FINAL SURVEY

Projected Bottom Hole Location
12054' MD 7471' TVD 979' N & 4582' W of SHL
88.5 degree Incl @ 271.3 degree AZM

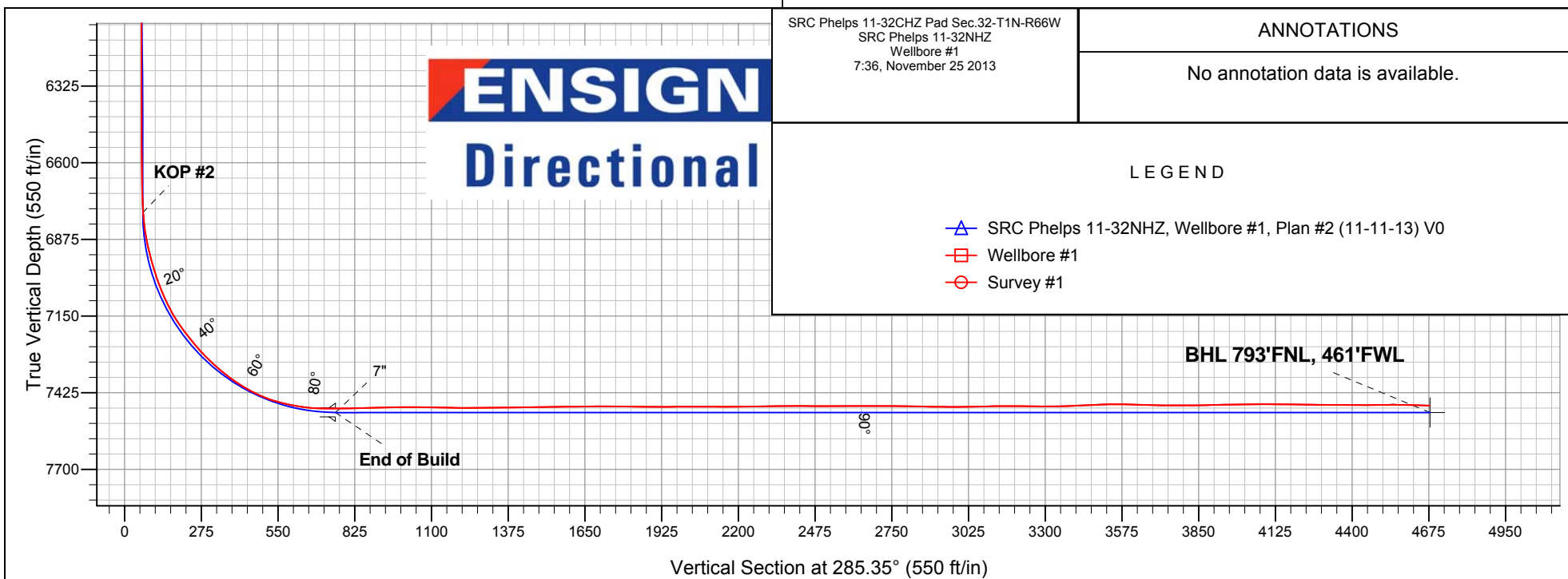
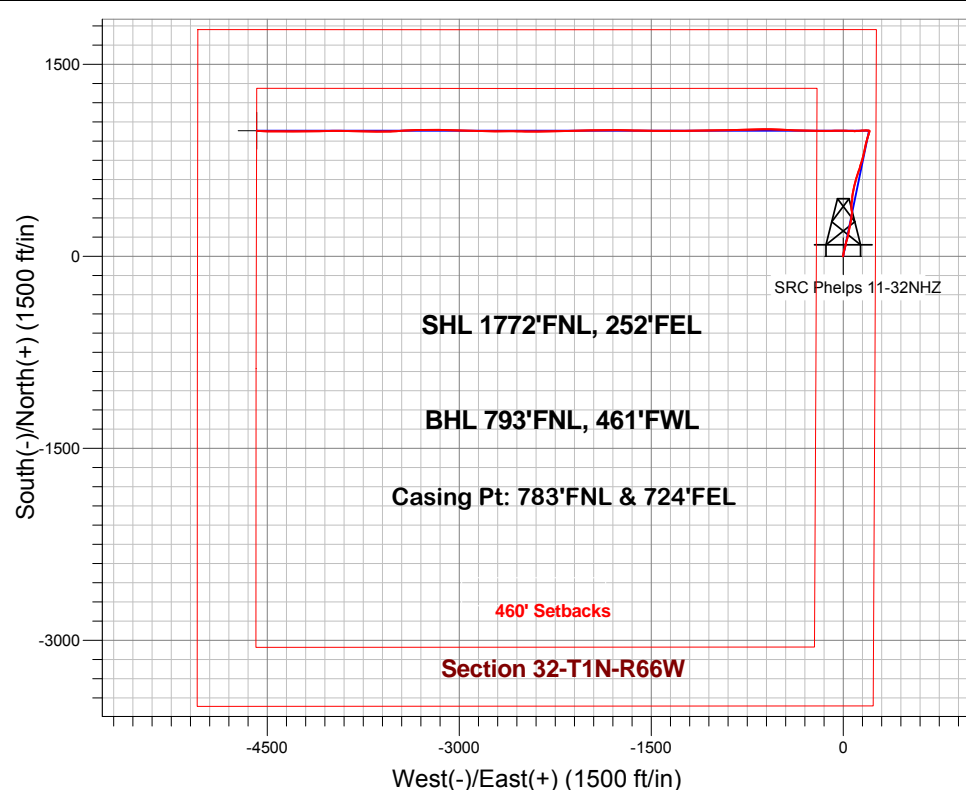

SRC Phelps 11-32CHZ Pad Sec.32-T1N-R66W
SRC Phelps 11-32NHZ
Wellbore #1
7:36, November 25 2013

ANNOTATIONS

No annotation data is available.

LEGEND

- ▲ SRC Phelps 11-32NHZ, Wellbore #1, Plan #2 (11-11-13) V0
- Wellbore #1
- Survey #1



Synergy Resources

SEC.32-T1N-R66W

SRC Phelps 11-32CHZ Pad Sec.32-T1N-R66W

SRC Phelps 11-32NHZ

Wellbore #1

Survey: Survey #1

Standard Survey Report

25 November, 2013

Company:	Synergy Resources	Local Co-ordinate Reference:	Well SRC Phelps 11-32NHZ
Project:	SEC.32-T1N-R66W	TVD Reference:	WELL @ 5031.0ft (Ensign Rig #17 RKB - 12')
Site:	SRC Phelps 11-32CHZ Pad Sec.32-T1N-R66W	MD Reference:	WELL @ 5031.0ft (Ensign Rig #17 RKB - 12')
Well:	SRC Phelps 11-32NHZ	North Reference:	True
Wellbore:	Wellbore #1	Survey Calculation Method:	Minimum Curvature
Design:	Wellbore #1	Database:	Landmark

Project	SEC.32-T1N-R66W, Weld County, Colorado		
Map System:	US State Plane 1983	System Datum:	Mean Sea Level
Geo Datum:	North American Datum 1983		Using Well Reference Point
Map Zone:	Colorado Northern Zone		Using geodetic scale factor

Site		SRC Phelps 11-32CHZ Pad Sec.32-T1N-R66W			
Site Position:		Northing:	1,247,322.38 ft	Latitude:	40.010114
From:	Lat/Long	Easting:	3,198,263.72 ft	Longitude:	-104.792191
Position Uncertainty:	0.0 ft	Slot Radius:	"	Grid Convergence:	0.46 °

Well	SRC Phelps 11-32NHZ					
Well Position	+N/-S	0.0 ft	Northing:	1,247,310.67 ft	Latitude:	40.010083
	+E/-W	0.0 ft	Easting:	3,198,212.27 ft	Longitude:	-104.792375
Position Uncertainty		0.0 ft	Wellhead Elevation:	ft	Ground Level:	5,019.0 ft

Wellbore	Wellbore #1				
Magnetics	Model Name	Sample Date	Declination (°)	Dip Angle (°)	Field Strength (nT)
	IGRF2010	11/11/2013	8.52	66.65	52,668

Design	Wellbore #1				
Audit Notes:					
Version:	1.0	Phase:	ACTUAL	Tie On Depth:	0.0
Vertical Section:	Depth From (TVD) (ft)	+N/-S (ft)	+E/-W (ft)	Direction (°)	
	0.0	0.0	0.0	285.35	

Survey Program	Date	11/25/2013			
From (ft)	To (ft)	Survey (Wellbore)	Tool Name	Description	
253.0	12,054.0	Survey #1 (Wellbore #1)	MWD	MWD - Standard	

Survey										
Measured Depth (ft)	Inclination (°)	Azimuth (°)	Vertical Depth (ft)	+N/-S (ft)	+E/-W (ft)	Vertical Section (ft)	Dogleg Rate (°/100ft)	Build Rate (°/100ft)	Turn Rate (°/100ft)	
0.0	0.00	0.00	0.0	0.0	0.0	0.0	0.00	0.00	0.00	
1.0	0.00	340.10	1.0	0.0	0.0	0.0	0.00	0.00	0.00	
SHL 1772'FNL, 252'FEL										
253.0	0.10	340.10	253.0	0.2	-0.1	0.1	0.04	0.04	0.00	
346.0	0.60	339.50	346.0	0.7	-0.3	0.5	0.54	0.54	-0.65	
471.0	2.40	7.10	471.0	4.0	-0.2	1.2	1.51	1.44	22.08	
596.0	4.40	10.60	595.7	11.3	1.0	2.0	1.61	1.60	2.80	
721.0	6.90	11.70	720.1	23.3	3.4	2.9	2.00	2.00	0.88	
845.0	8.80	13.80	842.9	39.8	7.2	3.6	1.55	1.53	1.69	
970.0	10.80	14.30	966.1	60.5	12.4	4.1	1.60	1.60	0.40	
1,099.0	12.70	12.70	1,092.4	86.0	18.5	4.9	1.49	1.47	-1.24	
1,160.0	13.00	14.00	1,151.9	99.2	21.6	5.4	0.68	0.49	2.13	
1,220.0	13.40	14.50	1,210.3	112.5	25.0	5.7	0.69	0.67	0.83	

Company:	Synergy Resources	Local Co-ordinate Reference:	Well SRC Phelps 11-32NHZ
Project:	SEC.32-T1N-R66W	TVD Reference:	WELL @ 5031.0ft (Ensign Rig #17 RKB - 12')
Site:	SRC Phelps 11-32CHZ Pad Sec.32-T1N-R66W	MD Reference:	WELL @ 5031.0ft (Ensign Rig #17 RKB - 12')
Well:	SRC Phelps 11-32NHZ	North Reference:	True
Wellbore:	Wellbore #1	Survey Calculation Method:	Minimum Curvature
Design:	Wellbore #1	Database:	Landmark

Survey										
Measured Depth (ft)	Inclination (°)	Azimuth (°)	Vertical Depth (ft)	+N/-S (ft)	+E/-W (ft)	Vertical Section (ft)	Dogleg Rate (°/100ft)	Build Rate (°/100ft)	Turn Rate (°/100ft)	
1,345.0	12.30	12.70	1,332.2	139.5	31.5	6.5	0.94	-0.88	-1.44	
1,470.0	12.00	12.90	1,454.4	165.2	37.4	7.7	0.24	-0.24	0.16	
1,595.0	12.70	12.60	1,576.5	191.2	43.3	8.9	0.56	0.56	-0.24	
1,720.0	13.70	11.00	1,698.2	219.2	49.1	10.7	0.85	0.80	-1.28	
1,845.0	14.30	11.50	1,819.4	248.8	55.0	12.8	0.49	0.48	0.40	
1,970.0	14.20	10.10	1,940.6	279.1	60.8	15.3	0.29	-0.08	-1.12	
2,095.0	13.10	6.90	2,062.1	308.2	65.2	18.7	1.07	-0.88	-2.56	
2,221.0	11.60	1.70	2,185.2	335.1	67.2	23.8	1.48	-1.19	-4.13	
2,346.0	11.00	356.20	2,307.7	359.5	66.8	30.7	0.99	-0.48	-4.40	
2,471.0	10.90	355.20	2,430.5	383.2	65.0	38.7	0.17	-0.08	-0.80	
2,595.0	10.50	3.20	2,552.3	406.2	64.7	45.1	1.24	-0.32	6.45	
2,720.0	11.20	12.20	2,675.1	429.4	67.9	48.2	1.46	0.56	7.20	
2,845.0	10.30	2.00	2,797.9	452.4	70.9	51.4	1.68	-0.72	-8.16	
2,971.0	9.20	5.20	2,922.1	473.7	72.2	55.8	0.97	-0.87	2.54	
3,096.0	10.30	9.90	3,045.3	494.7	75.0	58.6	1.09	0.88	3.76	
3,222.0	12.00	12.90	3,168.9	518.6	79.8	60.2	1.43	1.35	2.38	
3,348.0	11.00	14.10	3,292.4	543.0	85.7	61.1	0.82	-0.79	0.95	
3,474.0	10.40	15.70	3,416.2	565.6	91.7	61.3	0.53	-0.48	1.27	
3,599.0	10.10	12.60	3,539.2	587.2	97.2	61.7	0.50	-0.24	-2.48	
3,724.0	10.10	15.90	3,662.2	608.4	102.5	62.1	0.46	0.00	2.64	
3,850.0	9.40	17.70	3,786.4	628.8	108.7	61.6	0.61	-0.56	1.43	
3,977.0	9.20	19.90	3,911.7	648.2	115.3	60.4	0.32	-0.16	1.73	
4,103.0	9.90	19.40	4,036.0	667.9	122.3	58.8	0.56	0.56	-0.40	
4,229.0	9.00	17.50	4,160.3	687.5	128.9	57.7	0.76	-0.71	-1.51	
4,354.0	8.60	18.00	4,283.8	705.8	134.7	56.9	0.33	-0.32	0.40	
4,480.0	9.40	15.40	4,408.3	724.6	140.4	56.4	0.71	0.63	-2.06	
4,606.0	11.50	17.30	4,532.2	746.6	146.8	56.0	1.69	1.67	1.51	
4,732.0	9.90	12.90	4,656.0	769.1	153.0	56.0	1.42	-1.27	-3.49	
4,857.0	10.30	14.00	4,779.0	790.4	158.1	56.7	0.36	0.32	0.88	
4,982.0	10.00	12.90	4,902.1	811.8	163.2	57.5	0.29	-0.24	-0.88	
5,109.0	11.00	12.20	5,027.0	834.4	168.2	58.6	0.79	0.79	-0.55	
5,235.0	10.60	11.70	5,150.7	857.5	173.1	60.0	0.33	-0.32	-0.40	
5,361.0	9.80	14.50	5,274.7	879.3	178.2	60.9	0.75	-0.63	2.22	
5,486.0	9.00	15.40	5,398.1	899.0	183.4	61.1	0.65	-0.64	0.72	
5,612.0	9.00	17.30	5,522.5	917.9	189.0	60.7	0.24	0.00	1.51	
5,737.0	7.60	16.10	5,646.2	935.2	194.2	60.3	1.13	-1.12	-0.96	
5,863.0	5.60	15.90	5,771.3	949.1	198.2	60.1	1.59	-1.59	-0.16	
5,988.0	4.20	14.80	5,895.9	959.4	201.0	60.1	1.12	-1.12	-0.88	
6,114.0	2.90	14.00	6,021.6	966.9	203.0	60.2	1.03	-1.03	-0.63	
6,240.0	1.90	18.90	6,147.5	972.0	204.4	60.1	0.81	-0.79	3.89	
6,366.0	1.40	7.10	6,273.5	975.5	205.3	60.2	0.48	-0.40	-9.37	
6,492.0	0.70	0.60	6,399.5	977.8	205.5	60.7	0.56	-0.56	-5.16	
6,618.0	0.40	351.10	6,525.5	979.0	205.4	61.0	0.25	-0.24	-7.54	
6,744.0	0.80	321.40	6,651.4	980.1	204.8	61.9	0.39	0.32	-23.57	
6,807.0	1.90	280.50	6,714.4	980.7	203.5	63.3	2.22	1.75	-64.92	
6,839.0	2.30	282.20	6,746.4	980.9	202.3	64.5	1.26	1.25	5.31	
6,870.0	3.60	279.90	6,777.4	981.2	200.8	66.1	4.21	4.19	-7.42	
6,901.0	5.70	279.00	6,808.3	981.6	198.3	68.6	6.78	6.77	-2.90	
6,932.0	8.00	276.10	6,839.0	982.1	194.6	72.2	7.50	7.42	-9.35	
6,964.0	10.60	273.40	6,870.6	982.5	189.5	77.3	8.24	8.13	-8.44	
6,996.0	13.00	271.80	6,901.9	982.8	182.9	83.7	7.57	7.50	-5.00	
7,027.0	15.00	269.90	6,932.0	982.9	175.4	91.0	6.62	6.45	-6.13	
7,059.0	16.40	266.90	6,962.8	982.6	166.8	99.2	5.06	4.38	-9.38	
7,090.0	18.50	266.90	6,992.4	982.1	157.5	108.0	6.77	6.77	0.00	

Company:	Synergy Resources	Local Co-ordinate Reference:	Well SRC Phelps 11-32NHZ
Project:	SEC.32-T1N-R66W	TVD Reference:	WELL @ 5031.0ft (Ensign Rig #17 RKB - 12')
Site:	SRC Phelps 11-32CHZ Pad Sec.32-T1N-R66W	MD Reference:	WELL @ 5031.0ft (Ensign Rig #17 RKB - 12')
Well:	SRC Phelps 11-32NHZ	North Reference:	True
Wellbore:	Wellbore #1	Survey Calculation Method:	Minimum Curvature
Design:	Wellbore #1	Database:	Landmark

Survey									
Measured Depth (ft)	Inclination (°)	Azimuth (°)	Vertical Depth (ft)	+N/-S (ft)	+E/-W (ft)	Vertical Section (ft)	Dogleg Rate (°/100ft)	Build Rate (°/100ft)	Turn Rate (°/100ft)
7,121.0	20.70	266.20	7,021.6	981.5	147.1	117.9	7.14	7.10	-2.26
7,153.0	22.80	265.00	7,051.3	980.6	135.3	129.0	6.71	6.56	-3.75
7,184.0	25.10	265.30	7,079.6	979.5	122.8	140.9	7.43	7.42	0.97
7,215.0	27.20	267.10	7,107.5	978.6	109.1	153.8	7.24	6.77	5.81
7,247.0	29.80	269.60	7,135.6	978.2	93.9	168.4	8.94	8.13	7.81
7,278.0	32.90	270.80	7,162.1	978.3	77.8	183.9	10.20	10.00	3.87
7,310.0	36.20	271.70	7,188.4	978.7	59.6	201.5	10.43	10.31	2.81
7,341.0	38.30	271.50	7,213.1	979.2	40.9	219.8	6.79	6.77	-0.65
7,373.0	39.70	271.70	7,238.0	979.8	20.7	239.3	4.39	4.38	0.63
7,403.0	41.60	271.50	7,260.7	980.3	1.2	258.3	6.35	6.33	-0.67
7,435.0	44.30	270.60	7,284.1	980.7	-20.6	279.4	8.65	8.44	-2.81
7,466.0	46.90	269.20	7,305.8	980.6	-42.7	300.8	8.99	8.39	-4.52
7,498.0	49.10	267.80	7,327.2	980.0	-66.5	323.5	7.60	6.88	-4.38
7,529.0	51.30	267.80	7,347.1	979.1	-90.3	346.2	7.10	7.10	0.00
7,561.0	53.80	269.20	7,366.5	978.4	-115.7	370.5	8.55	7.81	4.38
7,592.0	56.50	269.90	7,384.2	978.3	-141.1	395.0	8.90	8.71	2.26
7,624.0	59.40	270.80	7,401.2	978.4	-168.3	421.2	9.37	9.06	2.81
7,656.0	62.20	271.10	7,416.8	978.9	-196.2	448.3	8.79	8.75	0.94
7,687.0	65.20	271.00	7,430.6	979.4	-224.0	475.2	9.68	9.68	-0.32
7,718.0	69.10	271.10	7,442.6	979.9	-252.5	502.9	12.58	12.58	0.32
7,749.0	72.50	271.70	7,452.8	980.6	-281.8	531.3	11.12	10.97	1.94
7,781.0	76.20	272.00	7,461.4	981.6	-312.6	561.2	11.60	11.56	0.94
7,812.0	78.20	272.50	7,468.3	982.8	-342.8	590.7	6.64	6.45	1.61
7,843.0	80.80	272.40	7,473.9	984.1	-373.2	620.4	8.39	8.39	-0.32
7,880.0	84.60	272.40	7,478.6	985.7	-409.9	656.2	10.27	10.27	0.00
7,942.0	89.30	272.40	7,481.9	988.2	-471.7	716.5	7.58	7.58	0.00
7,973.0	89.90	272.20	7,482.2	989.5	-502.7	746.7	2.04	1.94	-0.65
8,005.0	91.20	272.00	7,481.9	990.7	-534.7	777.8	4.11	4.06	-0.63
8,036.0	90.30	272.20	7,481.5	991.8	-565.7	808.0	2.97	-2.90	0.65
8,067.0	91.60	271.00	7,480.9	992.7	-596.6	838.1	5.71	4.19	-3.87
8,099.0	91.60	269.70	7,480.0	992.9	-628.6	869.0	4.06	0.00	-4.06
8,130.0	91.80	269.40	7,479.1	992.6	-659.6	898.8	1.16	0.65	-0.97
8,161.0	91.20	269.00	7,478.3	992.2	-690.6	928.6	2.33	-1.94	-1.29
8,193.0	91.10	268.30	7,477.7	991.4	-722.6	959.2	2.21	-0.31	-2.19
8,224.0	90.80	267.60	7,477.2	990.3	-753.6	988.8	2.46	-0.97	-2.26
8,256.0	89.90	267.30	7,477.0	988.9	-785.5	1,019.3	2.96	-2.81	-0.94
8,287.0	89.60	267.40	7,477.1	987.5	-816.5	1,048.7	1.02	-0.97	0.32
8,319.0	89.30	268.10	7,477.4	986.2	-848.5	1,079.2	2.38	-0.94	2.19
8,350.0	88.70	268.50	7,477.9	985.3	-879.5	1,108.9	2.33	-1.94	1.29
8,381.0	88.70	268.70	7,478.6	984.5	-910.4	1,138.5	0.64	0.00	0.65
8,413.0	88.90	268.50	7,479.3	983.7	-942.4	1,169.2	0.88	0.63	-0.63
8,444.0	89.70	268.10	7,479.7	982.8	-973.4	1,198.8	2.89	2.58	-1.29
8,476.0	90.20	268.70	7,479.7	981.9	-1,005.4	1,229.4	2.44	1.56	1.88
8,507.0	90.70	268.90	7,479.5	981.3	-1,036.4	1,259.1	1.74	1.61	0.65
8,539.0	90.70	269.90	7,479.1	981.0	-1,068.4	1,289.9	3.12	0.00	3.13
8,570.0	90.60	270.10	7,478.7	981.0	-1,099.4	1,319.8	0.72	-0.32	0.65
8,601.0	90.00	269.70	7,478.6	980.9	-1,130.4	1,349.7	2.33	-1.94	-1.29
8,632.0	90.20	269.00	7,478.5	980.5	-1,161.4	1,379.5	2.35	0.65	-2.26
8,664.0	90.90	268.90	7,478.2	980.0	-1,193.4	1,410.2	2.21	2.19	-0.31
8,695.0	91.30	269.70	7,477.6	979.6	-1,224.4	1,440.0	2.88	1.29	2.58
8,726.0	90.70	269.70	7,477.1	979.4	-1,255.4	1,469.8	1.94	-1.94	0.00
8,758.0	90.60	270.30	7,476.7	979.4	-1,287.4	1,500.7	1.90	-0.31	1.88
8,790.0	90.90	270.30	7,476.3	979.6	-1,319.3	1,531.6	0.94	0.94	0.00
8,821.0	91.00	270.10	7,475.8	979.7	-1,350.3	1,561.5	0.72	0.32	-0.65

Company:	Synergy Resources	Local Co-ordinate Reference:	Well SRC Phelps 11-32NHZ
Project:	SEC.32-T1N-R66W	TVD Reference:	WELL @ 5031.0ft (Ensign Rig #17 RKB - 12')
Site:	SRC Phelps 11-32CHZ Pad Sec.32-T1N-R66W	MD Reference:	WELL @ 5031.0ft (Ensign Rig #17 RKB - 12')
Well:	SRC Phelps 11-32NHZ	North Reference:	True
Wellbore:	Wellbore #1	Survey Calculation Method:	Minimum Curvature
Design:	Wellbore #1	Database:	Landmark

Survey									
Measured Depth (ft)	Inclination (°)	Azimuth (°)	Vertical Depth (ft)	+N/-S (ft)	+E/-W (ft)	Vertical Section (ft)	Dogleg Rate (°/100ft)	Build Rate (°/100ft)	Turn Rate (°/100ft)
8,852.0	90.60	270.10	7,475.3	979.7	-1,381.3	1,591.4	1.29	-1.29	0.00
8,884.0	90.10	270.30	7,475.2	979.9	-1,413.3	1,622.3	1.68	-1.56	0.63
8,915.0	90.50	270.30	7,475.0	980.0	-1,444.3	1,652.2	1.29	1.29	0.00
8,946.0	91.10	270.60	7,474.6	980.3	-1,475.3	1,682.2	2.16	1.94	0.97
8,978.0	90.90	270.40	7,474.0	980.5	-1,507.3	1,713.1	0.88	-0.63	-0.63
9,009.0	89.90	270.40	7,473.8	980.8	-1,538.3	1,743.0	3.23	-3.23	0.00
9,041.0	88.50	271.10	7,474.2	981.2	-1,570.3	1,774.0	4.89	-4.38	2.19
9,073.0	88.70	271.00	7,475.0	981.8	-1,602.3	1,805.0	0.70	0.63	-0.31
9,104.0	89.00	271.10	7,475.6	982.3	-1,633.3	1,835.0	1.02	0.97	0.32
9,135.0	89.40	271.10	7,476.1	982.9	-1,664.3	1,865.1	1.29	1.29	0.00
9,167.0	90.00	271.10	7,476.2	983.5	-1,696.3	1,896.1	1.88	1.88	0.00
9,198.0	90.50	271.10	7,476.1	984.1	-1,727.3	1,926.2	1.61	1.61	0.00
9,229.0	90.70	271.00	7,475.8	984.7	-1,758.3	1,956.2	0.72	0.65	-0.32
9,261.0	90.50	270.80	7,475.4	985.2	-1,790.3	1,987.2	0.88	-0.63	-0.63
9,293.0	89.80	269.60	7,475.4	985.3	-1,822.3	2,018.1	4.34	-2.19	-3.75
9,324.0	90.00	269.00	7,475.4	984.9	-1,853.3	2,047.9	2.04	0.65	-1.94
9,355.0	90.50	269.60	7,475.3	984.6	-1,884.3	2,077.6	2.52	1.61	1.94
9,387.0	89.70	269.40	7,475.2	984.3	-1,916.3	2,108.4	2.58	-2.50	-0.63
9,418.0	89.30	268.50	7,475.5	983.7	-1,947.2	2,138.2	3.18	-1.29	-2.90
9,449.0	90.20	269.20	7,475.6	983.1	-1,978.2	2,167.9	3.68	2.90	2.26
9,481.0	90.80	269.70	7,475.3	982.8	-2,010.2	2,198.7	2.44	1.88	1.56
9,512.0	90.40	269.20	7,475.0	982.5	-2,041.2	2,228.5	2.07	-1.29	-1.61
9,544.0	91.10	269.40	7,474.6	982.1	-2,073.2	2,259.2	2.28	2.19	0.63
9,575.0	91.00	268.90	7,474.0	981.6	-2,104.2	2,289.0	1.64	-0.32	-1.61
9,607.0	90.80	268.70	7,473.5	981.0	-2,136.2	2,319.7	0.88	-0.63	-0.63
9,638.0	90.60	267.30	7,473.2	979.9	-2,167.2	2,349.2	4.56	-0.65	-4.52
9,670.0	89.80	266.40	7,473.0	978.1	-2,199.1	2,379.6	3.76	-2.50	-2.81
9,702.0	89.80	266.60	7,473.2	976.2	-2,231.1	2,409.9	0.62	0.00	0.63
9,733.0	89.80	268.30	7,473.3	974.8	-2,262.0	2,439.4	5.48	0.00	5.48
9,765.0	89.80	269.60	7,473.4	974.2	-2,294.0	2,470.1	4.06	0.00	4.06
9,796.0	90.00	270.80	7,473.4	974.3	-2,325.0	2,500.0	3.92	0.65	3.87
9,827.0	89.70	270.60	7,473.5	974.7	-2,356.0	2,530.0	1.16	-0.97	-0.65
9,859.0	89.40	269.20	7,473.8	974.6	-2,388.0	2,560.8	4.47	-0.94	-4.38
9,891.0	90.10	269.90	7,473.9	974.4	-2,420.0	2,591.6	3.09	2.19	2.19
9,922.0	90.70	270.60	7,473.7	974.5	-2,451.0	2,621.6	2.97	1.94	2.26
9,954.0	90.70	270.60	7,473.3	974.9	-2,483.0	2,652.5	0.00	0.00	0.00
9,985.0	90.90	271.50	7,472.9	975.4	-2,514.0	2,682.5	2.97	0.65	2.90
10,016.0	90.30	271.10	7,472.5	976.1	-2,545.0	2,712.6	2.33	-1.94	-1.29
10,048.0	89.30	271.10	7,472.6	976.7	-2,577.0	2,743.6	3.13	-3.13	0.00
10,079.0	88.30	270.30	7,473.3	977.1	-2,608.0	2,773.6	4.13	-3.23	-2.58
10,111.0	88.70	270.40	7,474.1	977.3	-2,640.0	2,804.5	1.29	1.25	0.31
10,142.0	88.90	269.60	7,474.8	977.3	-2,671.0	2,834.4	2.66	0.65	-2.58
10,174.0	89.30	269.70	7,475.3	977.1	-2,703.0	2,865.2	1.29	1.25	0.31
10,205.0	89.70	270.80	7,475.6	977.3	-2,734.0	2,895.1	3.78	1.29	3.55
10,237.0	89.30	271.00	7,475.8	977.8	-2,766.0	2,926.1	1.40	-1.25	0.63
10,268.0	89.40	270.60	7,476.2	978.2	-2,797.0	2,956.1	1.33	0.32	-1.29
10,300.0	90.20	270.80	7,476.3	978.6	-2,829.0	2,987.1	2.58	2.50	0.63
10,331.0	90.80	270.80	7,476.0	979.0	-2,859.9	3,017.1	1.94	1.94	0.00
10,362.0	91.60	271.10	7,475.4	979.5	-2,890.9	3,047.1	2.76	2.58	0.97
10,394.0	91.50	271.50	7,474.5	980.3	-2,922.9	3,078.1	1.29	-0.31	1.25
10,425.0	90.70	271.80	7,473.9	981.2	-2,953.9	3,108.2	2.76	-2.58	0.97
10,457.0	90.70	271.80	7,473.5	982.2	-2,985.9	3,139.3	0.00	0.00	0.00
10,488.0	90.20	271.80	7,473.3	983.1	-3,016.9	3,169.5	1.61	-1.61	0.00
10,519.0	89.70	271.00	7,473.3	983.9	-3,047.9	3,199.6	3.04	-1.61	-2.58

Company:	Synergy Resources	Local Co-ordinate Reference:	Well SRC Phelps 11-32NHZ
Project:	SEC.32-T1N-R66W	TVD Reference:	WELL @ 5031.0ft (Ensign Rig #17 RKB - 12')
Site:	SRC Phelps 11-32CHZ Pad Sec.32-T1N-R66W	MD Reference:	WELL @ 5031.0ft (Ensign Rig #17 RKB - 12')
Well:	SRC Phelps 11-32NHZ	North Reference:	True
Wellbore:	Wellbore #1	Survey Calculation Method:	Minimum Curvature
Design:	Wellbore #1	Database:	Landmark

Survey

Measured Depth (ft)	Inclination (°)	Azimuth (°)	Vertical Depth (ft)	+N/-S (ft)	+E/-W (ft)	Vertical Section (ft)	Dogleg Rate (°/100ft)	Build Rate (°/100ft)	Turn Rate (°/100ft)
10,550.0	89.30	271.10	7,473.6	984.5	-3,078.8	3,229.6	1.33	-1.29	0.32
10,582.0	88.90	270.80	7,474.1	985.0	-3,110.8	3,260.6	1.56	-1.25	-0.94
10,614.0	89.60	271.30	7,474.5	985.6	-3,142.8	3,291.6	2.69	2.19	1.56
10,645.0	90.70	271.30	7,474.4	986.3	-3,173.8	3,321.7	3.55	3.55	0.00
10,677.0	91.40	270.80	7,473.8	986.9	-3,205.8	3,352.7	2.69	2.19	-1.56
10,708.0	92.20	271.00	7,472.9	987.3	-3,236.8	3,382.7	2.66	2.58	0.65
10,740.0	92.20	270.10	7,471.6	987.7	-3,268.8	3,413.6	2.81	0.00	-2.81
10,772.0	92.20	269.40	7,470.4	987.5	-3,300.7	3,444.4	2.19	0.00	-2.19
10,803.0	92.40	268.30	7,469.2	986.9	-3,331.7	3,474.1	3.60	0.65	-3.55
10,835.0	92.40	266.70	7,467.8	985.5	-3,363.7	3,504.5	5.00	0.00	-5.00
10,866.0	91.50	266.40	7,466.8	983.6	-3,394.6	3,533.9	3.06	-2.90	-0.97
10,898.0	89.20	266.90	7,466.6	981.8	-3,426.5	3,564.2	7.36	-7.19	1.56
10,929.0	87.90	266.20	7,467.4	979.9	-3,457.5	3,593.5	4.76	-4.19	-2.26
10,960.0	88.30	266.40	7,468.4	977.9	-3,488.4	3,622.8	1.44	1.29	0.65
10,992.0	88.70	266.70	7,469.2	976.0	-3,520.3	3,653.1	1.56	1.25	0.94
11,023.0	89.20	268.50	7,469.8	974.7	-3,551.3	3,682.6	6.03	1.61	5.81
11,054.0	89.30	269.40	7,470.2	974.1	-3,582.3	3,712.3	2.92	0.32	2.90
11,085.0	89.00	269.70	7,470.7	973.9	-3,613.3	3,742.2	1.37	-0.97	0.97
11,116.0	90.00	269.90	7,470.9	973.8	-3,644.3	3,772.0	3.29	3.23	0.65
11,148.0	89.90	270.40	7,471.0	973.8	-3,676.3	3,802.9	1.59	-0.31	1.56
11,179.0	90.50	271.10	7,470.8	974.2	-3,707.2	3,832.9	2.97	1.94	2.26
11,211.0	91.40	271.30	7,470.3	974.9	-3,739.2	3,863.9	2.88	2.81	0.63
11,243.0	91.50	271.80	7,469.5	975.8	-3,771.2	3,895.0	1.59	0.31	1.56
11,274.0	90.90	271.00	7,468.9	976.5	-3,802.2	3,925.1	3.23	-1.94	-2.58
11,305.0	92.00	272.20	7,468.1	977.4	-3,833.2	3,955.2	5.25	3.55	3.87
11,337.0	91.50	271.30	7,467.1	978.4	-3,865.1	3,986.3	3.22	-1.56	-2.81
11,368.0	90.30	269.90	7,466.6	978.7	-3,896.1	4,016.2	5.95	-3.87	-4.52
11,399.0	89.30	269.90	7,466.7	978.7	-3,927.1	4,046.1	3.23	-3.23	0.00
11,431.0	89.30	269.90	7,467.1	978.6	-3,959.1	4,077.0	0.00	0.00	0.00
11,463.0	90.10	269.60	7,467.3	978.5	-3,991.1	4,107.8	2.67	2.50	-0.94
11,494.0	90.60	269.40	7,467.1	978.2	-4,022.1	4,137.6	1.74	1.61	-0.65
11,525.0	89.20	269.60	7,467.1	977.9	-4,053.1	4,167.4	4.56	-4.52	0.65
11,557.0	89.20	269.60	7,467.6	977.7	-4,085.1	4,198.2	0.00	0.00	0.00
11,588.0	90.30	270.10	7,467.7	977.6	-4,116.1	4,228.1	3.90	3.55	1.61
11,620.0	89.20	268.70	7,467.9	977.3	-4,148.1	4,258.9	5.56	-3.44	-4.38
11,652.0	88.80	268.70	7,468.4	976.6	-4,180.1	4,289.5	1.25	-1.25	0.00
11,683.0	88.80	268.90	7,469.1	975.9	-4,211.1	4,319.2	0.65	0.00	0.65
11,715.0	89.60	269.00	7,469.5	975.3	-4,243.1	4,349.9	2.52	2.50	0.31
11,746.0	90.40	269.90	7,469.5	975.0	-4,274.1	4,379.7	3.88	2.58	2.90
11,778.0	90.40	270.80	7,469.3	975.2	-4,306.1	4,410.6	2.81	0.00	2.81
11,809.0	90.00	270.80	7,469.2	975.6	-4,337.1	4,440.6	1.29	-1.29	0.00
11,840.0	90.10	269.90	7,469.2	975.8	-4,368.1	4,470.6	2.92	0.32	-2.90
11,872.0	90.70	270.10	7,468.9	975.8	-4,400.1	4,501.4	1.98	1.88	0.63
11,903.0	90.90	270.80	7,468.5	976.1	-4,431.1	4,531.4	2.35	0.65	2.26
11,935.0	89.30	270.10	7,468.4	976.3	-4,463.1	4,562.3	5.46	-5.00	-2.19
11,967.0	88.80	271.10	7,469.0	976.7	-4,495.1	4,593.3	3.49	-1.56	3.13
11,999.0	88.50	271.30	7,469.7	977.3	-4,527.0	4,624.3	1.13	-0.94	0.63
12,054.0	88.50	271.30	7,471.2	978.6	-4,582.0	4,677.6	0.00	0.00	0.00

BHL 790°FNL, 460°FWL

Company:	Synergy Resources	Local Co-ordinate Reference:	Well SRC Phelps 11-32NHZ
Project:	SEC.32-T1N-R66W	TVD Reference:	WELL @ 5031.0ft (Ensign Rig #17 RKB - 12')
Site:	SRC Phelps 11-32CHZ Pad Sec.32-T1N-R66W	MD Reference:	WELL @ 5031.0ft (Ensign Rig #17 RKB - 12')
Well:	SRC Phelps 11-32NHZ	North Reference:	True
Wellbore:	Wellbore #1	Survey Calculation Method:	Minimum Curvature
Design:	Wellbore #1	Database:	Landmark

Checked By: _____	Approved By: _____	Date: _____
-------------------	--------------------	-------------