

LOCATION DRAWING

EWS 1A

SECTION: 26
TOWNSHIP: 8N
RANGE: 60W

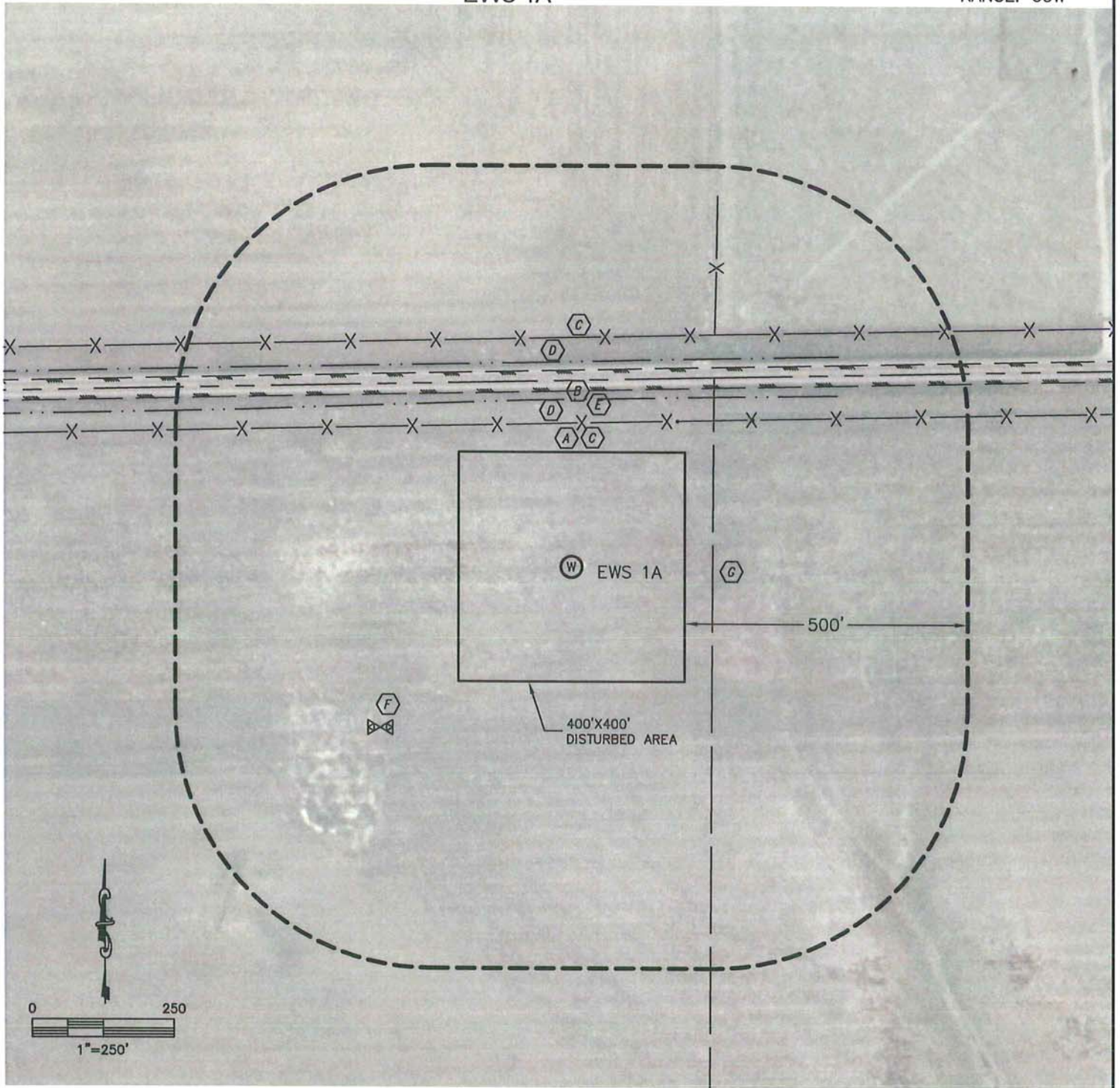

- (A) PROPERTY/RIGHT-OF-WAY LINE 250'N
- (B) SECTION LINE 325'N
- (C) FENCE LINE 250'N, 400'N
- (D) BORROW DITCH 292'N, 358'N
- (E) SOUTH EDGE OF ASPHALT ROAD (HWY14) 306'N
- (F) GAS VALVE 438'SW
- (G) QUARTER-SECTION LINE 249'E

LEGEND

GAS VALVE ABOVE GROUND 