



PHOTO LOCATION: LATITUDE LONGITUDE
 NAD 83: (40° 11' 54.85"N) (109° 01' 48.25"W)

CAMERA ANGLE: NORTH



PHOTO LOCATION: LATITUDE LONGITUDE
 NAD 83: (40° 11' 56.21"N) (109° 01' 48.26"W)

CAMERA ANGLE: SOUTH

RETAMCO OPERATING, INC.

LOCATION PHOTOS

**RETAMCO FEDERAL 3-104-26-9
 LOCATED IN SECTION 26, T3N, R104W,
 6th P.M., RIO BLANCO COUNTY,
 COLORADO.**

TIMBERLINE

(435) 789-1365

ENGINEERING & LAND SURVEYING, INC.
 209 NORTH 300 WEST - VERNAL, UTAH 84078

DATE PHOTOS TAKEN:
 4-29-14

PHOTOS TAKEN BY: N.H.

SHEET NO:

DATE DRAWN:
 5-3-14

DRAWN BY: M.W.W.

1

Date Last Revised:

OF 17

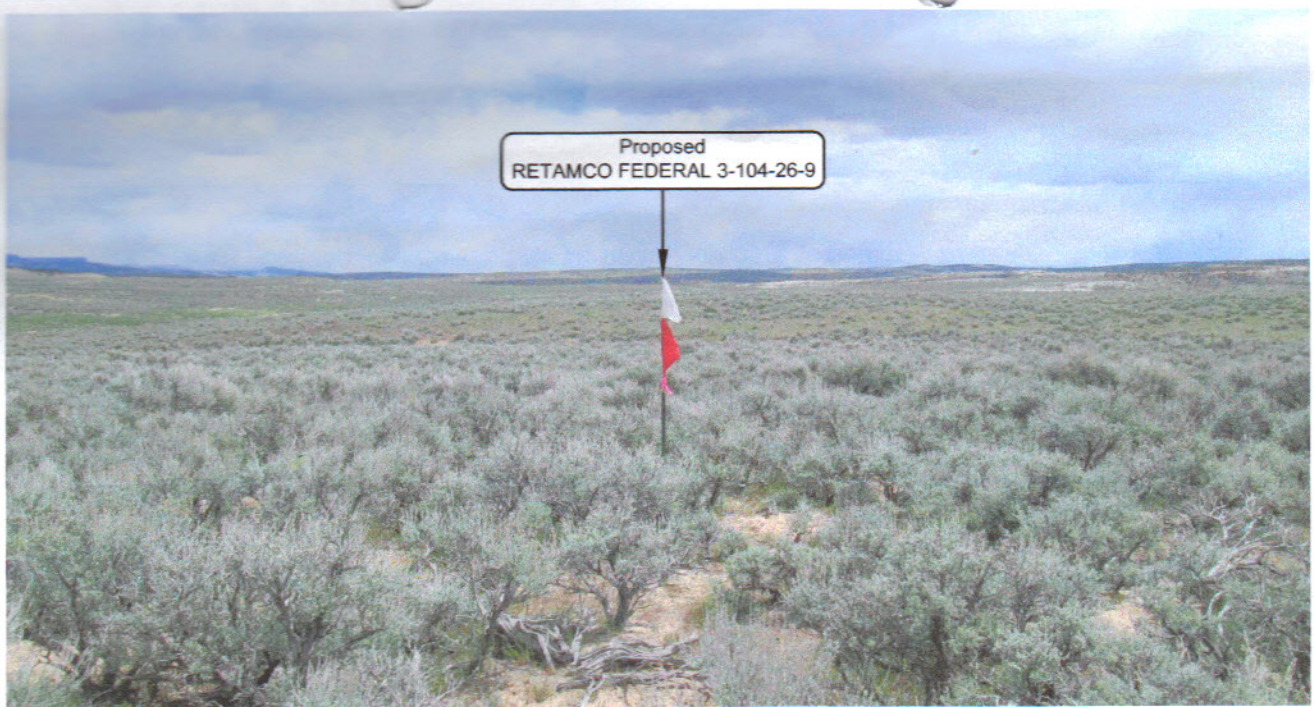

PHOTO LOCATION: LATITUDE LONGITUDE
 NAD 83: (40° 11' 55.53"N) (109° 01' 48.88"W)

CAMERA ANGLE: EAST



PHOTO LOCATION: LATITUDE LONGITUDE
 NAD 83: (40° 11' 55.45"N) (109° 01' 47.57"W)

CAMERA ANGLE: WEST

RETAMCO OPERATING, INC.

LOCATION PHOTOS

**RETAMCO FEDERAL 3-104-26-9
 LOCATED IN SECTION 26, T3N, R104W,
 6th P.M., RIO BLANCO COUNTY,
 COLORADO.**

TIMBERLINE

(435) 789-1365

ENGINEERING & LAND SURVEYING, INC.
 209 NORTH 300 WEST - VERNAL, UTAH 84078

DATE PHOTOS TAKEN: 4-29-14	PHOTOS TAKEN BY: N.H.	SHEET NO: 2 OF 17
DATE DRAWN: 5-3-14	DRAWN BY: M.W.W.	
Date Last Revised:		



PHOTO VIEW: FROM BEGINNING OF PROPOSED ROAD

CAMERA ANGLE: WESTERLY

PHOTO LOCATION: LATITUDE LONGITUDE
 NAD 83: (40° 11' 37.06"N) (109° 01' 04.49"W)

RETAMCO OPERATING, INC.

LOCATION PHOTOS

**RETAMCO FEDERAL 3-104-26-9
 LOCATED IN SECTION 26, T3N, R104W,
 6th P.M., RIO BLANCO COUNTY,
 COLORADO.**

TIMBERLINE

(435) 789-1365

ENGINEERING & LAND SURVEYING, INC.
 209 NORTH 300 WEST - VERNAL, UTAH 84078

DATE PHOTOS TAKEN: 4-29-14	PHOTOS TAKEN BY: N.H.	SHEET NO: 3 OF 17
DATE DRAWN: 5-3-14	DRAWN BY: M.W.W.	
Date Last Revised:		