

T3N, R104W, 6th P.M.

6

5800

5820

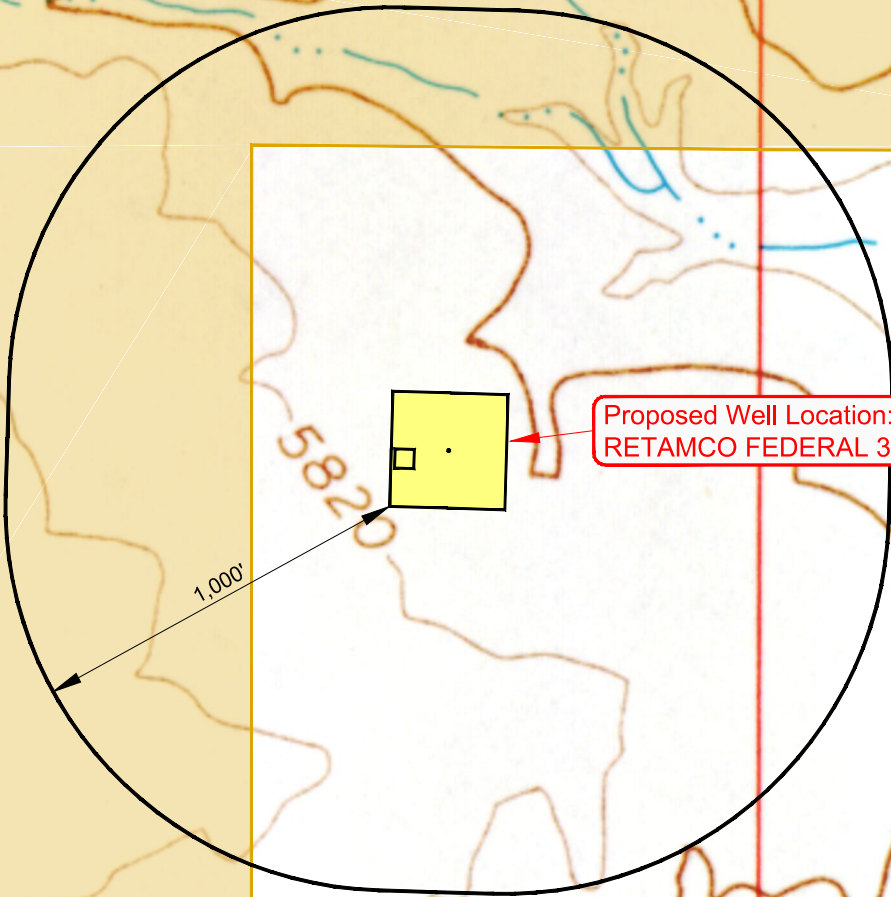

Proposed Well Location:
RETAMCO FEDERAL 3-104-26-9

1,000'

NOTE:
There Are No Surface Waters or
Riparian Areas Within 1,000 Feet of
the Proposed Oil & Gas Location.

Sec. 26

Sec. 25

6

Sec. 35

Sec. 36

□ = FEE □ = B.L.M. LANDS



SCALE

RETAMCO OPERATING, INC.

**RETAMCO FEDERAL 3-104-26-9
SECTION 26, T3N, R104W, 6th P.M.**

HYDROLOGY MAP

DATE SURVEYED: 4-29-14

DATE DRAWN: 5-3-14

SCALE: 1" = 500'

DRAWN BY: M.W.W.

REVISED: 6-18-14 M.W.W.

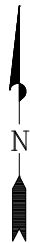

TIMBERLINE

(435) 789-1365

ENGINEERING & LAND SURVEYING, INC.
209 NORTH 300 WEST - VERNAL, UTAH 84078

SHEET
6
OF 17