

Map to Accompany  
OIL AND GAS LOCATION ASSESSMENT

Area Map

EE3 LLC

**Mutual 01-17H**

SHL: 267' FNL 501' FWL (NW/4 NW/4)

Sec. 17 T7N R80W

BHL:  $\pm 625'$  FSL  $\pm 625'$  FEL (SW/4 SE/4)

Sec. 18 T7N R80W

Jackson County, Colorado

Surface: Fee

Mineral Lease: Fee

LEGEND

 Existing Access (Fee) – Off Lease

 State Highway 14

Revised by Upstream Petroleum Management, Inc.

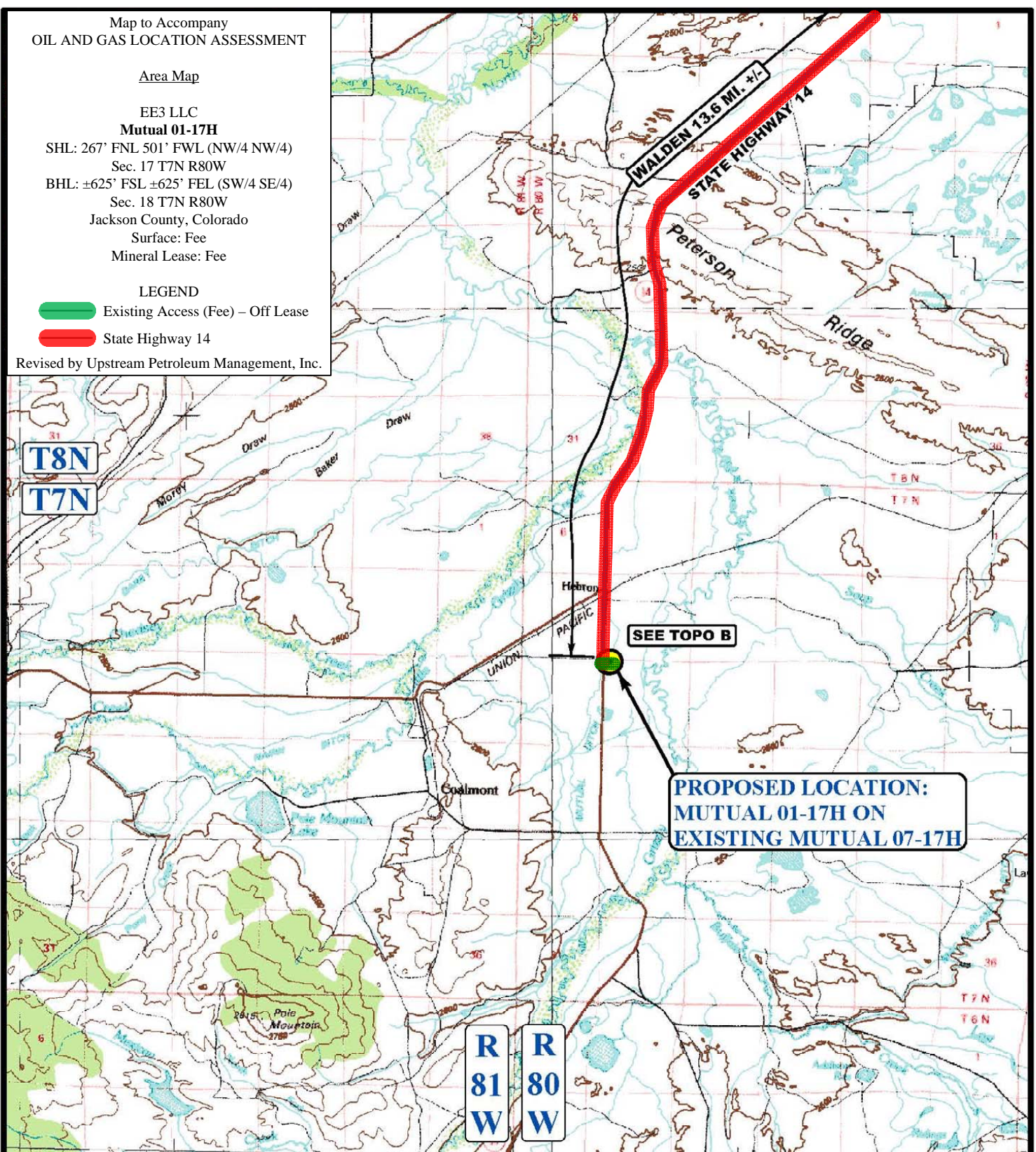

LEGEND:

 PROPOSED LOCATION

EE3 LLC

MUTUAL 01-17H ON EXISTING MUTUAL 07-17H

SECTION 17, T7N, R80W, 6th P.M.

267' FNL 501' FWL



**Uintah Engineering & Land Surveying**

85 South 200 East Vernal, Utah 84078

(435) 789-1017 \* FAX (435) 789-1813

**ACCESS ROAD  
MAP**

**02 24 14**  
MONTH DAY YEAR

SCALE: 1:100,000

DRAWN BY: J.C.

REVISED: 00-00-00

**A**  
TOPO



Map to Accompany  
OIL AND GAS LOCATION ASSESSMENT

Access Road Map

EE3 LLC

**Mutual 01-17H**

SHL: 267' FNL 501' FWL (NW/4 NW/4)

Sec. 17 T7N R80W

BHL:  $\pm 625'$  FSL  $\pm 625'$  FEL (SW/4 SE/4)

Sec. 18 T7N R80W

Jackson County, Colorado

Surface: Fee

Mineral Lease: Fee

LEGEND



 Existing Access (Fee) – Off Lease

 State Highway 14

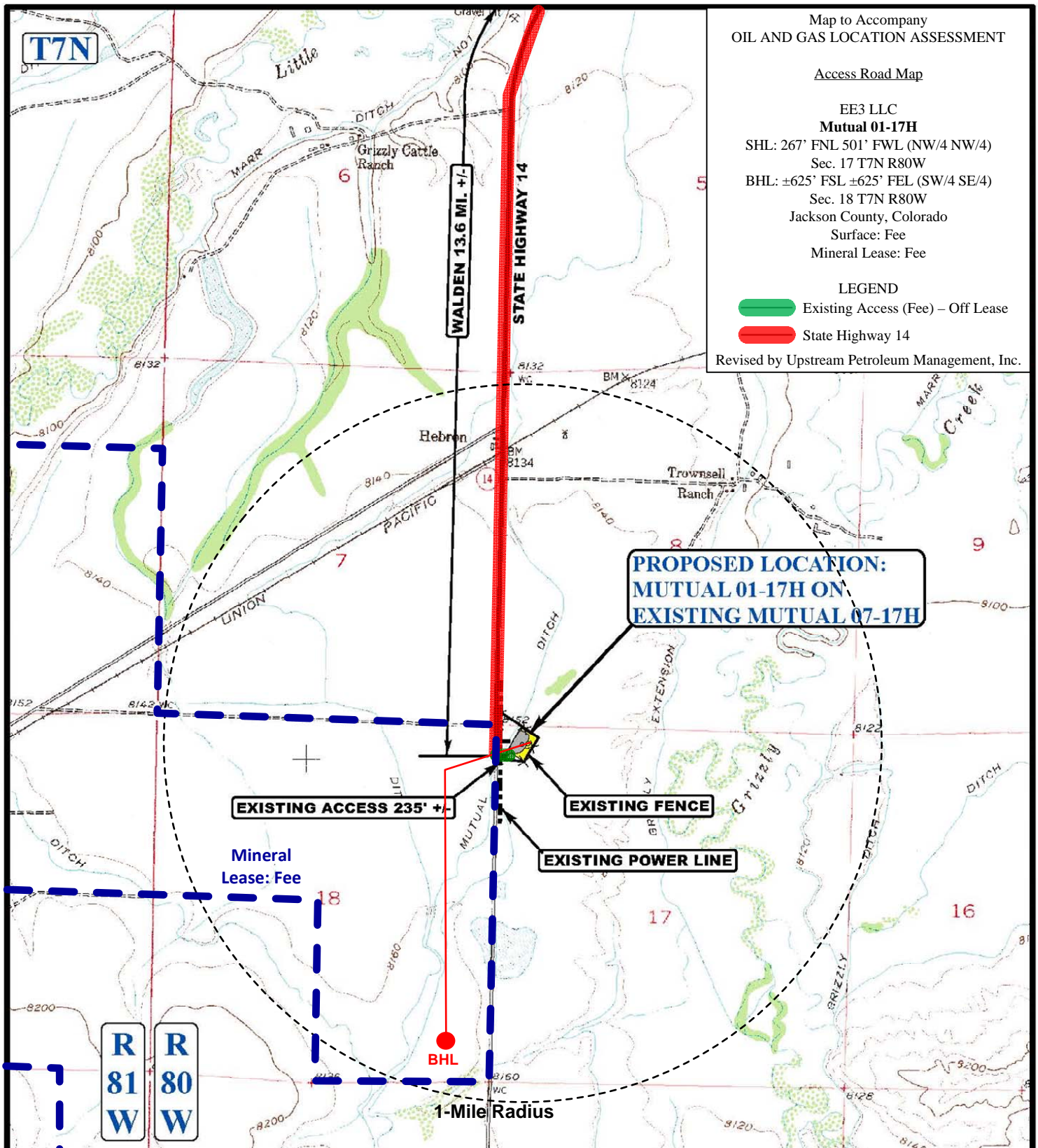
Revised by Upstream Petroleum Management, Inc.



LEGEND:

-  EXISTING ROADS
-  EXISTING FENCE
-  EXISTING POWER LINE



EE3 LLC

**MUTUAL 01-17H ON EXISTING MUTUAL 07-17H**

**SECTION 17, T7N, R80W, 6th P.M.**

**267' FNL 501' FWL**



**Uintah Engineering & Land Surveying**

85 South 200 East Vernal, Utah 84078

(435) 789-1017 \* FAX (435) 789-1813

**ACCESS ROAD  
MAP**

**02 24 14**  
MONTH DAY YEAR

SCALE: 1"=2000'

DRAWN BY: J.C.

REVISED: 00-00-00

