

BONANZA CREEK ENERGY INC.

WELD COUNTY, COLORADO (NAD 83)

NE NW SEC. 6 T4N R62W 6th P.M.

STATE SEVENTY HOLES A-E-6HNB

ORIGINAL WELLBORE

17 June, 2014

Plan: PROPOSAL #1





Project: WELD COUNTY, COLORADO (NAD 83)
Site: NE NW SEC. 6 T4N R62W 6th P.M.
Well: STATE SEVENTY HOLES A-E-6HNB
Wellbore: ORIGINAL WELLBORE
Design: PROPOSAL #1

ANNOTATIONS									
TVD	MD	Inc	Azi	+N/-S	+E/-W	Vsect	Dep	Annotation	
600.0	600.0	0.00	0.00	0.0	0.0	0.0	0.0	START NUDGE (2°/100ft BUR)	
1836.0	1877.9	25.56	295.13	119.1	-253.8	-27.9	280.3	EOB TO 25.56° INC	
4475.7	4804.0	25.56	295.13	655.2	-1396.7	-153.4	1542.8	END OF TANGENT	
5711.7	6082.0	0.00	0.00	774.3	-1650.5	-181.3	1823.1	EOD TO VERTICAL	
5741.7	6112.0	0.00	0.00	774.3	-1650.5	-181.3	1823.1	KOP (12°/100ft BUR)	
6202.9	6737.0	75.00	177.79	420.7	-1636.9	147.7	2177.0	START OF TANGENT	
6228.8	6837.0	75.00	177.79	324.2	-1633.1	237.5	2273.6	END OF TANGENT	
6245.0	6962.0	90.00	177.79	200.7	-1628.4	352.3	2397.2	7" ICP - STATE SEVENTY HOLES A-E-6HNB *NEW*	
6245.0	11308.0	90.00	177.79	-4142.1	-1460.8	4392.2	6743.2	BHL - STATE SEVENTY HOLE A-E-6HNB	

PROPOSED LOCAL COORDINATES:

SHL: 788ft FNL & 1680ft FWL Sec 6

7" ICP *NEW*: 589ft FNL & 60ft FWL Sec 6

BHL: 470ft FSL & 60ft FWL Sec 6

WELLBORE TARGET DETAILS (LAT/LONG)					
Name	TVD	+N/-S	+E/-W	Latitude	Longitude
KOP - STATE SEVENTY HOLES A-E-6HNB	5741.7	774.3	-1650.5	40.349045	-104.377321
7" ICP - STATE SEVENTY HOLES A-E-6HNB *NEW*	6245.0	200.7	-1628.4	40.347471	-104.377242
BHL - STATE SEVENTY HOLES A-E-6HNB	6245.0	-4142.1	-1460.8	40.335550	-104.376640

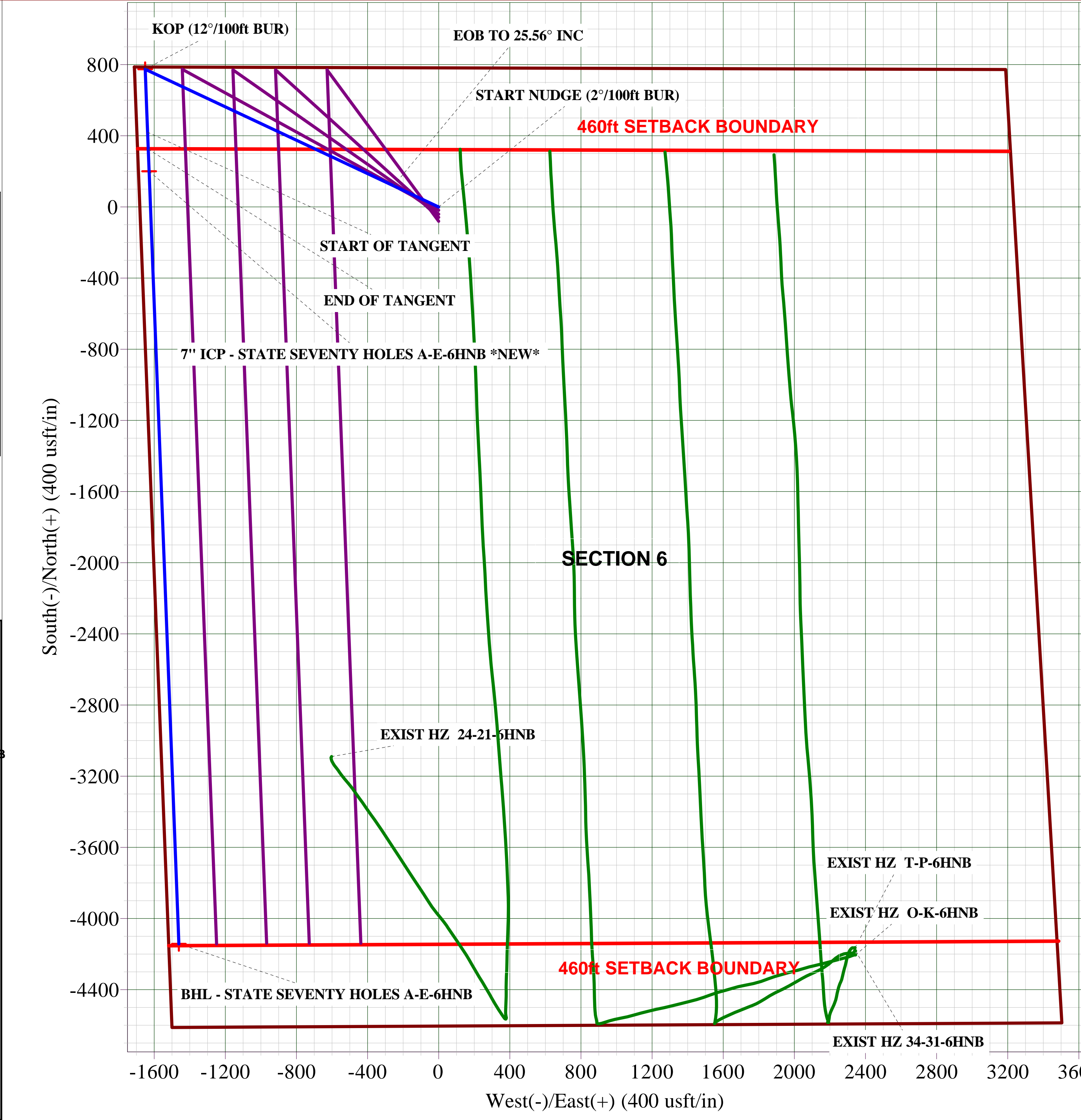
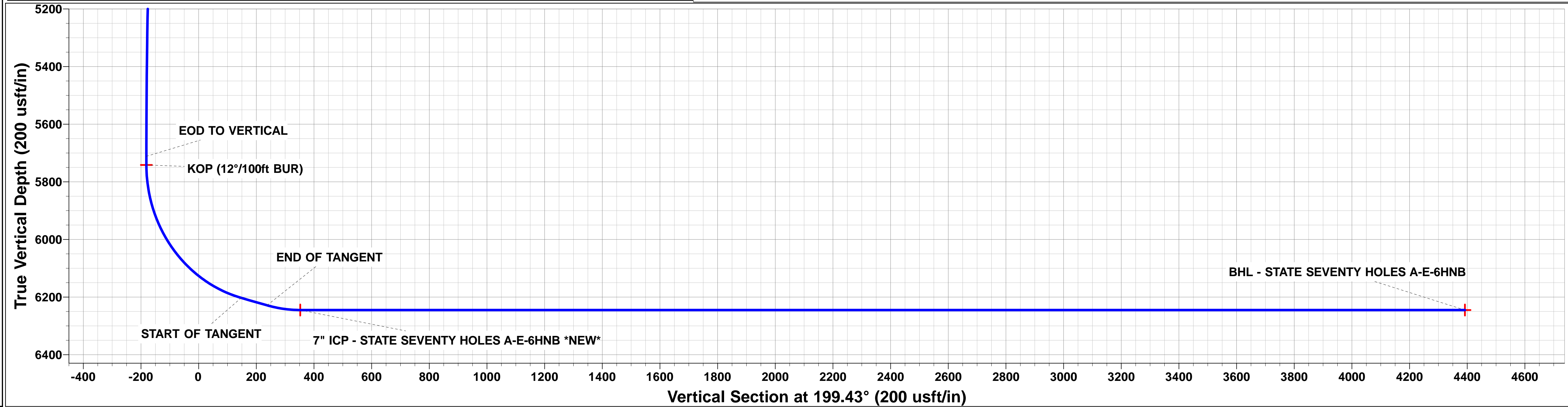
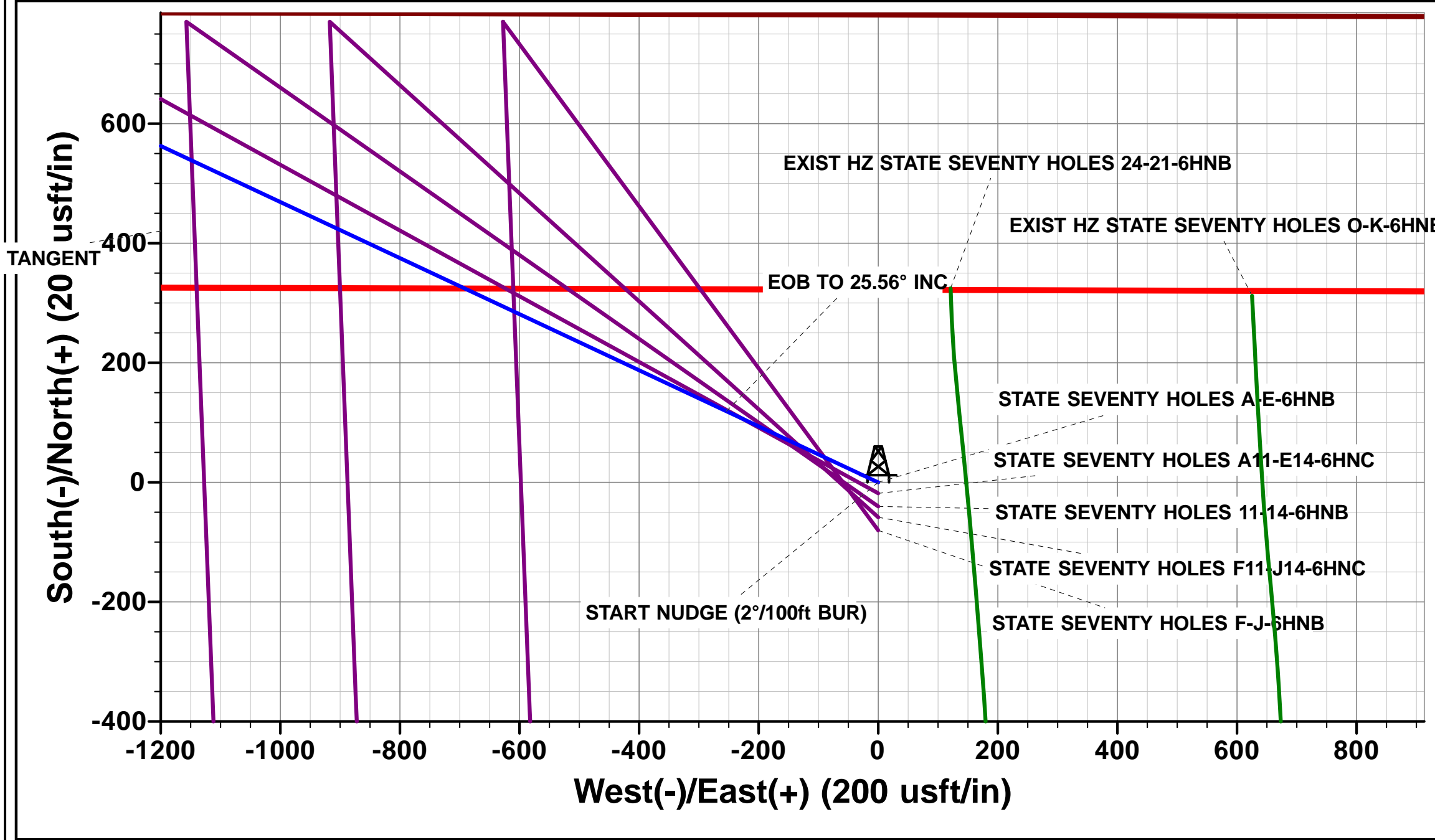
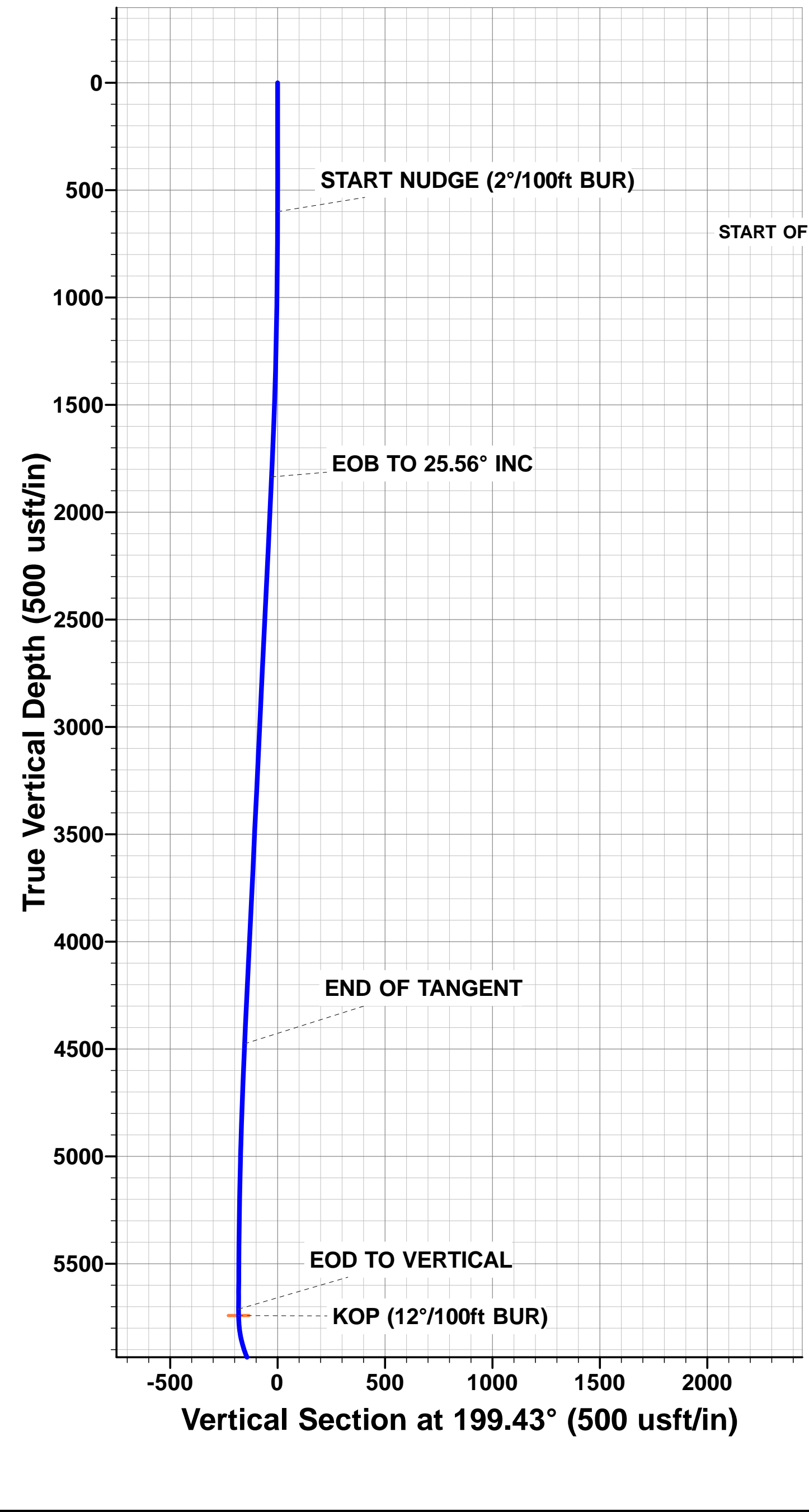

Planning Report



Database:	EDM 5000.1 Single User Db	Local Co-ordinate Reference:	Well STATE SEVENTY HOLES A-E-6HNB
Company:	BONANZA CREEK ENERGY INC.	TVD Reference:	KB-EST @ 4555.0usft (Original Well Elev)
Project:	WELD COUNTY, COLORADO (NAD 83)	MD Reference:	KB-EST @ 4555.0usft (Original Well Elev)
Site:	NE NW SEC. 6 T4N R62W 6th P.M.	North Reference:	True
Well:	STATE SEVENTY HOLES A-E-6HNB	Survey Calculation Method:	Minimum Curvature
Wellbore:	ORIGINAL WELLBORE		
Design:	PROPOSAL #1		

Project	WELD COUNTY, COLORADO (NAD 83)		
Map System:	US State Plane 1983	System Datum:	Mean Sea Level
Geo Datum:	North American Datum 1983		
Map Zone:	Colorado Northern Zone		Using geodetic scale factor

Site	NE NW SEC. 6 T4N R62W 6th P.M.		
Site Position:		Northing:	1,371,225.44 usft
From:	Lat/Long	Easting:	3,314,564.40 usft
Position Uncertainty:	0.0 usft	Slot Radius:	1.10000ft
		Latitude:	40.346920
		Longitude:	-104.371400
		Grid Convergence:	0.73 °

Well	STATE SEVENTY HOLES A-E-6HNB		
Well Position	+N/-S	0.0 usft	Northing: 1,371,225.44 usft
	+E/-W	0.0 usft	Easting: 3,314,564.40 usft
Position Uncertainty	0.0 usft	Wellhead Elevation:	usft
		Latitude:	40.346920
		Longitude:	-104.371400
		Ground Level:	4,538.0 usft

Wellbore	ORIGINAL WELLBORE				
Magnetics	Model Name	Sample Date	Declination (°)	Dip Angle (°)	Field Strength (nT)
	IGRF2010	16/06/2014	8.24	66.97	52,830

Design	PROPOSAL #1			
Audit Notes:				
Version:	Phase:	PROTOTYPE	Tie On Depth:	0.0
Vertical Section:	Depth From (TVD) (usft)	+N/-S (usft)	+E/-W (usft)	Direction (°)
	0.0	0.0	0.0	199.43

Plan Sections											
MD (usft)	Inc (°)	Azi (°)	Vertical Depth	SS (usft)	+N/-S (usft)	+E/-W (usft)	Dogleg Rate (°/100usf)	Build Rate (°/100usf)	Turn Rate (°/100usf)	TFO (°)	Target
0.0	0.00	0.00	0.0	-4,555.0	0.0	0.0	0.00	0.00	0.00	0.00	
600.0	0.00	0.00	600.0	-3,955.0	0.0	0.0	0.00	0.00	0.00	0.00	
1,877.9	25.56	295.13	1,836.0	-2,719.0	119.1	-253.8	2.00	2.00	0.00	295.13	
4,804.0	25.56	295.13	4,475.7	-79.3	655.2	-1,396.7	0.00	0.00	0.00	0.00	
6,082.0	0.00	0.00	5,711.7	1,156.7	774.3	-1,650.5	2.00	-2.00	0.00	180.00	
6,112.0	0.00	0.00	5,741.7	1,186.7	774.3	-1,650.5	0.00	0.00	0.00	0.00	KOP - STATE SEVI
6,737.0	75.00	177.79	6,202.9	1,647.9	420.7	-1,636.9	12.00	12.00	0.00	177.79	
6,837.0	75.00	177.79	6,228.8	1,673.8	324.2	-1,633.1	0.00	0.00	0.00	0.00	
6,962.0	90.00	177.79	6,245.0	1,690.0	200.7	-1,628.4	12.00	12.00	0.00	0.00	
11,308.0	90.00	177.79	6,245.0	1,690.0	-4,142.1	-1,460.8	0.00	0.00	0.00	57.34	BHL - STATE SEVI

Planning Report



Database:	EDM 5000.1 Single User Db	Local Co-ordinate Reference:	Well STATE SEVENTY HOLES A-E-6HNB
Company:	BONANZA CREEK ENERGY INC.	TVD Reference:	KB-EST @ 4555.0usft (Original Well Elev)
Project:	WELD COUNTY, COLORADO (NAD 83)	MD Reference:	KB-EST @ 4555.0usft (Original Well Elev)
Site:	NE NW SEC. 6 T4N R62W 6th P.M.	North Reference:	True
Well:	STATE SEVENTY HOLES A-E-6HNB	Survey Calculation Method:	Minimum Curvature
Wellbore:	ORIGINAL WELLBORE		
Design:	PROPOSAL #1		

Planned Survey

MD (usft)	Inc (°)	Azi (°)	TVD (usft)	SS (usft)	+N/-S (usft)	+E/-W (usft)	Vertical Section (usft)	Dogleg Rate (°/100usft)	Build Rate (°/100usft)	Turn Rate (°/100usft)
0.0	0.00	0.00	0.0	4,555.00	0.0	0.0	0.0	0.00	0.00	0.00
100.0	0.00	0.00	100.0	4,455.00	0.0	0.0	0.0	0.00	0.00	0.00
200.0	0.00	0.00	200.0	4,355.00	0.0	0.0	0.0	0.00	0.00	0.00
300.0	0.00	0.00	300.0	4,255.00	0.0	0.0	0.0	0.00	0.00	0.00
400.0	0.00	0.00	400.0	4,155.00	0.0	0.0	0.0	0.00	0.00	0.00
500.0	0.00	0.00	500.0	4,055.00	0.0	0.0	0.0	0.00	0.00	0.00
START NUDGE (2°/100ft BUR)										
600.0	0.00	0.00	600.0	3,955.00	0.0	0.0	0.0	0.00	0.00	0.00
700.0	2.00	295.13	700.0	3,855.02	0.7	-1.6	-0.2	2.00	2.00	0.00
800.0	4.00	295.13	799.8	3,755.16	3.0	-6.3	-0.7	2.00	2.00	0.00
900.0	6.00	295.13	899.5	3,655.55	6.7	-14.2	-1.6	2.00	2.00	0.00
1,000.0	8.00	295.13	998.7	3,556.30	11.8	-25.2	-2.8	2.00	2.00	0.00
1,100.0	10.00	295.13	1,097.5	3,457.53	18.5	-39.4	-4.3	2.00	2.00	0.00
1,200.0	12.00	295.13	1,195.6	3,359.38	26.6	-56.7	-6.2	2.00	2.00	0.00
1,300.0	14.00	295.13	1,293.1	3,261.94	36.1	-77.0	-8.5	2.00	2.00	0.00
1,400.0	16.00	295.13	1,389.6	3,165.36	47.1	-100.5	-11.0	2.00	2.00	0.00
1,500.0	18.00	295.13	1,485.3	3,069.73	59.6	-126.9	-13.9	2.00	2.00	0.00
1,600.0	20.00	295.13	1,579.8	2,975.18	73.4	-156.4	-17.2	2.00	2.00	0.00
1,700.0	22.00	295.13	1,673.2	2,881.83	88.6	-188.9	-20.7	2.00	2.00	0.00
1,800.0	24.00	295.13	1,765.2	2,789.79	105.2	-224.2	-24.6	2.00	2.00	0.00
EOB TO 25.56° INC										
1,877.9	25.56	295.13	1,836.0	2,719.03	119.1	-253.8	-27.9	2.00	2.00	0.00
1,900.0	25.56	295.13	1,855.9	2,699.12	123.1	-262.4	-28.8	0.00	0.00	0.00
2,000.0	25.56	295.13	1,946.1	2,608.91	141.4	-301.5	-33.1	0.00	0.00	0.00
2,100.0	25.56	295.13	2,036.3	2,518.69	159.8	-340.5	-37.4	0.00	0.00	0.00
2,200.0	25.56	295.13	2,126.5	2,428.48	178.1	-379.6	-41.7	0.00	0.00	0.00
2,300.0	25.56	295.13	2,216.7	2,338.27	196.4	-418.7	-46.0	0.00	0.00	0.00
2,400.0	25.56	295.13	2,306.9	2,248.05	214.7	-457.7	-50.3	0.00	0.00	0.00
2,500.0	25.56	295.13	2,397.2	2,157.84	233.0	-496.8	-54.6	0.00	0.00	0.00
2,600.0	25.56	295.13	2,487.4	2,067.62	251.4	-535.8	-58.8	0.00	0.00	0.00
2,700.0	25.56	295.13	2,577.6	1,977.41	269.7	-574.9	-63.1	0.00	0.00	0.00
2,800.0	25.56	295.13	2,667.8	1,887.19	288.0	-613.9	-67.4	0.00	0.00	0.00
2,900.0	25.56	295.13	2,758.0	1,796.98	306.3	-653.0	-71.7	0.00	0.00	0.00
3,000.0	25.56	295.13	2,848.2	1,706.76	324.7	-692.1	-76.0	0.00	0.00	0.00
3,100.0	25.56	295.13	2,938.4	1,616.55	343.0	-731.1	-80.3	0.00	0.00	0.00
3,200.0	25.56	295.13	3,028.7	1,526.34	361.3	-770.2	-84.6	0.00	0.00	0.00
3,300.0	25.56	295.13	3,118.9	1,436.12	379.6	-809.2	-88.9	0.00	0.00	0.00
3,400.0	25.56	295.13	3,209.1	1,345.91	398.0	-848.3	-93.2	0.00	0.00	0.00
3,500.0	25.56	295.13	3,299.3	1,255.69	416.3	-887.4	-97.5	0.00	0.00	0.00
3,600.0	25.56	295.13	3,389.5	1,165.48	434.6	-926.4	-101.7	0.00	0.00	0.00
3,700.0	25.56	295.13	3,479.7	1,075.26	452.9	-965.5	-106.0	0.00	0.00	0.00
3,800.0	25.56	295.13	3,569.9	985.05	471.3	-1,004.5	-110.3	0.00	0.00	0.00
3,900.0	25.56	295.13	3,660.2	894.84	489.6	-1,043.6	-114.6	0.00	0.00	0.00
4,000.0	25.56	295.13	3,750.4	804.62	507.9	-1,082.7	-118.9	0.00	0.00	0.00
4,100.0	25.56	295.13	3,840.6	714.41	526.2	-1,121.7	-123.2	0.00	0.00	0.00
4,200.0	25.56	295.13	3,930.8	624.19	544.6	-1,160.8	-127.5	0.00	0.00	0.00
4,300.0	25.56	295.13	4,021.0	533.98	562.9	-1,199.8	-131.8	0.00	0.00	0.00
4,400.0	25.56	295.13	4,111.2	443.76	581.2	-1,238.9	-136.1	0.00	0.00	0.00
4,500.0	25.56	295.13	4,201.5	353.55	599.5	-1,278.0	-140.3	0.00	0.00	0.00
4,600.0	25.56	295.13	4,291.7	263.34	617.9	-1,317.0	-144.6	0.00	0.00	0.00
4,700.0	25.56	295.13	4,381.9	173.12	636.2	-1,356.1	-148.9	0.00	0.00	0.00
4,800.0	25.56	295.13	4,472.1	82.91	654.5	-1,395.1	-153.2	0.00	0.00	0.00

END OF TANGENT

Planning Report



Database:	EDM 5000.1 Single User Db	Local Co-ordinate Reference:	Well STATE SEVENTY HOLES A-E-6HNB
Company:	BONANZA CREEK ENERGY INC.	TVD Reference:	KB-EST @ 4555.0usft (Original Well Elev)
Project:	WELD COUNTY, COLORADO (NAD 83)	MD Reference:	KB-EST @ 4555.0usft (Original Well Elev)
Site:	NE NW SEC. 6 T4N R62W 6th P.M.	North Reference:	True
Well:	STATE SEVENTY HOLES A-E-6HNB	Survey Calculation Method:	Minimum Curvature
Wellbore:	ORIGINAL WELLBORE		
Design:	PROPOSAL #1		

Planned Survey

MD (usft)	Inc (°)	Azi (°)	TVD (usft)	SS (usft)	+N/-S (usft)	+E/-W (usft)	Vertical Section (usft)	Dogleg Rate (°/100usft)	Build Rate (°/100usft)	Turn Rate (°/100usft)
4,804.0	25.56	295.13	4,475.7	79.27	655.2	-1,396.7	-153.4	0.00	0.00	0.00
4,900.0	23.64	295.13	4,563.0	-7.98	672.2	-1,432.9	-157.4	2.00	-2.00	0.00
5,000.0	21.64	295.13	4,655.3	-100.27	688.6	-1,467.7	-161.2	2.00	-2.00	0.00
5,100.0	19.64	295.13	4,748.9	-193.85	703.5	-1,499.6	-164.7	2.00	-2.00	0.00
5,200.0	17.64	295.13	4,843.6	-288.60	717.1	-1,528.6	-167.9	2.00	-2.00	0.00
5,300.0	15.64	295.13	4,939.4	-384.41	729.3	-1,554.5	-170.7	2.00	-2.00	0.00
5,400.0	13.64	295.13	5,036.2	-481.16	740.0	-1,577.4	-173.2	2.00	-2.00	0.00
5,500.0	11.64	295.13	5,133.7	-578.73	749.3	-1,597.2	-175.4	2.00	-2.00	0.00
5,600.0	9.64	295.13	5,232.0	-677.01	757.1	-1,613.9	-177.2	2.00	-2.00	0.00
5,700.0	7.64	295.13	5,330.9	-775.87	763.5	-1,627.5	-178.7	2.00	-2.00	0.00
5,800.0	5.64	295.13	5,430.2	-875.19	768.4	-1,637.9	-179.9	2.00	-2.00	0.00
5,900.0	3.64	295.13	5,529.9	-974.86	771.8	-1,645.3	-180.7	2.00	-2.00	0.00
6,000.0	1.64	295.13	5,629.7	-1,074.75	773.8	-1,649.4	-181.1	2.00	-2.00	0.00
EOD TO VERTICAL										
6,082.0	0.00	0.00	5,711.7	-1,156.70	774.3	-1,650.5	-181.3	2.00	-2.00	0.00
6,100.0	0.00	0.00	5,729.7	-1,174.74	774.3	-1,650.5	-181.3	0.00	0.00	0.00
KOP (12°/100ft BUR)										
6,112.0	0.00	0.00	5,741.7	-1,186.70	774.3	-1,650.5	-181.3	0.00	0.00	0.00
6,200.0	10.56	177.79	5,829.2	-1,274.24	766.2	-1,650.2	-173.7	12.00	12.00	0.00
6,300.0	22.56	177.79	5,924.9	-1,369.91	737.8	-1,649.1	-147.3	12.00	12.00	0.00
6,400.0	34.56	177.79	6,012.6	-1,457.58	690.1	-1,647.3	-102.9	12.00	12.00	0.00
6,500.0	46.56	177.79	6,088.4	-1,533.41	625.2	-1,644.7	-42.6	12.00	12.00	0.00
6,600.0	58.56	177.79	6,149.1	-1,594.09	546.0	-1,641.7	31.1	12.00	12.00	0.00
6,700.0	70.56	177.79	6,192.0	-1,636.96	455.9	-1,638.2	114.9	12.00	12.00	0.00
START OF TANGENT										
6,737.0	75.00	177.79	6,202.9	-1,647.90	420.7	-1,636.9	147.7	12.00	12.00	0.00
6,800.0	75.00	177.79	6,219.2	-1,664.21	359.8	-1,634.5	204.3	0.00	0.00	0.00
END OF TANGENT										
6,837.0	75.00	177.79	6,228.8	-1,673.78	324.2	-1,633.1	237.5	0.00	0.00	0.00
6,900.0	82.56	177.79	6,241.0	-1,686.03	262.4	-1,630.7	294.9	12.00	12.00	0.00
7" ICP - STATE SEVENTY HOLES A-E-6HNB *NEW*										
6,962.0	90.00	177.79	6,245.0	-1,690.05	200.7	-1,628.4	352.3	12.00	12.00	0.00
7,000.0	90.00	177.79	6,245.0	-1,690.05	162.7	-1,626.9	387.7	0.00	0.00	0.00
7,100.0	90.00	177.79	6,245.0	-1,690.05	62.7	-1,623.0	480.7	0.00	0.00	0.00
7,200.0	90.00	177.79	6,245.0	-1,690.05	-37.2	-1,619.2	573.6	0.00	0.00	0.00
7,300.0	90.00	177.79	6,245.0	-1,690.05	-137.1	-1,615.3	666.6	0.00	0.00	0.00
7,400.0	90.00	177.79	6,245.0	-1,690.05	-237.0	-1,611.5	759.5	0.00	0.00	0.00
7,500.0	90.00	177.79	6,245.0	-1,690.05	-337.0	-1,607.6	852.5	0.00	0.00	0.00
7,600.0	90.00	177.79	6,245.0	-1,690.05	-436.9	-1,603.8	945.4	0.00	0.00	0.00
7,700.0	90.00	177.79	6,245.0	-1,690.05	-536.8	-1,599.9	1,038.4	0.00	0.00	0.00
7,800.0	90.00	177.79	6,245.0	-1,690.04	-636.7	-1,596.0	1,131.3	0.00	0.00	0.00
7,900.0	90.00	177.79	6,245.0	-1,690.04	-736.7	-1,592.2	1,224.3	0.00	0.00	0.00
8,000.0	90.00	177.79	6,245.0	-1,690.04	-836.6	-1,588.3	1,317.2	0.00	0.00	0.00
8,100.0	90.00	177.79	6,245.0	-1,690.04	-936.5	-1,584.5	1,410.2	0.00	0.00	0.00
8,200.0	90.00	177.79	6,245.0	-1,690.04	-1,036.4	-1,580.6	1,503.2	0.00	0.00	0.00
8,300.0	90.00	177.79	6,245.0	-1,690.04	-1,136.4	-1,576.8	1,596.1	0.00	0.00	0.00
8,400.0	90.00	177.79	6,245.0	-1,690.04	-1,236.3	-1,572.9	1,689.1	0.00	0.00	0.00
8,500.0	90.00	177.79	6,245.0	-1,690.04	-1,336.2	-1,569.1	1,782.0	0.00	0.00	0.00
8,600.0	90.00	177.79	6,245.0	-1,690.04	-1,436.1	-1,565.2	1,875.0	0.00	0.00	0.00
8,700.0	90.00	177.79	6,245.0	-1,690.04	-1,536.1	-1,561.4	1,967.9	0.00	0.00	0.00
8,800.0	90.00	177.79	6,245.0	-1,690.04	-1,636.0	-1,557.5	2,060.9	0.00	0.00	0.00
8,900.0	90.00	177.79	6,245.0	-1,690.04	-1,735.9	-1,553.6	2,153.8	0.00	0.00	0.00
9,000.0	90.00	177.79	6,245.0	-1,690.04	-1,835.9	-1,549.8	2,246.8	0.00	0.00	0.00
9,100.0	90.00	177.79	6,245.0	-1,690.04	-1,935.8	-1,545.9	2,339.7	0.00	0.00	0.00

Planning Report



Database:	EDM 5000.1 Single User Db	Local Co-ordinate Reference:	Well STATE SEVENTY HOLES A-E-6HNB
Company:	BONANZA CREEK ENERGY INC.	TVD Reference:	KB-EST @ 4555.0usft (Original Well Elev)
Project:	WELD COUNTY, COLORADO (NAD 83)	MD Reference:	KB-EST @ 4555.0usft (Original Well Elev)
Site:	NE NW SEC. 6 T4N R62W 6th P.M.	North Reference:	True
Well:	STATE SEVENTY HOLES A-E-6HNB	Survey Calculation Method:	Minimum Curvature
Wellbore:	ORIGINAL WELLBORE		
Design:	PROPOSAL #1		

Planned Survey										
MD (usft)	Inc (°)	Azi (°)	TVD (usft)	SS (usft)	+N/-S (usft)	+E/-W (usft)	Vertical Section (usft)	Dogleg Rate (°/100usft)	Build Rate (°/100usft)	Turn Rate (°/100usft)
9,200.0	90.00	177.79	6,245.0	-1,690.03	-2,035.7	-1,542.1	2,432.7	0.00	0.00	0.00
9,300.0	90.00	177.79	6,245.0	-1,690.03	-2,135.6	-1,538.2	2,525.7	0.00	0.00	0.00
9,400.0	90.00	177.79	6,245.0	-1,690.03	-2,235.6	-1,534.4	2,618.6	0.00	0.00	0.00
9,500.0	90.00	177.79	6,245.0	-1,690.03	-2,335.5	-1,530.5	2,711.6	0.00	0.00	0.00
9,600.0	90.00	177.79	6,245.0	-1,690.03	-2,435.4	-1,526.7	2,804.5	0.00	0.00	0.00
9,700.0	90.00	177.79	6,245.0	-1,690.03	-2,535.3	-1,522.8	2,897.5	0.00	0.00	0.00
9,800.0	90.00	177.79	6,245.0	-1,690.03	-2,635.3	-1,519.0	2,990.4	0.00	0.00	0.00
9,900.0	90.00	177.79	6,245.0	-1,690.03	-2,735.2	-1,515.1	3,083.4	0.00	0.00	0.00
10,000.0	90.00	177.79	6,245.0	-1,690.02	-2,835.1	-1,511.2	3,176.3	0.00	0.00	0.00
10,100.0	90.00	177.79	6,245.0	-1,690.02	-2,935.0	-1,507.4	3,269.3	0.00	0.00	0.00
10,200.0	90.00	177.79	6,245.0	-1,690.02	-3,035.0	-1,503.5	3,362.2	0.00	0.00	0.00
10,300.0	90.00	177.79	6,245.0	-1,690.02	-3,134.9	-1,499.7	3,455.2	0.00	0.00	0.00
10,400.0	90.00	177.79	6,245.0	-1,690.02	-3,234.8	-1,495.8	3,548.2	0.00	0.00	0.00
10,500.0	90.00	177.79	6,245.0	-1,690.02	-3,334.7	-1,492.0	3,641.1	0.00	0.00	0.00
10,600.0	90.00	177.79	6,245.0	-1,690.01	-3,434.7	-1,488.1	3,734.1	0.00	0.00	0.00
10,700.0	90.00	177.79	6,245.0	-1,690.01	-3,534.6	-1,484.3	3,827.0	0.00	0.00	0.00
10,800.0	90.00	177.79	6,245.0	-1,690.01	-3,634.5	-1,480.4	3,920.0	0.00	0.00	0.00
10,900.0	90.00	177.79	6,245.0	-1,690.01	-3,734.4	-1,476.6	4,012.9	0.00	0.00	0.00
11,000.0	90.00	177.79	6,245.0	-1,690.01	-3,834.4	-1,472.7	4,105.9	0.00	0.00	0.00
11,100.0	90.00	177.79	6,245.0	-1,690.00	-3,934.3	-1,468.9	4,198.8	0.00	0.00	0.00
11,200.0	90.00	177.79	6,245.0	-1,690.00	-4,034.2	-1,465.0	4,291.8	0.00	0.00	0.00
11,300.0	90.00	177.79	6,245.0	-1,690.00	-4,134.1	-1,461.2	4,384.8	0.00	0.00	0.00
BHL - STATE SEVENTY HOLE A-E-6HNB										
11,308.0	90.00	177.79	6,245.0	-1,690.00	-4,142.1	-1,460.8	4,392.2	0.00	0.00	0.00

Plan Annotations				
MD (usft)	TVD (usft)	Local Coordinates		Comment
		+N/-S (usft)	+E/-W (usft)	
600.0	600.0	0.0	0.0	START NUDGE (2°/100ft BUR)
1,877.9	1,836.0	119.1	-253.8	EOB TO 25.56° INC
4,804.0	4,475.7	655.2	-1,396.7	END OF TANGENT
6,082.0	5,711.7	774.3	-1,650.5	EOD TO VERTICAL
6,112.0	5,741.7	774.3	-1,650.5	KOP (12°/100ft BUR)
6,737.0	6,202.9	420.7	-1,636.9	START OF TANGENT
6,837.0	6,228.8	324.2	-1,633.1	END OF TANGENT
6,962.0	6,245.0	200.7	-1,628.4	7" ICP - STATE SEVENTY HOLES A-E-6HNB *NEW*
11,308.0	6,245.0	-4,142.1	-1,460.8	BHL - STATE SEVENTY HOLE A-E-6HNB