

EXTRACTION OIL & GAS

Location: COLORADO Slot: SLOT#09 VARRA #9(1537'FSL & 786'FWL,SEC.05)
Field: WELD COUNTY (NAD83/TRUE NORTH) Well: VARRA #9
Facility: SEC.05-T06N-R67W Wellbore: VARRA #9 PWB

Plot reference wellpath is VARRA #9 (REV-A.0) PWP

True vertical depths are referenced to RIG (RKB)	Grid System: NAD83 / Lambert Colorado SP, Northern Zone (501), US feet
Measured depths are referenced to RIG (RKB)	North Reference: True north
RIG (RKB) to Mean Sea Level: 4898 feet	Scale: True distance
Mean Sea Level to Mud line (At Slot: SLOT#09 VARRA #9(1537'FSL & 786'FWL,SEC.05)): 0 feet	Depths are in feet
Coordinates are in feet referenced to Slot	Created by: painsr on 4/29/2014

Location Information

Facility Name			Grid East (US ft)	Grid North (US ft)	Latitude	Longitude
SEC.05-T06N-R67W			3160186.786	1430380.222	40°30'48.118"N	104°55'25.957"W
Slot	Local N (ft)	Local E (ft)	Grid East (US ft)	Grid North (US ft)	Latitude	Longitude
SLOT#09 VARRA #9(1537'FSL & 786'FWL,SEC.05)	-208.07	-1.39	3160186.748	1430172.158	40°30'46.062"N	104°55'25.975"W
RIG (RKB) to Mud line (At Slot: SLOT#09 VARRA #9(1537'FSL & 786'FWL,SEC.05))					4898ft	
Mean Sea Level to Mud line (At Slot: SLOT#09 VARRA #9(1537'FSL & 786'FWL,SEC.05))					0ft	
RIG (RKB) to Mean Sea Level					-4898ft	

Targets

Name	MD (ft)	TVD (ft)	Local N (ft)	Local E (ft)	Grid East (US ft)	Grid North (US ft)	Latitude	Longitude
VARRA PAD SECTION 04		0.00	208.03	1.37	3160186.77	1430380.18	40°30'48.118"N	104°55'25.957"W
VARRA PAD SECTION 05		0.00	208.03	1.37	3160186.77	1430380.18	40°30'48.118"N	104°55'25.957"W
VARRA #9 BHL ON PLAT REV-1(810'FSL & 460'FEL,SEC.04)	17344.17	7276.00	-569.50	9285.07	3169475.00	1429663.01	40°30'40.417"N	104°53'25.764"W
VARRA #9 LANDING POINT	7742.90	7276.00	-548.30	-316.17	3159874.15	1429621.84	40°30'40.644"N	104°55'30.068"W
VARRA PAD SOUTH 1/2 HARDLINE(460'SETBACKS)		7420.00	208.03	1.37	3160186.77	1430380.18	40°30'48.118"N	104°55'25.957"W

Survey Program

Start MD (ft)	End MD (ft)	Tool	Model	Log Name/Comment	Wellbore
24.00	18000.00	NaviTrak	NaviTrak (Standard)		VARRA #9 PWB

Well Profile Data

Design Comment	MD (ft)	Inc (°)	Az (°)	TVD (ft)	Local N (ft)	Local E (ft)	DLS (°/100ft)	VS (ft)
Tie On	24.00	0.000	242.974	24.00	0.00	0.00	0.00	0.00
End of Tangent	800.00	0.000	242.974	800.00	0.00	0.00	0.00	0.00
End of Build	1348.97	10.979	242.974	1345.61	-23.83	-46.71	2.00	-45.16
End of Tangent	6634.50	10.979	242.974	6534.40	-481.25	-943.44	0.00	-912.21
End of 3D Arc	7742.90	90.000	90.127	7276.00	-548.30	-316.17	9.00	-282.01
End of Tangent	17344.17	90.000	90.127	7276.00	-569.50	9285.07	0.00	9302.51

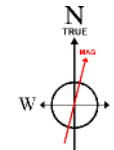
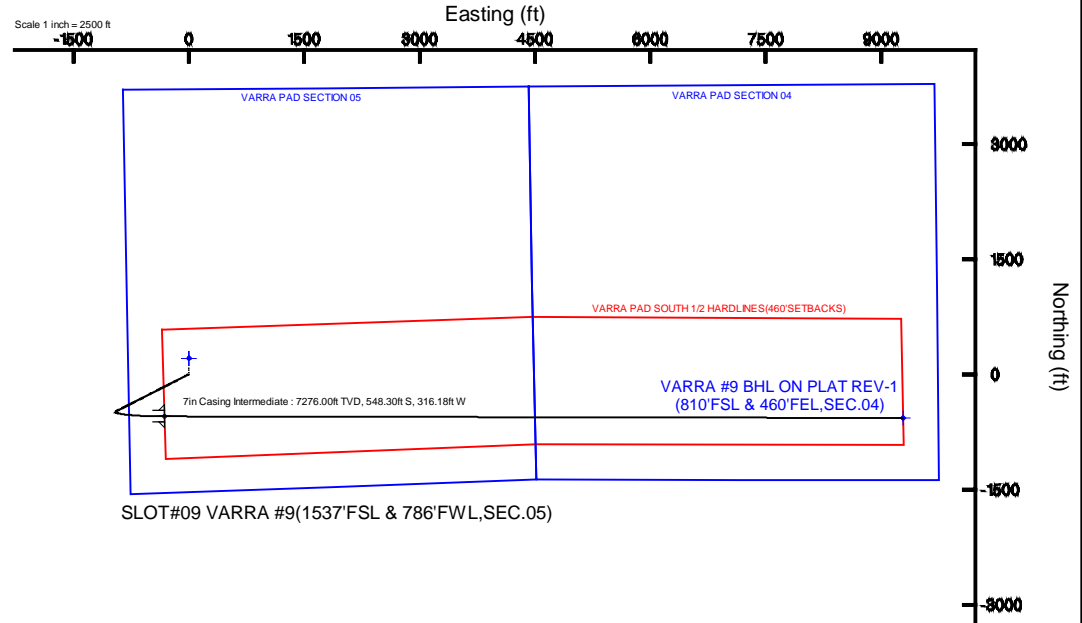

BGGM (1945.0 to 2015.0) Dip: 67.00° Field: 52835.3 nT
Magnetic North is 8.62 degrees East of True North (at 4/17/2014)

To correct azimuth from Magnetic to True add 8.62 degrees

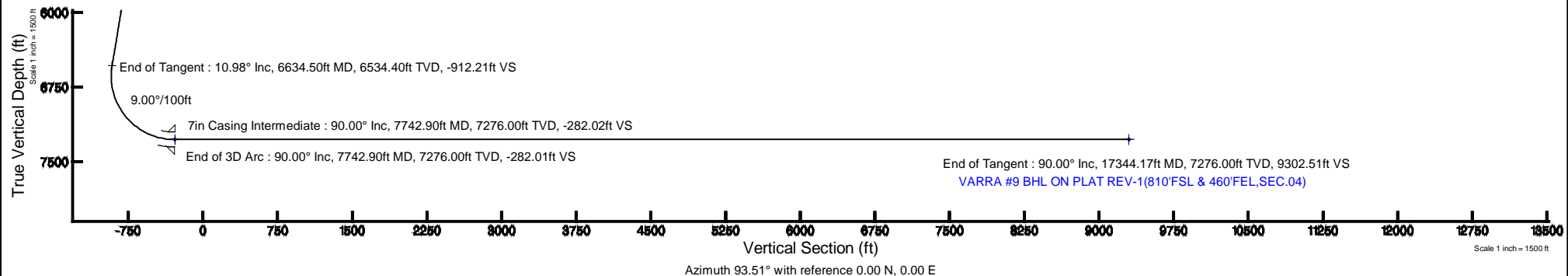



Planned Wellpath Report

VARRA #9 (REV-A.0) PWP

Page 1 of 8



REFERENCE WELLPATH IDENTIFICATION

Operator	EXTRACTION OIL & GAS	Slot	SLOT#09 VARRA #9(1537'FSL & 786'FWL,SEC.05)
Area	COLORADO	Well	VARRA #9
Field	WELD COUNTY (NAD83/TRUE NORTH)	Wellbore	VARRA #9 PWB
Facility	SEC.05-T06N-R67W		

REPORT SETUP INFORMATION

Projection System	NAD83 / Lambert Colorado SP, Northern Zone (501), US feet	Software System	WellArchitect® 4.0.0
North Reference	True	User	Painsetr
Scale	0.999967	Report Generated	4/29/2014 at 2:38:51 PM
Convergence at slot	n/a	Database/Source file	WA_Denver/VARRA_#9_PWB.xml

WELLPATH LOCATION

	Local coordinates		Grid coordinates		Geographic coordinates	
	North[ft]	East[ft]	Easting[US ft]	Northing[US ft]	Latitude	Longitude
Slot Location	-208.07	-1.39	3160186.75	1430172.16	40°30'46.062"N	104°55'25.975"W
Facility Reference Pt			3160186.79	1430380.22	40°30'48.118"N	104°55'25.957"W
Field Reference Pt			3185481.27	1419166.81	40°28'55.560"N	104°49'59.556"W

WELLPATH DATUM

Calculation method	Minimum curvature	RIG (RKB) to Facility Vertical Datum	4898.00ft
Horizontal Reference Pt	Slot	RIG (RKB) to Mean Sea Level	4898.00ft
Vertical Reference Pt	RIG (RKB)	RIG (RKB) to Mud Line at Slot (SLOT#09 VARRA #9(1537'FSL & 786'FWL,SEC.05))	4898.00ft
MD Reference Pt	RIG (RKB)	Section Origin	N 0.00, E 0.00 ft
Field Vertical Reference	Mean Sea Level	Section Azimuth	93.51°



Planned Wellpath Report

VARRA #9 (REV-A.0) PWP

Page 2 of 8



REFERENCE WELLPATH IDENTIFICATION

Operator	EXTRACTION OIL & GAS	Slot	SLOT#09 VARRA #9(1537'FSL & 786'FWL,SEC.05)
Area	COLORADO	Well	VARRA #9
Field	WELD COUNTY (NAD83/TRUE NORTH)	Wellbore	VARRA #9 PWB
Facility	SEC.05-T06N-R67W		

WELLPATH DATA (180 stations) † = interpolated/extrapolated station

MD [ft]	Inclination [°]	Azimuth [°]	TVD [ft]	Vert Sect [ft]	North [ft]	East [ft]	DLS [°/100ft]	Comments
0.00†	0.000	242.974	0.00	0.00	0.00	0.00	0.00	
24.00	0.000	242.974	24.00	0.00	0.00	0.00	0.00	Tie On
124.00†	0.000	242.974	124.00	0.00	0.00	0.00	0.00	
224.00†	0.000	242.974	224.00	0.00	0.00	0.00	0.00	
324.00†	0.000	242.974	324.00	0.00	0.00	0.00	0.00	
424.00†	0.000	242.974	424.00	0.00	0.00	0.00	0.00	
524.00†	0.000	242.974	524.00	0.00	0.00	0.00	0.00	
624.00†	0.000	242.974	624.00	0.00	0.00	0.00	0.00	
724.00†	0.000	242.974	724.00	0.00	0.00	0.00	0.00	
800.00	0.000	242.974	800.00	0.00	0.00	0.00	0.00	End of Tangent
824.00†	0.480	242.974	824.00	-0.09	-0.05	-0.09	2.00	
924.00†	2.480	242.974	923.96	-2.31	-1.22	-2.39	2.00	
1024.00†	4.480	242.974	1023.77	-7.54	-3.98	-7.80	2.00	
1124.00†	6.480	242.974	1123.31	-15.76	-8.32	-16.30	2.00	
1224.00†	8.480	242.974	1222.45	-26.98	-14.23	-27.90	2.00	
1324.00†	10.480	242.974	1321.08	-41.16	-21.72	-42.57	2.00	
1348.97	10.979	242.974	1345.61	-45.16	-23.83	-46.71	2.00	End of Build
1424.00†	10.979	242.974	1419.27	-57.47	-30.32	-59.44	0.00	
1524.00†	10.979	242.974	1517.44	-73.88	-38.98	-76.41	0.00	
1624.00†	10.979	242.974	1615.61	-90.28	-47.63	-93.37	0.00	
1724.00†	10.979	242.974	1713.78	-106.69	-56.28	-110.34	0.00	
1824.00†	10.979	242.974	1811.95	-123.09	-64.94	-127.30	0.00	
1924.00†	10.979	242.974	1910.12	-139.49	-73.59	-144.27	0.00	
2024.00†	10.979	242.974	2008.29	-155.90	-82.25	-161.24	0.00	
2124.00†	10.979	242.974	2106.46	-172.30	-90.90	-178.20	0.00	
2224.00†	10.979	242.974	2204.63	-188.71	-99.56	-195.17	0.00	
2324.00†	10.979	242.974	2302.80	-205.11	-108.21	-212.13	0.00	
2424.00†	10.979	242.974	2400.97	-221.51	-116.86	-229.10	0.00	
2524.00†	10.979	242.974	2499.14	-237.92	-125.52	-246.06	0.00	
2624.00†	10.979	242.974	2597.31	-254.32	-134.17	-263.03	0.00	



Planned Wellpath Report

VARRA #9 (REV-A.0) PWP

Page 3 of 8



REFERENCE WELLPATH IDENTIFICATION

Operator	EXTRACTION OIL & GAS	Slot	SLOT#09 VARRA #9(1537'FSL & 786'FWL,SEC.05)
Area	COLORADO	Well	VARRA #9
Field	WELD COUNTY (NAD83/TRUE NORTH)	Wellbore	VARRA #9 PWB
Facility	SEC.05-T06N-R67W		

WELLPATH DATA (180 stations) † = interpolated/extrapolated station

MD [ft]	Inclination [°]	Azimuth [°]	TVD [ft]	Vert Sect [ft]	North [ft]	East [ft]	DLS [°/100ft]	Comments
2724.00†	10.979	242.974	2695.48	-270.73	-142.83	-279.99	0.00	
2824.00†	10.979	242.974	2793.65	-287.13	-151.48	-296.96	0.00	
2924.00†	10.979	242.974	2891.82	-303.53	-160.14	-313.93	0.00	
3024.00†	10.979	242.974	2989.99	-319.94	-168.79	-330.89	0.00	
3124.00†	10.979	242.974	3088.16	-336.34	-177.44	-347.86	0.00	
3224.00†	10.979	242.974	3186.33	-352.75	-186.10	-364.82	0.00	
3324.00†	10.979	242.974	3284.50	-369.15	-194.75	-381.79	0.00	
3424.00†	10.979	242.974	3382.66	-385.55	-203.41	-398.75	0.00	
3524.00†	10.979	242.974	3480.83	-401.96	-212.06	-415.72	0.00	
3624.00†	10.979	242.974	3579.00	-418.36	-220.72	-432.69	0.00	
3724.00†	10.979	242.974	3677.17	-434.77	-229.37	-449.65	0.00	
3824.00†	10.979	242.974	3775.34	-451.17	-238.02	-466.62	0.00	
3924.00†	10.979	242.974	3873.51	-467.57	-246.68	-483.58	0.00	
4024.00†	10.979	242.974	3971.68	-483.98	-255.33	-500.55	0.00	
4124.00†	10.979	242.974	4069.85	-500.38	-263.99	-517.51	0.00	
4224.00†	10.979	242.974	4168.02	-516.79	-272.64	-534.48	0.00	
4324.00†	10.979	242.974	4266.19	-533.19	-281.30	-551.45	0.00	
4424.00†	10.979	242.974	4364.36	-549.59	-289.95	-568.41	0.00	
4524.00†	10.979	242.974	4462.53	-566.00	-298.60	-585.38	0.00	
4624.00†	10.979	242.974	4560.70	-582.40	-307.26	-602.34	0.00	
4724.00†	10.979	242.974	4658.87	-598.81	-315.91	-619.31	0.00	
4824.00†	10.979	242.974	4757.04	-615.21	-324.57	-636.27	0.00	
4924.00†	10.979	242.974	4855.21	-631.62	-333.22	-653.24	0.00	
5024.00†	10.979	242.974	4953.38	-648.02	-341.88	-670.21	0.00	
5124.00†	10.979	242.974	5051.55	-664.42	-350.53	-687.17	0.00	
5224.00†	10.979	242.974	5149.72	-680.83	-359.18	-704.14	0.00	
5324.00†	10.979	242.974	5247.89	-697.23	-367.84	-721.10	0.00	
5424.00†	10.979	242.974	5346.06	-713.64	-376.49	-738.07	0.00	
5524.00†	10.979	242.974	5444.23	-730.04	-385.15	-755.03	0.00	
5624.00†	10.979	242.974	5542.40	-746.44	-393.80	-772.00	0.00	



Planned Wellpath Report

VARRA #9 (REV-A.0) PWP

Page 4 of 8



REFERENCE WELLPATH IDENTIFICATION

Operator	EXTRACTION OIL & GAS	Slot	SLOT#09 VARRA #9(1537'FSL & 786'FWL,SEC.05)
Area	COLORADO	Well	VARRA #9
Field	WELD COUNTY (NAD83/TRUE NORTH)	Wellbore	VARRA #9 PWB
Facility	SEC.05-T06N-R67W		

WELLPATH DATA (180 stations) † = interpolated/extrapolated station

MD [ft]	Inclination [°]	Azimuth [°]	TVD [ft]	Vert Sect [ft]	North [ft]	East [ft]	DLS [°/100ft]	Comments
5724.00†	10.979	242.974	5640.57	-762.85	-402.46	-788.97	0.00	
5824.00†	10.979	242.974	5738.73	-779.25	-411.11	-805.93	0.00	
5924.00†	10.979	242.974	5836.90	-795.66	-419.76	-822.90	0.00	
6024.00†	10.979	242.974	5935.07	-812.06	-428.42	-839.86	0.00	
6124.00†	10.979	242.974	6033.24	-828.46	-437.07	-856.83	0.00	
6224.00†	10.979	242.974	6131.41	-844.87	-445.73	-873.79	0.00	
6324.00†	10.979	242.974	6229.58	-861.27	-454.38	-890.76	0.00	
6424.00†	10.979	242.974	6327.75	-877.68	-463.04	-907.73	0.00	
6524.00†	10.979	242.974	6425.92	-894.08	-471.69	-924.69	0.00	
6624.00†	10.979	242.974	6524.09	-910.48	-480.34	-941.66	0.00	
6634.50	10.979	242.974	6534.40	-912.21	-481.25	-943.44	0.00	End of Tangent
6724.00†	5.337	198.741	6623.03	-920.65	-489.08	-952.38	9.00	
6824.00†	8.873	124.678	6722.42	-915.27	-497.89	-947.52	9.00	
6924.00†	17.045	106.911	6819.83	-894.37	-506.56	-927.12	9.00	
7024.00†	25.767	100.696	6912.85	-858.47	-514.87	-891.66	9.00	
7124.00†	34.625	97.494	6999.20	-808.46	-522.63	-842.04	9.00	
7224.00†	43.535	95.473	7076.75	-745.57	-529.63	-779.46	9.00	
7324.00†	52.471	94.026	7143.60	-671.35	-535.72	-705.47	9.00	
7424.00†	61.421	92.891	7198.09	-587.62	-540.72	-621.89	9.00	
7524.00†	70.378	91.935	7238.88	-496.45	-544.54	-530.78	9.00	
7624.00†	79.341	91.081	7264.97	-400.08	-547.06	-434.39	9.00	
7724.00†	88.305	90.277	7275.72	-300.88	-548.23	-335.07	9.00	
7742.90	90.000	90.127	7276.00 [†]	-282.01	-548.30	-316.17	9.00	End of 3D Arc
7824.00†	90.000	90.127	7276.00	-201.06	-548.48	-235.08	0.00	
7924.00†	90.000	90.127	7276.00	-101.23	-548.70	-135.08	0.00	
8024.00†	90.000	90.127	7276.00	-1.41	-548.92	-35.08	0.00	
8124.00†	90.000	90.127	7276.00	98.42	-549.14	64.92	0.00	
8224.00†	90.000	90.127	7276.00	198.24	-549.36	164.92	0.00	
8324.00†	90.000	90.127	7276.00	298.07	-549.58	264.92	0.00	
8424.00†	90.000	90.127	7276.00	397.90	-549.80	364.92	0.00	



Planned Wellpath Report

VARRA #9 (REV-A.0) PWP

Page 5 of 8



REFERENCE WELLPATH IDENTIFICATION

Operator	EXTRACTION OIL & GAS	Slot	SLOT#09 VARRA #9(1537'FSL & 786'FWL,SEC.05)
Area	COLORADO	Well	VARRA #9
Field	WELD COUNTY (NAD83/TRUE NORTH)	Wellbore	VARRA #9 PWB
Facility	SEC.05-T06N-R67W		

WELLPATH DATA (180 stations) † = interpolated/extrapolated station

MD [ft]	Inclination [°]	Azimuth [°]	TVD [ft]	Vert Sect [ft]	North [ft]	East [ft]	DLS [°/100ft]	Comments
8524.00†	90.000	90.127	7276.00	497.72	-550.02	464.92	0.00	
8624.00†	90.000	90.127	7276.00	597.55	-550.24	564.92	0.00	
8724.00†	90.000	90.127	7276.00	697.37	-550.47	664.92	0.00	
8824.00†	90.000	90.127	7276.00	797.20	-550.69	764.92	0.00	
8924.00†	90.000	90.127	7276.00	897.02	-550.91	864.92	0.00	
9024.00†	90.000	90.127	7276.00	996.85	-551.13	964.92	0.00	
9124.00†	90.000	90.127	7276.00	1096.68	-551.35	1064.92	0.00	
9224.00†	90.000	90.127	7276.00	1196.50	-551.57	1164.92	0.00	
9324.00†	90.000	90.127	7276.00	1296.33	-551.79	1264.92	0.00	
9424.00†	90.000	90.127	7276.00	1396.15	-552.01	1364.92	0.00	
9524.00†	90.000	90.127	7276.00	1495.98	-552.23	1464.92	0.00	
9624.00†	90.000	90.127	7276.00	1595.80	-552.45	1564.92	0.00	
9724.00†	90.000	90.127	7276.00	1695.63	-552.67	1664.92	0.00	
9824.00†	90.000	90.127	7276.00	1795.46	-552.89	1764.92	0.00	
9924.00†	90.000	90.127	7276.00	1895.28	-553.12	1864.92	0.00	
10024.00†	90.000	90.127	7276.00	1995.11	-553.34	1964.92	0.00	
10124.00†	90.000	90.127	7276.00	2094.93	-553.56	2064.92	0.00	
10224.00†	90.000	90.127	7276.00	2194.76	-553.78	2164.92	0.00	
10324.00†	90.000	90.127	7276.00	2294.58	-554.00	2264.92	0.00	
10424.00†	90.000	90.127	7276.00	2394.41	-554.22	2364.92	0.00	
10524.00†	90.000	90.127	7276.00	2494.24	-554.44	2464.92	0.00	
10624.00†	90.000	90.127	7276.00	2594.06	-554.66	2564.92	0.00	
10724.00†	90.000	90.127	7276.00	2693.89	-554.88	2664.91	0.00	
10824.00†	90.000	90.127	7276.00	2793.71	-555.10	2764.91	0.00	
10924.00†	90.000	90.127	7276.00	2893.54	-555.32	2864.91	0.00	
11024.00†	90.000	90.127	7276.00	2993.36	-555.55	2964.91	0.00	
11124.00†	90.000	90.127	7276.00	3093.19	-555.77	3064.91	0.00	
11224.00†	90.000	90.127	7276.00	3193.02	-555.99	3164.91	0.00	
11324.00†	90.000	90.127	7276.00	3292.84	-556.21	3264.91	0.00	
11424.00†	90.000	90.127	7276.00	3392.67	-556.43	3364.91	0.00	



Planned Wellpath Report

VARRA #9 (REV-A.0) PWP

Page 6 of 8



REFERENCE WELLPATH IDENTIFICATION

Operator	EXTRACTION OIL & GAS	Slot	SLOT#09 VARRA #9(1537'FSL & 786'FWL,SEC.05)
Area	COLORADO	Well	VARRA #9
Field	WELD COUNTY (NAD83/TRUE NORTH)	Wellbore	VARRA #9 PWB
Facility	SEC.05-T06N-R67W		

WELLPATH DATA (180 stations) † = interpolated/extrapolated station

MD [ft]	Inclination [°]	Azimuth [°]	TVD [ft]	Vert Sect [ft]	North [ft]	East [ft]	DLS [°/100ft]	Comments
11524.00†	90.000	90.127	7276.00	3492.49	-556.65	3464.91	0.00	
11624.00†	90.000	90.127	7276.00	3592.32	-556.87	3564.91	0.00	
11724.00†	90.000	90.127	7276.00	3692.14	-557.09	3664.91	0.00	
11824.00†	90.000	90.127	7276.00	3791.97	-557.31	3764.91	0.00	
11924.00†	90.000	90.127	7276.00	3891.79	-557.53	3864.91	0.00	
12024.00†	90.000	90.127	7276.00	3991.62	-557.75	3964.91	0.00	
12124.00†	90.000	90.127	7276.00	4091.45	-557.97	4064.91	0.00	
12224.00†	90.000	90.127	7276.00	4191.27	-558.20	4164.91	0.00	
12324.00†	90.000	90.127	7276.00	4291.10	-558.42	4264.91	0.00	
12424.00†	90.000	90.127	7276.00	4390.92	-558.64	4364.91	0.00	
12524.00†	90.000	90.127	7276.00	4490.75	-558.86	4464.91	0.00	
12624.00†	90.000	90.127	7276.00	4590.57	-559.08	4564.91	0.00	
12724.00†	90.000	90.127	7276.00	4690.40	-559.30	4664.91	0.00	
12824.00†	90.000	90.127	7276.00	4790.23	-559.52	4764.91	0.00	
12924.00†	90.000	90.127	7276.00	4890.05	-559.74	4864.91	0.00	
13024.00†	90.000	90.127	7276.00	4989.88	-559.96	4964.91	0.00	
13124.00†	90.000	90.127	7276.00	5089.70	-560.18	5064.91	0.00	
13224.00†	90.000	90.127	7276.00	5189.53	-560.40	5164.91	0.00	
13324.00†	90.000	90.127	7276.00	5289.35	-560.63	5264.91	0.00	
13424.00†	90.000	90.127	7276.00	5389.18	-560.85	5364.91	0.00	
13524.00†	90.000	90.127	7276.00	5489.01	-561.07	5464.91	0.00	
13624.00†	90.000	90.127	7276.00	5588.83	-561.29	5564.91	0.00	
13724.00†	90.000	90.127	7276.00	5688.66	-561.51	5664.91	0.00	
13824.00†	90.000	90.127	7276.00	5788.48	-561.73	5764.91	0.00	
13924.00†	90.000	90.127	7276.00	5888.31	-561.95	5864.91	0.00	
14024.00†	90.000	90.127	7276.00	5988.13	-562.17	5964.91	0.00	
14124.00†	90.000	90.127	7276.00	6087.96	-562.39	6064.91	0.00	
14224.00†	90.000	90.127	7276.00	6187.79	-562.61	6164.91	0.00	
14324.00†	90.000	90.127	7276.00	6287.61	-562.83	6264.91	0.00	
14424.00†	90.000	90.127	7276.00	6387.44	-563.05	6364.91	0.00	



Planned Wellpath Report

VARRA #9 (REV-A.0) PWP

Page 7 of 8



REFERENCE WELLPATH IDENTIFICATION			
Operator	EXTRACTION OIL & GAS	Slot	SLOT#09 VARRA #9(1537'FSL & 786'FWL,SEC.05)
Area	COLORADO	Well	VARRA #9
Field	WELD COUNTY (NAD83/TRUE NORTH)	Wellbore	VARRA #9 PWB
Facility	SEC.05-T06N-R67W		

WELLPATH DATA (180 stations) † = interpolated/extrapolated station								
MD [ft]	Inclination [°]	Azimuth [°]	TVD [ft]	Vert Sect [ft]	North [ft]	East [ft]	DLS [°/100ft]	Comments
14524.00†	90.000	90.127	7276.00	6487.26	-563.28	6464.91	0.00	
14624.00†	90.000	90.127	7276.00	6587.09	-563.50	6564.91	0.00	
14724.00†	90.000	90.127	7276.00	6686.91	-563.72	6664.91	0.00	
14824.00†	90.000	90.127	7276.00	6786.74	-563.94	6764.90	0.00	
14924.00†	90.000	90.127	7276.00	6886.57	-564.16	6864.90	0.00	
15024.00†	90.000	90.127	7276.00	6986.39	-564.38	6964.90	0.00	
15124.00†	90.000	90.127	7276.00	7086.22	-564.60	7064.90	0.00	
15224.00†	90.000	90.127	7276.00	7186.04	-564.82	7164.90	0.00	
15324.00†	90.000	90.127	7276.00	7285.87	-565.04	7264.90	0.00	
15424.00†	90.000	90.127	7276.00	7385.69	-565.26	7364.90	0.00	
15524.00†	90.000	90.127	7276.00	7485.52	-565.48	7464.90	0.00	
15624.00†	90.000	90.127	7276.00	7585.35	-565.70	7564.90	0.00	
15724.00†	90.000	90.127	7276.00	7685.17	-565.93	7664.90	0.00	
15824.00†	90.000	90.127	7276.00	7785.00	-566.15	7764.90	0.00	
15924.00†	90.000	90.127	7276.00	7884.82	-566.37	7864.90	0.00	
16024.00†	90.000	90.127	7276.00	7984.65	-566.59	7964.90	0.00	
16124.00†	90.000	90.127	7276.00	8084.47	-566.81	8064.90	0.00	
16224.00†	90.000	90.127	7276.00	8184.30	-567.03	8164.90	0.00	
16324.00†	90.000	90.127	7276.00	8284.13	-567.25	8264.90	0.00	
16424.00†	90.000	90.127	7276.00	8383.95	-567.47	8364.90	0.00	
16524.00†	90.000	90.127	7276.00	8483.78	-567.69	8464.90	0.00	
16624.00†	90.000	90.127	7276.00	8583.60	-567.91	8564.90	0.00	
16724.00†	90.000	90.127	7276.00	8683.43	-568.13	8664.90	0.00	
16824.00†	90.000	90.127	7276.00	8783.25	-568.36	8764.90	0.00	
16924.00†	90.000	90.127	7276.00	8883.08	-568.58	8864.90	0.00	
17024.00†	90.000	90.127	7276.00	8982.91	-568.80	8964.90	0.00	
17124.00†	90.000	90.127	7276.00	9082.73	-569.02	9064.90	0.00	
17224.00†	90.000	90.127	7276.00	9182.56	-569.24	9164.90	0.00	
17324.00†	90.000	90.127	7276.00	9282.38	-569.46	9264.90	0.00	
17344.17	90.000	90.127	7276.00 ²	9302.51	-569.50	9285.07	0.00	End of Tangent



Planned Wellpath Report

VARRA #9 (REV-A.0) PWP

Page 8 of 8



REFERENCE WELLPATH IDENTIFICATION

Operator	EXTRACTION OIL & GAS	Slot	SLOT#09 VARRA #9(1537'FSL & 786'FWL,SEC.05)
Area	COLORADO	Well	VARRA #9
Field	WELD COUNTY (NAD83/TRUE NORTH)	Wellbore	VARRA #9 PWB
Facility	SEC.05-T06N-R67W		

HOLE & CASING SECTIONS - Ref Wellbore: VARRA #9 PWB Ref Wellpath: VARRA #9 (REV-A.0) PWP

String/Diameter	Start MD [ft]	End MD [ft]	Interval [ft]	Start TVD [ft]	End TVD [ft]	Start N/S [ft]	Start E/W [ft]	End N/S [ft]	End E/W [ft]
7in Casing Intermediate	24.00	7742.90	7718.90	24.00	7276.00	0.00	0.00	-548.30	-316.18

TARGETS

Name	MD [ft]	TVD [ft]	North [ft]	East [ft]	Grid East [US ft]	Grid North [US ft]	Latitude	Longitude	Shape
VARRA PAD SECTION 04		0.00	208.03	1.37	3160186.77	1430380.18	40°30'48.118"N	104°55'25.957"W	polygon
VARRA PAD SECTION 05		0.00	208.03	1.37	3160186.77	1430380.18	40°30'48.118"N	104°55'25.957"W	polygon
2) VARRA #9 BHL ON PLAT REV-1(810'FSL & 460'FEL,SEC.04)	17344.17	7276.00	-569.50	9285.07	3169475.00	1429663.01	40°30'40.417"N	104°53'25.764"W	point
1) VARRA #9 LANDING POINT	7742.90	7276.00	-548.30	-316.17	3159874.15	1429621.84	40°30'40.644"N	104°55'30.068"W	point
VARRA PAD SOUTH 1/2 HARDLINES(460'SETBACKS)		7420.00	208.03	1.37	3160186.77	1430380.18	40°30'48.118"N	104°55'25.957"W	polygon

SURVEY PROGRAM - Ref Wellbore: VARRA #9 PWB Ref Wellpath: VARRA #9 (REV-A.0) PWP

Start MD [ft]	End MD [ft]	Positional Uncertainty Model	Log Name/Comment	Wellbore
24.00	18000.00	NaviTrak (Standard)		VARRA #9 PWB