

EXTRACTION OIL & GAS

Location: COLORADO Slot: SLOT#06 VARRA #6(1615'FSL & 788'FWL,SEC.05)
Field: WELD COUNTY (NAD83/TRUE NORTH) Well: VARRA #6
Facility: SEC.05-T06N-R67W Wellbore: VARRA #6 PWB

Plot reference wellpath is VARRA #6 (REV-A.0) PWP

True vertical depths are referenced to RIG (RKB)	Grid System: NAD83 / Lambert Colorado SP, Northern Zone (501), US feet
Measured depths are referenced to RIG (RKB)	North Reference: True north
RIG (RKB) to Mean Sea Level: 4898 feet	Scale: True distance
Mean Sea Level to Mud line (At Slot: SLOT#06 VARRA #6(1615'FSL & 788'FWL,SEC.05)): 0 feet	Depths are in feet
Coordinates are in feet referenced to Slot	Created by: painsetr on 4/29/2014

Location Information

Facility Name			Grid East (US ft)	Grid North (US ft)	Latitude	Longitude
SEC.05-T06N-R67W			3160186.786	1430380.222	40°30'48.118"N	104°55'25.957"W
Slot	Local N (ft)	Local E (ft)	Grid East (US ft)	Grid North (US ft)	Latitude	Longitude
SLOT#06 VARRA #6(1615'FSL & 788'FWL,SEC.05)	-130.14	-0.85	3160186.782	1430250.081	40°30'46.832"N	104°55'25.968"W
RIG (RKB) to Mud line (At Slot: SLOT#06 VARRA #6(1615'FSL & 788'FWL,SEC.05))					4898ft	
Mean Sea Level to Mud line (At Slot: SLOT#06 VARRA #6(1615'FSL & 788'FWL,SEC.05))					0ft	
RIG (RKB) to Mean Sea Level					4898ft	

Targets

Name	MD (ft)	TVD (ft)	Local N (ft)	Local E (ft)	Grid East (US ft)	Grid North (US ft)	Latitude	Longitude
VARRA PAD SECTION 04		0.00	130.10	0.83	3160186.77	1430380.18	40°30'48.118"N	104°55'25.957"W
VARRA PAD SECTION 05		0.00	130.10	0.83	3160186.77	1430380.18	40°30'48.118"N	104°55'25.957"W
VARRA #6 BHL ON PLAT REV-1(1460'FSL & 460'FEL,SEC.04)	17326.67	7276.00	2.51	9276.22	3169462.47	1430312.86	40°30'46.840"N	104°53'25.868"W
VARRA #6 LANDING POINT	7721.49	7276.00	23.72	-328.94	3159857.71	1430271.67	40°30'47.066"N	104°55'30.227"W
VARRA PAD SOUTH 1/2 HARDLINES(460'SETBACKS)		7420.00	130.10	0.83	3160186.77	1430380.18	40°30'48.118"N	104°55'25.957"W

Survey Program

Start MD (ft)	End MD (ft)	Tool	Model	Log Name/Comment	Wellbore
24.00	18000.00	NaviTrak	NaviTrak (Standard)		VARRA #6 PWB

Well Profile Data

Design Comment	MD (ft)	Inc (°)	Az (°)	TVD (ft)	Local N (ft)	Local E (ft)	DLS (°/100ft)	VS (ft)
Tie On	24.00	0.000	271.339	24.00	0.00	0.00	0.00	0.00
End of Tangent	800.00	0.000	271.339	800.00	0.00	0.00	0.00	0.00
End of Build	1294.80	9.896	271.339	1292.34	1.00	-42.61	2.00	-42.61
End of Tangent	6611.56	9.896	271.339	6530.00	22.35	-956.10	0.00	-956.09
End of 3D Arc	7721.49	90.000	90.127	7276.00	23.72	-328.94	9.00	-328.93
End of Tangent	17326.67	90.000	90.127	7276.00	2.51	9276.22	0.00	9276.22

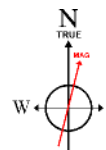
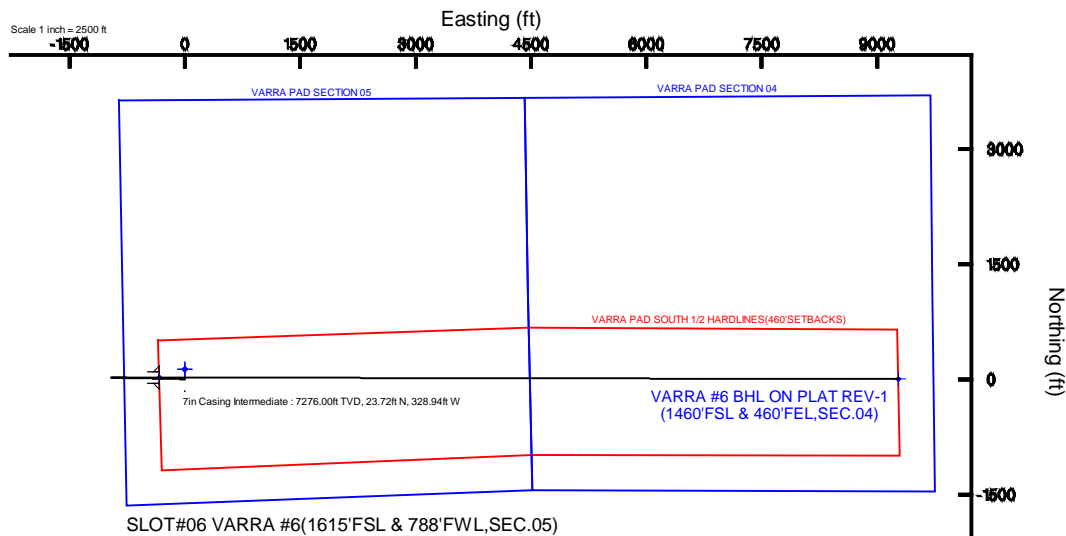

BGGM (1945.0 to 2015.0) Dip: 67.00° Field: 52835.3 nT
Magnetic North is 8.62 degrees East of True North (at 4/17/2014)

To correct azimuth from Magnetic to True add 8.62 degrees

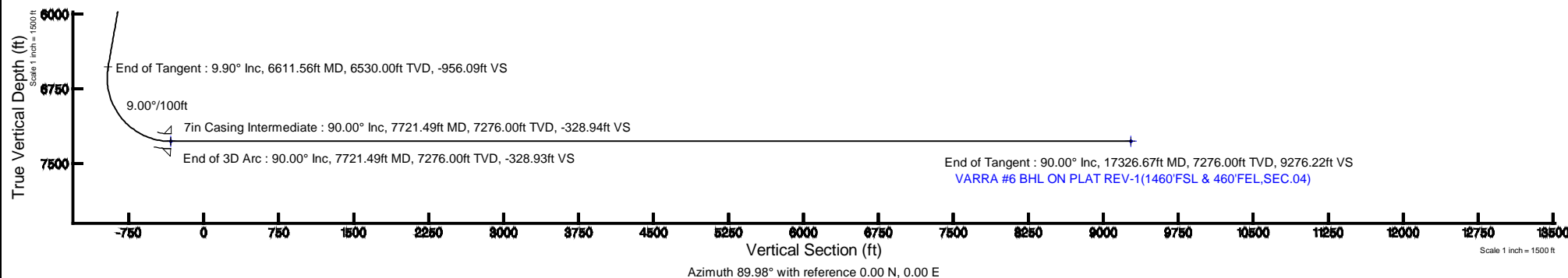



Planned Wellpath Report

VARRA #6 (REV-A.0) PWP

Page 1 of 8



REFERENCE WELLPATH IDENTIFICATION

Operator	EXTRACTION OIL & GAS	Slot	SLOT#06 VARRA #6(1615'FSL & 788'FWL,SEC.05)
Area	COLORADO	Well	VARRA #6
Field	WELD COUNTY (NAD83/TRUE NORTH)	Wellbore	VARRA #6 PWB
Facility	SEC.05-T06N-R67W		

REPORT SETUP INFORMATION

Projection System	NAD83 / Lambert Colorado SP, Northern Zone (501), US feet	Software System	WellArchitect® 4.0.0
North Reference	True	User	Painsetr
Scale	0.999967	Report Generated	4/29/2014 at 1:54:03 PM
Convergence at slot	n/a	Database/Source file	WA_Denver/VARRA_#6_PWB.xml

WELLPATH LOCATION

	Local coordinates		Grid coordinates		Geographic coordinates	
	North[ft]	East[ft]	Easting[US ft]	Northing[US ft]	Latitude	Longitude
Slot Location	-130.14	-0.85	3160186.78	1430250.08	40°30'46.832"N	104°55'25.968"W
Facility Reference Pt			3160186.79	1430380.22	40°30'48.118"N	104°55'25.957"W
Field Reference Pt			3185481.27	1419166.81	40°28'55.560"N	104°49'59.556"W

WELLPATH DATUM

Calculation method	Minimum curvature	RIG (RKB) to Facility Vertical Datum	4898.00ft
Horizontal Reference Pt	Slot	RIG (RKB) to Mean Sea Level	4898.00ft
Vertical Reference Pt	RIG (RKB)	RIG (RKB) to Mud Line at Slot (SLOT#06 VARRA #6(1615'FSL & 788'FWL,SEC.05))	4898.00ft
MD Reference Pt	RIG (RKB)	Section Origin	N 0.00, E 0.00 ft
Field Vertical Reference	Mean Sea Level	Section Azimuth	89.98°



Planned Wellpath Report

VARRA #6 (REV-A.0) PWP

Page 2 of 8



REFERENCE WELLPATH IDENTIFICATION

Operator	EXTRACTION OIL & GAS	Slot	SLOT#06 VARRA #6(1615'FSL & 788'FWL,SEC.05)
Area	COLORADO	Well	VARRA #6
Field	WELD COUNTY (NAD83/TRUE NORTH)	Wellbore	VARRA #6 PWB
Facility	SEC.05-T06N-R67W		

WELLPATH DATA (180 stations) † = interpolated/extrapolated station

MD [ft]	Inclination [°]	Azimuth [°]	TVD [ft]	Vert Sect [ft]	North [ft]	East [ft]	DLS [°/100ft]	Comments
0.00†	0.000	271.339	0.00	0.00	0.00	0.00	0.00	
24.00	0.000	271.339	24.00	0.00	0.00	0.00	0.00	Tie On
124.00†	0.000	271.339	124.00	0.00	0.00	0.00	0.00	
224.00†	0.000	271.339	224.00	0.00	0.00	0.00	0.00	
324.00†	0.000	271.339	324.00	0.00	0.00	0.00	0.00	
424.00†	0.000	271.339	424.00	0.00	0.00	0.00	0.00	
524.00†	0.000	271.339	524.00	0.00	0.00	0.00	0.00	
624.00†	0.000	271.339	624.00	0.00	0.00	0.00	0.00	
724.00†	0.000	271.339	724.00	0.00	0.00	0.00	0.00	
800.00	0.000	271.339	800.00	0.00	0.00	0.00	0.00	End of Tangent
824.00†	0.480	271.339	824.00	-0.10	0.00	-0.10	2.00	
924.00†	2.480	271.339	923.96	-2.68	0.06	-2.68	2.00	
1024.00†	4.480	271.339	1023.77	-8.75	0.20	-8.75	2.00	
1124.00†	6.480	271.339	1123.31	-18.30	0.43	-18.30	2.00	
1224.00†	8.480	271.339	1222.45	-31.31	0.73	-31.31	2.00	
1294.80	9.896	271.339	1292.34	-42.61	1.00	-42.61	2.00	End of Build
1324.00†	9.896	271.339	1321.11	-47.63	1.11	-47.63	0.00	
1424.00†	9.896	271.339	1419.62	-64.81	1.52	-64.81	0.00	
1524.00†	9.896	271.339	1518.13	-81.99	1.92	-81.99	0.00	
1624.00†	9.896	271.339	1616.65	-99.17	2.32	-99.17	0.00	
1724.00†	9.896	271.339	1715.16	-116.35	2.72	-116.35	0.00	
1824.00†	9.896	271.339	1813.67	-133.53	3.12	-133.54	0.00	
1924.00†	9.896	271.339	1912.18	-150.72	3.52	-150.72	0.00	
2024.00†	9.896	271.339	2010.69	-167.90	3.93	-167.90	0.00	
2124.00†	9.896	271.339	2109.21	-185.08	4.33	-185.08	0.00	
2224.00†	9.896	271.339	2207.72	-202.26	4.73	-202.26	0.00	
2324.00†	9.896	271.339	2306.23	-219.44	5.13	-219.44	0.00	
2424.00†	9.896	271.339	2404.74	-236.62	5.53	-236.62	0.00	
2524.00†	9.896	271.339	2503.25	-253.80	5.93	-253.80	0.00	
2624.00†	9.896	271.339	2601.77	-270.98	6.34	-270.99	0.00	



Planned Wellpath Report

VARRA #6 (REV-A.0) PWP

Page 3 of 8



REFERENCE WELLPATH IDENTIFICATION

Operator	EXTRACTION OIL & GAS	Slot	SLOT#06 VARRA #6(1615'FSL & 788'FWL,SEC.05)
Area	COLORADO	Well	VARRA #6
Field	WELD COUNTY (NAD83/TRUE NORTH)	Wellbore	VARRA #6 PWB
Facility	SEC.05-T06N-R67W		

WELLPATH DATA (180 stations) † = interpolated/extrapolated station

MD [ft]	Inclination [°]	Azimuth [°]	TVD [ft]	Vert Sect [ft]	North [ft]	East [ft]	DLS [°/100ft]	Comments
2724.00†	9.896	271.339	2700.28	-288.16	6.74	-288.17	0.00	
2824.00†	9.896	271.339	2798.79	-305.35	7.14	-305.35	0.00	
2924.00†	9.896	271.339	2897.30	-322.53	7.54	-322.53	0.00	
3024.00†	9.896	271.339	2995.82	-339.71	7.94	-339.71	0.00	
3124.00†	9.896	271.339	3094.33	-356.89	8.34	-356.89	0.00	
3224.00†	9.896	271.339	3192.84	-374.07	8.75	-374.07	0.00	
3324.00†	9.896	271.339	3291.35	-391.25	9.15	-391.25	0.00	
3424.00†	9.896	271.339	3389.86	-408.43	9.55	-408.43	0.00	
3524.00†	9.896	271.339	3488.38	-425.61	9.95	-425.62	0.00	
3624.00†	9.896	271.339	3586.89	-442.79	10.35	-442.80	0.00	
3724.00†	9.896	271.339	3685.40	-459.98	10.75	-459.98	0.00	
3824.00†	9.896	271.339	3783.91	-477.16	11.16	-477.16	0.00	
3924.00†	9.896	271.339	3882.43	-494.34	11.56	-494.34	0.00	
4024.00†	9.896	271.339	3980.94	-511.52	11.96	-511.52	0.00	
4124.00†	9.896	271.339	4079.45	-528.70	12.36	-528.70	0.00	
4224.00†	9.896	271.339	4177.96	-545.88	12.76	-545.88	0.00	
4324.00†	9.896	271.339	4276.47	-563.06	13.16	-563.07	0.00	
4424.00†	9.896	271.339	4374.99	-580.24	13.57	-580.25	0.00	
4524.00†	9.896	271.339	4473.50	-597.42	13.97	-597.43	0.00	
4624.00†	9.896	271.339	4572.01	-614.61	14.37	-614.61	0.00	
4724.00†	9.896	271.339	4670.52	-631.79	14.77	-631.79	0.00	
4824.00†	9.896	271.339	4769.03	-648.97	15.17	-648.97	0.00	
4924.00†	9.896	271.339	4867.55	-666.15	15.57	-666.15	0.00	
5024.00†	9.896	271.339	4966.06	-683.33	15.98	-683.33	0.00	
5124.00†	9.896	271.339	5064.57	-700.51	16.38	-700.52	0.00	
5224.00†	9.896	271.339	5163.08	-717.69	16.78	-717.70	0.00	
5324.00†	9.896	271.339	5261.60	-734.87	17.18	-734.88	0.00	
5424.00†	9.896	271.339	5360.11	-752.05	17.58	-752.06	0.00	
5524.00†	9.896	271.339	5458.62	-769.24	17.98	-769.24	0.00	
5624.00†	9.896	271.339	5557.13	-786.42	18.39	-786.42	0.00	



Planned Wellpath Report

VARRA #6 (REV-A.0) PWP

Page 4 of 8



REFERENCE WELLPATH IDENTIFICATION

Operator	EXTRACTION OIL & GAS	Slot	SLOT#06 VARRA #6(1615'FSL & 788'FWL,SEC.05)
Area	COLORADO	Well	VARRA #6
Field	WELD COUNTY (NAD83/TRUE NORTH)	Wellbore	VARRA #6 PWB
Facility	SEC.05-T06N-R67W		

WELLPATH DATA (180 stations) † = interpolated/extrapolated station

MD [ft]	Inclination [°]	Azimuth [°]	TVD [ft]	Vert Sect [ft]	North [ft]	East [ft]	DLS [°/100ft]	Comments
5724.00†	9.896	271.339	5655.64	-803.60	18.79	-803.60	0.00	
5824.00†	9.896	271.339	5754.16	-820.78	19.19	-820.78	0.00	
5924.00†	9.896	271.339	5852.67	-837.96	19.59	-837.96	0.00	
6024.00†	9.896	271.339	5951.18	-855.14	19.99	-855.15	0.00	
6124.00†	9.896	271.339	6049.69	-872.32	20.40	-872.33	0.00	
6224.00†	9.896	271.339	6148.20	-889.50	20.80	-889.51	0.00	
6324.00†	9.896	271.339	6246.72	-906.68	21.20	-906.69	0.00	
6424.00†	9.896	271.339	6345.23	-923.86	21.60	-923.87	0.00	
6524.00†	9.896	271.339	6443.74	-941.05	22.00	-941.05	0.00	
6611.56	9.896	271.339	6530.00	-956.09	22.35	-956.10	0.00	End of Tangent
6624.00†	8.777	271.497	6542.27	-958.11	22.40	-958.11	9.00	
6724.00†	0.309	46.976	6641.89	-965.55	22.79	-965.56	9.00	
6824.00†	9.228	88.824	6741.45	-957.32	23.14	-957.33	9.00	
6924.00†	18.227	89.484	6838.49	-933.62	23.44	-933.62	9.00	
7024.00†	27.226	89.715	6930.63	-895.02	23.70	-895.03	9.00	
7124.00†	36.226	89.838	7015.60	-842.49	23.90	-842.50	9.00	
7224.00†	45.226	89.917	7091.31	-777.31	24.03	-777.32	9.00	
7324.00†	54.226	89.974	7155.89	-701.10	24.10	-701.10	9.00	
7424.00†	63.226	90.020	7207.75	-615.72	24.10	-615.72	9.00	
7524.00†	72.226	90.059	7245.61	-523.27	24.04	-523.28	9.00	
7624.00†	81.226	90.094	7268.55	-426.04	23.91	-426.05	9.00	
7721.49	90.000	90.127	7276.00 [†]	-328.93	23.72	-328.94	9.00	End of 3D Arc
7724.00†	90.000	90.127	7276.00	-326.43	23.72	-326.43	0.00	
7824.00†	90.000	90.127	7276.00	-226.43	23.50	-226.43	0.00	
7924.00†	90.000	90.127	7276.00	-126.43	23.28	-126.43	0.00	
8024.00†	90.000	90.127	7276.00	-26.43	23.06	-26.43	0.00	
8124.00†	90.000	90.127	7276.00	73.57	22.83	73.57	0.00	
8224.00†	90.000	90.127	7276.00	173.57	22.61	173.57	0.00	
8324.00†	90.000	90.127	7276.00	273.57	22.39	273.57	0.00	
8424.00†	90.000	90.127	7276.00	373.57	22.17	373.57	0.00	



Planned Wellpath Report

VARRA #6 (REV-A.0) PWP

Page 5 of 8



REFERENCE WELLPATH IDENTIFICATION

Operator	EXTRACTION OIL & GAS	Slot	SLOT#06 VARRA #6(1615'FSL & 788'FWL,SEC.05)
Area	COLORADO	Well	VARRA #6
Field	WELD COUNTY (NAD83/TRUE NORTH)	Wellbore	VARRA #6 PWB
Facility	SEC.05-T06N-R67W		

WELLPATH DATA (180 stations) † = interpolated/extrapolated station

MD [ft]	Inclination [°]	Azimuth [°]	TVD [ft]	Vert Sect [ft]	North [ft]	East [ft]	DLS [°/100ft]	Comments
8524.00†	90.000	90.127	7276.00	473.57	21.95	473.57	0.00	
8624.00†	90.000	90.127	7276.00	573.57	21.73	573.57	0.00	
8724.00†	90.000	90.127	7276.00	673.57	21.51	673.57	0.00	
8824.00†	90.000	90.127	7276.00	773.57	21.29	773.57	0.00	
8924.00†	90.000	90.127	7276.00	873.57	21.07	873.57	0.00	
9024.00†	90.000	90.127	7276.00	973.57	20.85	973.56	0.00	
9124.00†	90.000	90.127	7276.00	1073.57	20.63	1073.56	0.00	
9224.00†	90.000	90.127	7276.00	1173.57	20.41	1173.56	0.00	
9324.00†	90.000	90.127	7276.00	1273.57	20.18	1273.56	0.00	
9424.00†	90.000	90.127	7276.00	1373.57	19.96	1373.56	0.00	
9524.00†	90.000	90.127	7276.00	1473.57	19.74	1473.56	0.00	
9624.00†	90.000	90.127	7276.00	1573.57	19.52	1573.56	0.00	
9724.00†	90.000	90.127	7276.00	1673.57	19.30	1673.56	0.00	
9824.00†	90.000	90.127	7276.00	1773.57	19.08	1773.56	0.00	
9924.00†	90.000	90.127	7276.00	1873.57	18.86	1873.56	0.00	
10024.00†	90.000	90.127	7276.00	1973.57	18.64	1973.56	0.00	
10124.00†	90.000	90.127	7276.00	2073.57	18.42	2073.56	0.00	
10224.00†	90.000	90.127	7276.00	2173.57	18.20	2173.56	0.00	
10324.00†	90.000	90.127	7276.00	2273.57	17.98	2273.56	0.00	
10424.00†	90.000	90.127	7276.00	2373.57	17.76	2373.56	0.00	
10524.00†	90.000	90.127	7276.00	2473.57	17.54	2473.56	0.00	
10624.00†	90.000	90.127	7276.00	2573.57	17.31	2573.56	0.00	
10724.00†	90.000	90.127	7276.00	2673.57	17.09	2673.56	0.00	
10824.00†	90.000	90.127	7276.00	2773.56	16.87	2773.56	0.00	
10924.00†	90.000	90.127	7276.00	2873.56	16.65	2873.56	0.00	
11024.00†	90.000	90.127	7276.00	2973.56	16.43	2973.56	0.00	
11124.00†	90.000	90.127	7276.00	3073.56	16.21	3073.56	0.00	
11224.00†	90.000	90.127	7276.00	3173.56	15.99	3173.56	0.00	
11324.00†	90.000	90.127	7276.00	3273.56	15.77	3273.56	0.00	
11424.00†	90.000	90.127	7276.00	3373.56	15.55	3373.56	0.00	



Planned Wellpath Report

VARRA #6 (REV-A.0) PWP

Page 6 of 8



REFERENCE WELLPATH IDENTIFICATION

Operator	EXTRACTION OIL & GAS	Slot	SLOT#06 VARRA #6(1615'FSL & 788'FWL,SEC.05)
Area	COLORADO	Well	VARRA #6
Field	WELD COUNTY (NAD83/TRUE NORTH)	Wellbore	VARRA #6 PWB
Facility	SEC.05-T06N-R67W		

WELLPATH DATA (180 stations) † = interpolated/extrapolated station

MD [ft]	Inclination [°]	Azimuth [°]	TVD [ft]	Vert Sect [ft]	North [ft]	East [ft]	DLS [°/100ft]	Comments
11524.00†	90.000	90.127	7276.00	3473.56	15.33	3473.56	0.00	
11624.00†	90.000	90.127	7276.00	3573.56	15.11	3573.56	0.00	
11724.00†	90.000	90.127	7276.00	3673.56	14.89	3673.56	0.00	
11824.00†	90.000	90.127	7276.00	3773.56	14.66	3773.56	0.00	
11924.00†	90.000	90.127	7276.00	3873.56	14.44	3873.56	0.00	
12024.00†	90.000	90.127	7276.00	3973.56	14.22	3973.56	0.00	
12124.00†	90.000	90.127	7276.00	4073.56	14.00	4073.56	0.00	
12224.00†	90.000	90.127	7276.00	4173.56	13.78	4173.56	0.00	
12324.00†	90.000	90.127	7276.00	4273.56	13.56	4273.56	0.00	
12424.00†	90.000	90.127	7276.00	4373.56	13.34	4373.56	0.00	
12524.00†	90.000	90.127	7276.00	4473.56	13.12	4473.56	0.00	
12624.00†	90.000	90.127	7276.00	4573.56	12.90	4573.56	0.00	
12724.00†	90.000	90.127	7276.00	4673.56	12.68	4673.56	0.00	
12824.00†	90.000	90.127	7276.00	4773.56	12.46	4773.56	0.00	
12924.00†	90.000	90.127	7276.00	4873.56	12.24	4873.56	0.00	
13024.00†	90.000	90.127	7276.00	4973.56	12.01	4973.56	0.00	
13124.00†	90.000	90.127	7276.00	5073.56	11.79	5073.55	0.00	
13224.00†	90.000	90.127	7276.00	5173.56	11.57	5173.55	0.00	
13324.00†	90.000	90.127	7276.00	5273.56	11.35	5273.55	0.00	
13424.00†	90.000	90.127	7276.00	5373.56	11.13	5373.55	0.00	
13524.00†	90.000	90.127	7276.00	5473.56	10.91	5473.55	0.00	
13624.00†	90.000	90.127	7276.00	5573.56	10.69	5573.55	0.00	
13724.00†	90.000	90.127	7276.00	5673.56	10.47	5673.55	0.00	
13824.00†	90.000	90.127	7276.00	5773.56	10.25	5773.55	0.00	
13924.00†	90.000	90.127	7276.00	5873.56	10.03	5873.55	0.00	
14024.00†	90.000	90.127	7276.00	5973.56	9.81	5973.55	0.00	
14124.00†	90.000	90.127	7276.00	6073.55	9.59	6073.55	0.00	
14224.00†	90.000	90.127	7276.00	6173.55	9.37	6173.55	0.00	
14324.00†	90.000	90.127	7276.00	6273.55	9.14	6273.55	0.00	
14424.00†	90.000	90.127	7276.00	6373.55	8.92	6373.55	0.00	



Planned Wellpath Report

VARRA #6 (REV-A.0) PWP

Page 7 of 8



REFERENCE WELLPATH IDENTIFICATION

Operator	EXTRACTION OIL & GAS	Slot	SLOT#06 VARRA #6(1615'FSL & 788'FWL,SEC.05)
Area	COLORADO	Well	VARRA #6
Field	WELD COUNTY (NAD83/TRUE NORTH)	Wellbore	VARRA #6 PWB
Facility	SEC.05-T06N-R67W		

WELLPATH DATA (180 stations) † = interpolated/extrapolated station

MD [ft]	Inclination [°]	Azimuth [°]	TVD [ft]	Vert Sect [ft]	North [ft]	East [ft]	DLS [°/100ft]	Comments
14524.00†	90.000	90.127	7276.00	6473.55	8.70	6473.55	0.00	
14624.00†	90.000	90.127	7276.00	6573.55	8.48	6573.55	0.00	
14724.00†	90.000	90.127	7276.00	6673.55	8.26	6673.55	0.00	
14824.00†	90.000	90.127	7276.00	6773.55	8.04	6773.55	0.00	
14924.00†	90.000	90.127	7276.00	6873.55	7.82	6873.55	0.00	
15024.00†	90.000	90.127	7276.00	6973.55	7.60	6973.55	0.00	
15124.00†	90.000	90.127	7276.00	7073.55	7.38	7073.55	0.00	
15224.00†	90.000	90.127	7276.00	7173.55	7.16	7173.55	0.00	
15324.00†	90.000	90.127	7276.00	7273.55	6.94	7273.55	0.00	
15424.00†	90.000	90.127	7276.00	7373.55	6.72	7373.55	0.00	
15524.00†	90.000	90.127	7276.00	7473.55	6.49	7473.55	0.00	
15624.00†	90.000	90.127	7276.00	7573.55	6.27	7573.55	0.00	
15724.00†	90.000	90.127	7276.00	7673.55	6.05	7673.55	0.00	
15824.00†	90.000	90.127	7276.00	7773.55	5.83	7773.55	0.00	
15924.00†	90.000	90.127	7276.00	7873.55	5.61	7873.55	0.00	
16024.00†	90.000	90.127	7276.00	7973.55	5.39	7973.55	0.00	
16124.00†	90.000	90.127	7276.00	8073.55	5.17	8073.55	0.00	
16224.00†	90.000	90.127	7276.00	8173.55	4.95	8173.55	0.00	
16324.00†	90.000	90.127	7276.00	8273.55	4.73	8273.55	0.00	
16424.00†	90.000	90.127	7276.00	8373.55	4.51	8373.55	0.00	
16524.00†	90.000	90.127	7276.00	8473.55	4.29	8473.55	0.00	
16624.00†	90.000	90.127	7276.00	8573.55	4.07	8573.55	0.00	
16724.00†	90.000	90.127	7276.00	8673.55	3.84	8673.55	0.00	
16824.00†	90.000	90.127	7276.00	8773.55	3.62	8773.55	0.00	
16924.00†	90.000	90.127	7276.00	8873.55	3.40	8873.55	0.00	
17024.00†	90.000	90.127	7276.00	8973.55	3.18	8973.55	0.00	
17124.00†	90.000	90.127	7276.00	9073.55	2.96	9073.55	0.00	
17224.00†	90.000	90.127	7276.00	9173.55	2.74	9173.54	0.00	
17324.00†	90.000	90.127	7276.00	9273.54	2.52	9273.54	0.00	
17326.67	90.000	90.127	7276.00 ²	9276.22	2.51	9276.22	0.00	End of Tangent



Planned Wellpath Report

VARRA #6 (REV-A.0) PWP

Page 8 of 8



REFERENCE WELLPATH IDENTIFICATION

Operator	EXTRACTION OIL & GAS	Slot	SLOT#06 VARRA #6(1615'FSL & 788'FWL,SEC.05)
Area	COLORADO	Well	VARRA #6
Field	WELD COUNTY (NAD83/TRUE NORTH)	Wellbore	VARRA #6 PWB
Facility	SEC.05-T06N-R67W		

HOLE & CASING SECTIONS - Ref Wellbore: VARRA #6 PWB Ref Wellpath: VARRA #6 (REV-A.0) PWP

String/Diameter	Start MD [ft]	End MD [ft]	Interval [ft]	Start TVD [ft]	End TVD [ft]	Start N/S [ft]	Start E/W [ft]	End N/S [ft]	End E/W [ft]
7in Casing Intermediate	24.00	7721.49	7697.49	24.00	7276.00	0.00	0.00	23.72	-328.94

TARGETS

Name	MD [ft]	TVD [ft]	North [ft]	East [ft]	Grid East [US ft]	Grid North [US ft]	Latitude	Longitude	Shape
VARRA PAD SECTION 04		0.00	130.10	0.83	3160186.77	1430380.18	40°30'48.118"N	104°55'25.957"W	polygon
VARRA PAD SECTION 05		0.00	130.10	0.83	3160186.77	1430380.18	40°30'48.118"N	104°55'25.957"W	polygon
2) VARRA #6 BHL ON PLAT REV-1(1460'FSL & 460'FEL,SEC.04)	17326.67	7276.00	2.51	9276.22	3169462.47	1430312.86	40°30'46.840"N	104°53'25.868"W	point
1) VARRA #6 LANDING POINT	7721.49	7276.00	23.72	-328.94	3159857.71	1430271.67	40°30'47.066"N	104°55'30.227"W	point
VARRA PAD SOUTH 1/2 HARDLINES(460'SETBACKS)		7420.00	130.10	0.83	3160186.77	1430380.18	40°30'48.118"N	104°55'25.957"W	polygon

SURVEY PROGRAM - Ref Wellbore: VARRA #6 PWB Ref Wellpath: VARRA #6 (REV-A.0) PWP

Start MD [ft]	End MD [ft]	Positional Uncertainty Model	Log Name/Comment	Wellbore
24.00	18000.00	NaviTrak (Standard)		VARRA #6 PWB