

# EXTRACTION OIL & GAS

Location: COLORADO Slot: SLOT#07 VARRA #7(1589'FSL & 788'FWL,SEC.05)  
Field: WELD COUNTY (NAD83/TRUE NORTH) Well: VARRA #7  
Facility: SEC.05-T06N-R67W Wellbore: VARRA #7 PWB

Plot reference wellpath is VARRA #7 (REV-A.0) PWP

True vertical depths are referenced to RIG (RKB)	Grid System: NAD83 / Lambert Colorado SP, Northern Zone (501), US feet
Measured depths are referenced to RIG (RKB)	North Reference: True north
RIG (RKB) to Mean Sea Level: 4898 feet	Scale: True distance
Mean Sea Level to Mud line (At Slot: SLOT#07 VARRA #7(1589'FSL & 788'FWL,SEC.05)): 0 feet	Depths are in feet
Coordinates are in feet referenced to Slot	Created by: painsr on 4/29/2014

## Location Information

Facility Name			Grid East (US ft)	Grid North (US ft)	Latitude	Longitude
SEC.05-T06N-R67W			3160186.786	1430380.222	40°30'48.118"N	104°55'25.957"W
Slot	Local N (ft)	Local E (ft)	Grid East (US ft)	Grid North (US ft)	Latitude	Longitude
SLOT#07 VARRA #7(1589FSL & 788FWL,SEC.05)	-155.95	-1.16	3160186.641	1430224.274	40°30'46.577"N	104°55'25.972"W
RIG (RKB) to Mud line (At Slot: SLOT#07 VARRA #7(1589FSL & 788FWL,SEC.05))					4898ft	
Mean Sea Level to Mud line (At Slot: SLOT#07 VARRA #7(1589FSL & 788FWL,SEC.05))					0ft	
RIG (RKB) to Mean Sea Level					4898ft	

## Targets

Name	MD (ft)	TVD (ft)	Local N (ft)	Local E (ft)	Grid East (US ft)	Grid North (US ft)	Latitude	Longitude
VARRA PAD SECTION 04		0.00	155.91	1.14	3160186.77	1430380.18	40°30'48.118"N	104°55'25.957"W
VARRA PAD SECTION 05		0.00	155.91	1.14	3160186.77	1430380.18	40°30'48.118"N	104°55'25.957"W
VARRA #7 BHL ON PLAT REV-1(1300'FSL & 460'FEL,SEC.04)	17467.84	7420.00	-131.62	9278.53	3160465.51	1430152.95	40°30'45.259"N	104°53'25.843"W
VARRA #7 LANDING POINT	7863.71	7420.00	-110.41	-325.57	3159861.80	1430111.76	40°30'45.486"N	104°55'30.187"W
VARRA PAD SOUTH 1/2 HARDLINE(460'SETBACKS)		7420.00	155.91	1.14	3160186.77	1430380.18	40°30'48.118"N	104°55'25.957"W

## Survey Program

Start MD (ft)	End MD (ft)	Tool	Model	Log Name/Comment	Wellbore
24.00	18000.00	NaviTrak	NaviTrak (Standard)		VARRA #7 PWB

## Well Profile Data

Design Comment	MD (ft)	Inc (°)	Az (°)	TVD (ft)	Local N (ft)	Local E (ft)	DLS (°/100ft)	VS (ft)
Tie On	24.00	0.000	264.244	24.00	0.00	0.00	0.00	0.00
End of Tangent	800.00	0.000	264.244	800.00	0.00	0.00	0.00	0.00
End of Build	1282.42	9.648	264.244	1280.14	-4.06	-40.32	2.00	-40.26
End of Tangent	6757.07	9.648	264.244	6677.36	-96.08	-953.25	0.00	-951.80
End of 3D Arc	7863.71	90.000	90.127	7420.00	-110.41	-325.57	9.00	-323.98
End of Tangent	17467.84	90.000	90.127	7420.00	-131.62	9278.53	0.00	9279.47

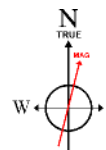
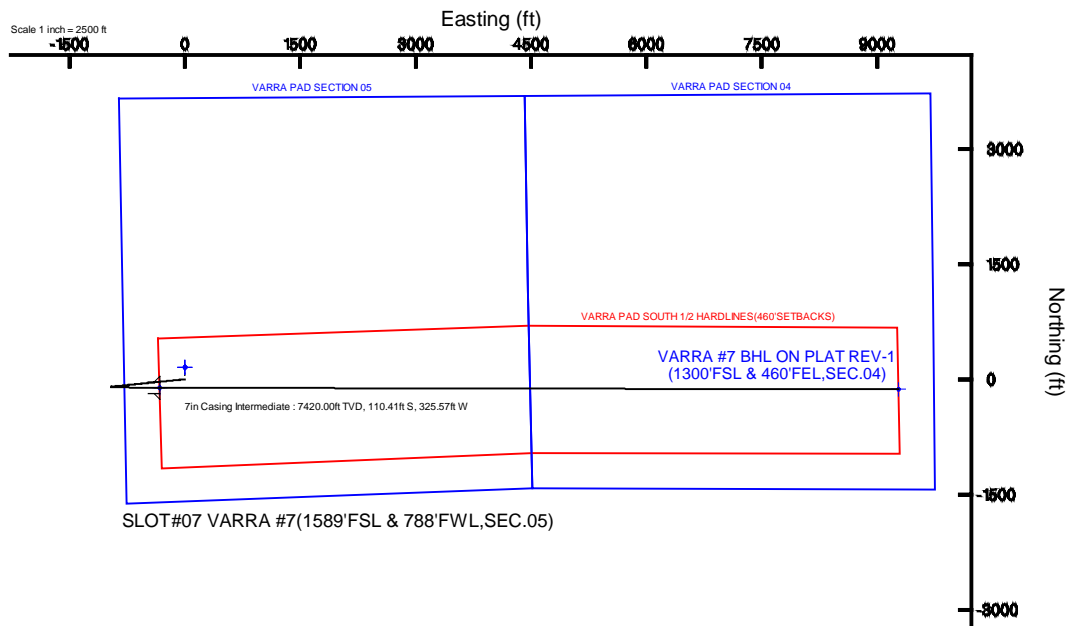

BGGM (1945.0 to 2015.0) Dip: 67.00° Field: 52835.3 nT  
Magnetic North is 8.62 degrees East of True North (at 4/17/2014)

To correct azimuth from Magnetic to True add 8.62 degrees

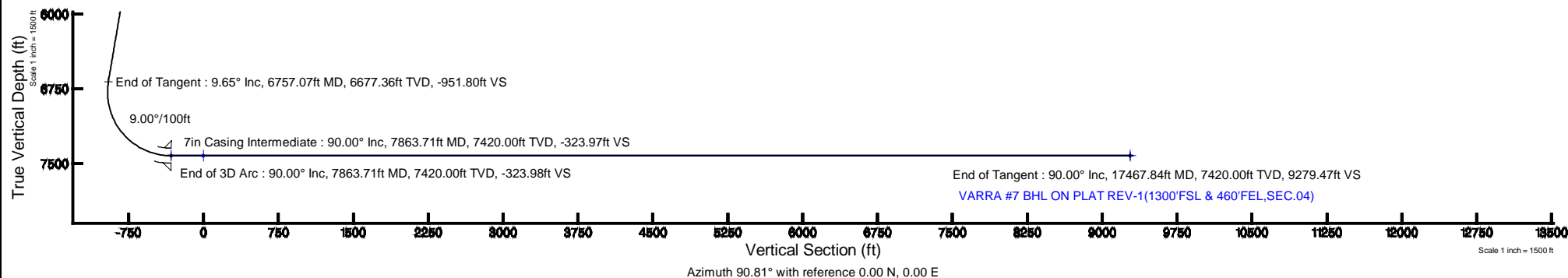



# Planned Wellpath Report

VARRA #7 (REV-A.0) PWP

Page 1 of 8



## REFERENCE WELLPATH IDENTIFICATION

Operator	EXTRACTION OIL & GAS	Slot	SLOT#07 VARRA #7(1589'FSL & 788'FWL,SEC.05)
Area	COLORADO	Well	VARRA #7
Field	WELD COUNTY (NAD83/TRUE NORTH)	Wellbore	VARRA #7 PWB
Facility	SEC.05-T06N-R67W		

## REPORT SETUP INFORMATION

Projection System	NAD83 / Lambert Colorado SP, Northern Zone (501), US feet	Software System	WellArchitect® 4.0.0
North Reference	True	User	Painsetr
Scale	0.999967	Report Generated	4/29/2014 at 2:31:20 PM
Convergence at slot	n/a	Database/Source file	WA_Denver/VARRA_#7_PWB.xml

## WELLPATH LOCATION

	Local coordinates		Grid coordinates		Geographic coordinates	
	North[ft]	East[ft]	Easting[US ft]	Northing[US ft]	Latitude	Longitude
Slot Location	-155.95	-1.16	3160186.64	1430224.27	40°30'46.577"N	104°55'25.972"W
Facility Reference Pt			3160186.79	1430380.22	40°30'48.118"N	104°55'25.957"W
Field Reference Pt			3185481.27	1419166.81	40°28'55.560"N	104°49'59.556"W

## WELLPATH DATUM

Calculation method	Minimum curvature	RIG (RKB) to Facility Vertical Datum	4898.00ft
Horizontal Reference Pt	Slot	RIG (RKB) to Mean Sea Level	4898.00ft
Vertical Reference Pt	RIG (RKB)	RIG (RKB) to Mud Line at Slot (SLOT#07 VARRA #7(1589'FSL & 788'FWL,SEC.05))	4898.00ft
MD Reference Pt	RIG (RKB)	Section Origin	N 0.00, E 0.00 ft
Field Vertical Reference	Mean Sea Level	Section Azimuth	90.81°



# Planned Wellpath Report

VARRA #7 (REV-A.0) PWP

Page 2 of 8



## REFERENCE WELLPATH IDENTIFICATION

Operator	EXTRACTION OIL & GAS	Slot	SLOT#07 VARRA #7(1589'FSL & 788'FWL,SEC.05)
Area	COLORADO	Well	VARRA #7
Field	WELD COUNTY (NAD83/TRUE NORTH)	Wellbore	VARRA #7 PWB
Facility	SEC.05-T06N-R67W		

## WELLPATH DATA (181 stations) † = interpolated/extrapolated station

MD [ft]	Inclination [°]	Azimuth [°]	TVD [ft]	Vert Sect [ft]	North [ft]	East [ft]	DLS [°/100ft]	Comments
0.00†	0.000	264.244	0.00	0.00	0.00	0.00	0.00	
24.00	0.000	264.244	24.00	0.00	0.00	0.00	0.00	Tie On
124.00†	0.000	264.244	124.00	0.00	0.00	0.00	0.00	
224.00†	0.000	264.244	224.00	0.00	0.00	0.00	0.00	
324.00†	0.000	264.244	324.00	0.00	0.00	0.00	0.00	
424.00†	0.000	264.244	424.00	0.00	0.00	0.00	0.00	
524.00†	0.000	264.244	524.00	0.00	0.00	0.00	0.00	
624.00†	0.000	264.244	624.00	0.00	0.00	0.00	0.00	
724.00†	0.000	264.244	724.00	0.00	0.00	0.00	0.00	
800.00	0.000	264.244	800.00	0.00	0.00	0.00	0.00	End of Tangent
824.00†	0.480	264.244	824.00	-0.10	-0.01	-0.10	2.00	
924.00†	2.480	264.244	923.96	-2.67	-0.27	-2.67	2.00	
1024.00†	4.480	264.244	1023.77	-8.70	-0.88	-8.71	2.00	
1124.00†	6.480	264.244	1123.31	-18.18	-1.84	-18.21	2.00	
1224.00†	8.480	264.244	1222.45	-31.11	-3.14	-31.16	2.00	
1282.42	9.648	264.244	1280.14	-40.26	-4.06	-40.32	2.00	End of Build
1324.00†	9.648	264.244	1321.14	-47.18	-4.76	-47.25	0.00	
1424.00†	9.648	264.244	1419.72	-63.83	-6.44	-63.93	0.00	
1524.00†	9.648	264.244	1518.31	-80.48	-8.12	-80.60	0.00	
1624.00†	9.648	264.244	1616.89	-97.13	-9.81	-97.28	0.00	
1724.00†	9.648	264.244	1715.48	-113.78	-11.49	-113.96	0.00	
1824.00†	9.648	264.244	1814.06	-130.43	-13.17	-130.63	0.00	
1924.00†	9.648	264.244	1912.65	-147.08	-14.85	-147.31	0.00	
2024.00†	9.648	264.244	2011.23	-163.73	-16.53	-163.98	0.00	
2124.00†	9.648	264.244	2109.82	-180.38	-18.21	-180.66	0.00	
2224.00†	9.648	264.244	2208.40	-197.03	-19.89	-197.33	0.00	
2324.00†	9.648	264.244	2306.99	-213.68	-21.57	-214.01	0.00	
2424.00†	9.648	264.244	2405.58	-230.33	-23.25	-230.68	0.00	
2524.00†	9.648	264.244	2504.16	-246.98	-24.93	-247.36	0.00	
2624.00†	9.648	264.244	2602.75	-263.63	-26.61	-264.04	0.00	



# Planned Wellpath Report

VARRA #7 (REV-A.0) PWP

Page 3 of 8



## REFERENCE WELLPATH IDENTIFICATION

Operator	EXTRACTION OIL & GAS	Slot	SLOT#07 VARRA #7(1589'FSL & 788'FWL,SEC.05)
Area	COLORADO	Well	VARRA #7
Field	WELD COUNTY (NAD83/TRUE NORTH)	Wellbore	VARRA #7 PWB
Facility	SEC.05-T06N-R67W		

## WELLPATH DATA (181 stations) † = interpolated/extrapolated station

MD [ft]	Inclination [°]	Azimuth [°]	TVD [ft]	Vert Sect [ft]	North [ft]	East [ft]	DLS [°/100ft]	Comments
2724.00†	9.648	264.244	2701.33	-280.28	-28.29	-280.71	0.00	
2824.00†	9.648	264.244	2799.92	-296.93	-29.97	-297.39	0.00	
2924.00†	9.648	264.244	2898.50	-313.58	-31.66	-314.06	0.00	
3024.00†	9.648	264.244	2997.09	-330.23	-33.34	-330.74	0.00	
3124.00†	9.648	264.244	3095.67	-346.88	-35.02	-347.41	0.00	
3224.00†	9.648	264.244	3194.26	-363.53	-36.70	-364.09	0.00	
3324.00†	9.648	264.244	3292.84	-380.18	-38.38	-380.77	0.00	
3424.00†	9.648	264.244	3391.43	-396.83	-40.06	-397.44	0.00	
3524.00†	9.648	264.244	3490.02	-413.48	-41.74	-414.12	0.00	
3624.00†	9.648	264.244	3588.60	-430.13	-43.42	-430.79	0.00	
3724.00†	9.648	264.244	3687.19	-446.78	-45.10	-447.47	0.00	
3824.00†	9.648	264.244	3785.77	-463.43	-46.78	-464.14	0.00	
3924.00†	9.648	264.244	3884.36	-480.08	-48.46	-480.82	0.00	
4024.00†	9.648	264.244	3982.94	-496.73	-50.14	-497.50	0.00	
4124.00†	9.648	264.244	4081.53	-513.38	-51.83	-514.17	0.00	
4224.00†	9.648	264.244	4180.11	-530.03	-53.51	-530.85	0.00	
4324.00†	9.648	264.244	4278.70	-546.68	-55.19	-547.52	0.00	
4424.00†	9.648	264.244	4377.28	-563.33	-56.87	-564.20	0.00	
4524.00†	9.648	264.244	4475.87	-579.99	-58.55	-580.87	0.00	
4624.00†	9.648	264.244	4574.46	-596.64	-60.23	-597.55	0.00	
4724.00†	9.648	264.244	4673.04	-613.29	-61.91	-614.23	0.00	
4824.00†	9.648	264.244	4771.63	-629.94	-63.59	-630.90	0.00	
4924.00†	9.648	264.244	4870.21	-646.59	-65.27	-647.58	0.00	
5024.00†	9.648	264.244	4968.80	-663.24	-66.95	-664.25	0.00	
5124.00†	9.648	264.244	5067.38	-679.89	-68.63	-680.93	0.00	
5224.00†	9.648	264.244	5165.97	-696.54	-70.31	-697.60	0.00	
5324.00†	9.648	264.244	5264.55	-713.19	-71.99	-714.28	0.00	
5424.00†	9.648	264.244	5363.14	-729.84	-73.68	-730.96	0.00	
5524.00†	9.648	264.244	5461.73	-746.49	-75.36	-747.63	0.00	
5624.00†	9.648	264.244	5560.31	-763.14	-77.04	-764.31	0.00	



# Planned Wellpath Report

VARRA #7 (REV-A.0) PWP

Page 4 of 8



## REFERENCE WELLPATH IDENTIFICATION

Operator	EXTRACTION OIL & GAS	Slot	SLOT#07 VARRA #7(1589'FSL & 788'FWL,SEC.05)
Area	COLORADO	Well	VARRA #7
Field	WELD COUNTY (NAD83/TRUE NORTH)	Wellbore	VARRA #7 PWB
Facility	SEC.05-T06N-R67W		

## WELLPATH DATA (181 stations) † = interpolated/extrapolated station

MD [ft]	Inclination [°]	Azimuth [°]	TVD [ft]	Vert Sect [ft]	North [ft]	East [ft]	DLS [°/100ft]	Comments
5724.00†	9.648	264.244	5658.90	-779.79	-78.72	-780.98	0.00	
5824.00†	9.648	264.244	5757.48	-796.44	-80.40	-797.66	0.00	
5924.00†	9.648	264.244	5856.07	-813.09	-82.08	-814.33	0.00	
6024.00†	9.648	264.244	5954.65	-829.74	-83.76	-831.01	0.00	
6124.00†	9.648	264.244	6053.24	-846.39	-85.44	-847.68	0.00	
6224.00†	9.648	264.244	6151.82	-863.04	-87.12	-864.36	0.00	
6324.00†	9.648	264.244	6250.41	-879.69	-88.80	-881.04	0.00	
6424.00†	9.648	264.244	6348.99	-896.34	-90.48	-897.71	0.00	
6524.00†	9.648	264.244	6447.58	-912.99	-92.16	-914.39	0.00	
6624.00†	9.648	264.244	6546.17	-929.64	-93.85	-931.06	0.00	
6724.00†	9.648	264.244	6644.75	-946.29	-95.53	-947.74	0.00	
6757.07	9.648	264.244	6677.36	-951.80	-96.08	-953.25	0.00	End of Tangent
6824.00†	3.710	254.541	6743.80	-959.45	-97.22	-960.93	9.00	
6924.00†	5.517	100.518	6843.67	-957.82	-98.97	-959.32	9.00	
7024.00†	14.460	94.001	6942.06	-940.58	-100.72	-942.10	9.00	
7124.00†	23.446	92.429	7036.54	-908.16	-102.44	-909.70	9.00	
7224.00†	32.440	91.697	7124.79	-861.36	-104.08	-862.92	9.00	
7324.00†	41.436	91.257	7204.64	-801.33	-105.60	-802.91	9.00	
7424.00†	50.433	90.951	7274.11	-729.55	-106.97	-731.14	9.00	
7524.00†	59.431	90.716	7331.51	-647.78	-108.15	-649.38	9.00	
7624.00†	68.430	90.521	7375.41	-558.05	-109.11	-559.66	9.00	
7724.00†	77.428	90.349	7404.73	-462.56	-109.83	-464.16	9.00	
7824.00†	86.427	90.189	7418.76	-363.65	-110.30	-365.26	9.00	
7863.71	90.000	90.127	7420.00 <sup>†</sup>	-323.98	-110.41	-325.57	9.00	End of 3D Arc
7924.00†	90.000	90.127	7420.00	-263.69	-110.54	-265.28	0.00	
8024.00†	90.000	90.127	7420.00	-163.69	-110.76	-165.28	0.00	
8124.00†	90.000	90.127	7420.00	-63.70	-110.98	-65.28	0.00	
8224.00†	90.000	90.127	7420.00	36.29	-111.20	34.72	0.00	
8324.00†	90.000	90.127	7420.00	136.28	-111.42	134.72	0.00	
8424.00†	90.000	90.127	7420.00	236.28	-111.64	234.72	0.00	



# Planned Wellpath Report

VARRA #7 (REV-A.0) PWP

Page 5 of 8



REFERENCE WELLPATH IDENTIFICATION			
Operator	EXTRACTION OIL & GAS	Slot	SLOT#07 VARRA #7(1589'FSL & 788'FWL,SEC.05)
Area	COLORADO	Well	VARRA #7
Field	WELD COUNTY (NAD83/TRUE NORTH)	Wellbore	VARRA #7 PWB
Facility	SEC.05-T06N-R67W		

WELLPATH DATA (181 stations) † = interpolated/extrapolated station								
MD [ft]	Inclination [°]	Azimuth [°]	TVD [ft]	Vert Sect [ft]	North [ft]	East [ft]	DLS [°/100ft]	Comments
8524.00†	90.000	90.127	7420.00	336.27	-111.86	334.72	0.00	
8624.00†	90.000	90.127	7420.00	436.26	-112.09	434.72	0.00	
8724.00†	90.000	90.127	7420.00	536.26	-112.31	534.72	0.00	
8824.00†	90.000	90.127	7420.00	636.25	-112.53	634.72	0.00	
8924.00†	90.000	90.127	7420.00	736.24	-112.75	734.72	0.00	
9024.00†	90.000	90.127	7420.00	836.23	-112.97	834.72	0.00	
9124.00†	90.000	90.127	7420.00	936.23	-113.19	934.72	0.00	
9224.00†	90.000	90.127	7420.00	1036.22	-113.41	1034.71	0.00	
9324.00†	90.000	90.127	7420.00	1136.21	-113.63	1134.71	0.00	
9424.00†	90.000	90.127	7420.00	1236.20	-113.85	1234.71	0.00	
9524.00†	90.000	90.127	7420.00	1336.20	-114.07	1334.71	0.00	
9624.00†	90.000	90.127	7420.00	1436.19	-114.29	1434.71	0.00	
9724.00†	90.000	90.127	7420.00	1536.18	-114.51	1534.71	0.00	
9824.00†	90.000	90.127	7420.00	1636.18	-114.74	1634.71	0.00	
9924.00†	90.000	90.127	7420.00	1736.17	-114.96	1734.71	0.00	
10024.00†	90.000	90.127	7420.00	1836.16	-115.18	1834.71	0.00	
10124.00†	90.000	90.127	7420.00	1936.15	-115.40	1934.71	0.00	
10224.00†	90.000	90.127	7420.00	2036.15	-115.62	2034.71	0.00	
10324.00†	90.000	90.127	7420.00	2136.14	-115.84	2134.71	0.00	
10424.00†	90.000	90.127	7420.00	2236.13	-116.06	2234.71	0.00	
10524.00†	90.000	90.127	7420.00	2336.13	-116.28	2334.71	0.00	
10624.00†	90.000	90.127	7420.00	2436.12	-116.50	2434.71	0.00	
10724.00†	90.000	90.127	7420.00	2536.11	-116.72	2534.71	0.00	
10824.00†	90.000	90.127	7420.00	2636.10	-116.94	2634.71	0.00	
10924.00†	90.000	90.127	7420.00	2736.10	-117.16	2734.71	0.00	
11024.00†	90.000	90.127	7420.00	2836.09	-117.39	2834.71	0.00	
11124.00†	90.000	90.127	7420.00	2936.08	-117.61	2934.71	0.00	
11224.00†	90.000	90.127	7420.00	3036.08	-117.83	3034.71	0.00	
11324.00†	90.000	90.127	7420.00	3136.07	-118.05	3134.71	0.00	
11424.00†	90.000	90.127	7420.00	3236.06	-118.27	3234.71	0.00	



# Planned Wellpath Report

VARRA #7 (REV-A.0) PWP

Page 6 of 8



## REFERENCE WELLPATH IDENTIFICATION

Operator	EXTRACTION OIL & GAS	Slot	SLOT#07 VARRA #7(1589'FSL & 788'FWL,SEC.05)
Area	COLORADO	Well	VARRA #7
Field	WELD COUNTY (NAD83/TRUE NORTH)	Wellbore	VARRA #7 PWB
Facility	SEC.05-T06N-R67W		

## WELLPATH DATA (181 stations) † = interpolated/extrapolated station

MD [ft]	Inclination [°]	Azimuth [°]	TVD [ft]	Vert Sect [ft]	North [ft]	East [ft]	DLS [°/100ft]	Comments
11524.00†	90.000	90.127	7420.00	3336.05	-118.49	3334.71	0.00	
11624.00†	90.000	90.127	7420.00	3436.05	-118.71	3434.71	0.00	
11724.00†	90.000	90.127	7420.00	3536.04	-118.93	3534.71	0.00	
11824.00†	90.000	90.127	7420.00	3636.03	-119.15	3634.71	0.00	
11924.00†	90.000	90.127	7420.00	3736.03	-119.37	3734.71	0.00	
12024.00†	90.000	90.127	7420.00	3836.02	-119.59	3834.71	0.00	
12124.00†	90.000	90.127	7420.00	3936.01	-119.81	3934.71	0.00	
12224.00†	90.000	90.127	7420.00	4036.00	-120.04	4034.71	0.00	
12324.00†	90.000	90.127	7420.00	4136.00	-120.26	4134.71	0.00	
12424.00†	90.000	90.127	7420.00	4235.99	-120.48	4234.71	0.00	
12524.00†	90.000	90.127	7420.00	4335.98	-120.70	4334.71	0.00	
12624.00†	90.000	90.127	7420.00	4435.98	-120.92	4434.71	0.00	
12724.00†	90.000	90.127	7420.00	4535.97	-121.14	4534.71	0.00	
12824.00†	90.000	90.127	7420.00	4635.96	-121.36	4634.71	0.00	
12924.00†	90.000	90.127	7420.00	4735.95	-121.58	4734.71	0.00	
13024.00†	90.000	90.127	7420.00	4835.95	-121.80	4834.71	0.00	
13124.00†	90.000	90.127	7420.00	4935.94	-122.02	4934.71	0.00	
13224.00†	90.000	90.127	7420.00	5035.93	-122.24	5034.71	0.00	
13324.00†	90.000	90.127	7420.00	5135.93	-122.46	5134.70	0.00	
13424.00†	90.000	90.127	7420.00	5235.92	-122.69	5234.70	0.00	
13524.00†	90.000	90.127	7420.00	5335.91	-122.91	5334.70	0.00	
13624.00†	90.000	90.127	7420.00	5435.90	-123.13	5434.70	0.00	
13724.00†	90.000	90.127	7420.00	5535.90	-123.35	5534.70	0.00	
13824.00†	90.000	90.127	7420.00	5635.89	-123.57	5634.70	0.00	
13924.00†	90.000	90.127	7420.00	5735.88	-123.79	5734.70	0.00	
14024.00†	90.000	90.127	7420.00	5835.88	-124.01	5834.70	0.00	
14124.00†	90.000	90.127	7420.00	5935.87	-124.23	5934.70	0.00	
14224.00†	90.000	90.127	7420.00	6035.86	-124.45	6034.70	0.00	
14324.00†	90.000	90.127	7420.00	6135.85	-124.67	6134.70	0.00	
14424.00†	90.000	90.127	7420.00	6235.85	-124.89	6234.70	0.00	



# Planned Wellpath Report

VARRA #7 (REV-A.0) PWP

Page 7 of 8



## REFERENCE WELLPATH IDENTIFICATION

Operator	EXTRACTION OIL & GAS	Slot	SLOT#07 VARRA #7(1589'FSL & 788'FWL,SEC.05)
Area	COLORADO	Well	VARRA #7
Field	WELD COUNTY (NAD83/TRUE NORTH)	Wellbore	VARRA #7 PWB
Facility	SEC.05-T06N-R67W		

## WELLPATH DATA (181 stations) † = interpolated/extrapolated station

MD [ft]	Inclination [°]	Azimuth [°]	TVD [ft]	Vert Sect [ft]	North [ft]	East [ft]	DLS [°/100ft]	Comments
14524.00†	90.000	90.127	7420.00	6335.84	-125.11	6334.70	0.00	
14624.00†	90.000	90.127	7420.00	6435.83	-125.34	6434.70	0.00	
14724.00†	90.000	90.127	7420.00	6535.82	-125.56	6534.70	0.00	
14824.00†	90.000	90.127	7420.00	6635.82	-125.78	6634.70	0.00	
14924.00†	90.000	90.127	7420.00	6735.81	-126.00	6734.70	0.00	
15024.00†	90.000	90.127	7420.00	6835.80	-126.22	6834.70	0.00	
15124.00†	90.000	90.127	7420.00	6935.80	-126.44	6934.70	0.00	
15224.00†	90.000	90.127	7420.00	7035.79	-126.66	7034.70	0.00	
15324.00†	90.000	90.127	7420.00	7135.78	-126.88	7134.70	0.00	
15424.00†	90.000	90.127	7420.00	7235.77	-127.10	7234.70	0.00	
15524.00†	90.000	90.127	7420.00	7335.77	-127.32	7334.70	0.00	
15624.00†	90.000	90.127	7420.00	7435.76	-127.54	7434.70	0.00	
15724.00†	90.000	90.127	7420.00	7535.75	-127.76	7534.70	0.00	
15824.00†	90.000	90.127	7420.00	7635.75	-127.99	7634.70	0.00	
15924.00†	90.000	90.127	7420.00	7735.74	-128.21	7734.70	0.00	
16024.00†	90.000	90.127	7420.00	7835.73	-128.43	7834.70	0.00	
16124.00†	90.000	90.127	7420.00	7935.72	-128.65	7934.70	0.00	
16224.00†	90.000	90.127	7420.00	8035.72	-128.87	8034.70	0.00	
16324.00†	90.000	90.127	7420.00	8135.71	-129.09	8134.70	0.00	
16424.00†	90.000	90.127	7420.00	8235.70	-129.31	8234.70	0.00	
16524.00†	90.000	90.127	7420.00	8335.70	-129.53	8334.70	0.00	
16624.00†	90.000	90.127	7420.00	8435.69	-129.75	8434.70	0.00	
16724.00†	90.000	90.127	7420.00	8535.68	-129.97	8534.70	0.00	
16824.00†	90.000	90.127	7420.00	8635.67	-130.19	8634.70	0.00	
16924.00†	90.000	90.127	7420.00	8735.67	-130.41	8734.70	0.00	
17024.00†	90.000	90.127	7420.00	8835.66	-130.64	8834.70	0.00	
17124.00†	90.000	90.127	7420.00	8935.65	-130.86	8934.70	0.00	
17224.00†	90.000	90.127	7420.00	9035.65	-131.08	9034.70	0.00	
17324.00†	90.000	90.127	7420.00	9135.64	-131.30	9134.70	0.00	
17424.00†	90.000	90.127	7420.00	9235.63	-131.52	9234.69	0.00	





# Planned Wellpath Report

VARRA #7 (REV-A.0) PWP

Page 8 of 8



## REFERENCE WELLPATH IDENTIFICATION

Operator	EXTRACTION OIL & GAS	Slot	SLOT#07 VARRA #7(1589'FSL & 788'FWL,SEC.05)
Area	COLORADO	Well	VARRA #7
Field	WELD COUNTY (NAD83/TRUE NORTH)	Wellbore	VARRA #7 PWB
Facility	SEC.05-T06N-R67W		

## WELLPATH DATA (181 stations)

MD [ft]	Inclination [°]	Azimuth [°]	TVD [ft]	Vert Sect [ft]	North [ft]	East [ft]	DLS [°/100ft]	Comments
17467.84	90.000	90.127	7420.00 <sup>2</sup>	9279.47	-131.62	9278.53	0.00	End of Tangent

## HOLE & CASING SECTIONS - Ref Wellbore: VARRA #7 PWB Ref Wellpath: VARRA #7 (REV-A.0) PWP

String/Diameter	Start MD [ft]	End MD [ft]	Interval [ft]	Start TVD [ft]	End TVD [ft]	Start N/S [ft]	Start E/W [ft]	End N/S [ft]	End E/W [ft]
7in Casing Intermediate	24.00	7863.71	7839.71	24.00	7420.00	0.00	0.00	-110.41	-325.57

## TARGETS

Name	MD [ft]	TVD [ft]	North [ft]	East [ft]	Grid East [US ft]	Grid North [US ft]	Latitude	Longitude	Shape
VARRA PAD SECTION 04		0.00	155.91	1.14	3160186.77	1430380.18	40°30'48.118"N	104°55'25.957"W	polygon
VARRA PAD SECTION 05		0.00	155.91	1.14	3160186.77	1430380.18	40°30'48.118"N	104°55'25.957"W	polygon
2) VARRA #7 BHL ON PLAT REV-1(1300'FSL & 460'FEL,SEC.04)	17467.84	7420.00	-131.62	9278.53	3169465.51	1430152.95	40°30'45.259"N	104°53'25.843"W	point
1) VARRA #7 LANDING POINT	7863.71	7420.00	-110.41	-325.57	3159861.80	1430111.76	40°30'45.486"N	104°55'30.187"W	point
VARRA PAD SOUTH 1/2 HARDLINES(460'SETBACKS)		7420.00	155.91	1.14	3160186.77	1430380.18	40°30'48.118"N	104°55'25.957"W	polygon

## SURVEY PROGRAM - Ref Wellbore: VARRA #7 PWB Ref Wellpath: VARRA #7 (REV-A.0) PWP

Start MD [ft]	End MD [ft]	Positional Uncertainty Model	Log Name/Comment	Wellbore
24.00	18000.00	NaviTrak (Standard)		VARRA #7 PWB