

# EXTRACTION OIL & GAS

Location: COLORADO Slot: SLOT#02 VARRA #2(1719'FSL & 791'FWL,SEC.05)  
Field: WELD COUNTY (NAD83/TRUE NORTH) Well: VARRA #2  
Facility: SEC.05-T06N-R67W Wellbore: VARRA #2 PWB

Plot reference wellpath is VARRA #2 (REV-A.0) PWP

True vertical depths are referenced to RIG (RKB)	Grid System: NAD83 / Lambert Colorado SP, Northern Zone (501), US feet
Measured depths are referenced to RIG (RKB)	North Reference: True north
RIG (RKB) to Mean Sea Level: 4898 feet	Scale: True distance
Mean Sea Level to Mud line (At Slot: SLOT#02 VARRA #2(1719'FSL & 791'FWL,SEC.05)): 0 feet	Depths are in feet
Coordinates are in feet referenced to Slot	Created by: painsetr on 4/29/2014

## Location Information

Facility Name				Grid East (US ft)	Grid North (US ft)	Latitude	Longitude
SEC.05-T06N-R67W				3160186.786	1430380.222	40°30'48.118"N	104°55'25.957"W
Slot	Local N (ft)	Local E (ft)		Grid East (US ft)	Grid North (US ft)	Latitude	Longitude
SLOT#02 VARRA #2(1719'FSL & 791'FWL,SEC.05)	-25.91	-0.31		3160186.646	1430354.314	40°30'47.862"N	104°55'25.961"W
RIG (RKB) to Mud line (At Slot: SLOT#02 VARRA #2(1719'FSL & 791'FWL,SEC.05))						4898ft	
Mean Sea Level to Mud line (At Slot: SLOT#02 VARRA #2(1719'FSL & 791'FWL,SEC.05))						0ft	
RIG (RKB) to Mean Sea Level						4898ft	

## Targets

Name	MD (ft)	TVD (ft)	Local N (ft)	Local E (ft)	Grid East (US ft)	Grid North (US ft)	Latitude	Longitude
VARRA PAD SECTION 04		0.00	25.87	0.29	3160186.77	1430380.18	40°30'48.118"N	104°55'25.957"W
VARRA PAD SECTION 05		0.00	25.87	0.29	3160186.77	1430380.18	40°30'48.118"N	104°55'25.957"W
VARRA #2 BHL ON PLAT REV-1(2440'FSL & 460'FEL,SEC.04)	17400.32	7276.00	878.29	9263.07	3169443.50	1431292.74	40°30'56.524"N	104°53'26.027"W
VARRA #2 LANDING POINT	7789.13	7276.00	899.87	-348.10	3159832.72	1431251.87	40°30'56.754"N	104°53'30.468"W
VARRA PAD CENTER HARDLINES(460' SETBACKS)		7420.00	25.87	0.29	3160186.77	1430380.18	40°30'48.118"N	104°55'25.957"W

## Survey Program

Start MD (ft)	End MD (ft)	Tool	Model	Log Name/Comment	Wellbore
24.00	18000.00	NaviTrak	NaviTrak (Standard)		VARRA #2 PWB

## Well Profile Data

Design Comment	MD (ft)	Inc (°)	Az (°)	TVD (ft)	Local N (ft)	Local E (ft)	DLS (°/100ft)	VS (ft)
Tie On	24.00	0.000	309.120	24.00	0.00	0.00	0.00	0.00
End of Tangent	800.00	0.000	309.120	800.00	0.00	0.00	0.00	0.00
End of Build	1454.29	13.086	309.120	1448.61	46.94	-57.72	2.00	-53.03
End of Tangent	6676.51	13.086	309.120	6535.23	792.94	-975.02	0.00	-895.82
End of 3D Arc	7789.13	90.000	90.129	7276.00	899.87	-348.10	9.00	-261.60
End of Tangent	17400.32	90.000	90.129	7276.00	878.29	9263.07	0.00	9304.62

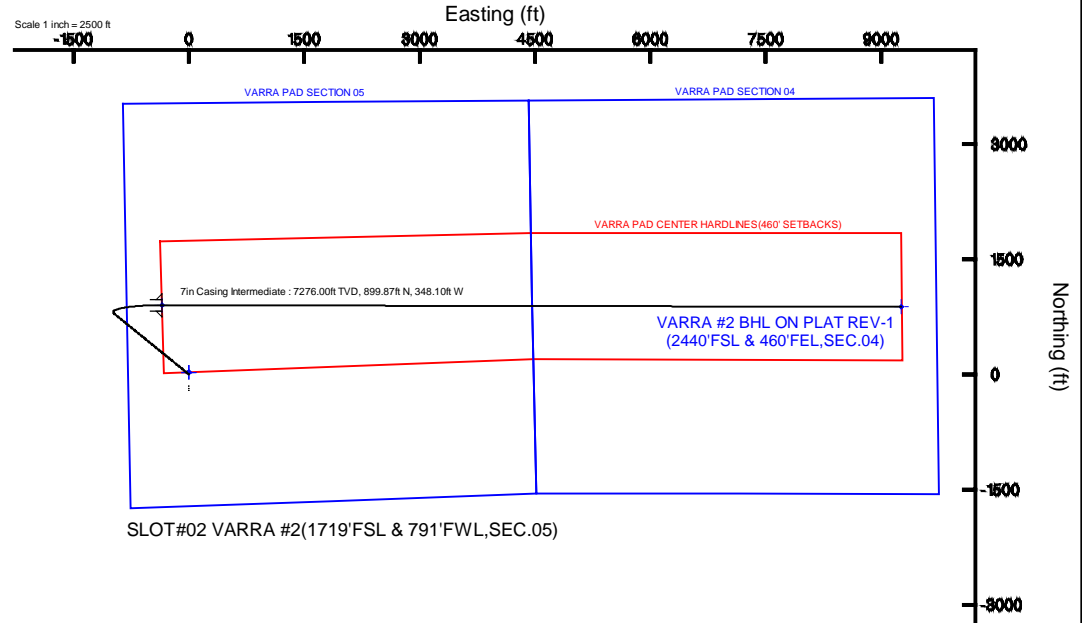

BGGM (1945.0 to 2015.0) Dip: 67.00° Field: 52835.3 nT  
Magnetic North is 8.62 degrees East of True North (at 4/17/2014)

To correct azimuth from Magnetic to True add 8.62 degrees

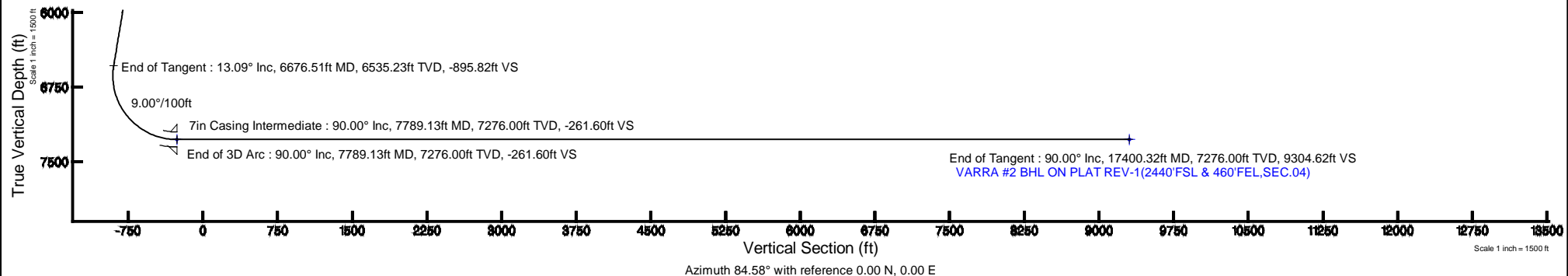



# Planned Wellpath Report

VARRA #2 (REV-A.0) PWP

Page 1 of 8



## REFERENCE WELLPATH IDENTIFICATION

Operator	EXTRACTION OIL & GAS	Slot	SLOT#02 VARRA #2(1719'FSL & 791'FWL,SEC.05)
Area	COLORADO	Well	VARRA #2
Field	WELD COUNTY (NAD83/TRUE NORTH)	Wellbore	VARRA #2 PWB
Facility	SEC.05-T06N-R67W		

## REPORT SETUP INFORMATION

Projection System	NAD83 / Lambert Colorado SP, Northern Zone (501), US feet	Software System	WellArchitect® 4.0.0
North Reference	True	User	Painsetr
Scale	0.999967	Report Generated	4/29/2014 at 1:36:25 PM
Convergence at slot	n/a	Database/Source file	WA_Denver/VARRA_#2_PWB.xml

## WELLPATH LOCATION

	Local coordinates		Grid coordinates		Geographic coordinates	
	North[ft]	East[ft]	Easting[US ft]	Northing[US ft]	Latitude	Longitude
Slot Location	-25.91	-0.31	3160186.65	1430354.31	40°30'47.862"N	104°55'25.961"W
Facility Reference Pt			3160186.79	1430380.22	40°30'48.118"N	104°55'25.957"W
Field Reference Pt			3185481.27	1419166.81	40°28'55.560"N	104°49'59.556"W

## WELLPATH DATUM

Calculation method	Minimum curvature	RIG (RKB) to Facility Vertical Datum	4898.00ft
Horizontal Reference Pt	Slot	RIG (RKB) to Mean Sea Level	4898.00ft
Vertical Reference Pt	RIG (RKB)	RIG (RKB) to Mud Line at Slot (SLOT#02 VARRA #2(1719'FSL & 791'FWL,SEC.05))	4898.00ft
MD Reference Pt	RIG (RKB)	Section Origin	N 0.00, E 0.00 ft
Field Vertical Reference	Mean Sea Level	Section Azimuth	84.58°



# Planned Wellpath Report

VARRA #2 (REV-A.0) PWP

Page 2 of 8



## REFERENCE WELLPATH IDENTIFICATION

Operator	EXTRACTION OIL & GAS	Slot	SLOT#02 VARRA #2(1719'FSL & 791'FWL,SEC.05)
Area	COLORADO	Well	VARRA #2
Field	WELD COUNTY (NAD83/TRUE NORTH)	Wellbore	VARRA #2 PWB
Facility	SEC.05-T06N-R67W		

## WELLPATH DATA (180 stations) † = interpolated/extrapolated station

MD [ft]	Inclination [°]	Azimuth [°]	TVD [ft]	Vert Sect [ft]	North [ft]	East [ft]	DLS [°/100ft]	Comments
0.00†	0.000	309.120	0.00	0.00	0.00	0.00	0.00	
24.00	0.000	309.120	24.00	0.00	0.00	0.00	0.00	Tie On
124.00†	0.000	309.120	124.00	0.00	0.00	0.00	0.00	
224.00†	0.000	309.120	224.00	0.00	0.00	0.00	0.00	
324.00†	0.000	309.120	324.00	0.00	0.00	0.00	0.00	
424.00†	0.000	309.120	424.00	0.00	0.00	0.00	0.00	
524.00†	0.000	309.120	524.00	0.00	0.00	0.00	0.00	
624.00†	0.000	309.120	624.00	0.00	0.00	0.00	0.00	
724.00†	0.000	309.120	724.00	0.00	0.00	0.00	0.00	
800.00	0.000	309.120	800.00	0.00	0.00	0.00	0.00	End of Tangent
824.00†	0.480	309.120	824.00	-0.07	0.06	-0.08	2.00	
924.00†	2.480	309.120	923.96	-1.91	1.69	-2.08	2.00	
1024.00†	4.480	309.120	1023.77	-6.24	5.52	-6.79	2.00	
1124.00†	6.480	309.120	1123.31	-13.05	11.55	-14.20	2.00	
1224.00†	8.480	309.120	1222.45	-22.32	19.76	-24.30	2.00	
1324.00†	10.480	309.120	1321.08	-34.06	30.15	-37.08	2.00	
1424.00†	12.480	309.120	1419.08	-48.25	42.71	-52.52	2.00	
1454.29	13.086	309.120	1448.61	-53.03	46.94	-57.72	2.00	End of Build
1524.00†	13.086	309.120	1516.52	-64.28	56.90	-69.96	0.00	
1624.00†	13.086	309.120	1613.92	-80.42	71.18	-87.53	0.00	
1724.00†	13.086	309.120	1711.32	-96.56	85.47	-105.09	0.00	
1824.00†	13.086	309.120	1808.73	-112.69	99.75	-122.66	0.00	
1924.00†	13.086	309.120	1906.13	-128.83	114.04	-140.22	0.00	
2024.00†	13.086	309.120	2003.53	-144.97	128.32	-157.79	0.00	
2124.00†	13.086	309.120	2100.94	-161.11	142.61	-175.35	0.00	
2224.00†	13.086	309.120	2198.34	-177.25	156.89	-192.92	0.00	
2324.00†	13.086	309.120	2295.74	-193.39	171.18	-210.48	0.00	
2424.00†	13.086	309.120	2393.15	-209.53	185.46	-228.05	0.00	
2524.00†	13.086	309.120	2490.55	-225.66	199.75	-245.62	0.00	
2624.00†	13.086	309.120	2587.95	-241.80	214.03	-263.18	0.00	



# Planned Wellpath Report

VARRA #2 (REV-A.0) PWP

Page 3 of 8



## REFERENCE WELLPATH IDENTIFICATION

Operator	EXTRACTION OIL & GAS	Slot	SLOT#02 VARRA #2(1719'FSL & 791'FWL,SEC.05)
Area	COLORADO	Well	VARRA #2
Field	WELD COUNTY (NAD83/TRUE NORTH)	Wellbore	VARRA #2 PWB
Facility	SEC.05-T06N-R67W		

## WELLPATH DATA (180 stations) † = interpolated/extrapolated station

MD [ft]	Inclination [°]	Azimuth [°]	TVD [ft]	Vert Sect [ft]	North [ft]	East [ft]	DLS [°/100ft]	Comments
2724.00†	13.086	309.120	2685.36	-257.94	228.32	-280.75	0.00	
2824.00†	13.086	309.120	2782.76	-274.08	242.60	-298.31	0.00	
2924.00†	13.086	309.120	2880.16	-290.22	256.89	-315.88	0.00	
3024.00†	13.086	309.120	2977.56	-306.36	271.17	-333.44	0.00	
3124.00†	13.086	309.120	3074.97	-322.50	285.46	-351.01	0.00	
3224.00†	13.086	309.120	3172.37	-338.63	299.74	-368.57	0.00	
3324.00†	13.086	309.120	3269.77	-354.77	314.03	-386.14	0.00	
3424.00†	13.086	309.120	3367.18	-370.91	328.31	-403.70	0.00	
3524.00†	13.086	309.120	3464.58	-387.05	342.60	-421.27	0.00	
3624.00†	13.086	309.120	3561.98	-403.19	356.88	-438.84	0.00	
3724.00†	13.086	309.120	3659.39	-419.33	371.17	-456.40	0.00	
3824.00†	13.086	309.120	3756.79	-435.47	385.45	-473.97	0.00	
3924.00†	13.086	309.120	3854.19	-451.60	399.74	-491.53	0.00	
4024.00†	13.086	309.120	3951.60	-467.74	414.02	-509.10	0.00	
4124.00†	13.086	309.120	4049.00	-483.88	428.31	-526.66	0.00	
4224.00†	13.086	309.120	4146.40	-500.02	442.59	-544.23	0.00	
4324.00†	13.086	309.120	4243.81	-516.16	456.88	-561.79	0.00	
4424.00†	13.086	309.120	4341.21	-532.30	471.16	-579.36	0.00	
4524.00†	13.086	309.120	4438.61	-548.44	485.45	-596.92	0.00	
4624.00†	13.086	309.120	4536.02	-564.57	499.73	-614.49	0.00	
4724.00†	13.086	309.120	4633.42	-580.71	514.02	-632.06	0.00	
4824.00†	13.086	309.120	4730.82	-596.85	528.30	-649.62	0.00	
4924.00†	13.086	309.120	4828.23	-612.99	542.59	-667.19	0.00	
5024.00†	13.086	309.120	4925.63	-629.13	556.87	-684.75	0.00	
5124.00†	13.086	309.120	5023.03	-645.27	571.16	-702.32	0.00	
5224.00†	13.086	309.120	5120.44	-661.41	585.44	-719.88	0.00	
5324.00†	13.086	309.120	5217.84	-677.54	599.73	-737.45	0.00	
5424.00†	13.086	309.120	5315.24	-693.68	614.02	-755.01	0.00	
5524.00†	13.086	309.120	5412.65	-709.82	628.30	-772.58	0.00	
5624.00†	13.086	309.120	5510.05	-725.96	642.59	-790.14	0.00	



# Planned Wellpath Report

VARRA #2 (REV-A.0) PWP

Page 4 of 8



## REFERENCE WELLPATH IDENTIFICATION

Operator	EXTRACTION OIL & GAS	Slot	SLOT#02 VARRA #2(1719'FSL & 791'FWL,SEC.05)
Area	COLORADO	Well	VARRA #2
Field	WELD COUNTY (NAD83/TRUE NORTH)	Wellbore	VARRA #2 PWB
Facility	SEC.05-T06N-R67W		

## WELLPATH DATA (180 stations) † = interpolated/extrapolated station

MD [ft]	Inclination [°]	Azimuth [°]	TVD [ft]	Vert Sect [ft]	North [ft]	East [ft]	DLS [°/100ft]	Comments
5724.00†	13.086	309.120	5607.45	-742.10	656.87	-807.71	0.00	
5824.00†	13.086	309.120	5704.86	-758.24	671.16	-825.28	0.00	
5924.00†	13.086	309.120	5802.26	-774.38	685.44	-842.84	0.00	
6024.00†	13.086	309.120	5899.66	-790.51	699.73	-860.41	0.00	
6124.00†	13.086	309.120	5997.07	-806.65	714.01	-877.97	0.00	
6224.00†	13.086	309.120	6094.47	-822.79	728.30	-895.54	0.00	
6324.00†	13.086	309.120	6191.87	-838.93	742.58	-913.10	0.00	
6424.00†	13.086	309.120	6289.28	-855.07	756.87	-930.67	0.00	
6524.00†	13.086	309.120	6386.68	-871.21	771.15	-948.23	0.00	
6624.00†	13.086	309.120	6484.08	-887.35	785.44	-965.80	0.00	
6676.51	13.086	309.120	6535.23	-895.82	792.94	-975.02	0.00	End of Tangent
6724.00†	10.166	324.776	6581.75	-901.74	799.76	-981.61	9.00	
6824.00†	8.889	20.879	6680.57	-902.71	814.21	-983.96	9.00	
6924.00†	14.681	56.195	6778.54	-888.10	828.51	-970.64	9.00	
7024.00†	22.647	69.608	6873.24	-858.30	842.30	-942.01	9.00	
7124.00†	31.162	76.132	6962.36	-814.02	855.24	-898.76	9.00	
7224.00†	39.874	80.045	7043.68	-756.35	867.00	-841.95	9.00	
7324.00†	48.677	82.740	7115.22	-686.72	877.31	-772.99	9.00	
7424.00†	57.527	84.788	7175.20	-606.85	885.90	-693.57	9.00	
7524.00†	66.405	86.466	7222.16	-518.69	892.57	-605.64	9.00	
7624.00†	75.298	87.929	7254.93	-424.42	897.16	-511.39	9.00	
7724.00†	84.200	89.277	7272.71	-326.36	899.54	-413.11	9.00	
7789.13	90.000	90.129	7276.00 <sup>†</sup>	-261.60	899.87	-348.10	9.00	End of 3D Arc
7824.00†	90.000	90.129	7276.00	-226.89	899.79	-313.23	0.00	
7924.00†	90.000	90.129	7276.00	-127.36	899.57	-213.23	0.00	
8024.00†	90.000	90.129	7276.00	-27.83	899.34	-113.23	0.00	
8124.00†	90.000	90.129	7276.00	71.70	899.12	-13.23	0.00	
8224.00†	90.000	90.129	7276.00	171.24	898.89	86.77	0.00	
8324.00†	90.000	90.129	7276.00	270.77	898.67	186.77	0.00	
8424.00†	90.000	90.129	7276.00	370.30	898.45	286.77	0.00	



# Planned Wellpath Report

VARRA #2 (REV-A.0) PWP

Page 5 of 8



## REFERENCE WELLPATH IDENTIFICATION

Operator	EXTRACTION OIL & GAS	Slot	SLOT#02 VARRA #2(1719'FSL & 791'FWL,SEC.05)
Area	COLORADO	Well	VARRA #2
Field	WELD COUNTY (NAD83/TRUE NORTH)	Wellbore	VARRA #2 PWB
Facility	SEC.05-T06N-R67W		

## WELLPATH DATA (180 stations) † = interpolated/extrapolated station

MD [ft]	Inclination [°]	Azimuth [°]	TVD [ft]	Vert Sect [ft]	North [ft]	East [ft]	DLS [°/100ft]	Comments
8524.00†	90.000	90.129	7276.00	469.83	898.22	386.77	0.00	
8624.00†	90.000	90.129	7276.00	569.36	898.00	486.77	0.00	
8724.00†	90.000	90.129	7276.00	668.90	897.77	586.77	0.00	
8824.00†	90.000	90.129	7276.00	768.43	897.55	686.77	0.00	
8924.00†	90.000	90.129	7276.00	867.96	897.32	786.77	0.00	
9024.00†	90.000	90.129	7276.00	967.49	897.10	886.77	0.00	
9124.00†	90.000	90.129	7276.00	1067.02	896.87	986.77	0.00	
9224.00†	90.000	90.129	7276.00	1166.56	896.65	1086.77	0.00	
9324.00†	90.000	90.129	7276.00	1266.09	896.43	1186.77	0.00	
9424.00†	90.000	90.129	7276.00	1365.62	896.20	1286.77	0.00	
9524.00†	90.000	90.129	7276.00	1465.15	895.98	1386.77	0.00	
9624.00†	90.000	90.129	7276.00	1564.68	895.75	1486.77	0.00	
9724.00†	90.000	90.129	7276.00	1664.22	895.53	1586.77	0.00	
9824.00†	90.000	90.129	7276.00	1763.75	895.30	1686.77	0.00	
9924.00†	90.000	90.129	7276.00	1863.28	895.08	1786.77	0.00	
10024.00†	90.000	90.129	7276.00	1962.81	894.85	1886.77	0.00	
10124.00†	90.000	90.129	7276.00	2062.34	894.63	1986.77	0.00	
10224.00†	90.000	90.129	7276.00	2161.88	894.40	2086.77	0.00	
10324.00†	90.000	90.129	7276.00	2261.41	894.18	2186.77	0.00	
10424.00†	90.000	90.129	7276.00	2360.94	893.96	2286.77	0.00	
10524.00†	90.000	90.129	7276.00	2460.47	893.73	2386.77	0.00	
10624.00†	90.000	90.129	7276.00	2560.00	893.51	2486.77	0.00	
10724.00†	90.000	90.129	7276.00	2659.54	893.28	2586.77	0.00	
10824.00†	90.000	90.129	7276.00	2759.07	893.06	2686.77	0.00	
10924.00†	90.000	90.129	7276.00	2858.60	892.83	2786.77	0.00	
11024.00†	90.000	90.129	7276.00	2958.13	892.61	2886.77	0.00	
11124.00†	90.000	90.129	7276.00	3057.66	892.38	2986.77	0.00	
11224.00†	90.000	90.129	7276.00	3157.20	892.16	3086.77	0.00	
11324.00†	90.000	90.129	7276.00	3256.73	891.93	3186.77	0.00	
11424.00†	90.000	90.129	7276.00	3356.26	891.71	3286.77	0.00	



# Planned Wellpath Report

VARRA #2 (REV-A.0) PWP

Page 6 of 8



## REFERENCE WELLPATH IDENTIFICATION

Operator	EXTRACTION OIL & GAS	Slot	SLOT#02 VARRA #2(1719'FSL & 791'FWL,SEC.05)
Area	COLORADO	Well	VARRA #2
Field	WELD COUNTY (NAD83/TRUE NORTH)	Wellbore	VARRA #2 PWB
Facility	SEC.05-T06N-R67W		

## WELLPATH DATA (180 stations) † = interpolated/extrapolated station

MD [ft]	Inclination [°]	Azimuth [°]	TVD [ft]	Vert Sect [ft]	North [ft]	East [ft]	DLS [°/100ft]	Comments
11524.00†	90.000	90.129	7276.00	3455.79	891.49	3386.76	0.00	
11624.00†	90.000	90.129	7276.00	3555.33	891.26	3486.76	0.00	
11724.00†	90.000	90.129	7276.00	3654.86	891.04	3586.76	0.00	
11824.00†	90.000	90.129	7276.00	3754.39	890.81	3686.76	0.00	
11924.00†	90.000	90.129	7276.00	3853.92	890.59	3786.76	0.00	
12024.00†	90.000	90.129	7276.00	3953.45	890.36	3886.76	0.00	
12124.00†	90.000	90.129	7276.00	4052.99	890.14	3986.76	0.00	
12224.00†	90.000	90.129	7276.00	4152.52	889.91	4086.76	0.00	
12324.00†	90.000	90.129	7276.00	4252.05	889.69	4186.76	0.00	
12424.00†	90.000	90.129	7276.00	4351.58	889.47	4286.76	0.00	
12524.00†	90.000	90.129	7276.00	4451.11	889.24	4386.76	0.00	
12624.00†	90.000	90.129	7276.00	4550.65	889.02	4486.76	0.00	
12724.00†	90.000	90.129	7276.00	4650.18	888.79	4586.76	0.00	
12824.00†	90.000	90.129	7276.00	4749.71	888.57	4686.76	0.00	
12924.00†	90.000	90.129	7276.00	4849.24	888.34	4786.76	0.00	
13024.00†	90.000	90.129	7276.00	4948.77	888.12	4886.76	0.00	
13124.00†	90.000	90.129	7276.00	5048.31	887.89	4986.76	0.00	
13224.00†	90.000	90.129	7276.00	5147.84	887.67	5086.76	0.00	
13324.00†	90.000	90.129	7276.00	5247.37	887.44	5186.76	0.00	
13424.00†	90.000	90.129	7276.00	5346.90	887.22	5286.76	0.00	
13524.00†	90.000	90.129	7276.00	5446.43	887.00	5386.76	0.00	
13624.00†	90.000	90.129	7276.00	5545.97	886.77	5486.76	0.00	
13724.00†	90.000	90.129	7276.00	5645.50	886.55	5586.76	0.00	
13824.00†	90.000	90.129	7276.00	5745.03	886.32	5686.76	0.00	
13924.00†	90.000	90.129	7276.00	5844.56	886.10	5786.76	0.00	
14024.00†	90.000	90.129	7276.00	5944.09	885.87	5886.76	0.00	
14124.00†	90.000	90.129	7276.00	6043.63	885.65	5986.76	0.00	
14224.00†	90.000	90.129	7276.00	6143.16	885.42	6086.76	0.00	
14324.00†	90.000	90.129	7276.00	6242.69	885.20	6186.76	0.00	
14424.00†	90.000	90.129	7276.00	6342.22	884.97	6286.76	0.00	



# Planned Wellpath Report

VARRA #2 (REV-A.0) PWP

Page 7 of 8



## REFERENCE WELLPATH IDENTIFICATION

Operator	EXTRACTION OIL & GAS	Slot	SLOT#02 VARRA #2(1719'FSL & 791'FWL,SEC.05)
Area	COLORADO	Well	VARRA #2
Field	WELD COUNTY (NAD83/TRUE NORTH)	Wellbore	VARRA #2 PWB
Facility	SEC.05-T06N-R67W		

## WELLPATH DATA (180 stations) † = interpolated/extrapolated station

MD [ft]	Inclination [°]	Azimuth [°]	TVD [ft]	Vert Sect [ft]	North [ft]	East [ft]	DLS [°/100ft]	Comments
14524.00†	90.000	90.129	7276.00	6441.75	884.75	6386.76	0.00	
14624.00†	90.000	90.129	7276.00	6541.29	884.53	6486.76	0.00	
14724.00†	90.000	90.129	7276.00	6640.82	884.30	6586.76	0.00	
14824.00†	90.000	90.129	7276.00	6740.35	884.08	6686.76	0.00	
14924.00†	90.000	90.129	7276.00	6839.88	883.85	6786.76	0.00	
15024.00†	90.000	90.129	7276.00	6939.42	883.63	6886.76	0.00	
15124.00†	90.000	90.129	7276.00	7038.95	883.40	6986.76	0.00	
15224.00†	90.000	90.129	7276.00	7138.48	883.18	7086.76	0.00	
15324.00†	90.000	90.129	7276.00	7238.01	882.95	7186.76	0.00	
15424.00†	90.000	90.129	7276.00	7337.54	882.73	7286.76	0.00	
15524.00†	90.000	90.129	7276.00	7437.08	882.51	7386.75	0.00	
15624.00†	90.000	90.129	7276.00	7536.61	882.28	7486.75	0.00	
15724.00†	90.000	90.129	7276.00	7636.14	882.06	7586.75	0.00	
15824.00†	90.000	90.129	7276.00	7735.67	881.83	7686.75	0.00	
15924.00†	90.000	90.129	7276.00	7835.20	881.61	7786.75	0.00	
16024.00†	90.000	90.129	7276.00	7934.74	881.38	7886.75	0.00	
16124.00†	90.000	90.129	7276.00	8034.27	881.16	7986.75	0.00	
16224.00†	90.000	90.129	7276.00	8133.80	880.93	8086.75	0.00	
16324.00†	90.000	90.129	7276.00	8233.33	880.71	8186.75	0.00	
16424.00†	90.000	90.129	7276.00	8332.86	880.48	8286.75	0.00	
16524.00†	90.000	90.129	7276.00	8432.40	880.26	8386.75	0.00	
16624.00†	90.000	90.129	7276.00	8531.93	880.04	8486.75	0.00	
16724.00†	90.000	90.129	7276.00	8631.46	879.81	8586.75	0.00	
16824.00†	90.000	90.129	7276.00	8730.99	879.59	8686.75	0.00	
16924.00†	90.000	90.129	7276.00	8830.52	879.36	8786.75	0.00	
17024.00†	90.000	90.129	7276.00	8930.06	879.14	8886.75	0.00	
17124.00†	90.000	90.129	7276.00	9029.59	878.91	8986.75	0.00	
17224.00†	90.000	90.129	7276.00	9129.12	878.69	9086.75	0.00	
17324.00†	90.000	90.129	7276.00	9228.65	878.46	9186.75	0.00	
17400.32	90.000	90.129	7276.00 <sup>2</sup>	9304.62	878.29	9263.07	0.00	End of Tangent





# Planned Wellpath Report

VARRA #2 (REV-A.0) PWP

Page 8 of 8



## REFERENCE WELLPATH IDENTIFICATION

Operator	EXTRACTION OIL & GAS	Slot	SLOT#02 VARRA #2(1719'FSL & 791'FWL,SEC.05)
Area	COLORADO	Well	VARRA #2
Field	WELD COUNTY (NAD83/TRUE NORTH)	Wellbore	VARRA #2 PWB
Facility	SEC.05-T06N-R67W		

## HOLE & CASING SECTIONS - Ref Wellbore: VARRA #2 PWB Ref Wellpath: VARRA #2 (REV-A.0) PWP

String/Diameter	Start MD [ft]	End MD [ft]	Interval [ft]	Start TVD [ft]	End TVD [ft]	Start N/S [ft]	Start E/W [ft]	End N/S [ft]	End E/W [ft]
7in Casing Intermediate	24.00	7789.13	7765.13	24.00	7276.00	0.00	0.00	899.87	-348.10

## TARGETS

Name	MD [ft]	TVD [ft]	North [ft]	East [ft]	Grid East [US ft]	Grid North [US ft]	Latitude	Longitude	Shape
VARRA PAD SECTION 04		0.00	25.87	0.29	3160186.77	1430380.18	40°30'48.118"N	104°55'25.957"W	polygon
VARRA PAD SECTION 05		0.00	25.87	0.29	3160186.77	1430380.18	40°30'48.118"N	104°55'25.957"W	polygon
2) VARRA #2 BHL ON PLAT REV-1(2440'FSL & 460'FEL,SEC.04)	17400.32	7276.00	878.29	9263.07	3169443.50	1431292.74	40°30'56.524"N	104°53'26.027"W	point
1) VARRA #2 LANDING POINT	7789.13	7276.00	899.87	-348.10	3159832.72	1431251.87	40°30'56.754"N	104°55'30.468"W	point
VARRA PAD CENTER HARDLINES(460' SETBACKS)		7420.00	25.87	0.29	3160186.77	1430380.18	40°30'48.118"N	104°55'25.957"W	polygon

## SURVEY PROGRAM - Ref Wellbore: VARRA #2 PWB Ref Wellpath: VARRA #2 (REV-A.0) PWP

Start MD [ft]	End MD [ft]	Positional Uncertainty Model	Log Name/Comment	Wellbore
24.00	18000.00	NaviTrak (Standard)		VARRA #2 PWB