

EXTRACTION OIL & GAS

Location: COLORADO Slot: SLOT#04 VARRA #4(1667'FSL & 790'FWL,SEC.05)
Field: WELD COUNTY (NAD83/TRUE NORTH) Well: VARRA #4
Facility: SEC.05-T06N-R67W Wellbore: VARRA #4 PWB

Plot reference wellpath is VARRA #4 (REV-A.0) PWP

True vertical depths are referenced to RIG (RKB)	Grid System: NAD83 / Lambert Colorado SP, Northern Zone (501), US feet
Measured depths are referenced to RIG (RKB)	North Reference: True north
RIG (RKB) to Mean Sea Level: 4898 feet	Scale: True distance
Mean Sea Level to Mud line (At Slot: SLOT#04 VARRA #4(1667'FSL & 790'FWL,SEC.05)): 0 feet	Depths are in feet
Coordinates are in feet referenced to Slot	Created by: painsetr on 4/29/2014

Location Information

Facility Name			Grid East (US ft)	Grid North (US ft)	Latitude	Longitude
SEC.05-T06N-R67W			3160186.786	1430380.222	40°30'48.118"N	104°55'25.957"W
Slot	Local N (ft)	Local E (ft)	Grid East (US ft)	Grid North (US ft)	Latitude	Longitude
SLOT#04 VARRA #4(1667FSL & 790FWL,SEC.05)	-78.03	-0.54	3160186.753	1430302.198	40°30'47.347"N	104°55'25.964"W
RIG (RKB) to Mud line (At Slot: SLOT#04 VARRA #4(1667FSL & 790FWL,SEC.05))					4898ft	
Mean Sea Level to Mud line (At Slot: SLOT#04 VARRA #4(1667FSL & 790FWL,SEC.05))					0ft	
RIG (RKB) to Mean Sea Level					4898ft	

Targets

Name	MD (ft)	TVD (ft)	Local N (ft)	Local E (ft)	Grid East (US ft)	Grid North (US ft)	Latitude	Longitude
VARRA PAD SECTION 04		0.00	77.98	0.53	3160186.77	1430380.18	40°30'48.118"N	104°55'25.957"W
VARRA PAD SECTION 05		0.00	77.98	0.53	3160186.77	1430380.18	40°30'48.118"N	104°55'25.957"W
VARRA #4 BHL ON PLAT REV-1(1950'FSL & 460'FEL,SEC.04)	17489.92	7420.00	440.40	9269.61	3169452.98	1430802.80	40°30'51.682"N	104°53'25.948"W
VARRA #4 LANDING POINT	7881.59	7420.00	461.62	-338.70	3159845.08	1430761.59	40°30'51.908"N	104°55'30.349"W
VARRA PAD CENTER HARDLINES(460' SETBACKS)		7420.00	77.98	0.53	3160186.77	1430380.18	40°30'48.118"N	104°55'25.957"W

Survey Program

Start MD (ft)	End MD (ft)	Tool	Model	Log Name/Comment	Wellbore
24.00	18000.00	NaviTrak	NaviTrak (Standard)		VARRA #4 PWB

Well Profile Data

Design Comment	MD (ft)	Inc (°)	Az (°)	TVD (ft)	Local N (ft)	Local E (ft)	DLS (°/100ft)	VS (ft)
Tie On	24.00	0.000	292.950	24.00	0.00	0.00	0.00	0.00
End of Tangent	800.00	0.000	292.950	800.00	0.00	0.00	0.00	0.00
End of Build	1329.53	10.591	292.950	1326.52	19.03	-44.94	2.00	-43.98
End of Tangent	6773.23	10.591	292.950	6677.49	409.15	-966.23	0.00	-945.73
End of 3D Arc	7881.59	90.000	90.126	7420.00	461.62	-338.70	9.00	-316.41
End of Tangent	17489.92	90.000	90.126	7420.00	440.40	9269.61	0.00	9280.06

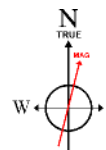
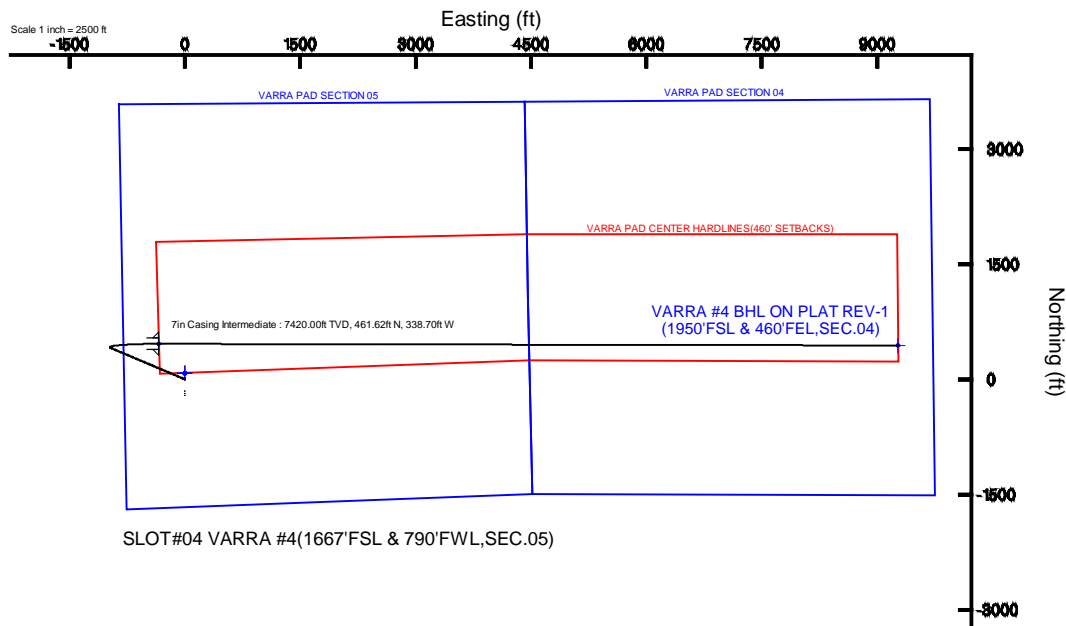

BGGM (1945.0 to 2015.0) Dip: 67.00° Field: 52835.3 nT
Magnetic North is 8.62 degrees East of True North (at 4/17/2014)

To correct azimuth from Magnetic to True add 8.62 degrees

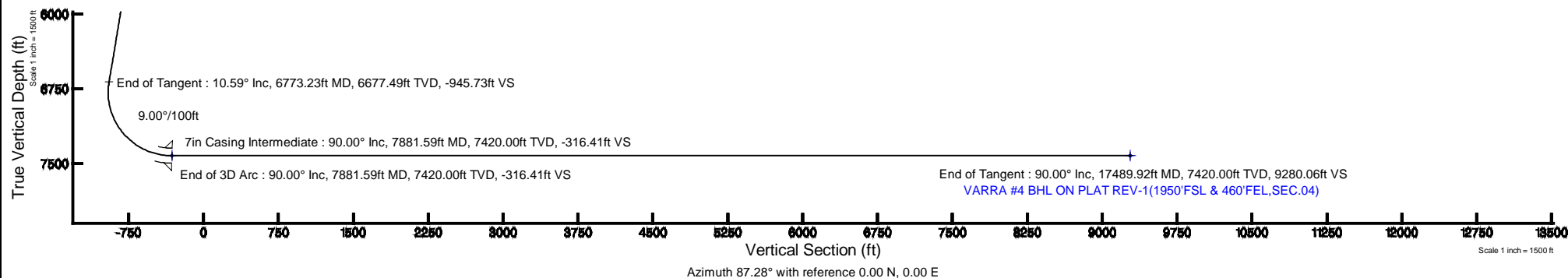



Planned Wellpath Report

VARRA #4 (REV-A.0) PWP

Page 1 of 8



REFERENCE WELLPATH IDENTIFICATION

Operator	EXTRACTION OIL & GAS	Slot	SLOT#04 VARRA #4(1667'FSL & 790'FWL,SEC.05)
Area	COLORADO	Well	VARRA #4
Field	WELD COUNTY (NAD83/TRUE NORTH)	Wellbore	VARRA #4 PWB
Facility	SEC.05-T06N-R67W		

REPORT SETUP INFORMATION

Projection System	NAD83 / Lambert Colorado SP, Northern Zone (501), US feet	Software System	WellArchitect® 4.0.0
North Reference	True	User	Painsetr
Scale	0.999967	Report Generated	4/29/2014 at 1:47:02 PM
Convergence at slot	n/a	Database/Source file	WA_Denver/VARRA_#4_PWB.xml

WELLPATH LOCATION

	Local coordinates		Grid coordinates		Geographic coordinates	
	North[ft]	East[ft]	Easting[US ft]	Northing[US ft]	Latitude	Longitude
Slot Location	-78.03	-0.54	3160186.75	1430302.20	40°30'47.347"N	104°55'25.964"W
Facility Reference Pt			3160186.79	1430380.22	40°30'48.118"N	104°55'25.957"W
Field Reference Pt			3185481.27	1419166.81	40°28'55.560"N	104°49'59.556"W

WELLPATH DATUM

Calculation method	Minimum curvature	RIG (RKB) to Facility Vertical Datum	4898.00ft
Horizontal Reference Pt	Slot	RIG (RKB) to Mean Sea Level	4898.00ft
Vertical Reference Pt	RIG (RKB)	RIG (RKB) to Mud Line at Slot (SLOT#04 VARRA #4(1667'FSL & 790'FWL,SEC.05))	4898.00ft
MD Reference Pt	RIG (RKB)	Section Origin	N 0.00, E 0.00 ft
Field Vertical Reference	Mean Sea Level	Section Azimuth	87.28°



Planned Wellpath Report

VARRA #4 (REV-A.0) PWP

Page 2 of 8



REFERENCE WELLPATH IDENTIFICATION

Operator	EXTRACTION OIL & GAS	Slot	SLOT#04 VARRA #4(1667'FSL & 790'FWL,SEC.05)
Area	COLORADO	Well	VARRA #4
Field	WELD COUNTY (NAD83/TRUE NORTH)	Wellbore	VARRA #4 PWB
Facility	SEC.05-T06N-R67W		

WELLPATH DATA (181 stations) † = interpolated/extrapolated station

MD [ft]	Inclination [°]	Azimuth [°]	TVD [ft]	Vert Sect [ft]	North [ft]	East [ft]	DLS [°/100ft]	Comments
0.00†	0.000	292.950	0.00	0.00	0.00	0.00	0.00	
24.00	0.000	292.950	24.00	0.00	0.00	0.00	0.00	Tie On
124.00†	0.000	292.950	124.00	0.00	0.00	0.00	0.00	
224.00†	0.000	292.950	224.00	0.00	0.00	0.00	0.00	
324.00†	0.000	292.950	324.00	0.00	0.00	0.00	0.00	
424.00†	0.000	292.950	424.00	0.00	0.00	0.00	0.00	
524.00†	0.000	292.950	524.00	0.00	0.00	0.00	0.00	
624.00†	0.000	292.950	624.00	0.00	0.00	0.00	0.00	
724.00†	0.000	292.950	724.00	0.00	0.00	0.00	0.00	
800.00	0.000	292.950	800.00	0.00	0.00	0.00	0.00	End of Tangent
824.00†	0.480	292.950	824.00	-0.09	0.04	-0.09	2.00	
924.00†	2.480	292.950	923.96	-2.42	1.05	-2.47	2.00	
1024.00†	4.480	292.950	1023.77	-7.89	3.41	-8.06	2.00	
1124.00†	6.480	292.950	1123.31	-16.50	7.14	-16.85	2.00	
1224.00†	8.480	292.950	1222.45	-28.23	12.21	-28.84	2.00	
1324.00†	10.480	292.950	1321.08	-43.07	18.63	-44.01	2.00	
1329.53	10.591	292.950	1326.52	-43.98	19.03	-44.94	2.00	End of Build
1424.00†	10.591	292.950	1419.38	-59.63	25.80	-60.93	0.00	
1524.00†	10.591	292.950	1517.68	-76.20	32.97	-77.85	0.00	
1624.00†	10.591	292.950	1615.97	-92.76	40.13	-94.77	0.00	
1724.00†	10.591	292.950	1714.27	-109.33	47.30	-111.70	0.00	
1824.00†	10.591	292.950	1812.57	-125.89	54.46	-128.62	0.00	
1924.00†	10.591	292.950	1910.86	-142.46	61.63	-145.55	0.00	
2024.00†	10.591	292.950	2009.16	-159.02	68.80	-162.47	0.00	
2124.00†	10.591	292.950	2107.46	-175.59	75.96	-179.39	0.00	
2224.00†	10.591	292.950	2205.75	-192.15	83.13	-196.32	0.00	
2324.00†	10.591	292.950	2304.05	-208.72	90.30	-213.24	0.00	
2424.00†	10.591	292.950	2402.35	-225.28	97.46	-230.17	0.00	
2524.00†	10.591	292.950	2500.64	-241.85	104.63	-247.09	0.00	
2624.00†	10.591	292.950	2598.94	-258.41	111.80	-264.01	0.00	



Planned Wellpath Report

VARRA #4 (REV-A.0) PWP

Page 3 of 8



REFERENCE WELLPATH IDENTIFICATION

Operator	EXTRACTION OIL & GAS	Slot	SLOT#04 VARRA #4(1667'FSL & 790'FWL,SEC.05)
Area	COLORADO	Well	VARRA #4
Field	WELD COUNTY (NAD83/TRUE NORTH)	Wellbore	VARRA #4 PWB
Facility	SEC.05-T06N-R67W		

WELLPATH DATA (181 stations) † = interpolated/extrapolated station

MD [ft]	Inclination [°]	Azimuth [°]	TVD [ft]	Vert Sect [ft]	North [ft]	East [ft]	DLS [°/100ft]	Comments
2724.00†	10.591	292.950	2697.24	-274.98	118.96	-280.94	0.00	
2824.00†	10.591	292.950	2795.53	-291.54	126.13	-297.86	0.00	
2924.00†	10.591	292.950	2893.83	-308.11	133.30	-314.79	0.00	
3024.00†	10.591	292.950	2992.13	-324.67	140.46	-331.71	0.00	
3124.00†	10.591	292.950	3090.42	-341.24	147.63	-348.63	0.00	
3224.00†	10.591	292.950	3188.72	-357.80	154.80	-365.56	0.00	
3324.00†	10.591	292.950	3287.02	-374.37	161.96	-382.48	0.00	
3424.00†	10.591	292.950	3385.31	-390.93	169.13	-399.41	0.00	
3524.00†	10.591	292.950	3483.61	-407.50	176.29	-416.33	0.00	
3624.00†	10.591	292.950	3581.91	-424.06	183.46	-433.25	0.00	
3724.00†	10.591	292.950	3680.20	-440.63	190.63	-450.18	0.00	
3824.00†	10.591	292.950	3778.50	-457.19	197.79	-467.10	0.00	
3924.00†	10.591	292.950	3876.80	-473.76	204.96	-484.03	0.00	
4024.00†	10.591	292.950	3975.09	-490.32	212.13	-500.95	0.00	
4124.00†	10.591	292.950	4073.39	-506.88	219.29	-517.88	0.00	
4224.00†	10.591	292.950	4171.68	-523.45	226.46	-534.80	0.00	
4324.00†	10.591	292.950	4269.98	-540.01	233.63	-551.72	0.00	
4424.00†	10.591	292.950	4368.28	-556.58	240.79	-568.65	0.00	
4524.00†	10.591	292.950	4466.57	-573.14	247.96	-585.57	0.00	
4624.00†	10.591	292.950	4564.87	-589.71	255.13	-602.50	0.00	
4724.00†	10.591	292.950	4663.17	-606.27	262.29	-619.42	0.00	
4824.00†	10.591	292.950	4761.46	-622.84	269.46	-636.34	0.00	
4924.00†	10.591	292.950	4859.76	-639.40	276.62	-653.27	0.00	
5024.00†	10.591	292.950	4958.06	-655.97	283.79	-670.19	0.00	
5124.00†	10.591	292.950	5056.35	-672.53	290.96	-687.12	0.00	
5224.00†	10.591	292.950	5154.65	-689.10	298.12	-704.04	0.00	
5324.00†	10.591	292.950	5252.95	-705.66	305.29	-720.96	0.00	
5424.00†	10.591	292.950	5351.24	-722.23	312.46	-737.89	0.00	
5524.00†	10.591	292.950	5449.54	-738.79	319.62	-754.81	0.00	
5624.00†	10.591	292.950	5547.84	-755.36	326.79	-771.74	0.00	



Planned Wellpath Report

VARRA #4 (REV-A.0) PWP

Page 4 of 8



REFERENCE WELLPATH IDENTIFICATION

Operator	EXTRACTION OIL & GAS	Slot	SLOT#04 VARRA #4(1667'FSL & 790'FWL,SEC.05)
Area	COLORADO	Well	VARRA #4
Field	WELD COUNTY (NAD83/TRUE NORTH)	Wellbore	VARRA #4 PWB
Facility	SEC.05-T06N-R67W		

WELLPATH DATA (181 stations) † = interpolated/extrapolated station

MD [ft]	Inclination [°]	Azimuth [°]	TVD [ft]	Vert Sect [ft]	North [ft]	East [ft]	DLS [°/100ft]	Comments
5724.00†	10.591	292.950	5646.13	-771.92	333.96	-788.66	0.00	
5824.00†	10.591	292.950	5744.43	-788.49	341.12	-805.58	0.00	
5924.00†	10.591	292.950	5842.73	-805.05	348.29	-822.51	0.00	
6024.00†	10.591	292.950	5941.02	-821.62	355.46	-839.43	0.00	
6124.00†	10.591	292.950	6039.32	-838.18	362.62	-856.36	0.00	
6224.00†	10.591	292.950	6137.62	-854.75	369.79	-873.28	0.00	
6324.00†	10.591	292.950	6235.91	-871.31	376.96	-890.20	0.00	
6424.00†	10.591	292.950	6334.21	-887.88	384.12	-907.13	0.00	
6524.00†	10.591	292.950	6432.51	-904.44	391.29	-924.05	0.00	
6624.00†	10.591	292.950	6530.80	-921.01	398.45	-940.98	0.00	
6724.00†	10.591	292.950	6629.10	-937.57	405.62	-957.90	0.00	
6773.23	10.591	292.950	6677.49	-945.73	409.15	-966.23	0.00	End of Tangent
6824.00†	6.635	308.696	6727.69	-952.14	412.80	-972.82	9.00	
6924.00†	5.635	42.811	6827.31	-952.97	420.03	-974.00	9.00	
7024.00†	13.461	72.488	6925.90	-938.18	427.15	-959.53	9.00	
7124.00†	22.189	79.884	7021.02	-908.14	433.98	-929.78	9.00	
7224.00†	31.067	83.212	7110.33	-863.58	440.36	-885.48	9.00	
7324.00†	39.996	85.167	7191.63	-805.61	446.13	-827.72	9.00	
7424.00†	48.948	86.505	7262.92	-735.65	451.15	-757.91	9.00	
7524.00†	57.911	87.520	7322.44	-655.42	455.29	-677.79	9.00	
7624.00†	66.881	88.352	7368.73	-566.90	458.45	-589.32	9.00	
7724.00†	75.855	89.079	7400.64	-472.27	460.56	-494.69	9.00	
7824.00†	84.830	89.751	7417.40	-373.86	461.55	-396.21	9.00	
7881.59	90.000	90.126	7420.00 ¹	-316.41	461.62	-338.70	9.00	End of 3D Arc
7924.00†	90.000	90.126	7420.00	-274.05	461.52	-296.29	0.00	
8024.00†	90.000	90.126	7420.00	-174.18	461.30	-196.29	0.00	
8124.00†	90.000	90.126	7420.00	-74.30	461.08	-96.29	0.00	
8224.00†	90.000	90.126	7420.00	25.58	460.86	3.71	0.00	
8324.00†	90.000	90.126	7420.00	125.45	460.64	103.71	0.00	
8424.00†	90.000	90.126	7420.00	225.33	460.42	203.71	0.00	



Planned Wellpath Report

VARRA #4 (REV-A.0) PWP

Page 5 of 8



REFERENCE WELLPATH IDENTIFICATION

Operator	EXTRACTION OIL & GAS	Slot	SLOT#04 VARRA #4(1667'FSL & 790'FWL,SEC.05)
Area	COLORADO	Well	VARRA #4
Field	WELD COUNTY (NAD83/TRUE NORTH)	Wellbore	VARRA #4 PWB
Facility	SEC.05-T06N-R67W		

WELLPATH DATA (181 stations) † = interpolated/extrapolated station

MD [ft]	Inclination [°]	Azimuth [°]	TVD [ft]	Vert Sect [ft]	North [ft]	East [ft]	DLS [°/100ft]	Comments
8524.00†	90.000	90.126	7420.00	325.21	460.20	303.71	0.00	
8624.00†	90.000	90.126	7420.00	425.08	459.98	403.71	0.00	
8724.00†	90.000	90.126	7420.00	524.96	459.76	503.71	0.00	
8824.00†	90.000	90.126	7420.00	624.84	459.53	603.71	0.00	
8924.00†	90.000	90.126	7420.00	724.71	459.31	703.71	0.00	
9024.00†	90.000	90.126	7420.00	824.59	459.09	803.71	0.00	
9124.00†	90.000	90.126	7420.00	924.47	458.87	903.71	0.00	
9224.00†	90.000	90.126	7420.00	1024.34	458.65	1003.71	0.00	
9324.00†	90.000	90.126	7420.00	1124.22	458.43	1103.71	0.00	
9424.00†	90.000	90.126	7420.00	1224.10	458.21	1203.71	0.00	
9524.00†	90.000	90.126	7420.00	1323.97	457.99	1303.71	0.00	
9624.00†	90.000	90.126	7420.00	1423.85	457.77	1403.71	0.00	
9724.00†	90.000	90.126	7420.00	1523.73	457.55	1503.71	0.00	
9824.00†	90.000	90.126	7420.00	1623.60	457.33	1603.71	0.00	
9924.00†	90.000	90.126	7420.00	1723.48	457.11	1703.71	0.00	
10024.00†	90.000	90.126	7420.00	1823.36	456.89	1803.71	0.00	
10124.00†	90.000	90.126	7420.00	1923.23	456.66	1903.71	0.00	
10224.00†	90.000	90.126	7420.00	2023.11	456.44	2003.71	0.00	
10324.00†	90.000	90.126	7420.00	2122.99	456.22	2103.71	0.00	
10424.00†	90.000	90.126	7420.00	2222.86	456.00	2203.71	0.00	
10524.00†	90.000	90.126	7420.00	2322.74	455.78	2303.71	0.00	
10624.00†	90.000	90.126	7420.00	2422.62	455.56	2403.71	0.00	
10724.00†	90.000	90.126	7420.00	2522.49	455.34	2503.71	0.00	
10824.00†	90.000	90.126	7420.00	2622.37	455.12	2603.70	0.00	
10924.00†	90.000	90.126	7420.00	2722.25	454.90	2703.70	0.00	
11024.00†	90.000	90.126	7420.00	2822.12	454.68	2803.70	0.00	
11124.00†	90.000	90.126	7420.00	2922.00	454.46	2903.70	0.00	
11224.00†	90.000	90.126	7420.00	3021.88	454.24	3003.70	0.00	
11324.00†	90.000	90.126	7420.00	3121.75	454.02	3103.70	0.00	
11424.00†	90.000	90.126	7420.00	3221.63	453.79	3203.70	0.00	



Planned Wellpath Report

VARRA #4 (REV-A.0) PWP

Page 6 of 8



REFERENCE WELLPATH IDENTIFICATION

Operator	EXTRACTION OIL & GAS	Slot	SLOT#04 VARRA #4(1667'FSL & 790'FWL,SEC.05)
Area	COLORADO	Well	VARRA #4
Field	WELD COUNTY (NAD83/TRUE NORTH)	Wellbore	VARRA #4 PWB
Facility	SEC.05-T06N-R67W		

WELLPATH DATA (181 stations) † = interpolated/extrapolated station

MD [ft]	Inclination [°]	Azimuth [°]	TVD [ft]	Vert Sect [ft]	North [ft]	East [ft]	DLS [°/100ft]	Comments
11524.00†	90.000	90.126	7420.00	3321.51	453.57	3303.70	0.00	
11624.00†	90.000	90.126	7420.00	3421.38	453.35	3403.70	0.00	
11724.00†	90.000	90.126	7420.00	3521.26	453.13	3503.70	0.00	
11824.00†	90.000	90.126	7420.00	3621.14	452.91	3603.70	0.00	
11924.00†	90.000	90.126	7420.00	3721.01	452.69	3703.70	0.00	
12024.00†	90.000	90.126	7420.00	3820.89	452.47	3803.70	0.00	
12124.00†	90.000	90.126	7420.00	3920.77	452.25	3903.70	0.00	
12224.00†	90.000	90.126	7420.00	4020.64	452.03	4003.70	0.00	
12324.00†	90.000	90.126	7420.00	4120.52	451.81	4103.70	0.00	
12424.00†	90.000	90.126	7420.00	4220.40	451.59	4203.70	0.00	
12524.00†	90.000	90.126	7420.00	4320.27	451.37	4303.70	0.00	
12624.00†	90.000	90.126	7420.00	4420.15	451.15	4403.70	0.00	
12724.00†	90.000	90.126	7420.00	4520.03	450.92	4503.70	0.00	
12824.00†	90.000	90.126	7420.00	4619.90	450.70	4603.70	0.00	
12924.00†	90.000	90.126	7420.00	4719.78	450.48	4703.70	0.00	
13024.00†	90.000	90.126	7420.00	4819.66	450.26	4803.70	0.00	
13124.00†	90.000	90.126	7420.00	4919.53	450.04	4903.70	0.00	
13224.00†	90.000	90.126	7420.00	5019.41	449.82	5003.70	0.00	
13324.00†	90.000	90.126	7420.00	5119.29	449.60	5103.70	0.00	
13424.00†	90.000	90.126	7420.00	5219.16	449.38	5203.70	0.00	
13524.00†	90.000	90.126	7420.00	5319.04	449.16	5303.70	0.00	
13624.00†	90.000	90.126	7420.00	5418.91	448.94	5403.70	0.00	
13724.00†	90.000	90.126	7420.00	5518.79	448.72	5503.70	0.00	
13824.00†	90.000	90.126	7420.00	5618.67	448.50	5603.70	0.00	
13924.00†	90.000	90.126	7420.00	5718.54	448.28	5703.70	0.00	
14024.00†	90.000	90.126	7420.00	5818.42	448.05	5803.70	0.00	
14124.00†	90.000	90.126	7420.00	5918.30	447.83	5903.70	0.00	
14224.00†	90.000	90.126	7420.00	6018.17	447.61	6003.70	0.00	
14324.00†	90.000	90.126	7420.00	6118.05	447.39	6103.70	0.00	
14424.00†	90.000	90.126	7420.00	6217.93	447.17	6203.70	0.00	



Planned Wellpath Report

VARRA #4 (REV-A.0) PWP

Page 7 of 8



REFERENCE WELLPATH IDENTIFICATION

Operator	EXTRACTION OIL & GAS	Slot	SLOT#04 VARRA #4(1667'FSL & 790'FWL,SEC.05)
Area	COLORADO	Well	VARRA #4
Field	WELD COUNTY (NAD83/TRUE NORTH)	Wellbore	VARRA #4 PWB
Facility	SEC.05-T06N-R67W		

WELLPATH DATA (181 stations) † = interpolated/extrapolated station

MD [ft]	Inclination [°]	Azimuth [°]	TVD [ft]	Vert Sect [ft]	North [ft]	East [ft]	DLS [°/100ft]	Comments
14524.00†	90.000	90.126	7420.00	6317.80	446.95	6303.70	0.00	
14624.00†	90.000	90.126	7420.00	6417.68	446.73	6403.70	0.00	
14724.00†	90.000	90.126	7420.00	6517.56	446.51	6503.70	0.00	
14824.00†	90.000	90.126	7420.00	6617.43	446.29	6603.70	0.00	
14924.00†	90.000	90.126	7420.00	6717.31	446.07	6703.69	0.00	
15024.00†	90.000	90.126	7420.00	6817.19	445.85	6803.69	0.00	
15124.00†	90.000	90.126	7420.00	6917.06	445.63	6903.69	0.00	
15224.00†	90.000	90.126	7420.00	7016.94	445.41	7003.69	0.00	
15324.00†	90.000	90.126	7420.00	7116.82	445.18	7103.69	0.00	
15424.00†	90.000	90.126	7420.00	7216.69	444.96	7203.69	0.00	
15524.00†	90.000	90.126	7420.00	7316.57	444.74	7303.69	0.00	
15624.00†	90.000	90.126	7420.00	7416.45	444.52	7403.69	0.00	
15724.00†	90.000	90.126	7420.00	7516.32	444.30	7503.69	0.00	
15824.00†	90.000	90.126	7420.00	7616.20	444.08	7603.69	0.00	
15924.00†	90.000	90.126	7420.00	7716.08	443.86	7703.69	0.00	
16024.00†	90.000	90.126	7420.00	7815.95	443.64	7803.69	0.00	
16124.00†	90.000	90.126	7420.00	7915.83	443.42	7903.69	0.00	
16224.00†	90.000	90.126	7420.00	8015.71	443.20	8003.69	0.00	
16324.00†	90.000	90.126	7420.00	8115.58	442.98	8103.69	0.00	
16424.00†	90.000	90.126	7420.00	8215.46	442.76	8203.69	0.00	
16524.00†	90.000	90.126	7420.00	8315.34	442.54	8303.69	0.00	
16624.00†	90.000	90.126	7420.00	8415.21	442.31	8403.69	0.00	
16724.00†	90.000	90.126	7420.00	8515.09	442.09	8503.69	0.00	
16824.00†	90.000	90.126	7420.00	8614.97	441.87	8603.69	0.00	
16924.00†	90.000	90.126	7420.00	8714.84	441.65	8703.69	0.00	
17024.00†	90.000	90.126	7420.00	8814.72	441.43	8803.69	0.00	
17124.00†	90.000	90.126	7420.00	8914.60	441.21	8903.69	0.00	
17224.00†	90.000	90.126	7420.00	9014.47	440.99	9003.69	0.00	
17324.00†	90.000	90.126	7420.00	9114.35	440.77	9103.69	0.00	
17424.00†	90.000	90.126	7420.00	9214.23	440.55	9203.69	0.00	



Planned Wellpath Report

VARRA #4 (REV-A.0) PWP

Page 8 of 8



REFERENCE WELLPATH IDENTIFICATION

Operator	EXTRACTION OIL & GAS	Slot	SLOT#04 VARRA #4(1667'FSL & 790'FWL,SEC.05)
Area	COLORADO	Well	VARRA #4
Field	WELD COUNTY (NAD83/TRUE NORTH)	Wellbore	VARRA #4 PWB
Facility	SEC.05-T06N-R67W		

WELLPATH DATA (181 stations)

MD [ft]	Inclination [°]	Azimuth [°]	TVD [ft]	Vert Sect [ft]	North [ft]	East [ft]	DLS [°/100ft]	Comments
17489.92	90.000	90.126	7420.00 ²	9280.06	440.40	9269.61	0.00	End of Tangent

HOLE & CASING SECTIONS - Ref Wellbore: VARRA #4 PWB Ref Wellpath: VARRA #4 (REV-A.0) PWP

String/Diameter	Start MD [ft]	End MD [ft]	Interval [ft]	Start TVD [ft]	End TVD [ft]	Start N/S [ft]	Start E/W [ft]	End N/S [ft]	End E/W [ft]
7in Casing Intermediate	24.00	7881.59	7857.59	24.00	7420.00	0.00	0.00	461.62	-338.70

TARGETS

Name	MD [ft]	TVD [ft]	North [ft]	East [ft]	Grid East [US ft]	Grid North [US ft]	Latitude	Longitude	Shape
VARRA PAD SECTION 04		0.00	77.98	0.53	3160186.77	1430380.18	40°30'48.118"N	104°55'25.957"W	polygon
VARRA PAD SECTION 05		0.00	77.98	0.53	3160186.77	1430380.18	40°30'48.118"N	104°55'25.957"W	polygon
2) VARRA #4 BHL ON PLAT REV-1(1950'FSL & 460'FEL,SEC.04)	17489.92	7420.00	440.40	9269.61	3169452.98	1430802.80	40°30'51.682"N	104°53'25.948"W	point
1) VARRA #4 LANDING POINT	7881.59	7420.00	461.62	-338.70	3159845.08	1430761.59	40°30'51.908"N	104°55'30.349"W	point
VARRA PAD CENTER HARDLINES(460' SETBACKS)		7420.00	77.98	0.53	3160186.77	1430380.18	40°30'48.118"N	104°55'25.957"W	polygon

SURVEY PROGRAM - Ref Wellbore: VARRA #4 PWB Ref Wellpath: VARRA #4 (REV-A.0) PWP

Start MD [ft]	End MD [ft]	Positional Uncertainty Model	Log Name/Comment	Wellbore
24.00	18000.00	NaviTrak (Standard)		VARRA #4 PWB