

LEGEND:

PROPOSED LOCATION

GREAT WESTERN OIL & GAS COMPANY

De TIENNE FD 16-022HC, 16-059HN, 16-099HN, 16-102HC, 16-139HN, 16-182HN, A, 10-399HN, 10-362HN, 10-359HC, 10-322HN, 10-279HN, 10-242HC, 10-239HN & 10-202HN
 SECTION 10, T6N, R67W, 6th P.M.
 NW 1/4 SW 1/4

DRAWN BY: J.L.G.

DATE DRAWN: 05-29-14

SCALE: 1:100,000

REV: 00-00-00

ACCESS ROAD MAP

TOPO A



UELS, LLC
 Corporate Office * 85 South 200 East
 Vernal, UT 84078 * (435) 789-1017

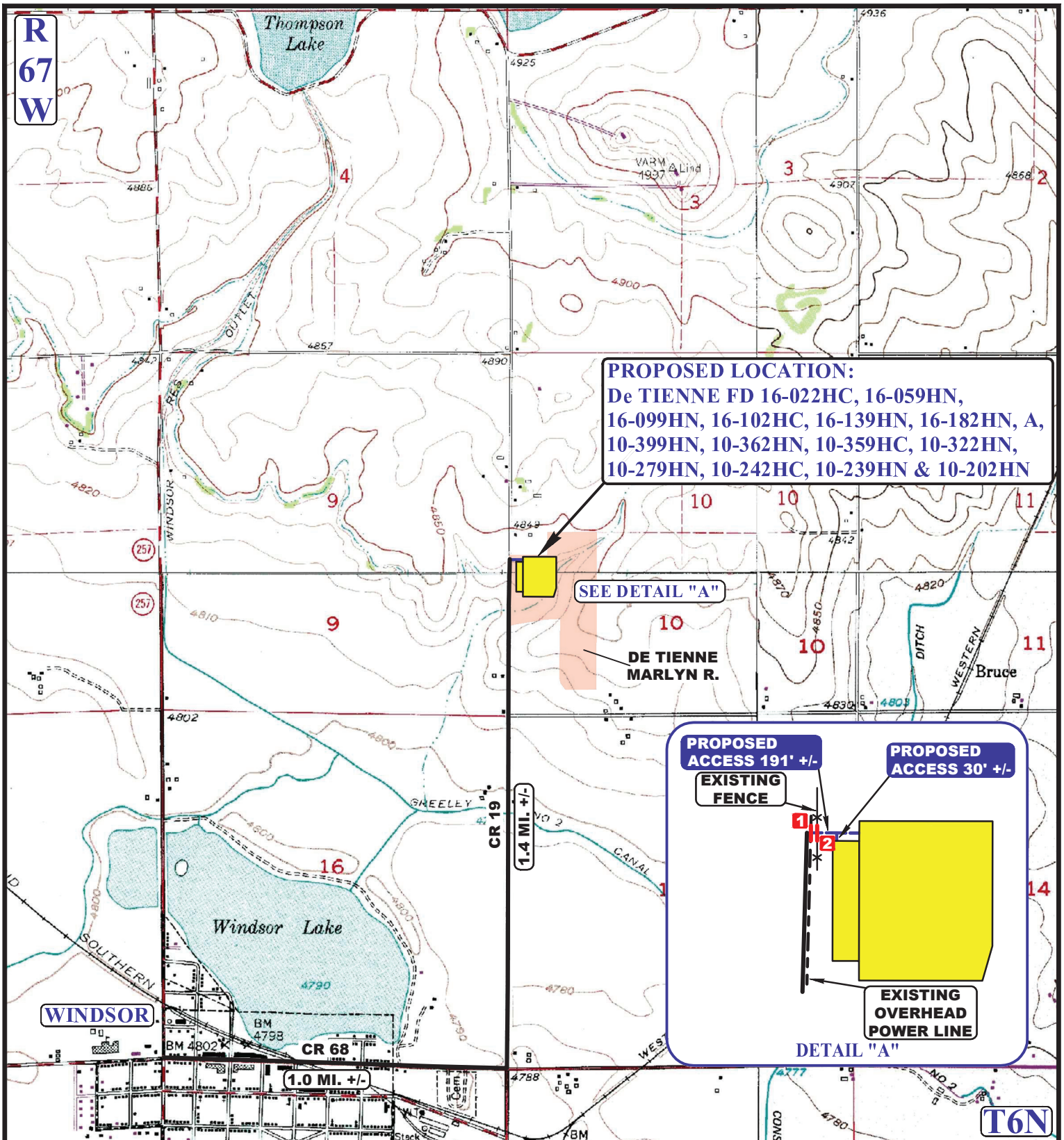

NOTE: PARCEL DATA SHOWN HAS BEEN OBTAINED FROM VARIOUS SOURCES AND SHOULD BE USED FOR MAPPING, GRAPHIC AND PLANNING PURPOSES ONLY. NO WARRANTY IS MADE BY UINTAH ENGINEERING AND LAND SURVEYING (UELS) FOR ACCURACY OF THE PARCEL DATA.

LEGEND:

- EXISTING ROAD
- PROPOSED ROAD
- - - EXISTING POWER LINE
- x x EXISTING FENCE
- 1 18" CULVERT REQUIRED
- 2 CATTLE GUARD REQUIRED



GREAT WESTERN OIL & GAS COMPANY

De TIENNE FD 16-022HC, 16-059HN, 16-099HN, 16-102HC, 16-139HN, 16-182HN, A, 10-399HN, 10-362HN, 10-359HC, 10-322HN, 10-279HN, 10-242HC, 10-239HN & 10-202HN
SECTION 10, T6N, R67W, 6th P.M.
NW 1/4 SW 1/4

DRAWN BY: J.L.G.	DATE DRAWN: 05-29-14
SCALE: 1" = 2000'	REV: 00-00-00
ACCESS ROAD MAP	TOPO B



UELS, LLC
Corporate Office * 85 South 200 East
Vernal, UT 84078 * (435) 789-1017