

# Location Drawing

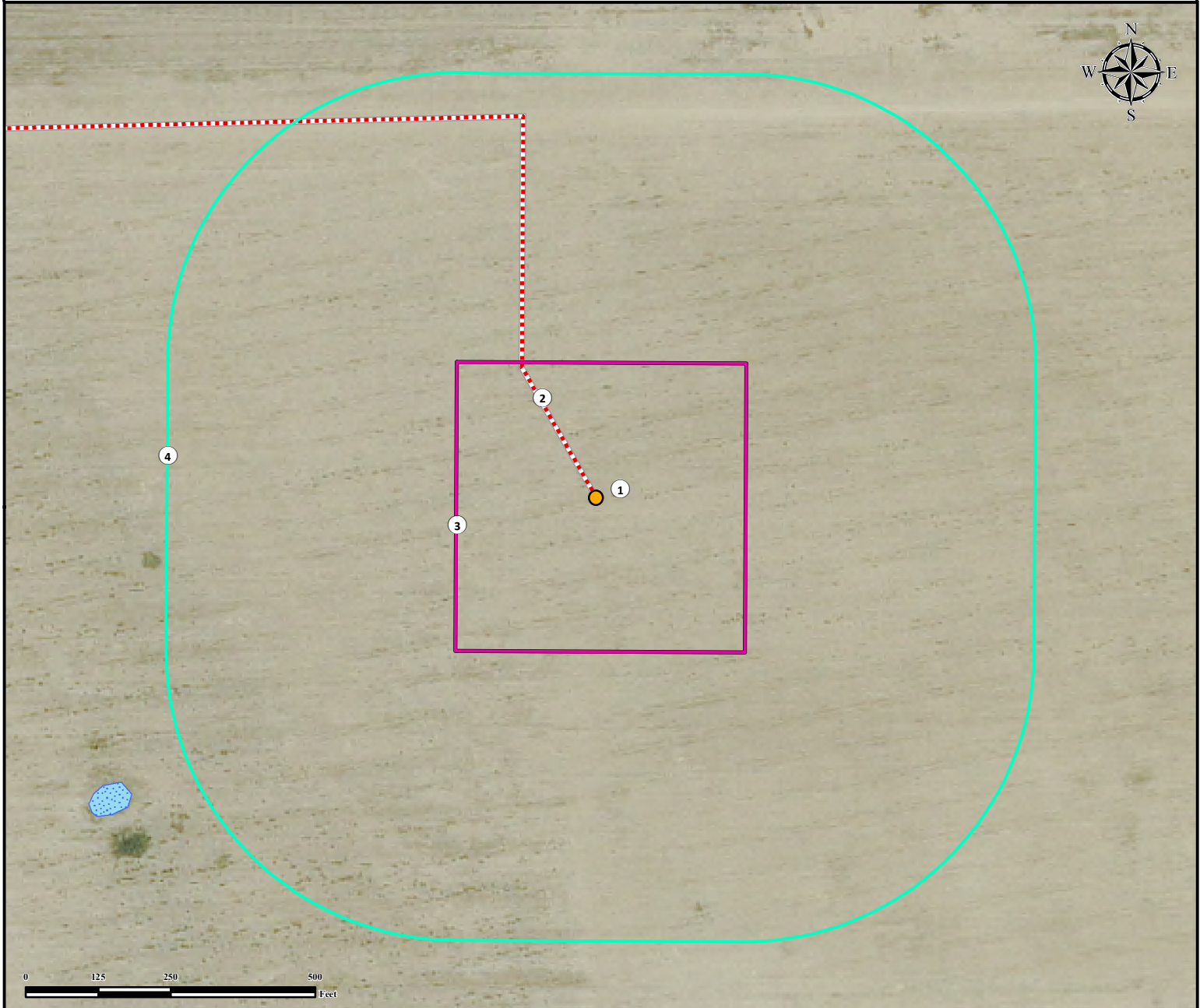



## BILLHEIMER 31-33-16-52H

NW¼ NE¼ SECTION 33, TOWNSHIP 16 SOUTH, RANGE 52 WEST OF THE 6TH PRINCIPAL MERIDIAN



1. Proposed Well BILLHEIMER 31-33-16-52H.
2. Proposed Access Road.
3. Operational Disturbance Area.
4. 500' Radius.

### Legend

- |   |  |
|---|--|
|  Proposed Well       |  Disturbance Area |
|  Proposed Access Road |  500' Radius      |
|   |  Pond             |

### Measured from Nearest Well or Facility Edge

Building -	>5280' N
Building Unit -	>5280' N

### Measured from Reference Location

Public Road - (CR J/63)	±5280' N
Prop. Line (Blakemore, Rodriguez Martha Jane)	±628' N
Utility (Power Line) -	>5280' N
Surface Water (Pond) -	±952' SW
Railroad -	>5280' SE
Water Well - ±2,363' NW	SWL = 77'
Permit: 25059,	Receipt: 0025059

### Reference Location

\*\* BILLHEIMER 31-33-16-52H \*\*  
 Lat: 38.624600° Long:-103.237661° (NAD83)  
 Elevation: 4742 Feet

### Disturbance Acreage:

5.74 Acres Drilling Operations  
 2.87 Acres Interim Reclaim

Current Surface Use: Dry Land Crop  
 Future Surface Use: Dry Land Crop



Use our resources to find yours!  
[www.petro-fs.com](http://www.petro-fs.com)  
 (303) 928-7128

Field Date: 05/01/2014  
 Drafting Date: 05/27/2014  
 Drafted by: DRF  
 Checked by: SMG  
 Revision:

Data Sources:  
 - Aerial courtesy of NAIP (2013)

Prepared for: **PIONEER NATURAL RESOURCES USA INC.**