

# GREAT WESTERN OIL & GAS COMPANY

## CONSTRUCTION LAYOUT FOR

WILLOW BEND LD 18-36HN-2, 18-23HC, 18-23HN,  
18-37HN, 18-22HC, 18-22HN, 18-37OHS & 18-361HN  
SECTION 18, T1S, R67W, 6th P.M.  
NE 1/4 NE 1/4

FIGURE #1

SCALE: 1" = 100'  
DATE: 11-25-13  
DRAWN BY: J.W.  
REVISED: 12-11-13  
REVISED: 05-14-14

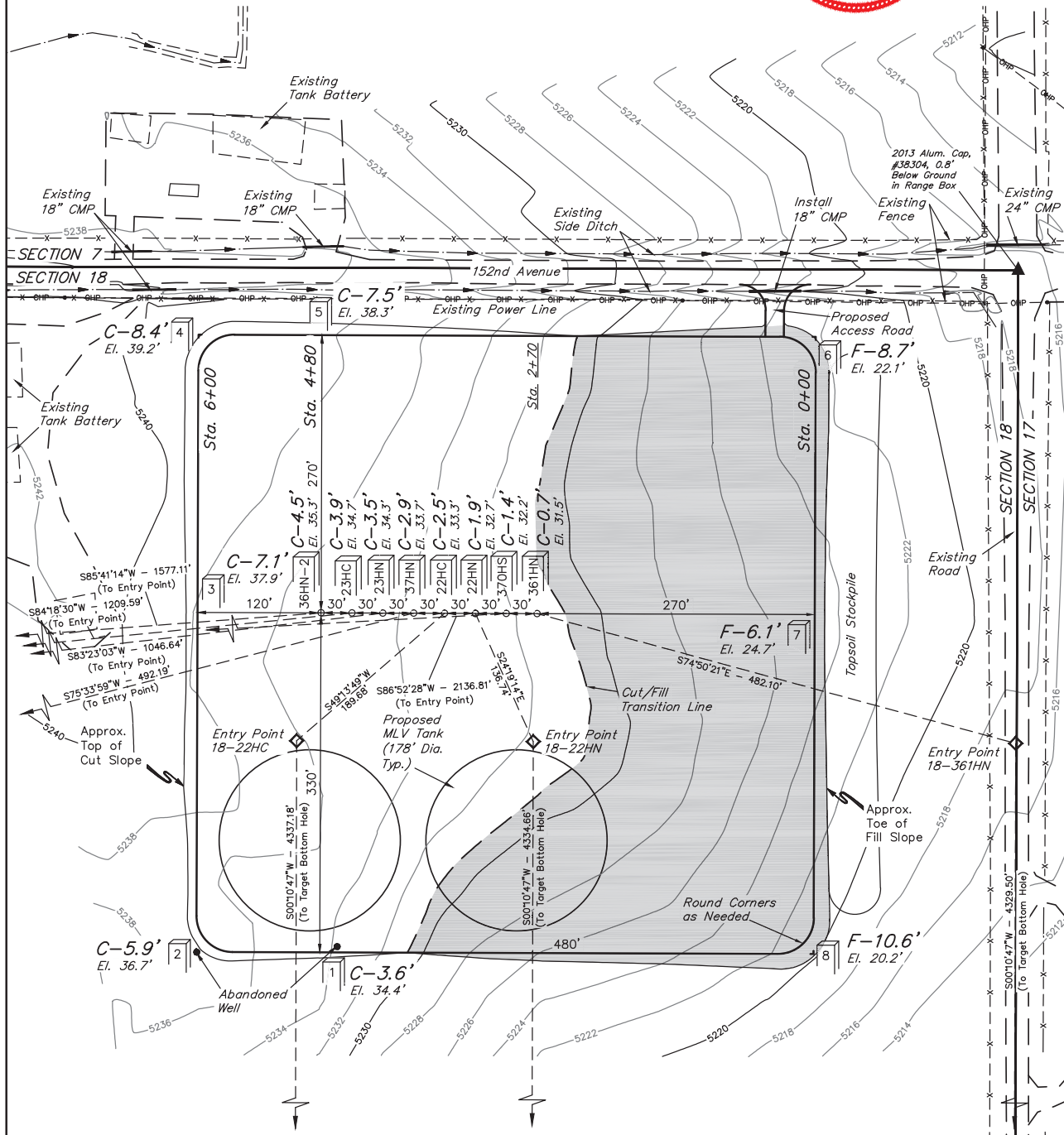

Elev. Ungraded Ground At 18-36HN-2 Loc. Stake = 5235.3'  
FINISHED GRADE ELEV. AT 18-36HN-2 LOC. STAKE = 5230.8'

UINTAH ENGINEERING & LAND SURVEYING  
85 So. 200 East • Vernal, Utah 84078 • (435) 789-1017