

# EXTRACTION OIL & GAS

Location: COLORADO Slot: SLOT#09 WINDER #9(884'FNL & 684'FEL,SEC.09)  
Field: WELD COUNTY (NAD83/TRUE NORTH) Well: WINDER #9  
Facility: SEC.09-T06N-R67W Wellbore: WINDER #9 PWB

Plot reference wellpath is WINDER #9 (REV-A.0) PWP

True vertical depths are referenced to RIG (RKB)	Grid System: NAD83 / Lambert Colorado SP, Northern Zone (501), US feet
Measured depths are referenced to RIG (RKB)	North Reference: True north
RIG (RKB) to Mean Sea Level: 4892 feet	Scale: True distance
Mean Sea Level to Mud line (At Slot: SLOT#09 WINDER #9(884'FNL & 684'FEL,SEC.09)): 0 feet	Depths are in feet
Coordinates are in feet referenced to Slot	Created by: painsett on 4/8/2014

## Location Information

Facility Name			Grid East (US ft)	Grid North (US ft)	Latitude	Longitude
SEC.09-T06N-R67W			3169265.228	1428175.850	40°30'25.736"N	104°53'28.612"W
Slot	Local N (ft)	Local E (ft)	Grid East (US ft)	Grid North (US ft)	Latitude	Longitude
SLOT#09 WINDER #9(884FNL & 684FEL,SEC.09)	-207.97	-1.62	3169265.034	1427967.886	40°30'23.681"N	104°53'28.633"W
RIG (RKB) to Mud line (At Slot: SLOT#09 WINDER #9(884FNL & 684FEL,SEC.09))					4892ft	
Mean Sea Level to Mud line (At Slot: SLOT#09 WINDER #9(884FNL & 684FEL,SEC.09))					0ft	
RIG (RKB) to Mean Sea Level					4892ft	

## Targets

Name	MD (ft)	TVD (ft)	Local N (ft)	Local E (ft)	Grid East (US ft)	Grid North (US ft)	Latitude	Longitude
TWELL/WINDER 1/2 SECTION 08		56.00	-3126.22	-9583.08	3159703.97	1424776.07	40°29'52.771"N	104°55'32.678"W
TWELL/WINDER 1/2 SECTION 09		56.00	-3126.22	-9583.08	3159703.97	1424776.07	40°29'52.771"N	104°55'32.678"W
TWELL/WINDER SECTION 08		56.00	-3126.22	-9583.08	3159703.97	1424776.07	40°29'52.771"N	104°55'32.678"W
TWELL/WINDER SECTION 09		56.00	-3126.22	-9583.08	3159703.97	1424776.07	40°29'52.771"N	104°55'32.678"W
WINDER #9 BHL ON PLAT REV-1(1624'FNL & 460'FWL,SEC.08)	17334.66	7270.00	-906.86	-9352.27	3159919.54	1426096.89	40°30'14.702"N	104°55'29.701"W
WINDER #9 LANDING POINT	7766.30	7270.00	-931.58	216.06	3169497.48	1427037.84	40°30'14.476"N	104°53'25.636"W
WINDER PAD NORTH 1/2 HARDLINES(460' SETBACKS)	7446.00	-3126.22	-9583.08	3159703.97	1424776.07	40°29'52.771"N	104°55'32.678"W	

## Survey Program

Start MD (ft)	End MD (ft)	Tool	Model	Log Name/Comment	Wellbore
24.00	19000.00	NaviTrak	NaviTrak (Standard)		WINDER #9 PWB

## Well Profile Data

Design Comment	MD (ft)	Inc (°)	Az (°)	TVD (ft)	Local N (ft)	Local E (ft)	DLS (°/100ft)	VS (ft)
Tie On	24.00	0.000	134.248	24.00	0.00	0.00	0.00	0.00
End of Tangent	800.00	0.000	134.248	800.00	0.00	0.00	0.00	0.00
End of Build	1412.41	12.248	134.248	1407.76	-45.50	46.71	2.00	-42.10
End of Tangent	6668.93	12.248	134.248	6544.62	-823.62	845.53	0.00	-762.09
End of 3D Arc	7766.30	90.000	270.148	7270.00	-931.58	216.06	9.00	-125.14
End of Tangent	17334.66	90.000	270.148	7270.00	-906.86	-9352.27	0.00	9396.13

## Wellpath Comments

MD (ft)	X (ft)	Y (ft)	TVD (ft)	Inclination (°)	Azimuth (°)	VS (ft)	Comment
7458.83	511.74	-921.47	7198.00	62.664	265.669	-420.42	NIO A
7664.69	317.24	-930.64	7262.00	80.959	268.771	-225.94	NIO B

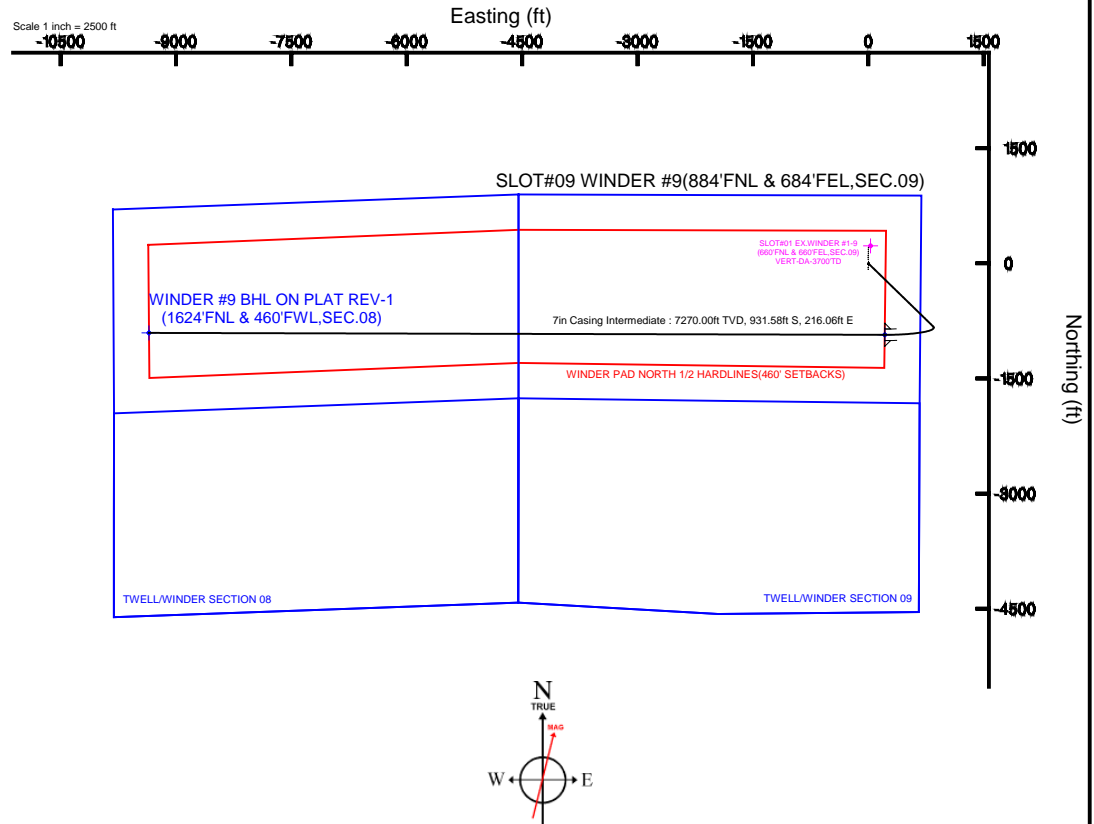

BGGM (1945.0 to 2015.0) Dip: 67.01° Field: 52838.7 nT  
Magnetic North is 8.61 degrees East of True North (at 4/7/2014)

To correct azimuth from Magnetic to True add 8.61 degrees

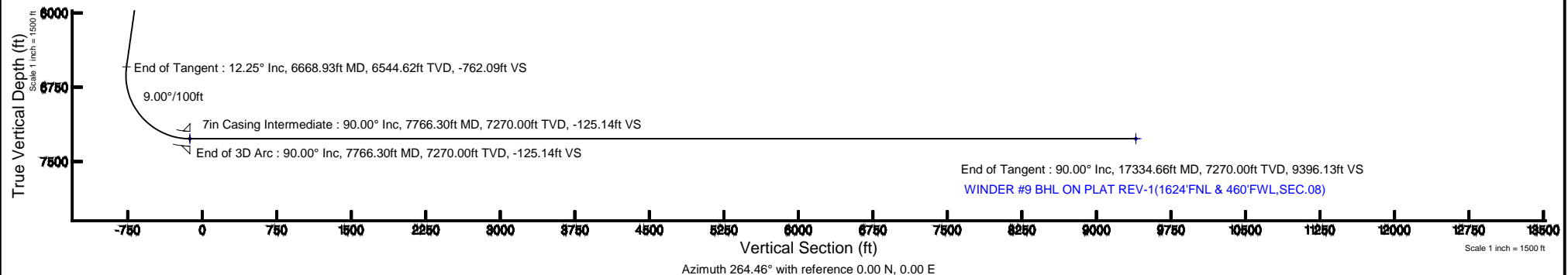



# Planned Wellpath Report

WINDER #9 (REV-A.0) PWP

Page 1 of 9



## REFERENCE WELLPATH IDENTIFICATION

Operator	EXTRACTION OIL & GAS	Slot	SLOT#09 WINDER #9(884'FNL & 684'FEL,SEC.09)
Area	COLORADO	Well	WINDER #9
Field	WELD COUNTY (NAD83/TRUE NORTH)	Wellbore	WINDER #9 PWB
Facility	SEC.09-T06N-R67W		

## REPORT SETUP INFORMATION

Projection System	NAD83 / Lambert Colorado SP, Northern Zone (501), US feet	Software System	WellArchitect® 4.0.0
North Reference	True	User	Painsetr
Scale	0.999967	Report Generated	4/8/2014 at 1:01:06 PM
Convergence at slot	n/a	Database/Source file	WA_Denver/WINDER_#9_PWB.xml

## WELLPATH LOCATION

	Local coordinates		Grid coordinates		Geographic coordinates	
	North[ft]	East[ft]	Easting[US ft]	Northing[US ft]	Latitude	Longitude
Slot Location	-207.97	-1.62	3169265.03	1427967.89	40°30'23.681"N	104°53'28.633"W
Facility Reference Pt			3169265.23	1428175.85	40°30'25.736"N	104°53'28.612"W
Field Reference Pt			3185481.27	1419166.81	40°28'55.560"N	104°49'59.556"W

## WELLPATH DATUM

Calculation method	Minimum curvature	RIG (RKB) to Facility Vertical Datum	4892.00ft
Horizontal Reference Pt	Slot	RIG (RKB) to Mean Sea Level	4892.00ft
Vertical Reference Pt	RIG (RKB)	RIG (RKB) to Mud Line at Slot (SLOT#09 WINDER #9(884'FNL & 684'FEL,SEC.09))	4892.00ft
MD Reference Pt	RIG (RKB)	Section Origin	N 0.00, E 0.00 ft
Field Vertical Reference	Mean Sea Level	Section Azimuth	264.46°



# Planned Wellpath Report

WINDER #9 (REV-A.0) PWP

Page 2 of 9



## REFERENCE WELLPATH IDENTIFICATION

Operator	EXTRACTION OIL & GAS	Slot	SLOT#09 WINDER #9(884'FNL & 684'FEL,SEC.09)
Area	COLORADO	Well	WINDER #9
Field	WELD COUNTY (NAD83/TRUE NORTH)	Wellbore	WINDER #9 PWB
Facility	SEC.09-T06N-R67W		

## WELLPATH DATA (180 stations) † = interpolated/extrapolated station

MD [ft]	Inclination [°]	Azimuth [°]	TVD [ft]	Vert Sect [ft]	North [ft]	East [ft]	DLS [°/100ft]	Comments
0.00†	0.000	134.248	0.00	0.00	0.00	0.00	0.00	
24.00	0.000	134.248	24.00	0.00	0.00	0.00	0.00	Tie On
124.00†	0.000	134.248	124.00	0.00	0.00	0.00	0.00	
224.00†	0.000	134.248	224.00	0.00	0.00	0.00	0.00	
324.00†	0.000	134.248	324.00	0.00	0.00	0.00	0.00	
424.00†	0.000	134.248	424.00	0.00	0.00	0.00	0.00	
524.00†	0.000	134.248	524.00	0.00	0.00	0.00	0.00	
624.00†	0.000	134.248	624.00	0.00	0.00	0.00	0.00	
724.00†	0.000	134.248	724.00	0.00	0.00	0.00	0.00	
800.00	0.000	134.248	800.00	0.00	0.00	0.00	0.00	End of Tangent
824.00†	0.480	134.248	824.00	-0.06	-0.07	0.07	2.00	
924.00†	2.480	134.248	923.96	-1.73	-1.87	1.92	2.00	
1024.00†	4.480	134.248	1023.77	-5.65	-6.11	6.27	2.00	
1124.00†	6.480	134.248	1123.31	-11.82	-12.77	13.11	2.00	
1224.00†	8.480	134.248	1222.45	-20.22	-21.85	22.44	2.00	
1324.00†	10.480	134.248	1321.08	-30.85	-33.35	34.23	2.00	
1412.41	12.248	134.248	1407.76	-42.10	-45.50	46.71	2.00	End of Build
1424.00†	12.248	134.248	1419.08	-43.69	-47.22	48.47	0.00	
1524.00†	12.248	134.248	1516.81	-57.39	-62.02	63.67	0.00	
1624.00†	12.248	134.248	1614.53	-71.08	-76.82	78.87	0.00	
1724.00†	12.248	134.248	1712.25	-84.78	-91.63	94.06	0.00	
1824.00†	12.248	134.248	1809.98	-98.48	-106.43	109.26	0.00	
1924.00†	12.248	134.248	1907.70	-112.17	-121.23	124.46	0.00	
2024.00†	12.248	134.248	2005.42	-125.87	-136.03	139.65	0.00	
2124.00†	12.248	134.248	2103.15	-139.57	-150.84	154.85	0.00	
2224.00†	12.248	134.248	2200.87	-153.27	-165.64	170.05	0.00	
2324.00†	12.248	134.248	2298.60	-166.96	-180.44	185.24	0.00	
2424.00†	12.248	134.248	2396.32	-180.66	-195.25	200.44	0.00	
2524.00†	12.248	134.248	2494.04	-194.36	-210.05	215.64	0.00	
2624.00†	12.248	134.248	2591.77	-208.05	-224.85	230.83	0.00	



# Planned Wellpath Report

WINDER #9 (REV-A.0) PWP

Page 3 of 9



## REFERENCE WELLPATH IDENTIFICATION

Operator	EXTRACTION OIL & GAS	Slot	SLOT#09 WINDER #9(884'FNL & 684'FEL,SEC.09)
Area	COLORADO	Well	WINDER #9
Field	WELD COUNTY (NAD83/TRUE NORTH)	Wellbore	WINDER #9 PWB
Facility	SEC.09-T06N-R67W		

## WELLPATH DATA (180 stations) † = interpolated/extrapolated station

MD [ft]	Inclination [°]	Azimuth [°]	TVD [ft]	Vert Sect [ft]	North [ft]	East [ft]	DLS [°/100ft]	Comments
2724.00†	12.248	134.248	2689.49	-221.75	-239.65	246.03	0.00	
2824.00†	12.248	134.248	2787.21	-235.45	-254.46	261.23	0.00	
2924.00†	12.248	134.248	2884.94	-249.15	-269.26	276.42	0.00	
3024.00†	12.248	134.248	2982.66	-262.84	-284.06	291.62	0.00	
3124.00†	12.248	134.248	3080.39	-276.54	-298.87	306.82	0.00	
3224.00†	12.248	134.248	3178.11	-290.24	-313.67	322.01	0.00	
3324.00†	12.248	134.248	3275.83	-303.93	-328.47	337.21	0.00	
3424.00†	12.248	134.248	3373.56	-317.63	-343.28	352.41	0.00	
3524.00†	12.248	134.248	3471.28	-331.33	-358.08	367.60	0.00	
3624.00†	12.248	134.248	3569.00	-345.03	-372.88	382.80	0.00	
3724.00†	12.248	134.248	3666.73	-358.72	-387.68	398.00	0.00	
3824.00†	12.248	134.248	3764.45	-372.42	-402.49	413.19	0.00	
3924.00†	12.248	134.248	3862.18	-386.12	-417.29	428.39	0.00	
4024.00†	12.248	134.248	3959.90	-399.81	-432.09	443.59	0.00	
4124.00†	12.248	134.248	4057.62	-413.51	-446.90	458.79	0.00	
4224.00†	12.248	134.248	4155.35	-427.21	-461.70	473.98	0.00	
4324.00†	12.248	134.248	4253.07	-440.91	-476.50	489.18	0.00	
4424.00†	12.248	134.248	4350.79	-454.60	-491.31	504.38	0.00	
4524.00†	12.248	134.248	4448.52	-468.30	-506.11	519.57	0.00	
4624.00†	12.248	134.248	4546.24	-482.00	-520.91	534.77	0.00	
4724.00†	12.248	134.248	4643.97	-495.69	-535.71	549.97	0.00	
4824.00†	12.248	134.248	4741.69	-509.39	-550.52	565.16	0.00	
4924.00†	12.248	134.248	4839.41	-523.09	-565.32	580.36	0.00	
5024.00†	12.248	134.248	4937.14	-536.79	-580.12	595.56	0.00	
5124.00†	12.248	134.248	5034.86	-550.48	-594.93	610.75	0.00	
5224.00†	12.248	134.248	5132.58	-564.18	-609.73	625.95	0.00	
5324.00†	12.248	134.248	5230.31	-577.88	-624.53	641.15	0.00	
5424.00†	12.248	134.248	5328.03	-591.57	-639.34	656.34	0.00	
5524.00†	12.248	134.248	5425.76	-605.27	-654.14	671.54	0.00	
5624.00†	12.248	134.248	5523.48	-618.97	-668.94	686.74	0.00	



# Planned Wellpath Report

WINDER #9 (REV-A.0) PWP

Page 4 of 9



## REFERENCE WELLPATH IDENTIFICATION

Operator	EXTRACTION OIL & GAS	Slot	SLOT#09 WINDER #9(884'FNL & 684'FEL,SEC.09)
Area	COLORADO	Well	WINDER #9
Field	WELD COUNTY (NAD83/TRUE NORTH)	Wellbore	WINDER #9 PWB
Facility	SEC.09-T06N-R67W		

## WELLPATH DATA (180 stations) † = interpolated/extrapolated station

MD [ft]	Inclination [°]	Azimuth [°]	TVD [ft]	Vert Sect [ft]	North [ft]	East [ft]	DLS [°/100ft]	Comments
5724.00†	12.248	134.248	5621.20	-632.67	-683.74	701.93	0.00	
5824.00†	12.248	134.248	5718.93	-646.36	-698.55	717.13	0.00	
5924.00†	12.248	134.248	5816.65	-660.06	-713.35	732.33	0.00	
6024.00†	12.248	134.248	5914.37	-673.76	-728.15	747.52	0.00	
6124.00†	12.248	134.248	6012.10	-687.45	-742.96	762.72	0.00	
6224.00†	12.248	134.248	6109.82	-701.15	-757.76	777.92	0.00	
6324.00†	12.248	134.248	6207.55	-714.85	-772.56	793.11	0.00	
6424.00†	12.248	134.248	6305.27	-728.55	-787.37	808.31	0.00	
6524.00†	12.248	134.248	6402.99	-742.24	-802.17	823.51	0.00	
6624.00†	12.248	134.248	6500.72	-755.94	-816.97	838.70	0.00	
6668.93	12.248	134.248	6544.62	-762.09	-823.62	845.53	0.00	End of Tangent
6724.00†	9.391	156.139	6598.73	-767.28	-831.81	851.54	9.00	
6824.00†	10.029	211.466	6697.50	-764.60	-846.73	850.29	9.00	
6924.00†	16.545	239.581	6794.87	-746.40	-861.40	833.43	9.00	
7024.00†	24.651	250.927	6888.43	-713.14	-875.45	801.38	9.00	
7124.00†	33.200	256.800	6975.89	-665.64	-888.54	754.92	9.00	
7224.00†	41.923	260.462	7055.10	-605.05	-900.35	695.20	9.00	
7324.00†	50.727	263.052	7124.09	-532.89	-910.59	623.68	9.00	
7424.00†	59.576	265.058	7181.18	-450.91	-919.01	542.14	9.00	
7524.00†	68.450	266.728	7224.96	-361.14	-925.39	452.57	9.00	
7624.00†	77.339	268.203	7254.34	-265.80	-929.58	357.18	9.00	
7724.00†	86.236	269.579	7268.61	-167.22	-931.48	258.33	9.00	
7766.30	90.000	270.148	7270.00 <sup>1</sup>	-125.14	-931.58	216.06	9.00	End of 3D Arc
7824.00†	90.000	270.148	7270.00	-67.72	-931.43	158.36	0.00	
7924.00†	90.000	270.148	7270.00	31.78	-931.17	58.36	0.00	
8024.00†	90.000	270.148	7270.00	131.29	-930.92	-41.64	0.00	
8124.00†	90.000	270.148	7270.00	230.80	-930.66	-141.64	0.00	
8224.00†	90.000	270.148	7270.00	330.31	-930.40	-241.64	0.00	
8324.00†	90.000	270.148	7270.00	429.82	-930.14	-341.64	0.00	
8424.00†	90.000	270.148	7270.00	529.32	-929.88	-441.64	0.00	



# Planned Wellpath Report

WINDER #9 (REV-A.0) PWP

Page 5 of 9



REFERENCE WELLPATH IDENTIFICATION			
Operator	EXTRACTION OIL & GAS	Slot	SLOT#09 WINDER #9(884'FNL & 684'FEL,SEC.09)
Area	COLORADO	Well	WINDER #9
Field	WELD COUNTY (NAD83/TRUE NORTH)	Wellbore	WINDER #9 PWB
Facility	SEC.09-T06N-R67W		

WELLPATH DATA (180 stations) † = interpolated/extrapolated station								
MD [ft]	Inclination [°]	Azimuth [°]	TVD [ft]	Vert Sect [ft]	North [ft]	East [ft]	DLS [°/100ft]	Comments
8524.00†	90.000	270.148	7270.00	628.83	-929.62	-541.64	0.00	
8624.00†	90.000	270.148	7270.00	728.34	-929.37	-641.64	0.00	
8724.00†	90.000	270.148	7270.00	827.85	-929.11	-741.64	0.00	
8824.00†	90.000	270.148	7270.00	927.36	-928.85	-841.64	0.00	
8924.00†	90.000	270.148	7270.00	1026.86	-928.59	-941.64	0.00	
9024.00†	90.000	270.148	7270.00	1126.37	-928.33	-1041.64	0.00	
9124.00†	90.000	270.148	7270.00	1225.88	-928.07	-1141.64	0.00	
9224.00†	90.000	270.148	7270.00	1325.39	-927.82	-1241.64	0.00	
9324.00†	90.000	270.148	7270.00	1424.89	-927.56	-1341.64	0.00	
9424.00†	90.000	270.148	7270.00	1524.40	-927.30	-1441.64	0.00	
9524.00†	90.000	270.148	7270.00	1623.91	-927.04	-1541.64	0.00	
9624.00†	90.000	270.148	7270.00	1723.42	-926.78	-1641.63	0.00	
9724.00†	90.000	270.148	7270.00	1822.93	-926.52	-1741.63	0.00	
9824.00†	90.000	270.148	7270.00	1922.43	-926.27	-1841.63	0.00	
9924.00†	90.000	270.148	7270.00	2021.94	-926.01	-1941.63	0.00	
10024.00†	90.000	270.148	7270.00	2121.45	-925.75	-2041.63	0.00	
10124.00†	90.000	270.148	7270.00	2220.96	-925.49	-2141.63	0.00	
10224.00†	90.000	270.148	7270.00	2320.47	-925.23	-2241.63	0.00	
10324.00†	90.000	270.148	7270.00	2419.97	-924.97	-2341.63	0.00	
10424.00†	90.000	270.148	7270.00	2519.48	-924.71	-2441.63	0.00	
10524.00†	90.000	270.148	7270.00	2618.99	-924.46	-2541.63	0.00	
10624.00†	90.000	270.148	7270.00	2718.50	-924.20	-2641.63	0.00	
10724.00†	90.000	270.148	7270.00	2818.01	-923.94	-2741.63	0.00	
10824.00†	90.000	270.148	7270.00	2917.51	-923.68	-2841.63	0.00	
10924.00†	90.000	270.148	7270.00	3017.02	-923.42	-2941.63	0.00	
11024.00†	90.000	270.148	7270.00	3116.53	-923.16	-3041.63	0.00	
11124.00†	90.000	270.148	7270.00	3216.04	-922.91	-3141.63	0.00	
11224.00†	90.000	270.148	7270.00	3315.54	-922.65	-3241.63	0.00	
11324.00†	90.000	270.148	7270.00	3415.05	-922.39	-3341.63	0.00	
11424.00†	90.000	270.148	7270.00	3514.56	-922.13	-3441.63	0.00	



# Planned Wellpath Report

WINDER #9 (REV-A.0) PWP

Page 6 of 9



REFERENCE WELLPATH IDENTIFICATION			
Operator	EXTRACTION OIL & GAS	Slot	SLOT#09 WINDER #9(884'FNL & 684'FEL,SEC.09)
Area	COLORADO	Well	WINDER #9
Field	WELD COUNTY (NAD83/TRUE NORTH)	Wellbore	WINDER #9 PWB
Facility	SEC.09-T06N-R67W		

WELLPATH DATA (180 stations) † = interpolated/extrapolated station								
MD [ft]	Inclination [°]	Azimuth [°]	TVD [ft]	Vert Sect [ft]	North [ft]	East [ft]	DLS [°/100ft]	Comments
11524.00†	90.000	270.148	7270.00	3614.07	-921.87	-3541.63	0.00	
11624.00†	90.000	270.148	7270.00	3713.58	-921.61	-3641.63	0.00	
11724.00†	90.000	270.148	7270.00	3813.08	-921.36	-3741.63	0.00	
11824.00†	90.000	270.148	7270.00	3912.59	-921.10	-3841.63	0.00	
11924.00†	90.000	270.148	7270.00	4012.10	-920.84	-3941.63	0.00	
12024.00†	90.000	270.148	7270.00	4111.61	-920.58	-4041.63	0.00	
12124.00†	90.000	270.148	7270.00	4211.12	-920.32	-4141.63	0.00	
12224.00†	90.000	270.148	7270.00	4310.62	-920.06	-4241.63	0.00	
12324.00†	90.000	270.148	7270.00	4410.13	-919.81	-4341.63	0.00	
12424.00†	90.000	270.148	7270.00	4509.64	-919.55	-4441.63	0.00	
12524.00†	90.000	270.148	7270.00	4609.15	-919.29	-4541.63	0.00	
12624.00†	90.000	270.148	7270.00	4708.66	-919.03	-4641.62	0.00	
12724.00†	90.000	270.148	7270.00	4808.16	-918.77	-4741.62	0.00	
12824.00†	90.000	270.148	7270.00	4907.67	-918.51	-4841.62	0.00	
12924.00†	90.000	270.148	7270.00	5007.18	-918.25	-4941.62	0.00	
13024.00†	90.000	270.148	7270.00	5106.69	-918.00	-5041.62	0.00	
13124.00†	90.000	270.148	7270.00	5206.19	-917.74	-5141.62	0.00	
13224.00†	90.000	270.148	7270.00	5305.70	-917.48	-5241.62	0.00	
13324.00†	90.000	270.148	7270.00	5405.21	-917.22	-5341.62	0.00	
13424.00†	90.000	270.148	7270.00	5504.72	-916.96	-5441.62	0.00	
13524.00†	90.000	270.148	7270.00	5604.23	-916.70	-5541.62	0.00	
13624.00†	90.000	270.148	7270.00	5703.73	-916.45	-5641.62	0.00	
13724.00†	90.000	270.148	7270.00	5803.24	-916.19	-5741.62	0.00	
13824.00†	90.000	270.148	7270.00	5902.75	-915.93	-5841.62	0.00	
13924.00†	90.000	270.148	7270.00	6002.26	-915.67	-5941.62	0.00	
14024.00†	90.000	270.148	7270.00	6101.77	-915.41	-6041.62	0.00	
14124.00†	90.000	270.148	7270.00	6201.27	-915.15	-6141.62	0.00	
14224.00†	90.000	270.148	7270.00	6300.78	-914.90	-6241.62	0.00	
14324.00†	90.000	270.148	7270.00	6400.29	-914.64	-6341.62	0.00	
14424.00†	90.000	270.148	7270.00	6499.80	-914.38	-6441.62	0.00	





# Planned Wellpath Report

WINDER #9 (REV-A.0) PWP

Page 7 of 9



## REFERENCE WELLPATH IDENTIFICATION

Operator	EXTRACTION OIL & GAS	Slot	SLOT#09 WINDER #9(884'FNL & 684'FEL,SEC.09)
Area	COLORADO	Well	WINDER #9
Field	WELD COUNTY (NAD83/TRUE NORTH)	Wellbore	WINDER #9 PWB
Facility	SEC.09-T06N-R67W		

## WELLPATH DATA (180 stations) † = interpolated/extrapolated station

MD [ft]	Inclination [°]	Azimuth [°]	TVD [ft]	Vert Sect [ft]	North [ft]	East [ft]	DLS [°/100ft]	Comments
14524.00†	90.000	270.148	7270.00	6599.31	-914.12	-6541.62	0.00	
14624.00†	90.000	270.148	7270.00	6698.81	-913.86	-6641.62	0.00	
14724.00†	90.000	270.148	7270.00	6798.32	-913.60	-6741.62	0.00	
14824.00†	90.000	270.148	7270.00	6897.83	-913.35	-6841.62	0.00	
14924.00†	90.000	270.148	7270.00	6997.34	-913.09	-6941.62	0.00	
15024.00†	90.000	270.148	7270.00	7096.84	-912.83	-7041.62	0.00	
15124.00†	90.000	270.148	7270.00	7196.35	-912.57	-7141.62	0.00	
15224.00†	90.000	270.148	7270.00	7295.86	-912.31	-7241.62	0.00	
15324.00†	90.000	270.148	7270.00	7395.37	-912.05	-7341.62	0.00	
15424.00†	90.000	270.148	7270.00	7494.88	-911.79	-7441.62	0.00	
15524.00†	90.000	270.148	7270.00	7594.38	-911.54	-7541.62	0.00	
15624.00†	90.000	270.148	7270.00	7693.89	-911.28	-7641.61	0.00	
15724.00†	90.000	270.148	7270.00	7793.40	-911.02	-7741.61	0.00	
15824.00†	90.000	270.148	7270.00	7892.91	-910.76	-7841.61	0.00	
15924.00†	90.000	270.148	7270.00	7992.42	-910.50	-7941.61	0.00	
16024.00†	90.000	270.148	7270.00	8091.92	-910.24	-8041.61	0.00	
16124.00†	90.000	270.148	7270.00	8191.43	-909.99	-8141.61	0.00	
16224.00†	90.000	270.148	7270.00	8290.94	-909.73	-8241.61	0.00	
16324.00†	90.000	270.148	7270.00	8390.45	-909.47	-8341.61	0.00	
16424.00†	90.000	270.148	7270.00	8489.96	-909.21	-8441.61	0.00	
16524.00†	90.000	270.148	7270.00	8589.46	-908.95	-8541.61	0.00	
16624.00†	90.000	270.148	7270.00	8688.97	-908.69	-8641.61	0.00	
16724.00†	90.000	270.148	7270.00	8788.48	-908.44	-8741.61	0.00	
16824.00†	90.000	270.148	7270.00	8887.99	-908.18	-8841.61	0.00	
16924.00†	90.000	270.148	7270.00	8987.49	-907.92	-8941.61	0.00	
17024.00†	90.000	270.148	7270.00	9087.00	-907.66	-9041.61	0.00	
17124.00†	90.000	270.148	7270.00	9186.51	-907.40	-9141.61	0.00	
17224.00†	90.000	270.148	7270.00	9286.02	-907.14	-9241.61	0.00	
17324.00†	90.000	270.148	7270.00	9385.53	-906.89	-9341.61	0.00	
17334.66	90.000	270.148	7270.00 <sup>2</sup>	9396.13	-906.86	-9352.27	0.00	End of Tangent





# Planned Wellpath Report

WINDER #9 (REV-A.0) PWP

Page 8 of 9



## REFERENCE WELLPATH IDENTIFICATION

Operator	EXTRACTION OIL & GAS	Slot	SLOT#09 WINDER #9(884'FNL & 684'FEL,SEC.09)
Area	COLORADO	Well	WINDER #9
Field	WELD COUNTY (NAD83/TRUE NORTH)	Wellbore	WINDER #9 PWB
Facility	SEC.09-T06N-R67W		

## HOLE & CASING SECTIONS - Ref Wellbore: WINDER #9 PWB Ref Wellpath: WINDER #9 (REV-A.0) PWP

String/Diameter	Start MD [ft]	End MD [ft]	Interval [ft]	Start TVD [ft]	End TVD [ft]	Start N/S [ft]	Start E/W [ft]	End N/S [ft]	End E/W [ft]
7in Casing Intermediate	24.00	7766.30	7742.30	24.00	7270.00	0.00	0.00	-931.58	216.06

## TARGETS

Name	MD [ft]	TVD [ft]	North [ft]	East [ft]	Grid East [US ft]	Grid North [US ft]	Latitude	Longitude	Shape
TWELL/WINDER 1/2 SECTION 08		56.00	-3126.22	-9583.08	3159703.97	1424776.07	40°29'52.771"N	104°55'32.678"W	polygon
TWELL/WINDER 1/2 SECTION 09		56.00	-3126.22	-9583.08	3159703.97	1424776.07	40°29'52.771"N	104°55'32.678"W	polygon
TWELL/WINDER SECTION 08		56.00	-3126.22	-9583.08	3159703.97	1424776.07	40°29'52.771"N	104°55'32.678"W	polygon
TWELL/WINDER SECTION 09		56.00	-3126.22	-9583.08	3159703.97	1424776.07	40°29'52.771"N	104°55'32.678"W	polygon
2) WINDER #9 BHL ON PLAT REV-1(1624'FNL & 460'FWL,SEC.08)	17334.66	7270.00	-906.86	-9352.27	3159919.54	1426996.89	40°30'14.702"N	104°55'29.701"W	point
1) WINDER #9 LANDING POINT	7766.30	7270.00	-931.58	216.06	3169487.48	1427037.84	40°30'14.476"N	104°53'25.836"W	point
WINDER PAD NORTH 1/2 HARDLINES(460' SETBACKS)		7446.00	-3126.22	-9583.08	3159703.97	1424776.07	40°29'52.771"N	104°55'32.678"W	polygon

## SURVEY PROGRAM - Ref Wellbore: WINDER #9 PWB Ref Wellpath: WINDER #9 (REV-A.0) PWP

Start MD [ft]	End MD [ft]	Positional Uncertainty Model	Log Name/Comment	Wellbore
24.00	19000.00	NaviTrak (Standard)		WINDER #9 PWB



# Planned Wellpath Report

WINDER #9 (REV-A.0) PWP

Page 9 of 9



## REFERENCE WELLPATH IDENTIFICATION

Operator	EXTRACTION OIL & GAS	Slot	SLOT#09 WINDER #9(884'FNL & 684'FEL,SEC.09)
Area	COLORADO	Well	WINDER #9
Field	WELD COUNTY (NAD83/TRUE NORTH)	Wellbore	WINDER #9 PWB
Facility	SEC.09-T06N-R67W		

## WELLPATH COMMENTS

MD [ft]	Inclination [°]	Azimuth [°]	TVD [ft]	Comment
7458.83	62.664	265.669	7198.00	NIO A
7664.69	80.959	268.771	7262.00	NIO B