

EXTRACTION OIL & GAS

Location: COLORADO Slot: SLOT#07 WINDER #7(832'FNL & 684'FEL,SEC.09)
Field: WELD COUNTY (NAD83/TRUE NORTH) Well: WINDER #7
Facility: SEC.09-T06N-R67W Wellbore: WINDER #7 PWB

Plot reference wellpath is WINDER #7 (REV-A.0) PWP

True vertical depths are referenced to RIG (RKB)	Grid System: NAD83 / Lambert Colorado SP, Northern Zone (501), US feet
Measured depths are referenced to RIG (RKB)	North Reference: True north
RIG (RKB) to Mean Sea Level: 4892 feet	Scale: True distance
Mean Sea Level to Mud line (At Slot: SLOT#07 WINDER #7(832'FNL & 684'FEL,SEC.09)): 0 feet	Depths are in feet
Coordinates are in feet referenced to Slot	Created by: painsetr on 4/8/2014

Location Information

Facility Name			Grid East (US ft)	Grid North (US ft)	Latitude	Longitude
SEC.09-T06N-R67W			3169265.228	1428175.850	40°30'25.736"N	104°53'28.612"W
Slot	Local N (ft)	Local E (ft)	Grid East (US ft)	Grid North (US ft)	Latitude	Longitude
SLOT#07 WINDER #7(832'FNL & 684'FEL,SEC.09)	-156.25	-1.39	3169264.910	1428019.597	40°30'24.192"N	104°53'28.630"W
RIG (RKB) to Mud line (At Slot: SLOT#07 WINDER #7(832'FNL & 684'FEL,SEC.09))					4892ft	
Mean Sea Level to Mud line (At Slot: SLOT#07 WINDER #7(832'FNL & 684'FEL,SEC.09))					0ft	
RIG (RKB) to Mean Sea Level					4892ft	

Targets

Name	MD (ft)	TVD (ft)	Local N (ft)	Local E (ft)	Grid East (US ft)	Grid North (US ft)	Latitude	Longitude
TWELL/WINDER 1/2 SECTION 08		56.00	-3177.93	-9583.31	3159703.97	1424776.07	40°29'52.771"N	104°55'32.678"W
TWELL/WINDER 1/2 SECTION 09		56.00	-3177.93	-9583.31	3159703.97	1424776.07	40°29'52.771"N	104°55'32.678"W
TWELL/WINDER SECTION 08		56.00	-3177.93	-9583.31	3159703.97	1424776.07	40°29'52.771"N	104°55'32.678"W
TWELL/WINDER SECTION 09		56.00	-3177.93	-9583.31	3159703.97	1424776.07	40°29'52.771"N	104°55'32.678"W
WINDER #7 BHL ON PLAT REV-1(1129'FNL & 460'FWL,SEC.08)	17434.25	7414.00	-463.46	-9355.09	3159913.55	1427491.95	40°30'19.595"N	104°55'29.737"W
WINDER #7 LANDING POINT	7858.85	7414.00	-488.19	220.28	3169488.52	1427532.95	40°30'19.388"N	104°53'25.778"W
WINDER PAD NORTH 1/2 HARDLINES(460' SETBACKS)		7446.00	-3177.93	-9583.31	3159703.97	1424776.07	40°29'52.771"N	104°55'32.678"W

Survey Program

Start MD (ft)	End MD (ft)	Tool	Model	Log Name/Comment	Wellbore
24.00	19000.00	NaviTrak	NaviTrak (Standard)		WINDER #7 PWB

Well Profile Data

Design Comment	MD (ft)	Inc (°)	Az (°)	TVD (ft)	Local N (ft)	Local E (ft)	DLS (°/100ft)	VS (ft)
Tie On	24.00	0.000	117.051	24.00	0.00	0.00	0.00	0.00
End of Tangent	800.00	0.000	117.051	800.00	0.00	0.00	0.00	0.00
End of Build	1279.85	9.597	117.051	1277.61	-18.23	35.71	2.00	-34.76
End of Tangent	6763.85	9.597	117.051	6684.86	-434.03	849.96	0.00	-827.45
End of 3D Arc	7858.85	90.000	270.148	7414.00	-488.19	220.28	9.00	-195.85
End of Tangent	17434.25	90.000	270.148	7414.00	-463.46	-9355.09	0.00	9366.57

Wellpath Comments

MD (ft)	X (ft)	Y (ft)	TVD (ft)	Inclination (°)	Azimuth (°)	VS (ft)	Comment
7317.50	698.75	-472.90	7198.00	41.468	265.182	-674.49	NIO A
7408.99	633.66	-477.62	7262.00	49.654	266.422	-609.25	NIO B
7504.16	556.92	-481.71	7318.00	58.181	267.427	-532.40	NIO C
7637.46	437.24	-485.84	7376.00	70.135	268.564	-412.67	FORT HAYS
7706.88	370.81	-487.20	7396.00	76.363	269.084	-346.25	CODELL

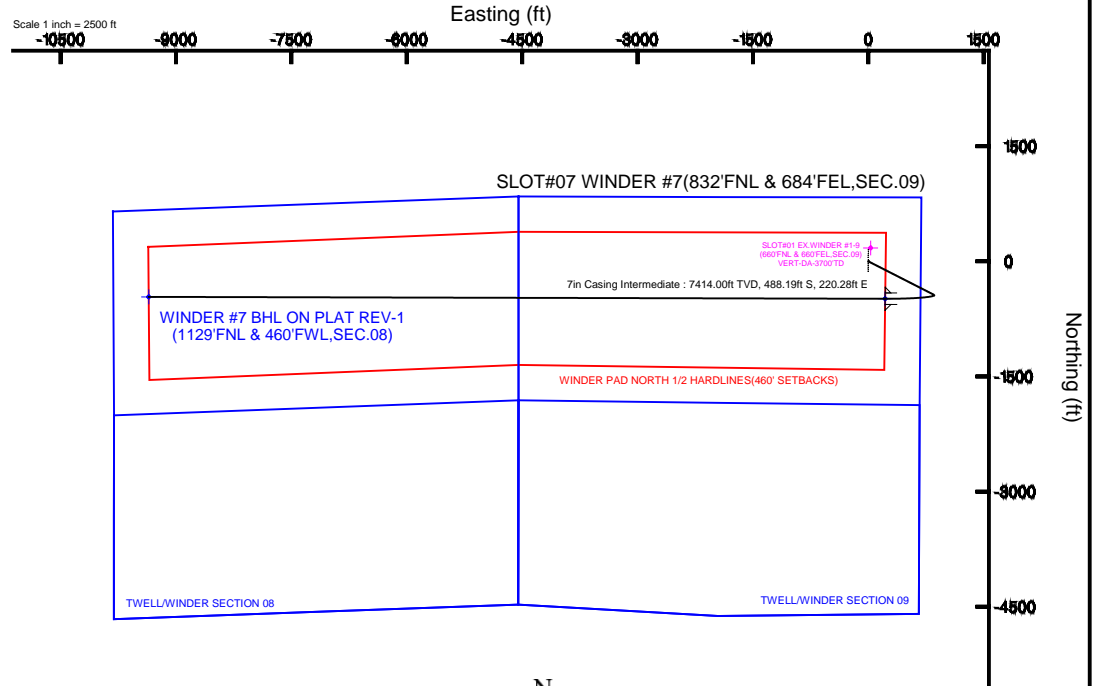

BGGM (1945.0 to 2015.0) Dip: 67.01° Field: 52838.7 nT
Magnetic North is 8.61 degrees East of True North (at 4/7/2014)

To correct azimuth from Magnetic to True add 8.61 degrees

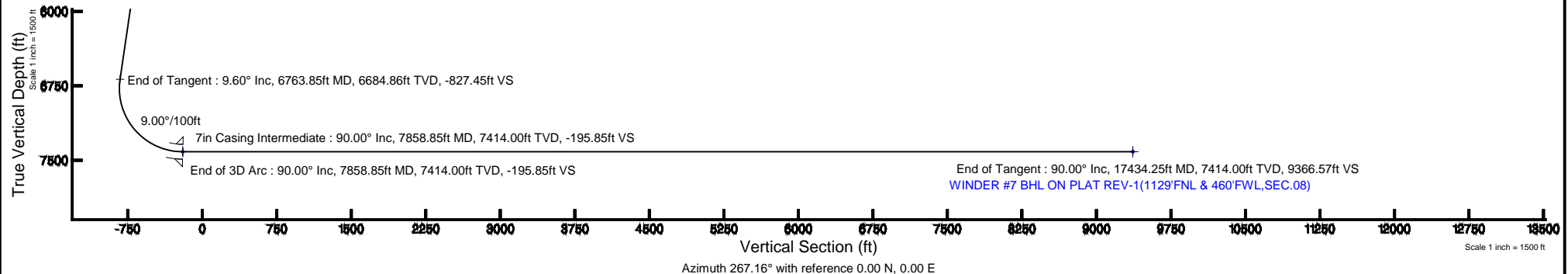



Planned Wellpath Report

WINDER #7 (REV-A.0) PWP

Page 1 of 10



REFERENCE WELLPATH IDENTIFICATION

Operator	EXTRACTION OIL & GAS	Slot	SLOT#07 WINDER #7(832'FNL & 684'FEL,SEC.09)
Area	COLORADO	Well	WINDER #7
Field	WELD COUNTY (NAD83/TRUE NORTH)	Wellbore	WINDER #7 PWB
Facility	SEC.09-T06N-R67W		

REPORT SETUP INFORMATION

Projection System	NAD83 / Lambert Colorado SP, Northern Zone (501), US feet	Software System	WellArchitect® 4.0.0
North Reference	True	User	Painsetr
Scale	0.999967	Report Generated	4/8/2014 at 12:52:17 PM
Convergence at slot	n/a	Database/Source file	WA_Denver/WINDER_#7_PWB.xml

WELLPATH LOCATION

	Local coordinates		Grid coordinates		Geographic coordinates	
	North[ft]	East[ft]	Easting[US ft]	Northing[US ft]	Latitude	Longitude
Slot Location	-156.25	-1.39	3169264.91	1428019.60	40°30'24.192"N	104°53'28.630"W
Facility Reference Pt			3169265.23	1428175.85	40°30'25.736"N	104°53'28.612"W
Field Reference Pt			3185481.27	1419166.81	40°28'55.560"N	104°49'59.556"W

WELLPATH DATUM

Calculation method	Minimum curvature	RIG (RKB) to Facility Vertical Datum	4892.00ft
Horizontal Reference Pt	Slot	RIG (RKB) to Mean Sea Level	4892.00ft
Vertical Reference Pt	RIG (RKB)	RIG (RKB) to Mud Line at Slot (SLOT#07 WINDER #7(832'FNL & 684'FEL,SEC.09))	4892.00ft
MD Reference Pt	RIG (RKB)	Section Origin	N 0.00, E 0.00 ft
Field Vertical Reference	Mean Sea Level	Section Azimuth	267.16°



Planned Wellpath Report

WINDER #7 (REV-A.0) PWP

Page 2 of 10



REFERENCE WELLPATH IDENTIFICATION

Operator	EXTRACTION OIL & GAS	Slot	SLOT#07 WINDER #7(832'FNL & 684'FEL,SEC.09)
Area	COLORADO	Well	WINDER #7
Field	WELD COUNTY (NAD83/TRUE NORTH)	Wellbore	WINDER #7 PWB
Facility	SEC.09-T06N-R67W		

WELLPATH DATA (181 stations) † = interpolated/extrapolated station

MD [ft]	Inclination [°]	Azimuth [°]	TVD [ft]	Vert Sect [ft]	North [ft]	East [ft]	DLS [°/100ft]	Comments
0.00†	0.000	117.051	0.00	0.00	0.00	0.00	0.00	
24.00	0.000	117.051	24.00	0.00	0.00	0.00	0.00	Tie On
124.00†	0.000	117.051	124.00	0.00	0.00	0.00	0.00	
224.00†	0.000	117.051	224.00	0.00	0.00	0.00	0.00	
324.00†	0.000	117.051	324.00	0.00	0.00	0.00	0.00	
424.00†	0.000	117.051	424.00	0.00	0.00	0.00	0.00	
524.00†	0.000	117.051	524.00	0.00	0.00	0.00	0.00	
624.00†	0.000	117.051	624.00	0.00	0.00	0.00	0.00	
724.00†	0.000	117.051	724.00	0.00	0.00	0.00	0.00	
800.00	0.000	117.051	800.00	0.00	0.00	0.00	0.00	End of Tangent
824.00†	0.480	117.051	824.00	-0.09	-0.05	0.09	2.00	
924.00†	2.480	117.051	923.96	-2.33	-1.22	2.39	2.00	
1024.00†	4.480	117.051	1023.77	-7.59	-3.98	7.80	2.00	
1124.00†	6.480	117.051	1123.31	-15.87	-8.32	16.30	2.00	
1224.00†	8.480	117.051	1222.45	-27.15	-14.24	27.89	2.00	
1279.85	9.597	117.051	1277.61	-34.76	-18.23	35.71	2.00	End of Build
1324.00†	9.597	117.051	1321.14	-41.14	-21.58	42.26	0.00	
1424.00†	9.597	117.051	1419.74	-55.60	-29.16	57.11	0.00	
1524.00†	9.597	117.051	1518.34	-70.05	-36.75	71.96	0.00	
1624.00†	9.597	117.051	1616.94	-84.51	-44.33	86.81	0.00	
1724.00†	9.597	117.051	1715.54	-98.96	-51.91	101.65	0.00	
1824.00†	9.597	117.051	1814.14	-113.42	-59.49	116.50	0.00	
1924.00†	9.597	117.051	1912.74	-127.87	-67.07	131.35	0.00	
2024.00†	9.597	117.051	2011.34	-142.32	-74.65	146.20	0.00	
2124.00†	9.597	117.051	2109.95	-156.78	-82.24	161.05	0.00	
2224.00†	9.597	117.051	2208.55	-171.23	-89.82	175.89	0.00	
2324.00†	9.597	117.051	2307.15	-185.69	-97.40	190.74	0.00	
2424.00†	9.597	117.051	2405.75	-200.14	-104.98	205.59	0.00	
2524.00†	9.597	117.051	2504.35	-214.60	-112.56	220.44	0.00	
2624.00†	9.597	117.051	2602.95	-229.05	-120.15	235.28	0.00	



Planned Wellpath Report

WINDER #7 (REV-A.0) PWP

Page 3 of 10



REFERENCE WELLPATH IDENTIFICATION

Operator	EXTRACTION OIL & GAS	Slot	SLOT#07 WINDER #7(832'FNL & 684'FEL,SEC.09)
Area	COLORADO	Well	WINDER #7
Field	WELD COUNTY (NAD83/TRUE NORTH)	Wellbore	WINDER #7 PWB
Facility	SEC.09-T06N-R67W		

WELLPATH DATA (181 stations) † = interpolated/extrapolated station

MD [ft]	Inclination [°]	Azimuth [°]	TVD [ft]	Vert Sect [ft]	North [ft]	East [ft]	DLS [°/100ft]	Comments
2724.00†	9.597	117.051	2701.55	-243.51	-127.73	250.13	0.00	
2824.00†	9.597	117.051	2800.15	-257.96	-135.31	264.98	0.00	
2924.00†	9.597	117.051	2898.75	-272.41	-142.89	279.83	0.00	
3024.00†	9.597	117.051	2997.35	-286.87	-150.47	294.68	0.00	
3124.00†	9.597	117.051	3095.95	-301.32	-158.06	309.52	0.00	
3224.00†	9.597	117.051	3194.55	-315.78	-165.64	324.37	0.00	
3324.00†	9.597	117.051	3293.15	-330.23	-173.22	339.22	0.00	
3424.00†	9.597	117.051	3391.75	-344.69	-180.80	354.07	0.00	
3524.00†	9.597	117.051	3490.35	-359.14	-188.38	368.91	0.00	
3624.00†	9.597	117.051	3588.95	-373.60	-195.97	383.76	0.00	
3724.00†	9.597	117.051	3687.55	-388.05	-203.55	398.61	0.00	
3824.00†	9.597	117.051	3786.15	-402.51	-211.13	413.46	0.00	
3924.00†	9.597	117.051	3884.75	-416.96	-218.71	428.31	0.00	
4024.00†	9.597	117.051	3983.35	-431.41	-226.29	443.15	0.00	
4124.00†	9.597	117.051	4081.96	-445.87	-233.88	458.00	0.00	
4224.00†	9.597	117.051	4180.56	-460.32	-241.46	472.85	0.00	
4324.00†	9.597	117.051	4279.16	-474.78	-249.04	487.70	0.00	
4424.00†	9.597	117.051	4377.76	-489.23	-256.62	502.55	0.00	
4524.00†	9.597	117.051	4476.36	-503.69	-264.20	517.39	0.00	
4624.00†	9.597	117.051	4574.96	-518.14	-271.79	532.24	0.00	
4724.00†	9.597	117.051	4673.56	-532.60	-279.37	547.09	0.00	
4824.00†	9.597	117.051	4772.16	-547.05	-286.95	561.94	0.00	
4924.00†	9.597	117.051	4870.76	-561.50	-294.53	576.78	0.00	
5024.00†	9.597	117.051	4969.36	-575.96	-302.11	591.63	0.00	
5124.00†	9.597	117.051	5067.96	-590.41	-309.70	606.48	0.00	
5224.00†	9.597	117.051	5166.56	-604.87	-317.28	621.33	0.00	
5324.00†	9.597	117.051	5265.16	-619.32	-324.86	636.18	0.00	
5424.00†	9.597	117.051	5363.76	-633.78	-332.44	651.02	0.00	
5524.00†	9.597	117.051	5462.36	-648.23	-340.02	665.87	0.00	
5624.00†	9.597	117.051	5560.96	-662.69	-347.61	680.72	0.00	



Planned Wellpath Report

WINDER #7 (REV-A.0) PWP

Page 4 of 10



REFERENCE WELLPATH IDENTIFICATION

Operator	EXTRACTION OIL & GAS	Slot	SLOT#07 WINDER #7(832'FNL & 684'FEL,SEC.09)
Area	COLORADO	Well	WINDER #7
Field	WELD COUNTY (NAD83/TRUE NORTH)	Wellbore	WINDER #7 PWB
Facility	SEC.09-T06N-R67W		

WELLPATH DATA (181 stations) † = interpolated/extrapolated station

MD [ft]	Inclination [°]	Azimuth [°]	TVD [ft]	Vert Sect [ft]	North [ft]	East [ft]	DLS [°/100ft]	Comments
5724.00†	9.597	117.051	5659.56	-677.14	-355.19	695.57	0.00	
5824.00†	9.597	117.051	5758.16	-691.59	-362.77	710.41	0.00	
5924.00†	9.597	117.051	5856.76	-706.05	-370.35	725.26	0.00	
6024.00†	9.597	117.051	5955.36	-720.50	-377.93	740.11	0.00	
6124.00†	9.597	117.051	6053.96	-734.96	-385.51	754.96	0.00	
6224.00†	9.597	117.051	6152.57	-749.41	-393.10	769.81	0.00	
6324.00†	9.597	117.051	6251.17	-763.87	-400.68	784.65	0.00	
6424.00†	9.597	117.051	6349.77	-778.32	-408.26	799.50	0.00	
6524.00†	9.597	117.051	6448.37	-792.78	-415.84	814.35	0.00	
6624.00†	9.597	117.051	6546.97	-807.23	-423.42	829.20	0.00	
6724.00†	9.597	117.051	6645.57	-821.69	-431.01	844.05	0.00	
6763.85	9.597	117.051	6684.86	-827.45	-434.03	849.96	0.00	End of Tangent
6824.00†	5.382	144.455	6744.50	-833.32	-438.61	856.07	9.00	
6924.00†	7.311	233.541	6844.08	-830.55	-446.22	853.68	9.00	
7024.00†	15.480	254.111	6942.06	-812.21	-453.67	835.69	9.00	
7124.00†	24.238	260.364	7036.03	-778.76	-460.77	802.55	9.00	
7224.00†	33.121	263.413	7123.68	-731.02	-467.36	755.07	9.00	
7324.00†	42.049	265.282	7202.85	-670.16	-473.26	694.43	9.00	
7424.00†	50.999	266.596	7271.59	-597.69	-478.33	622.12	9.00	
7524.00†	59.960	267.612	7328.20	-515.38	-482.45	539.92	9.00	
7624.00†	68.928	268.459	7371.29	-425.27	-485.51	449.85	9.00	
7724.00†	77.899	269.208	7399.81	-329.57	-487.45	354.13	9.00	
7824.00†	86.872	269.908	7413.05	-230.64	-488.20	255.11	9.00	
7858.85	90.000	270.148	7414.00 [†]	-195.85	-488.19	220.28	9.00	End of 3D Arc
7924.00†	90.000	270.148	7414.00	-130.79	-488.02	155.13	0.00	
8024.00†	90.000	270.148	7414.00	-30.93	-487.76	55.13	0.00	
8124.00†	90.000	270.148	7414.00	68.94	-487.50	-44.87	0.00	
8224.00†	90.000	270.148	7414.00	168.80	-487.24	-144.87	0.00	
8324.00†	90.000	270.148	7414.00	268.67	-486.99	-244.87	0.00	
8424.00†	90.000	270.148	7414.00	368.53	-486.73	-344.87	0.00	



Planned Wellpath Report

WINDER #7 (REV-A.0) PWP

Page 5 of 10



REFERENCE WELLPATH IDENTIFICATION

Operator	EXTRACTION OIL & GAS	Slot	SLOT#07 WINDER #7(832'FNL & 684'FEL,SEC.09)
Area	COLORADO	Well	WINDER #7
Field	WELD COUNTY (NAD83/TRUE NORTH)	Wellbore	WINDER #7 PWB
Facility	SEC.09-T06N-R67W		

WELLPATH DATA (181 stations) † = interpolated/extrapolated station

MD [ft]	Inclination [°]	Azimuth [°]	TVD [ft]	Vert Sect [ft]	North [ft]	East [ft]	DLS [°/100ft]	Comments
8524.00†	90.000	270.148	7414.00	468.39	-486.47	-444.87	0.00	
8624.00†	90.000	270.148	7414.00	568.26	-486.21	-544.87	0.00	
8724.00†	90.000	270.148	7414.00	668.12	-485.95	-644.87	0.00	
8824.00†	90.000	270.148	7414.00	767.99	-485.69	-744.87	0.00	
8924.00†	90.000	270.148	7414.00	867.85	-485.44	-844.87	0.00	
9024.00†	90.000	270.148	7414.00	967.72	-485.18	-944.87	0.00	
9124.00†	90.000	270.148	7414.00	1067.58	-484.92	-1044.87	0.00	
9224.00†	90.000	270.148	7414.00	1167.45	-484.66	-1144.87	0.00	
9324.00†	90.000	270.148	7414.00	1267.31	-484.40	-1244.87	0.00	
9424.00†	90.000	270.148	7414.00	1367.17	-484.14	-1344.87	0.00	
9524.00†	90.000	270.148	7414.00	1467.04	-483.89	-1444.87	0.00	
9624.00†	90.000	270.148	7414.00	1566.90	-483.63	-1544.86	0.00	
9724.00†	90.000	270.148	7414.00	1666.77	-483.37	-1644.86	0.00	
9824.00†	90.000	270.148	7414.00	1766.63	-483.11	-1744.86	0.00	
9924.00†	90.000	270.148	7414.00	1866.50	-482.85	-1844.86	0.00	
10024.00†	90.000	270.148	7414.00	1966.36	-482.60	-1944.86	0.00	
10124.00†	90.000	270.148	7414.00	2066.22	-482.34	-2044.86	0.00	
10224.00†	90.000	270.148	7414.00	2166.09	-482.08	-2144.86	0.00	
10324.00†	90.000	270.148	7414.00	2265.95	-481.82	-2244.86	0.00	
10424.00†	90.000	270.148	7414.00	2365.82	-481.56	-2344.86	0.00	
10524.00†	90.000	270.148	7414.00	2465.68	-481.30	-2444.86	0.00	
10624.00†	90.000	270.148	7414.00	2565.55	-481.05	-2544.86	0.00	
10724.00†	90.000	270.148	7414.00	2665.41	-480.79	-2644.86	0.00	
10824.00†	90.000	270.148	7414.00	2765.28	-480.53	-2744.86	0.00	
10924.00†	90.000	270.148	7414.00	2865.14	-480.27	-2844.86	0.00	
11024.00†	90.000	270.148	7414.00	2965.00	-480.01	-2944.86	0.00	
11124.00†	90.000	270.148	7414.00	3064.87	-479.75	-3044.86	0.00	
11224.00†	90.000	270.148	7414.00	3164.73	-479.50	-3144.86	0.00	
11324.00†	90.000	270.148	7414.00	3264.60	-479.24	-3244.86	0.00	
11424.00†	90.000	270.148	7414.00	3364.46	-478.98	-3344.86	0.00	



Planned Wellpath Report

WINDER #7 (REV-A.0) PWP

Page 6 of 10



REFERENCE WELLPATH IDENTIFICATION

Operator	EXTRACTION OIL & GAS	Slot	SLOT#07 WINDER #7(832'FNL & 684'FEL,SEC.09)
Area	COLORADO	Well	WINDER #7
Field	WELD COUNTY (NAD83/TRUE NORTH)	Wellbore	WINDER #7 PWB
Facility	SEC.09-T06N-R67W		

WELLPATH DATA (181 stations) † = interpolated/extrapolated station

MD [ft]	Inclination [°]	Azimuth [°]	TVD [ft]	Vert Sect [ft]	North [ft]	East [ft]	DLS [°/100ft]	Comments
11524.00†	90.000	270.148	7414.00	3464.33	-478.72	-3444.86	0.00	
11624.00†	90.000	270.148	7414.00	3564.19	-478.46	-3544.86	0.00	
11724.00†	90.000	270.148	7414.00	3664.06	-478.21	-3644.86	0.00	
11824.00†	90.000	270.148	7414.00	3763.92	-477.95	-3744.86	0.00	
11924.00†	90.000	270.148	7414.00	3863.78	-477.69	-3844.86	0.00	
12024.00†	90.000	270.148	7414.00	3963.65	-477.43	-3944.86	0.00	
12124.00†	90.000	270.148	7414.00	4063.51	-477.17	-4044.86	0.00	
12224.00†	90.000	270.148	7414.00	4163.38	-476.91	-4144.86	0.00	
12324.00†	90.000	270.148	7414.00	4263.24	-476.66	-4244.86	0.00	
12424.00†	90.000	270.148	7414.00	4363.11	-476.40	-4344.86	0.00	
12524.00†	90.000	270.148	7414.00	4462.97	-476.14	-4444.86	0.00	
12624.00†	90.000	270.148	7414.00	4562.83	-475.88	-4544.85	0.00	
12724.00†	90.000	270.148	7414.00	4662.70	-475.62	-4644.85	0.00	
12824.00†	90.000	270.148	7414.00	4762.56	-475.37	-4744.85	0.00	
12924.00†	90.000	270.148	7414.00	4862.43	-475.11	-4844.85	0.00	
13024.00†	90.000	270.148	7414.00	4962.29	-474.85	-4944.85	0.00	
13124.00†	90.000	270.148	7414.00	5062.16	-474.59	-5044.85	0.00	
13224.00†	90.000	270.148	7414.00	5162.02	-474.33	-5144.85	0.00	
13324.00†	90.000	270.148	7414.00	5261.89	-474.07	-5244.85	0.00	
13424.00†	90.000	270.148	7414.00	5361.75	-473.82	-5344.85	0.00	
13524.00†	90.000	270.148	7414.00	5461.61	-473.56	-5444.85	0.00	
13624.00†	90.000	270.148	7414.00	5561.48	-473.30	-5544.85	0.00	
13724.00†	90.000	270.148	7414.00	5661.34	-473.04	-5644.85	0.00	
13824.00†	90.000	270.148	7414.00	5761.21	-472.78	-5744.85	0.00	
13924.00†	90.000	270.148	7414.00	5861.07	-472.52	-5844.85	0.00	
14024.00†	90.000	270.148	7414.00	5960.94	-472.27	-5944.85	0.00	
14124.00†	90.000	270.148	7414.00	6060.80	-472.01	-6044.85	0.00	
14224.00†	90.000	270.148	7414.00	6160.67	-471.75	-6144.85	0.00	
14324.00†	90.000	270.148	7414.00	6260.53	-471.49	-6244.85	0.00	
14424.00†	90.000	270.148	7414.00	6360.39	-471.23	-6344.85	0.00	



Planned Wellpath Report

WINDER #7 (REV-A.0) PWP

Page 7 of 10



REFERENCE WELLPATH IDENTIFICATION			
Operator	EXTRACTION OIL & GAS	Slot	SLOT#07 WINDER #7(832'FNL & 684'FEL,SEC.09)
Area	COLORADO	Well	WINDER #7
Field	WELD COUNTY (NAD83/TRUE NORTH)	Wellbore	WINDER #7 PWB
Facility	SEC.09-T06N-R67W		

WELLPATH DATA (181 stations) † = interpolated/extrapolated station								
MD [ft]	Inclination [°]	Azimuth [°]	TVD [ft]	Vert Sect [ft]	North [ft]	East [ft]	DLS [°/100ft]	Comments
14524.00†	90.000	270.148	7414.00	6460.26	-470.98	-6444.85	0.00	
14624.00†	90.000	270.148	7414.00	6560.12	-470.72	-6544.85	0.00	
14724.00†	90.000	270.148	7414.00	6659.99	-470.46	-6644.85	0.00	
14824.00†	90.000	270.148	7414.00	6759.85	-470.20	-6744.85	0.00	
14924.00†	90.000	270.148	7414.00	6859.72	-469.94	-6844.85	0.00	
15024.00†	90.000	270.148	7414.00	6959.58	-469.68	-6944.85	0.00	
15124.00†	90.000	270.148	7414.00	7059.44	-469.43	-7044.85	0.00	
15224.00†	90.000	270.148	7414.00	7159.31	-469.17	-7144.85	0.00	
15324.00†	90.000	270.148	7414.00	7259.17	-468.91	-7244.85	0.00	
15424.00†	90.000	270.148	7414.00	7359.04	-468.65	-7344.85	0.00	
15524.00†	90.000	270.148	7414.00	7458.90	-468.39	-7444.85	0.00	
15624.00†	90.000	270.148	7414.00	7558.77	-468.14	-7544.84	0.00	
15724.00†	90.000	270.148	7414.00	7658.63	-467.88	-7644.84	0.00	
15824.00†	90.000	270.148	7414.00	7758.50	-467.62	-7744.84	0.00	
15924.00†	90.000	270.148	7414.00	7858.36	-467.36	-7844.84	0.00	
16024.00†	90.000	270.148	7414.00	7958.22	-467.10	-7944.84	0.00	
16124.00†	90.000	270.148	7414.00	8058.09	-466.84	-8044.84	0.00	
16224.00†	90.000	270.148	7414.00	8157.95	-466.59	-8144.84	0.00	
16324.00†	90.000	270.148	7414.00	8257.82	-466.33	-8244.84	0.00	
16424.00†	90.000	270.148	7414.00	8357.68	-466.07	-8344.84	0.00	
16524.00†	90.000	270.148	7414.00	8457.55	-465.81	-8444.84	0.00	
16624.00†	90.000	270.148	7414.00	8557.41	-465.55	-8544.84	0.00	
16724.00†	90.000	270.148	7414.00	8657.28	-465.29	-8644.84	0.00	
16824.00†	90.000	270.148	7414.00	8757.14	-465.04	-8744.84	0.00	
16924.00†	90.000	270.148	7414.00	8857.00	-464.78	-8844.84	0.00	
17024.00†	90.000	270.148	7414.00	8956.87	-464.52	-8944.84	0.00	
17124.00†	90.000	270.148	7414.00	9056.73	-464.26	-9044.84	0.00	
17224.00†	90.000	270.148	7414.00	9156.60	-464.00	-9144.84	0.00	
17324.00†	90.000	270.148	7414.00	9256.46	-463.75	-9244.84	0.00	
17424.00†	90.000	270.148	7414.00	9356.33	-463.49	-9344.84	0.00	



Planned Wellpath Report

WINDER #7 (REV-A.0) PWP

Page 8 of 10



REFERENCE WELLPATH IDENTIFICATION

Operator	EXTRACTION OIL & GAS	Slot	SLOT#07 WINDER #7(832'FNL & 684'FEL,SEC.09)
Area	COLORADO	Well	WINDER #7
Field	WELD COUNTY (NAD83/TRUE NORTH)	Wellbore	WINDER #7 PWB
Facility	SEC.09-T06N-R67W		

WELLPATH DATA (181 stations)

MD [ft]	Inclination [°]	Azimuth [°]	TVD [ft]	Vert Sect [ft]	North [ft]	East [ft]	DLS [°/100ft]	Comments
17434.25	90.000	270.148	7414.00 ²	9366.57	-463.46	-9355.09	0.00	End of Tangent

HOLE & CASING SECTIONS - Ref Wellbore: WINDER #7 PWB Ref Wellpath: WINDER #7 (REV-A.0) PWP

String/Diameter	Start MD [ft]	End MD [ft]	Interval [ft]	Start TVD [ft]	End TVD [ft]	Start N/S [ft]	Start E/W [ft]	End N/S [ft]	End E/W [ft]
7in Casing Intermediate	24.00	7858.85	7834.85	24.00	7414.00	0.00	0.00	-488.19	220.28



Planned Wellpath Report

WINDER #7 (REV-A.0) PWP

Page 9 of 10



REFERENCE WELLPATH IDENTIFICATION

Operator	EXTRACTION OIL & GAS	Slot	SLOT#07 WINDER #7(832'FNL & 684'FEL,SEC.09)
Area	COLORADO	Well	WINDER #7
Field	WELD COUNTY (NAD83/TRUE NORTH)	Wellbore	WINDER #7 PWB
Facility	SEC.09-T06N-R67W		

TARGETS

Name	MD [ft]	TVD [ft]	North [ft]	East [ft]	Grid East [US ft]	Grid North [US ft]	Latitude	Longitude	Shape
TWELL/WINDER 1/2 SECTION 08		56.00	-3177.93	-9583.31	3159703.97	1424776.07	40°29'52.771"N	104°55'32.678"W	polygon
TWELL/WINDER 1/2 SECTION 09		56.00	-3177.93	-9583.31	3159703.97	1424776.07	40°29'52.771"N	104°55'32.678"W	polygon
TWELL/WINDER SECTION 08		56.00	-3177.93	-9583.31	3159703.97	1424776.07	40°29'52.771"N	104°55'32.678"W	polygon
TWELL/WINDER SECTION 09		56.00	-3177.93	-9583.31	3159703.97	1424776.07	40°29'52.771"N	104°55'32.678"W	polygon
2) WINDER #7 BHL ON PLAT REV-1(1129'FNL & 460'FWL,SEC.08)	17434.25	7414.00	-463.46	-9355.09	3159913.55	1427491.95	40°30'19.595"N	104°55'29.737"W	point
1) WINDER #7 LANDING POINT	7858.85	7414.00	-488.19	220.28	3169488.52	1427532.95	40°30'19.368"N	104°53'25.778"W	point
WINDER PAD NORTH 1/2 HARDLINES(460' SETBACKS)		7446.00	-3177.93	-9583.31	3159703.97	1424776.07	40°29'52.771"N	104°55'32.678"W	polygon

SURVEY PROGRAM - Ref Wellbore: WINDER #7 PWB Ref Wellpath: WINDER #7 (REV-A.0) PWP

Start MD [ft]	End MD [ft]	Positional Uncertainty Model	Log Name/Comment	Wellbore
24.00	19000.00	NaviTrak (Standard)		WINDER #7 PWB



Planned Wellpath Report

WINDER #7 (REV-A.0) PWP

Page 10 of 10



REFERENCE WELLPATH IDENTIFICATION

Operator	EXTRACTION OIL & GAS	Slot	SLOT#07 WINDER #7(832'FNL & 684'FEL,SEC.09)
Area	COLORADO	Well	WINDER #7
Field	WELD COUNTY (NAD83/TRUE NORTH)	Wellbore	WINDER #7 PWB
Facility	SEC.09-T06N-R67W		

WELLPATH COMMENTS

MD [ft]	Inclination [°]	Azimuth [°]	TVD [ft]	Comment
7317.50	41.468	265.182	7198.00	NIO A
7408.99	49.654	266.422	7262.00	NIO B
7504.16	58.181	267.427	7318.00	NIO C
7637.46	70.135	268.564	7376.00	FORT HAYS
7706.88	76.363	269.084	7396.00	CODELL