



Lat40°, Inc. 1635 Foxtrail Drive, Suite 325 Loveland, CO 970-776-3321

HYDROLOGY MAP

LEDFORD 22Y-HZ PAD

SECTION: 22
TOWNSHIP: 5N
RANGE: 64W

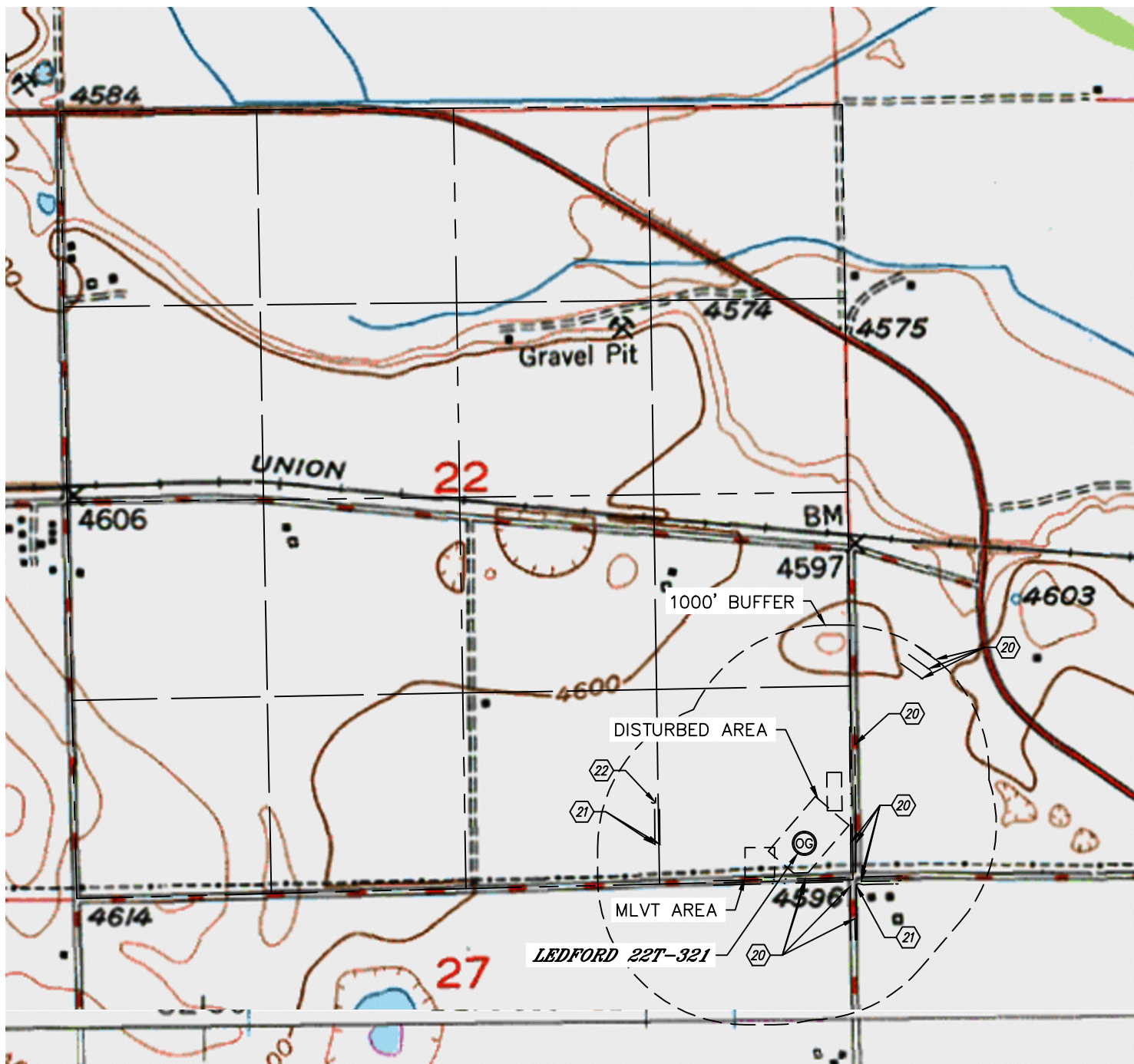

- 20 BARROW DITCH 240' & 268' S, 315' & 349' E, 428', 447', 465' & 615' SE, 753', 1373', 1453' & 1532' NE
- 21 DITCH 455' SE, 980' & 1014' W
- 22 POND 1047' NW

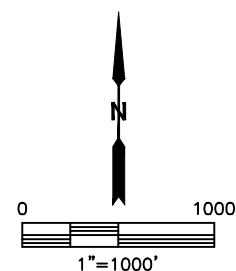

NEAREST DOWN GRADIENT SURFACE WATER: BARROW DITCH 240' S

DATE: 1/28/2014
PROJECT#: 2013182