



May 5, 2013

7535 Hilltop Circle
Denver, CO 80221
www.petro-fs.com

Mr. Matt Lepore, Director
Colorado Oil and Gas Conservation Commission
1120 Lincoln Street, Suite 801
Denver, Colorado 80203

**RE: COGCC Rule 318A.e.: Proposed Wellbore Spacing Unit
Kaiser H-10HC Well: NENE Section 10, Township 6 North, Range 65 West
Weld County, Colorado**

Dear Mr. Lepore:

Bayswater Exploration & Production, LLC (Bayswater) is planning to drill the above referenced wells in accordance with the provisions set out in COGCC Rule 318A.e. Bayswater's proposed wellbore spacing unit consists of:

SWNW, SENW, SWNE, SENE of Section 10, Township 6 North, Range 65 West
NWSW, NESW, NWSE, NESE of Section 10, Township 6 North, Range 65 West
Containing 320 acres

Bayswater is not the only owner within the proposed wellbore spacing unit and has provided notice to the remaining owner(s) within this spacing unit, as required by COGCC Rule 318A.e.(6). Copies of the required notification letters are on file at Bayswater's office. The required thirty (30) day notice period has elapsed absent the receipt by Bayswater of any objection to their proposal by the owners within the proposed spacing unit for the subject well.

Enclosed is the Proposed Spacing Unit Plat to assist in your review and approval of Bayswater's proposed Application for Permit to Drill (APD) for Kaiser H-10HC well. Many thanks for your attention to this matter.

Respectfully,

Jennifer Grosshans
Regulatory Technician
Agent for Bayswater Exploration & Production, LLC

:jg

Enclosure: Proposed Spacing Unit Plat

We are what we repeatedly do. Excellence, then, is not an act, but a habit.

-Aristotle

PROPOSED 318A.e. WELLBORE SPACING UNIT

SECTION 10, TOWNSHIP 6 NORTH, RANGE 65 WEST, 6TH P.M.

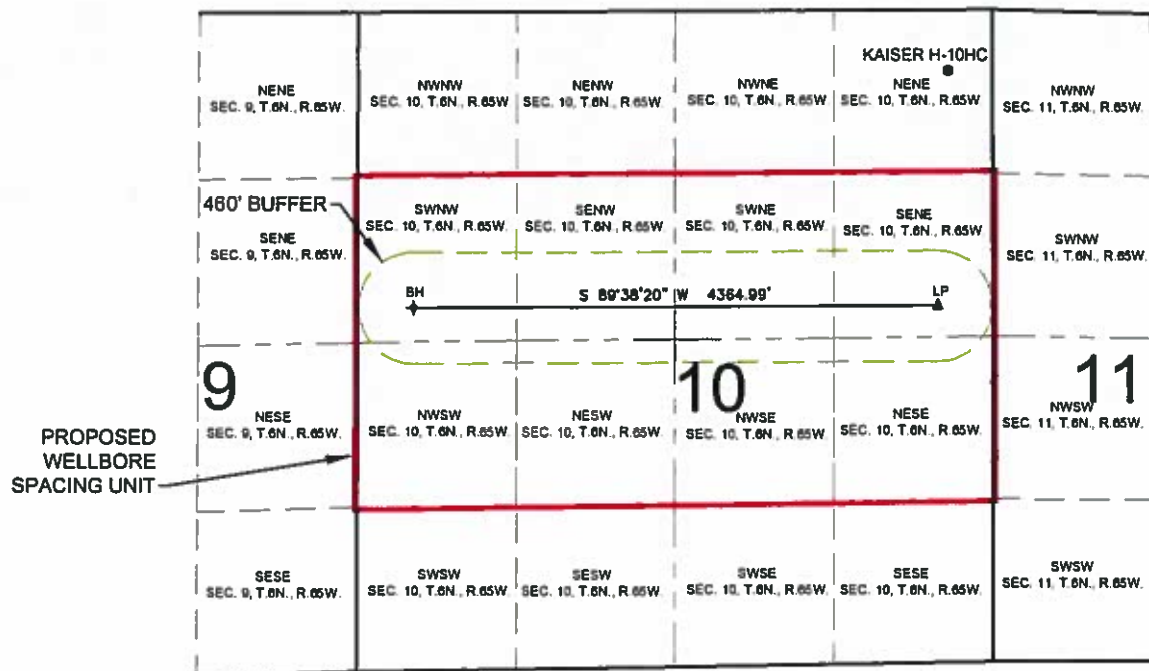

WELL KAISER H-10HC TO BE LOCATED 502' FNL AND 378' FEL, SEC. 10, T6N, R65W

SURFACE LOCATION

NAD83

LATITUDE= 40.507117°

LONGITUDE= 104.641205°

LANDING POINT LOCATION

NAD83

LATITUDE= 40.501771°

LONGITUDE= 104.641612°

BOTTOM HOLE LOCATION

NAD83

LATITUDE= 40.501811°

LONGITUDE= 104.657308°

LEGEND

- = PROPOSED WELL
- ▲ = LANDING POINT
- ✦ = BOTTOM HOLE
- LP = LANDING POINT
- BH = BOTTOM HOLE

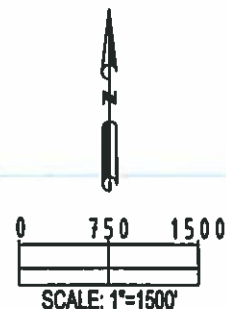

PREPARED BY: BCC Petroleum Field Services, LLC 7230 Hilltop Circle Denver, CO 80221	FIELD DATE:	12-12-13	SURFACE LOCATION: NE 1/4 NE 1/4, SEC. 10, T6N, R65W, 6TH P.M. WELD COUNTY, COLORADO
	DRAWING DATE:	02-03-14	
	BY:	KAD	
	CHECKED:	MLP	