

Hydrology Map

H O L T O N 1 2 - C P A D

M U L T I W E L L P A D

NW¼ NE¼ SECTION 12, TOWNSHIP 6 NORTH, RANGE 65 WEST OF THE 6TH PRINCIPAL MERIDIAN

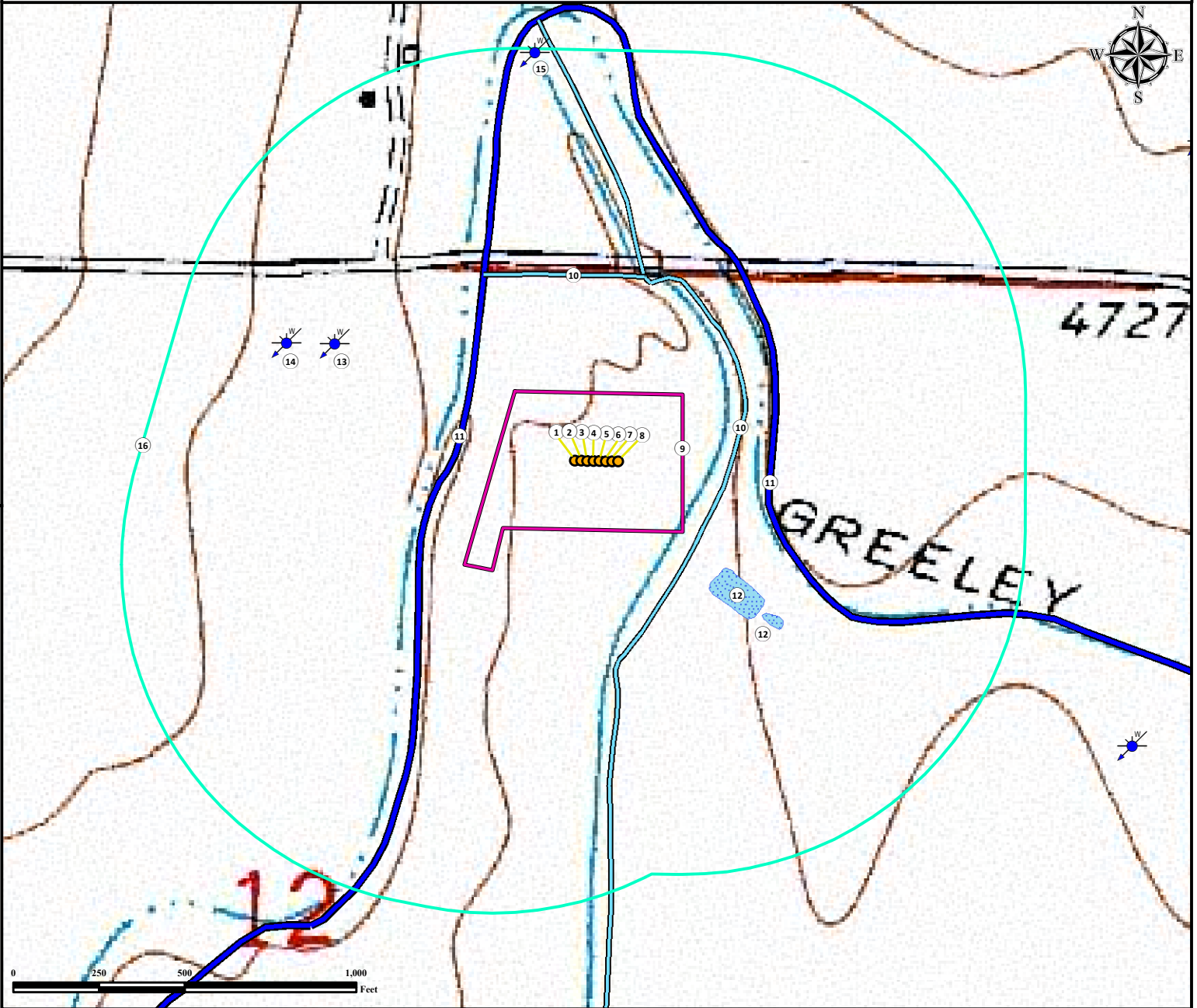

- 1. Proposed Well HOLTON F-12HN.
- 2. Proposed Well HOLTON G-12HN.
- 3. Proposed Well HOLTON H-12HN.
- 4. Proposed Well HOLTON I-12HN.
- 5. Proposed Well HOLTON J-12HC.
- 6. Proposed Well HOLTON K-12HN.
- 7. Proposed Well HOLTON L-12HN.
- 8. Proposed Well HOLTON M-12HC.

- 9. Operational Disturbance Area.
- 10. Ditches are ±371' E, and ±543' N.
- 11. Canals are ±397' W, and ±513' E.
- 12. Ponds are ±489' SE, and ±663' SE.
- 13. Water Well (Permit #261559) is ±830' NW.
- 14. Water Well (Permit #231594) is ±961' NW.
- 15. Water Well (Permit #146340) is ±1205' N.
- 16. 1000' Radius.

Legend	<ul style="list-style-type: none"> Disturbance Area 1000' Radius Canal Ditch ● Proposed Well Pond ⊙ Water Well 	Reference Location
		<p>** All measurements are made from Reference Well HOLTON I-12HN **</p> <p>Lat: 40.506225° Long: -104.608292° (NAD83) Elevation: 4718 Feet</p>

PFS Petroleum Field Services *Use our resources to find yours!*
www.petro-fs.com
(303) 928-7128

Field Date: 1/29/2013
 Drafting Date: 4/17/2014
 Drafted by: CSG
 Checked by: MLP
 Revision: 1

Data Sources:
 - Topo courtesy USGS
 - Water features courtesy of NHD

Prepared for:
BAYSWATER
 EXPLORATION AND PRODUCTION, LLC