

**ConocoPhillips Company**  
**STATE LA PLATA-1H**  
 LOCATED IN ARAPAHOE COUNTY, COLORADO  
 SECTION 13, T5S, R65W, 6th P.M.

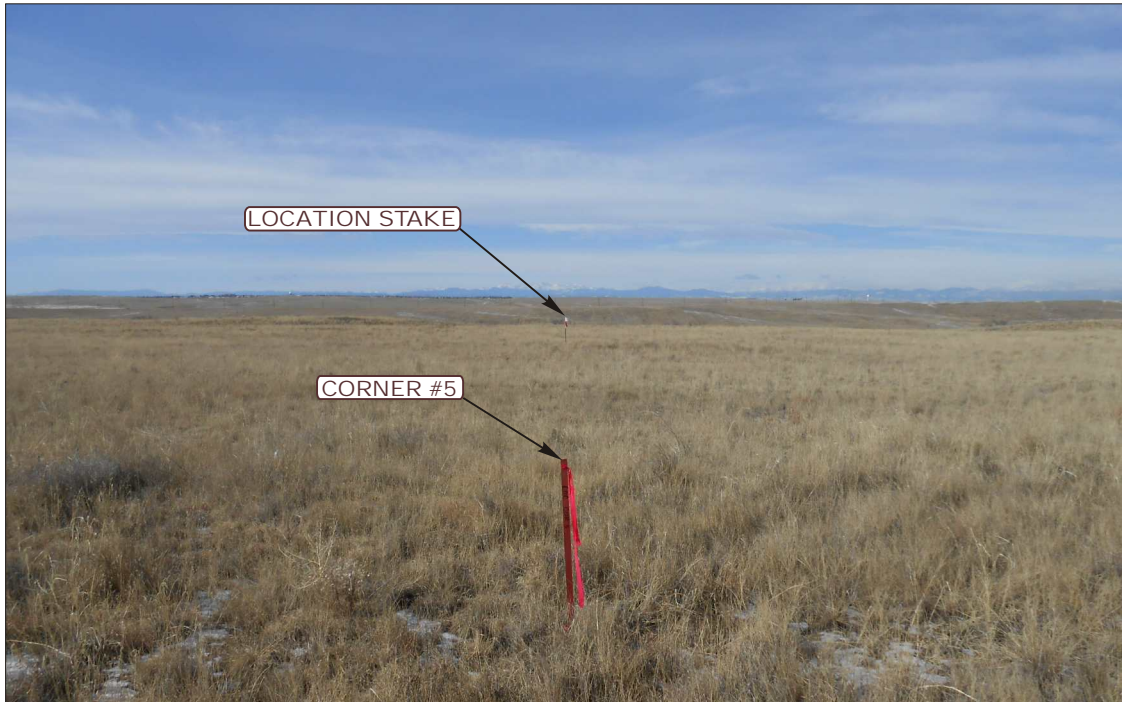

**PHOTO: VIEW FROM CORNER #5 TO LOCATION STAKE**

**CAMERA ANGLE: WESTERLY**



**PHOTO: VIEW FROM BEGINNING OF PROPOSED ACCESS**

**CAMERA ANGLE: SOUTHWESTERLY**



- Since 1964 -

**U**  
**E**  
**S**  
 Uintah Engineering & Land Surveying  
 85 South 200 East Vernal, Utah 84078  
 (435) 789-1017 \* FAX (435) 789-1813

<b>LOCATION PHOTOS</b>	<b>02</b>	<b>04</b>	<b>14</b>	<b>PHOTO</b> <b>P1</b>
	MONTH	DAY	YEAR	
TAKEN BY: D.N.	DRAWN BY: T.W.	REVISED: 00-00-00		

**ConocoPhillips Company**  
**STATE LA PLATA-1H**  
 LOCATED IN ARAPAHOE COUNTY, COLORADO  
 SECTION 13, T5S, R65W, 6th P.M.



PHOTO: VIEW OF LOCATION STAKE

CAMERA ANGLE: NORTHERLY



PHOTO: VIEW OF LOCATION STAKE

CAMERA ANGLE: EASTERLY



- Since 1964 -

**UELS** Uintah Engineering & Land Surveying  
 85 South 200 East Vernal, Utah 84078  
 (435) 789-1017 \* FAX (435) 789-1813

<b>LOCATION PHOTOS</b>	<b>02</b>	<b>04</b>	<b>14</b>	<b>PHOTO P2</b>
	MONTH	DAY	YEAR	
TAKEN BY: D.N.	DRAWN BY: T.W.	REVISED: 00-00-00		

**ConocoPhillips Company**  
**STATE LA PLATA-1H**  
 LOCATED IN ARAPAHOE COUNTY, COLORADO  
 SECTION 13, T5S, R65W, 6th P.M.



**PHOTO: VIEW OF LOCATION STAKE**

**CAMERA ANGLE: SOUTHERLY**



**PHOTO: VIEW OF LOCATION STAKE**

**CAMERA ANGLE: WESTERLY**



- Since 1964 -

**U**  
**E**  
**S** Uintah Engineering & Land Surveying  
 85 South 200 East Vernal, Utah 84078  
 (435) 789-1017 \* FAX (435) 789-1813

<b>LOCATION PHOTOS</b>	<b>02</b> MONTH	<b>04</b> DAY	<b>14</b> YEAR	<b>PHOTO</b>
<b>TAKEN BY: D.N.</b>	<b>DRAWN BY: T.W.</b>	<b>REVISED: 00-00-00</b>	<b>P3</b>	