

LEGEND:

PROPOSED LOCATION



ConocoPhillips Company

STATE LA PLATA-1H
SECTION 13, T5S, R65W, 6th P.M.
1320' FSL 1840' FWL



Utah Engineering & Land Surveying
 85 South 200 East Vernal, Utah 84078
 (435) 789-1017 * FAX (435) 789-1813

ACCESS ROAD
MAP

02 **04** **14**
 MONTH DAY YEAR

SCALE: 1:100,000 DRAWN BY: T.W. REVISED: 00-00-00



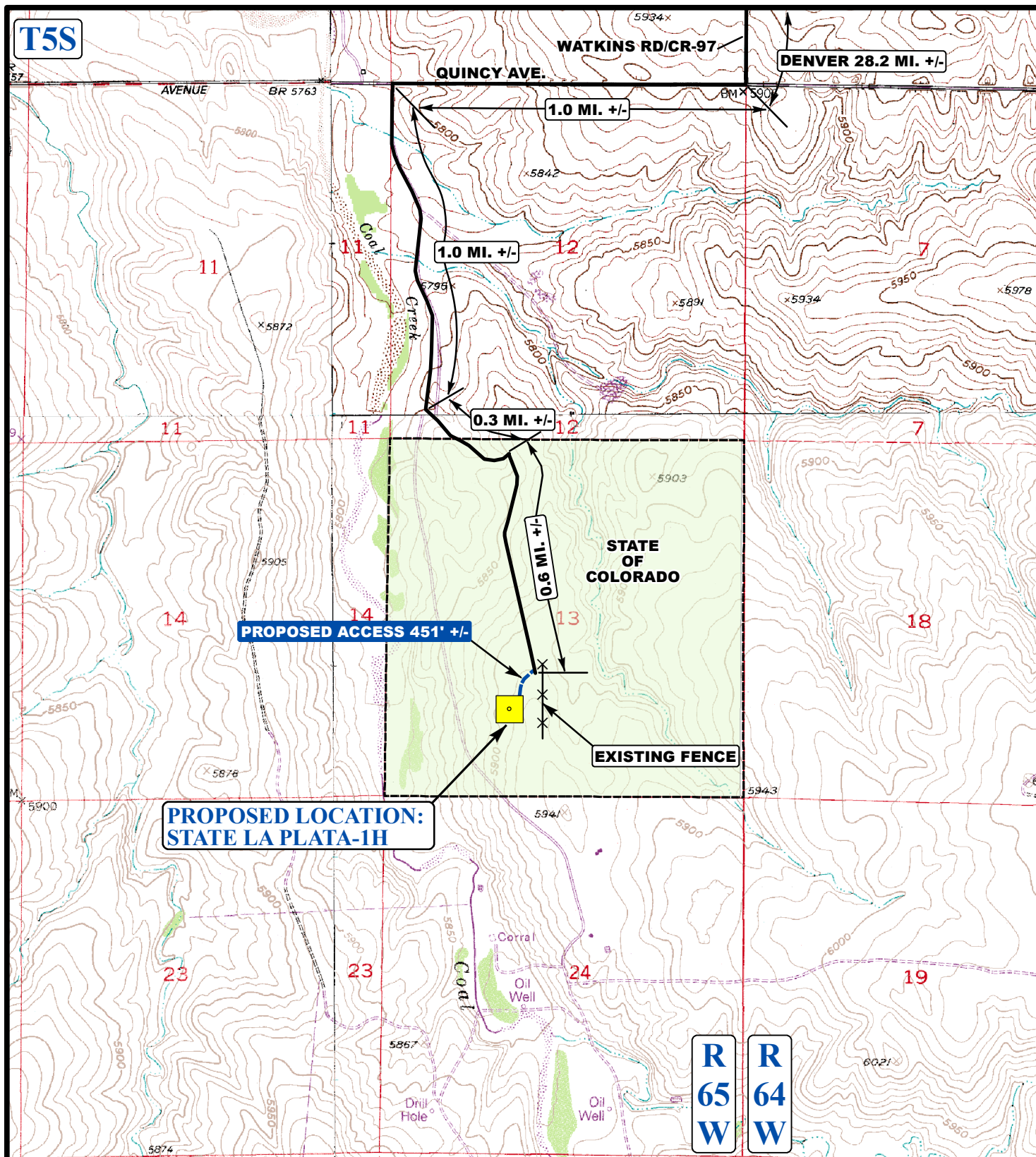

————— EXISTING ROADS
 - - - - - PROPOSED ACCESS ROAD
 x x x EXISTING FENCE



ConocoPhillips Company

STATE LA PLATA-1H
 SECTION 13, T5S, R65W, 6th P.M.
 1320' FSL 1840' FWL

ACCESS ROAD
MAP

02 04 14
 MONTH DAY YEAR

SCALE: 1"=2000' DRAWN BY: T.W. REVISED: 00-00-00

B
 TOPO

UEIS

Uintah Engineering & Land Surveying
 85 South 200 East Vernal, Utah 84078
 (435) 789-1017 * FAX (435) 789-1813