

C:\FES PROJECTS\1319-01_BONANZA\5N-61W\dwg\5N-61W LAYOUT.dwg SAVED DATE 2014-04-21 21:08

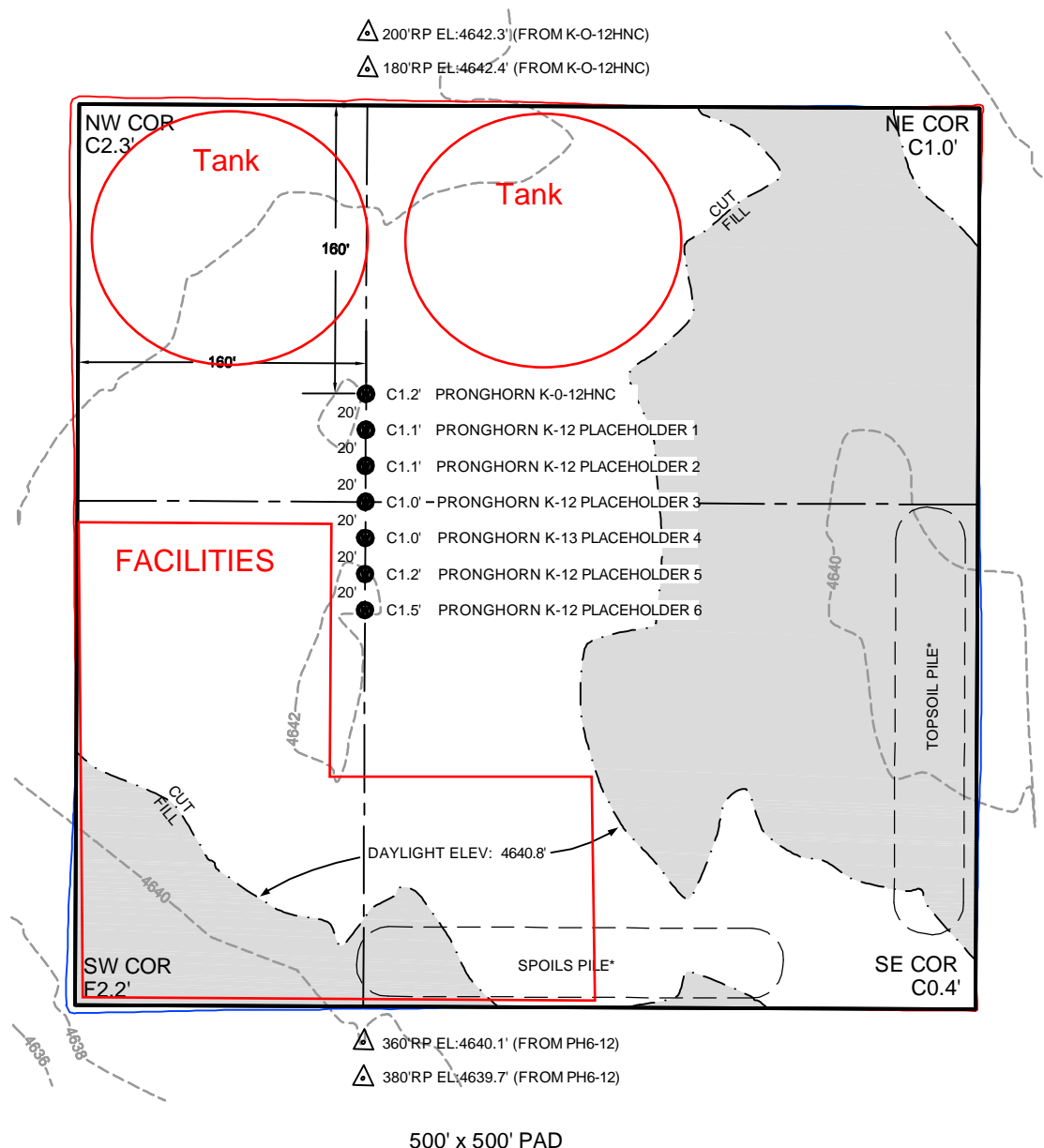

DESIGN INFORMATION & EARTH VOLUMES

EXISTING GRADE @ CENTER LOCATION = 4,642.0' (K-O-12HNC)

FINISHED GRADE ELEVATION = 4,640.8'

CUT SLOPES = 2:1

FILL SLOPES = 2:1

TOTAL CUT FOR WELL PAD = 4,267 C.Y.

TOTAL FILL FOR WELL PAD = 1,662 C.Y.

TOPSOIL @ 6" DEPTH (ESTIMATED)= 2,000 C.Y.

SHRINKAGE (10%) = 227 C.Y.

EXCESS MATERIAL = 378 C.Y.

* CONTRACTOR SHALL PLACE TOPSOIL & SPOILS PILES ON PAD AT

OWNERS DISCRETION

CONTOUR INTERVAL = 2'

SHEET NO:

1 of 1

Fremont
ENGINEERING & SURVEYING
64 COAL MINE RD.
LANDER, WY 82520
307-349-0840
fes@wyoming.com

Drawn By: DAF
Checked By: DDF
Date: 4/19/14
Revision:
Date:
Explanation:

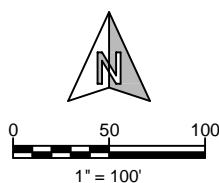

PAD CUT/FILL LAYOUT

PRONGHORN K-12 PAD
NW $\frac{1}{4}$ NE $\frac{1}{4}$, SECTION 12,
T.5N., R.61W., 6th PM
WELD COUNTY, COLORADO

BONANZA CREEK

410 17th Street
Denver, CO 80202
(720) 440-6100