

Section 28
T. 6 S., R. 96 W.

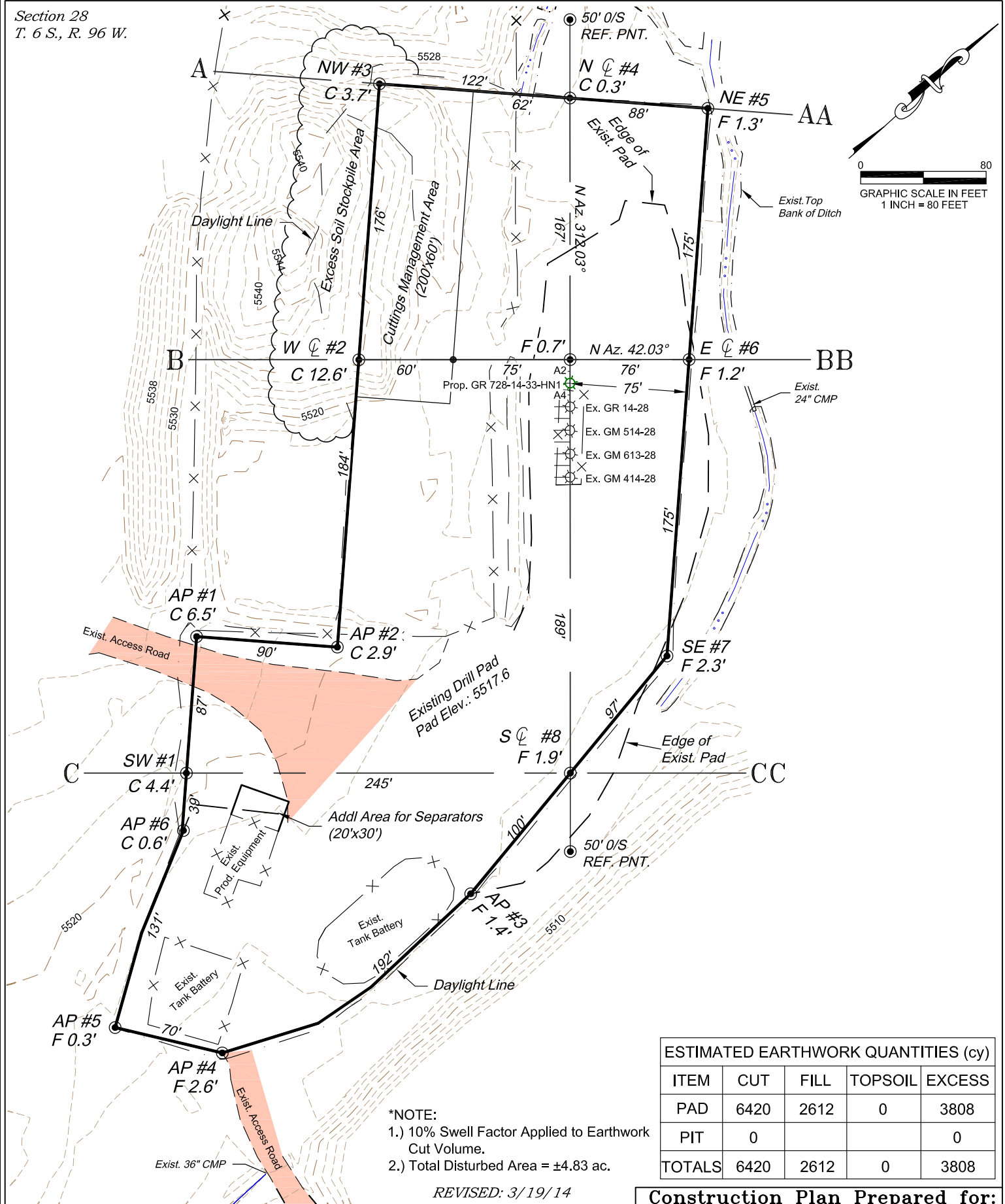

*NOTE:
1.) 10% Swell Factor Applied to Earthwork Cut Volume.
2.) Total Disturbed Area = ±4.83 ac.

REVISED: 3/19/14

ESTIMATED EARTHWORK QUANTITIES (cy)				
ITEM	CUT	FILL	TOPSOIL	EXCESS
PAD	6420	2612	0	3808
PIT	0			0
TOTALS	6420	2612	0	3808

Construction Plan Prepared for:
WPXENERGY WPX Energy Rocky Mountain, LLC

GR 14-28 Drill Pad - Plat 2
CONSTRUCTION LAYOUT

136 East Third Street
Rifle, Colorado 81650
Ph. (970) 625-2720
Fax (970) 625-2773



BOOKCLIFF
Survey Services, Inc.

SCALE: 1" = 80'
DATE: 3/6/14
PLAT: 2 of 7
PROJECT: Valley
DFT: cs

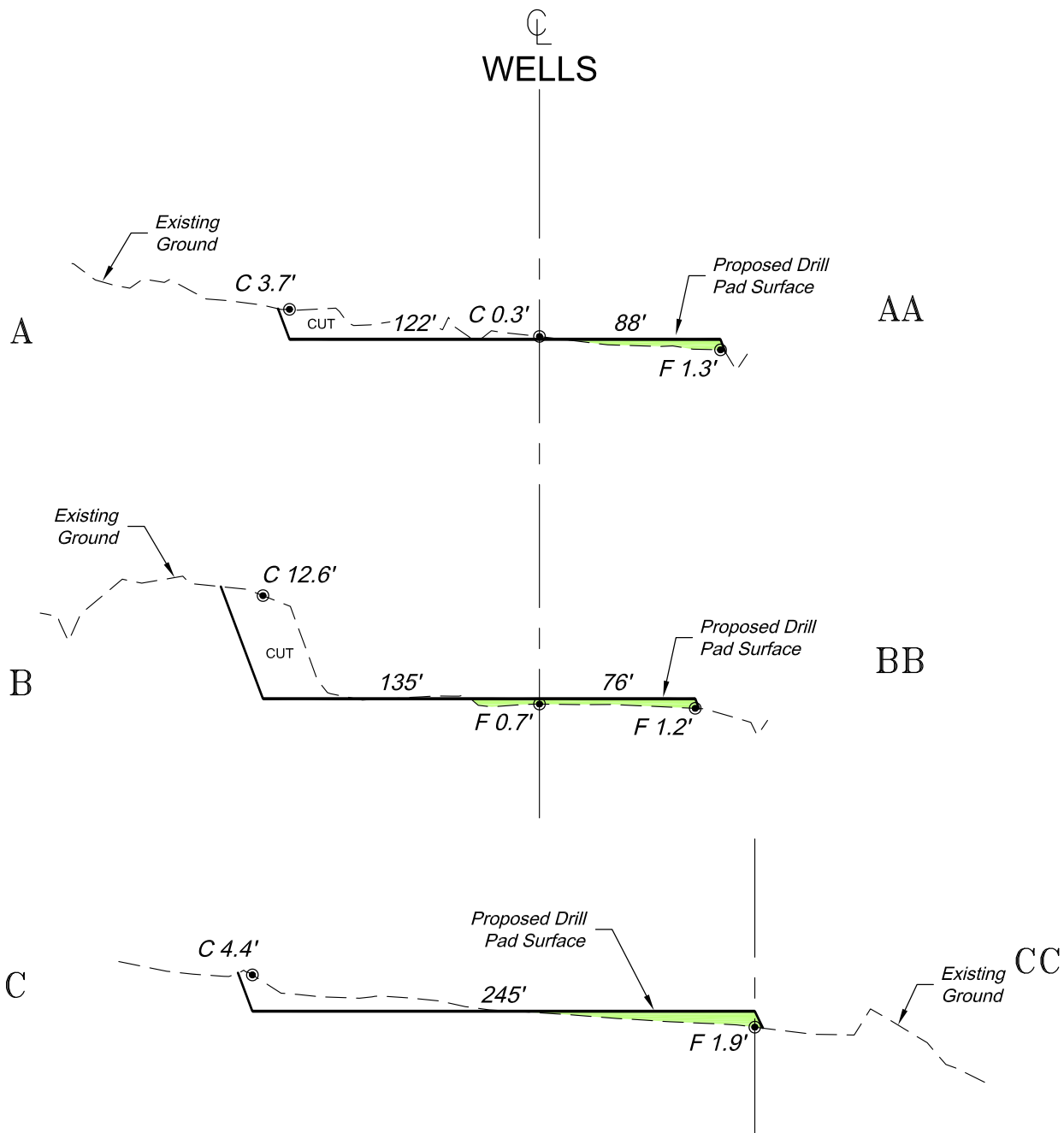

SCALE: Horiz.: 1" = 80'
Vert. : 1" = 20'

***NOTE:**
CUT SLOPES: 1.5:1
FILL SLOPES: 1.5:1,
UNLESS OTHERWISE NOTED.

136 East Third Street
Rifle, Colorado 81650
Ph. (970) 625-2720
Fax (970) 625-2773



SCALE: As Noted
DATE: 3/6/14
PLAT: 3 of 7
PROJECT: Valley
DFT: cs

Construction Plan Prepared for:
WPXENERGY WPX Energy Rocky Mountain, LLC

*GR 14-28 Drill Pad - Plat 3
CONSTRUCTION LAYOUT
CROSS SECTIONS*