



Lat40°, Inc. 1635 Foxtrail Drive, Suite 325 Loveland, CO 970-776-3321

HYDROLOGY MAP

FIVE RIVERS K09-62-1HN PAD

SECTION: 8
TOWNSHIP: 4N
RANGE: 66W

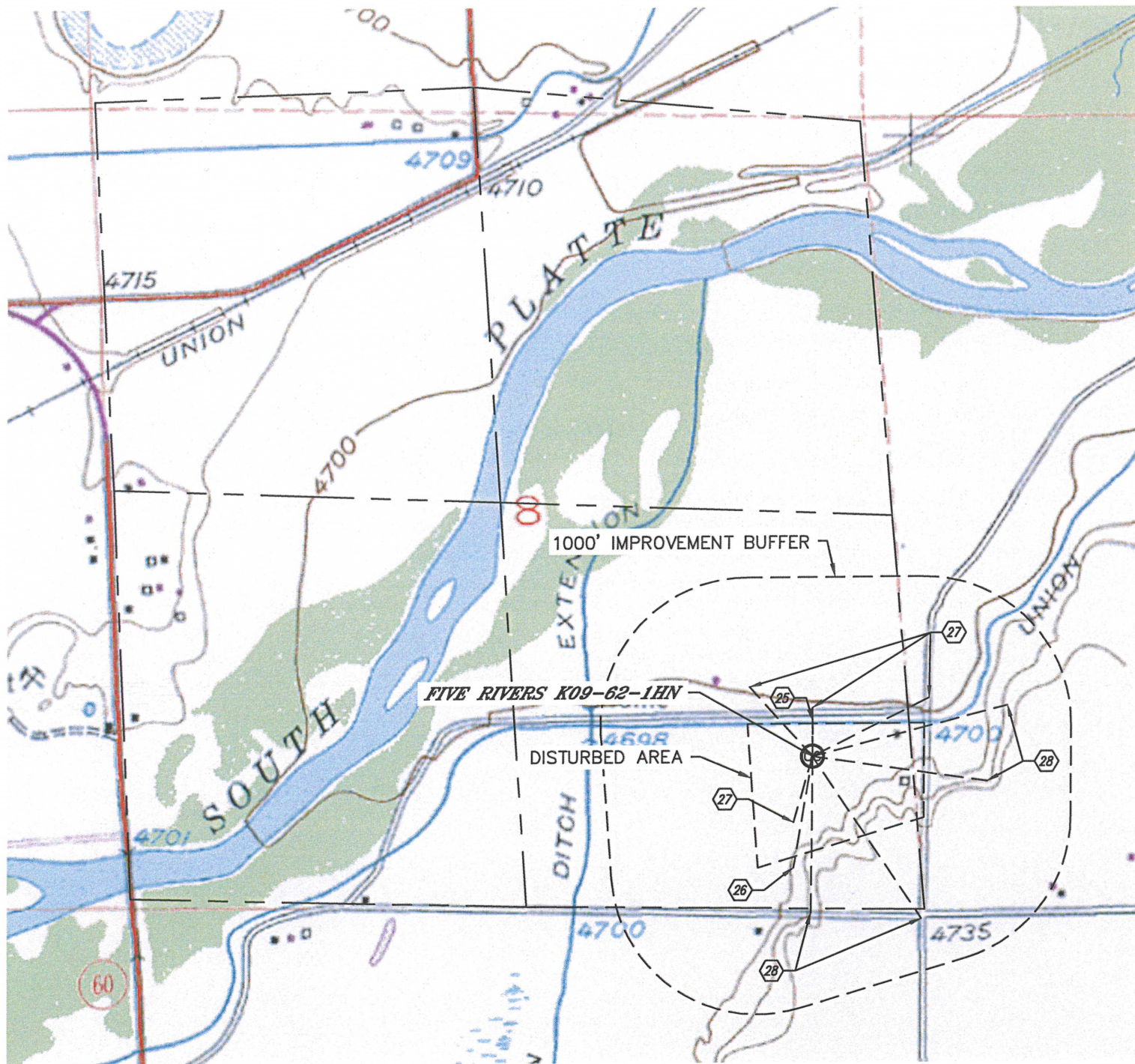

- 25 CANAL 243' N
- 26 POND 766' SW
- 27 DITCH 329' N, 465' SW, 640' NW, 890' NE
- 28 BARROW DITCH 1062' S, 1201' & 1331' SE, 1372' NE

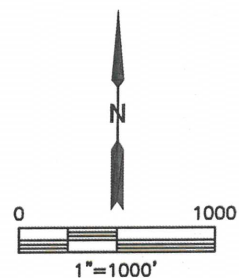

DATE: 11/7/2013
PROJECT#: 2013063