

FORM 19
Rev 6/99

**State of Colorado
Oil and Gas Conservation Commission**

1120 Lincoln Street, Suite 801, Denver, Colorado 80203 Phone: (303)894-2100 Fax:(303)894-2109



FOR OGCC USE ONLY

RECEIVED
4/11/2014

SPILL/RELEASE REPORT

This form is to be submitted by the party responsible for the oil and gas spill or release. Any spill or release which may impact waters of the State must be reported as soon as practicable; any spill over 20 bbls must be reported within 24 hours and all spills over five bbls must be reported within ten days. Submit a Site Investigation and Remediation Workplan (Form 27) when requested by the Director.

Spill report taken by:

FACILITY ID:

OPERATOR INFORMATION

Name of Operator: <u>WPX Energy Rocky Mountain, LLC</u>	OGCC Operator No: <u>96850</u>	Phone Numbers
Address: <u>1058 County Road 215</u>	City: <u>Parachute</u> State: <u>CO</u> Zip: <u>81635</u>	No: <u>970-683-2295</u>
Contact Person: <u>Karolina Blaney</u>		Fax: <u>970-285-9573</u>
		Email: <u>Karolina.Blaney@wpxenergy.com</u>

DESCRIPTION OF SPILL OR RELEASE

Date of Incident: <u>04/02/2014</u>	Facility Name & No: <u>Clough 911-28D Injection Well (COGCC # 159447)</u>	County: <u>Garfield</u>
Type of Facility (well, tank battery, flow line, pit): <u>UIC Injection Well</u>	Well Name and Number: <u>Clough RWF 911-28D</u>	QtrQtr: <u>SESW</u> Section: <u>21</u>
API Number: <u>05-045-22176</u>		Township: <u>6S</u> Range: <u>94W</u>
Specify volume spilled and recovered (in bbls) for the following materials:		Meridian: <u>6th</u>
Oil spilled: _____ Oil recov'd: _____	Water spilled: <u>~1.3</u>	Water recov'd: <u>~0.75</u> Other spilled: _____ Other recov'd: _____
Ground Water impacted? <input type="checkbox"/> Yes <input checked="" type="checkbox"/> No	Surface Water impacted? <input type="checkbox"/> Yes <input checked="" type="checkbox"/> No	
Contained within berm? <input type="checkbox"/> Yes <input checked="" type="checkbox"/> No	Area and vertical extent of spill: _____ working area - 724 sq feet	
Current land use: <u>Non-irrigated cropland</u>	Weather conditions: <u>Partly cloudy, showers, moist soil conditions</u>	
Soil/geology description: <u>Nihill channery loam - Channery to very channery stratified extremely channery sandy loam to extremely channery loam</u>		
IF LESS THAN A MILE , report distance IN FEET to nearest ... Surface water: <u>~1,240 feet</u> wetlands: <u>None</u> buildings: <u>~4,712 feet</u>		
Livestock: <u>None</u> Water wells: <u>~2,985 feet</u> Depth to shallowest ground water: <u>~87 feet</u>		
Cause of spill (e.g. equipment failure, human error, etc.): <u>Citizen Complaint</u> Detailed description of the spill/release incident:		
As requested by COGCC, the purpose of this Form 19 is to close a citizen complaint (Document #200401047) that was reported to COGCC on 4/3/14. The complaint stated that a workover rig was spraying fluids on the ground, a tank got overfilled, and liquids were being emitted from the well head area on the Clough 2A well pad. On 4/2/2014 WPX was conducting workover operations on the Clough RWF 911-28D injection well; tubing with a plug in the end was being snubbed out of the hole. Pressure built up in the tubing and caused deminimis amount of treated water to be discharged out of the top end of the tubing. In addition, five wet joints of tubing were pulled out of the well which allowed some additional treated water to flow out onto the ground in the immediate vicinity of the well head. This was a routine workover operation therefore WPX already had a vac truck on location to immediately recover any treated water from the ground.		

CORRECTIVE ACTION

Describe immediate response (how stopped, contained and recovered): <u>After the pressure was relieved in the tubing, a vac truck already on-site was able to recover the treated water around the well head.</u>
Describe any emergency pits constructed: <u>None were constructed.</u>
How was the extent of contamination determined? <u>By field measurements and mapping with a Trimble GPS unit.</u>
Further remediation activities proposed (attach separate sheet if needed): <u>None are currently planned. The COGCC visited the site on April 4, 2014 and met with WPX operation engineers and the tool pusher in charge of the work over rig. The suspected overfilling tank was inspected and it was determined there was no overflow. The release of pressure from the well to the tank causes the release of some vapors and that may have been the cause for the citizen to think the tank was overflowing. The area around the well head was moist but it was determined that the moisture was the result of recent precipitation the day before the inspection. COGCC inspected the site on multiple occasions in response to the citizen complaint and found no evidence of a spill, and recommended that the complaint be closed.</u>
Describe measures taken to prevent problem from reoccurring: <u>None are currently planned. Since this was a routine operation, any water generated during snubbing operations or when pulling wet strings is either captured in a drip pan or is immediately recovered with a vac truck.</u>

OTHER NOTIFICATIONS

List the parties and agencies notified (County, BLM, EPA, DOT, Local Emergency Planning Coordinator or other).

Date	Agency	Contact	Phone	Response
04/04/2014	COGCC	Stan Spencer	970-625-2497	Site Inspection
04/04/2014	County	Kirby Wynn	970-625-5905	Courtesy notification

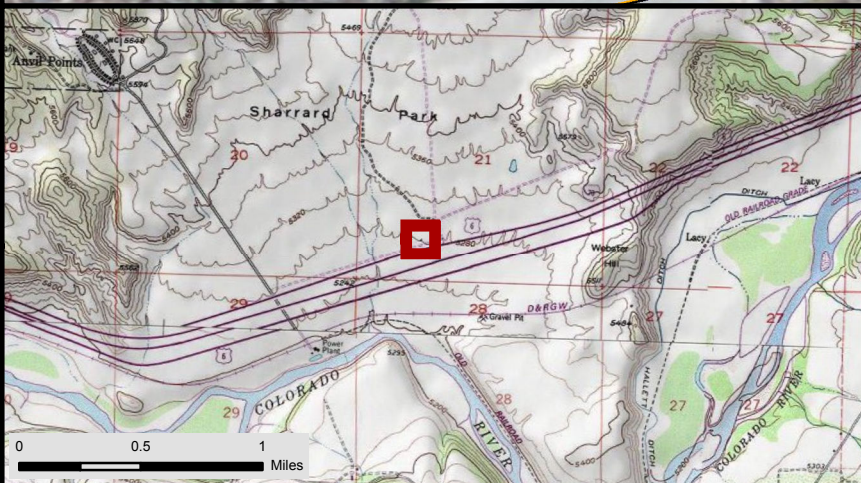
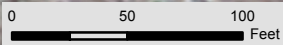

WPXENERGY Form 19 Map

Clough 2-A

39.505663 -107.897707
 Section 21, Township 6 South, Range 94 West

	Transportation	Hydrography
Working Area	CO Highways	Ditch
PLSS	County Roads	Intermittent Stream
Township	Local Streets	Perennial Stream
Section	WPX Access	Waterbody
		Watershed

HCSI
 ENVIRONMENTAL CONSULTANTS
 H.C. COMPLIANCE SOLUTIONS, INC.

Author: B. Hall
Revision: 1
Date: 4/10/2014