

# WHITING OIL & GAS CORP.

## LOCATION DRAWING FOR

RAZOR 33 PRODUCTION FACILITY PAD

SECTION 33, T10N, R58W, 6th P.M.

395' FSL 2541' FWL

SCALE: 1" = 300'

DATE SURVEYED: 03-25-14

SURVEYED BY: DALLAS NIELSEN

DATE DRAWN: 03-26-14

DRAWN BY: J.S.

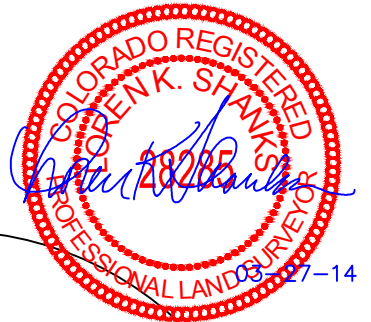
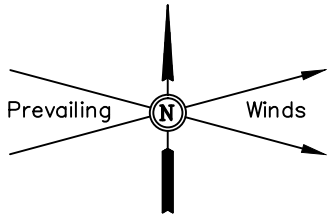

LINE TABLE		
LINE	DIRECTION	LENGTH
L1	SOUTH	97'
L2	SOUTH	48'
L3	SOUTH	34'
L4	SOUTH	433'
L5	SOUTH	384'
L6	SOUTH	369'
L7	S10°E	401'
L8	S01°E	68'
L9	S56°E	277'
L10	S75°E	259'
L11	S87°E	315'
L12	S87°E	295'
L13	NORTH	574'
L14	NORTH	190'

500' Offset  
from Edge of  
Disturbance

**PROPOSED RAZOR 33  
PRODUCTION FACILITY PAD**  
(Center of Pad)  
(NAD 83)  
Lat: 40.788736°  
Long: 103.870114°

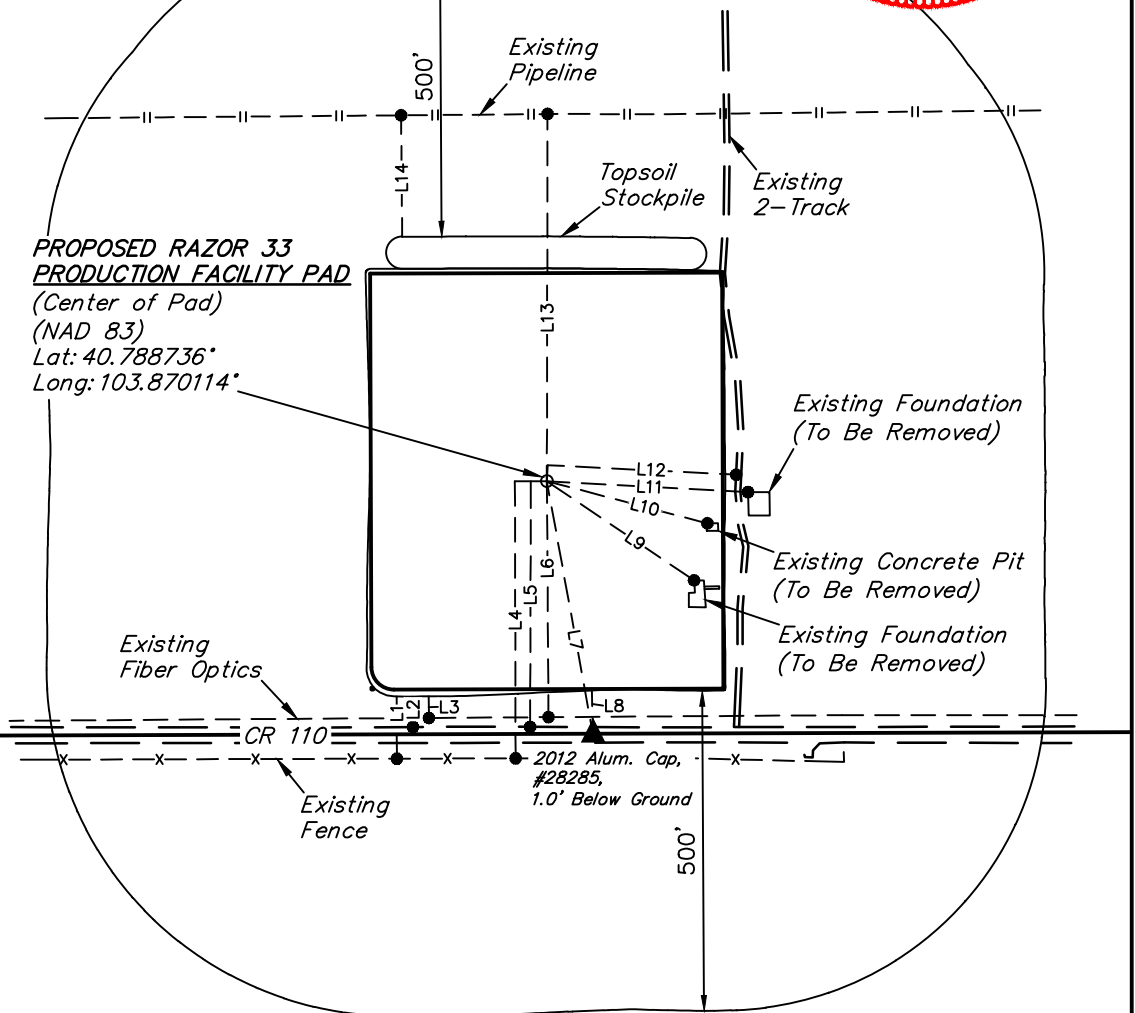

SECTION 33, T10N

SECTION 4, T9N

UINTAH ENGINEERING & LAND SURVEYING

85 So. 200 East \* Vernal, Utah 84078 \* (435) 789-1017