

GREAT WESTERN OIL & GAS COMPANY
CONSTRUCTION LAYOUT FOR
ROCK FAMILY LE 13-021HN, 13-4HN, 13-4HC,
13-29HN, 13-3HN, 13-3HC & 13-28HN-1
SECTION 24, T1S, R66W, 6th. P.M.
S 1/2 NW 1/4

FIGURE #1

SCALE: 1" = 100'
DATE: 09-10-12
DRAWN BY: J.W.
REV: 12-11-13 H.K.W.
REV: 02-20-14 J.W.

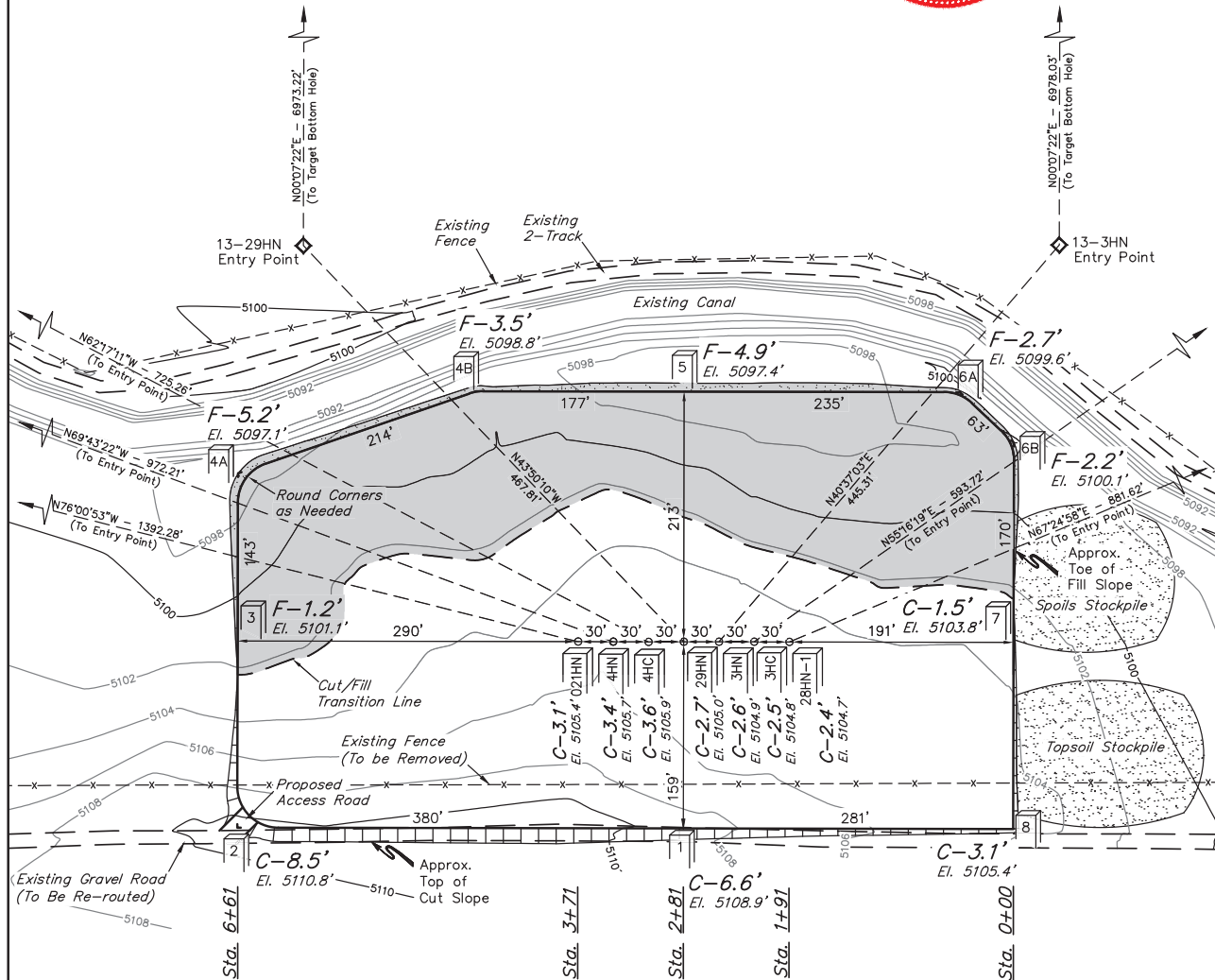

Elev. Ungraded Ground At 13-29HN Loc. Stake = 5105.7'
FINISHED GRADE ELEV. AT 13-29HN LOC. STAKE = 5102.3

UINTAH ENGINEERING & LAND SURVEYING
85 So. 200 East • Vernal, Utah 84078 • (435) 789-1017

1" = 40'
X-Section
Scale
1" = 100'
DATE: 09-10-12
DRAWN BY: J.W.
REV: 12-11-13 H.K.W.
REV: 02-20-14 J.W.

GREAT WESTERN OIL & GAS COMPANY
CONSTRUCTION LAYOUT CROSS SECTIONS FOR
ROCK FAMILY LE 13-021HN, 13-4HN, 13-4HC,
13-29HN, 13-3HN, 13-3HC & 13-28HN-1
SECTION 24, T1S, R66W, 6th. P.M.
S 1/2 NW 1/4

FIGURE #2

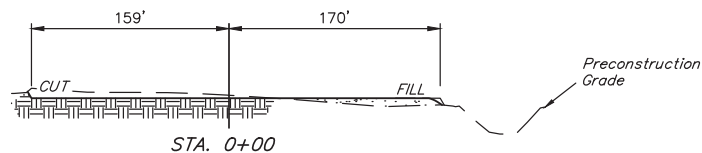
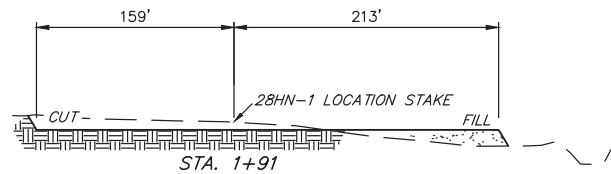
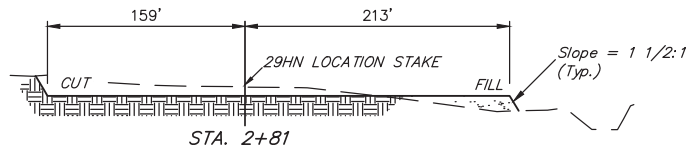
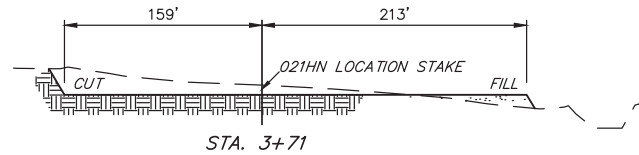
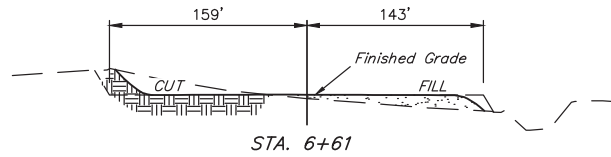

NOTE:
Topsoil should not be
Stripped Below Finished
Grade on Substructure Area.

* NOTE:
FILL QUANTITY INCLUDES
5% FOR COMPACTION

APPROXIMATE YARDAGES

(6") Topsoil Stripping = 4,640 Cu. Yds.
Remaining Location = 14,450 Cu. Yds.
TOTAL CUT = 19,090 CU. YDS.
FILL = 10,660 CU. YDS.

EXCESS MATERIAL = 8,430 Cu. Yds.
Topsoil = 4,640 Cu. Yds.
EXCESS UNBALANCE = 3,790 Cu. Yds.
(After Interim Rehabilitation)

APPROXIMATE ACREAGE
WELL SITE DISTURBANCE = ± 6.495 ACRES
ACCESS ROAD DISTURBANCE = ± 0.002 ACRES
TOTAL = ± 6.497 ACRES

UINTAH ENGINEERING & LAND SURVEYING
85 So. 200 East * Vernal, Utah 84078 * (435) 789-1017