

NW. COR.  
SEC. 34, T2N, R67W  
FOUND 2 1/2" ALUM. CAP  
L.S. NO. 34980

T2N, R67W

NE. COR.  
SEC. 34, T2N, R67W  
FOUND 3 1/4" ALUM. CAP  
L.S. NO. 13258

S 89°33'17" W  
1267.78' (M)

S 89°32'37" W  
1305.08' (M)

S 89°33'01" W 2624.61' (M)

W. 1/16 COR.  
SEC. 34 AND SEC. 27  
T2N, R67W  
FOUND 2" ALUM. CAP  
L.S. NO. 25937

N. 1/4 COR.  
SEC. 34, T2N, R67W  
FOUND 3 1/4" ALUM. CAP  
L.S. NO. 25937

BOTTOM OF HOLE:  
50' FNL & 290' FEL

N 00°56'49" E 2643.26' (M)

N 00°22'18" W  
2645.13' (C)

W. 1/4 COR.  
SEC. 34, T2N, R67W  
FOUND 3 1/4" ALUM. CAP  
L.S. NO. 12330

S 89°36'26" W  
2633.68' (C)

S 89°36'27" W  
2629.26' (C)

**SURFACE LOCATION**  
GROUND ELEVATION= 4949.2'  
NAD 83  
LATITUDE= 40.088654°  
LONGITUDE= -104.872765°

LATITUDE= 40°05'19.153"  
LONGITUDE= -104°52'21.953"

**BOTTOM HOLE LOCATION**  
NAD 83  
LATITUDE= 40.101904°  
LONGITUDE= -104.868730°

LATITUDE= 40°06'06.856"  
LONGITUDE= -104°52'07.427"

SW. COR.  
SEC. 34, T2N, R67W  
FOUND 2" ALUM. CAP  
L.S. NO. 25937

N 00°33'12" W 2642.42' (M)

34

N 00°22'18" W  
2645.18' (C)

**SICKLER 26C-34HZ**  
SURFACE LOCATION

S. 1/4 COR.  
SEC. 34, T2N, R67W  
FOUND 3 1/4" ALUM. CAP  
L.S. NO. 13258

S 89°40'03" W 2625.30' (M)

S 89°40'00" W 2634.19' (M)

E. 1/4 COR.  
SEC. 34, T2N, R67W  
FOUND 2" ALUM. CAP  
L.S. NO. 25937

N 00°28'21" W 2647.75' (M)

SE. COR.  
SEC. 34, T2N, R67W  
FOUND 2 1/2" ALUM. CAP  
L.S. NO. 24657

### CERTIFICATE OF SURVEYOR:

THIS IS TO CERTIFY THAT THE ABOVE PLAT WAS PREPARED FROM FIELD NOTES OF ACTUAL SURVEY MADE BY ME OR UNDER MY SUPERVISION AND THAT THE SAME ARE TRUE AND CORRECT TO THE BEST OF MY KNOWLEDGE AND BELIEF. THIS CERTIFICATE DOES NOT REPRESENT A LAND SURVEY PLAT OR IMPROVEMENT SURVEY PLAT AS DEFINED BY C.S. 38-51-102 AND CANNOT BE RELIED UPON TO DETERMINE OWNERSHIP.

*Benjamin J. Reenders*  
BENJAMIN J. REENDERS  
PROFESSIONAL LAND SURVEYOR  
COLORADO REGISTRATION NUMBER 48306  
12/10/13

NOTICE:  
ACCORDING TO COLORADO STATE LAW YOU MUST COMMENCE ANY LEGAL ACTION BASED UPON ANY DEFECT IN THIS SURVEY WITHIN THREE YEARS AFTER YOU FIRST DISCOVER SUCH DEFECT. IN NO EVENT MAY ANY ACTION BASED UPON ANY DEFECT IN THIS SURVEY BE COMMENCED MORE THAN TEN YEARS FROM THE DATE ON THE CERTIFICATION SHOWN HEREON.

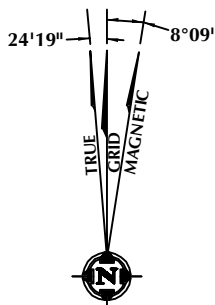

NOTE:  
MAGNETIC NORTH IS CURRENT AS OF 12/8/2013.  
MAGNETIC NORTH CHANGES WEST 0°08' PER YEAR.

### NOTES:

- ▲ INDICATES FOUND SECTION CORNER
- INDICATES CALCULATED CORNER
- ELEVATION BASED ON NAVD88 (GEOID09)
- BASIS OF BEARING DERIVED FROM COLORADO COORDINATE SYSTEM 1983 NORTH ZONE UNLESS OTHERWISE NOTED.
- ALL MEASURED DISTANCES ARE GRID.  
COMBINED SCALE FACTOR: .99972779
- OPERATOR: ROB WILSON / PDOP = 1.6
- SURFACE USE OF LOCATION IS FLOOD IRRIGATED.
- SEE ADDENDUM TO WELL LOCATION CERTIFICATE FOR EXISTING IMPROVEMENTS WITHIN 500' OF THE WELL PAD.
- WELL FOOTAGES ARE MEASURED AT RIGHT ANGLES TO THE SECTION LINES.
- THE BOTTOM OF HOLE BEARS N12°45'22"E 4957' FROM THE SURFACE LOCATION.

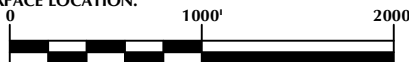

SCALE: 1" = 1000'

### WELL PAD - SICKLER 27N-34HZ

**SICKLER 26C-34HZ**  
**WELL LOCATION CERTIFICATE**  
417' FSL & 1425' FEL SWSE (SURFACE)  
50' FNL & 290' FEL NENE (BOTTOM)  
LOCATED IN SECTION 34  
T2N, R67W, 6TH P.M.  
WELD COUNTY, COLORADO

**Kerr-McGee Oil &  
Gas Onshore L.P.**  
1099 18th Street  
Denver, Colorado 80202



### CONSULTING, LLC

SHERIDAN OFFICE  
2155 North Main Street  
Sheridan, Wyoming 82801  
Phone 307-674-0609

LOVELAND OFFICE  
1635 Foxtrail Drive, Suite 204  
Loveland, Colorado 80538  
Phone 970-776-4331

DRAFTED BY:	LMO	CHECKED BY:	BJR
DATE DRAFTED:	12/10/13	DATE SURVEYED:	11/19/13
REVISED:		FILE NAME:	13-105



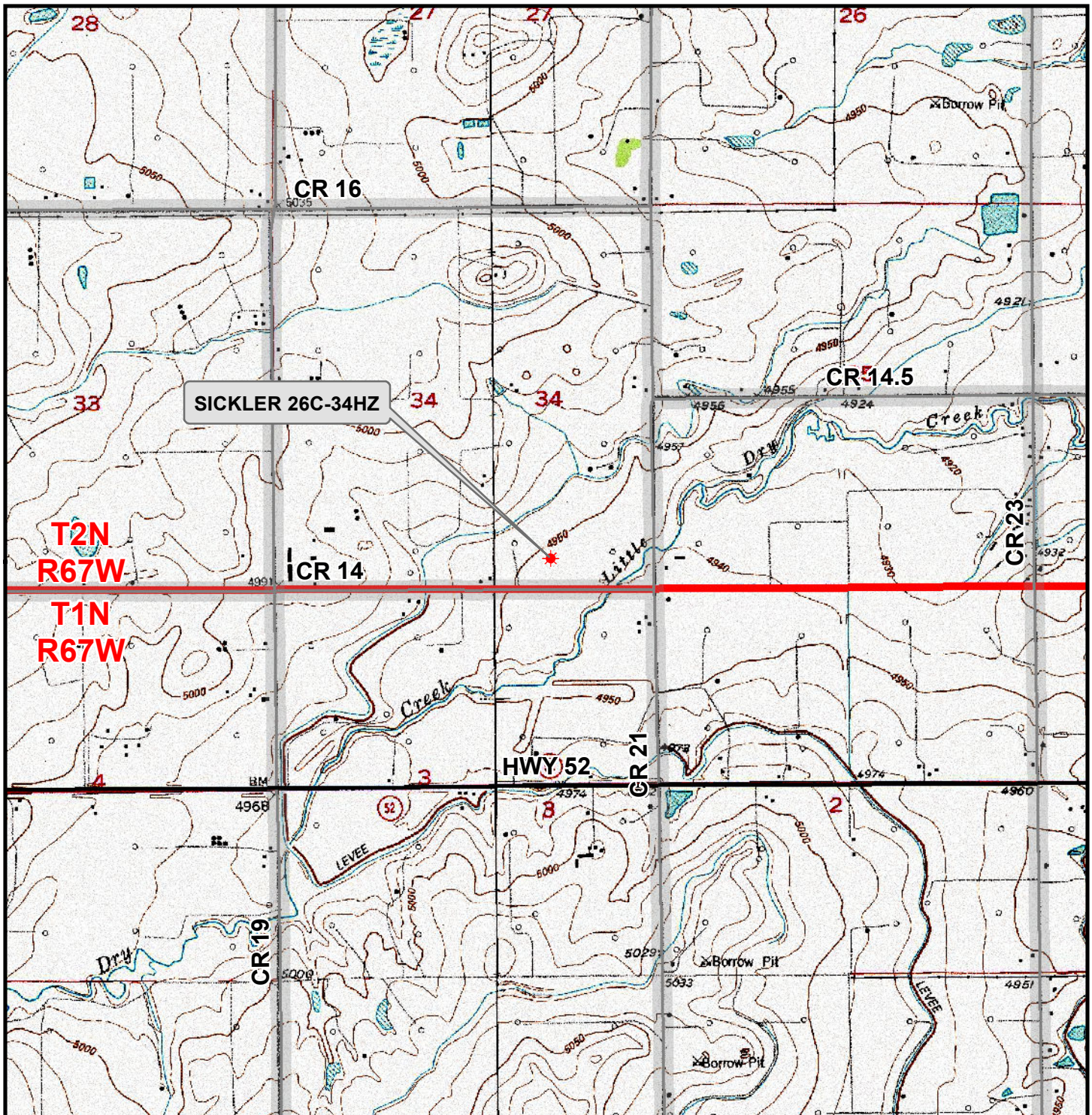

### Legend

- ★ Well - Fee - Proposed   
  Road - Primitive - Existing   
  Road - County - Existing  
 Road - Improved - Existing   
 Road - Highway - Existing

**WELL PAD - SICKLER 27N-34HZ**

**GENERAL LOCATION MAP**  
**SICKLER 26C-34HZ**  
**LOCATED IN SECTION 34**  
**T2N, R67W, 6th P.M.**  
**WELD COUNTY, COLORADO**

**Kerr-McGee Oil &**  
**Gas Onshore L.P.**

1099 18th Street  
 Denver, Colorado 80202



**CONSULTING, LLC**

SHERIDAN OFFICE  
 2155 North Main Street  
 Sheridan, Wyoming 82801  
 Phone 307-674-0609

LOVELAND OFFICE  
 1635 Foxtail Drive, Suite 204  
 Loveland, Colorado 80538  
 Phone 970-776-4331



SCALE: 1" = 2,000ft

NAD83 CO-Nft

DRAWN: JELO

DATE: 10 Dec 2013

REVISED:

DATE: