

NW. COR.
SEC. 34, T2N, R67W
FOUND 2 1/2" ALUM. CAP
L.S. NO. 34980

T2N, R67W

NE. COR.
SEC. 34, T2N, R67W
FOUND 3 1/4" ALUM. CAP
L.S. NO. 13258

S 89°33'17" W
1267.78' (M)

S 89°32'37" W
1305.08' (M)

S 89°33'01" W 2624.61' (M)

W. 1/16 COR.
SEC. 34 AND SEC. 27
T2N, R67W
FOUND 2" ALUM. CAP
L.S. NO. 25937

N. 1/4 COR.
SEC. 34, T2N, R67W
FOUND 3 1/4" ALUM. CAP
L.S. NO. 25937

1965'
652'
660'

BOTTOM OF HOLE:
50' FNL & 660' FEL

N 00°56'49" E 2643.26' (M)

W. 1/4 COR.
SEC. 34, T2N, R67W
FOUND 3 1/4" ALUM. CAP
L.S. NO. 12330

S 89°36'26" W
2633.68' (C)

S 89°36'27" W
2629.26' (C)

34

SURFACE LOCATION
GROUND ELEVATION= 4949.2'
NAD 83
LATITUDE= 40.088604°
LONGITUDE= -104.872851°

LATITUDE= 40°05'18.97"
LONGITUDE= -104°52'22.262"

BOTTOM HOLE LOCATION
NAD 83
LATITUDE= 40.101904°
LONGITUDE= -104.870052°

LATITUDE= 40°06'06.853"
LONGITUDE= -104°52'12.189"

SW. COR.
SEC. 34, T2N, R67W
FOUND 2" ALUM. CAP
L.S. NO. 25937

S. 1/4 COR.
SEC. 34, T2N, R67W
FOUND 3 1/4" ALUM. CAP
L.S. NO. 13258

SICKLER 1N-34HZ
SURFACE LOCATION

E. 1/4 COR.
SEC. 34, T2N, R67W
FOUND 2" ALUM. CAP
L.S. NO. 25937

SE. COR.
SEC. 34, T2N, R67W
FOUND 2 1/2" ALUM. CAP
L.S. NO. 24657

S 89°40'03" W 2625.30' (M)

S 89°40'00" W 2634.19' (M)

NOTES:

- ▲ INDICATES FOUND SECTION CORNER
- INDICATES CALCULATED CORNER
- ELEVATION BASED ON NAVD88 (GEOID09)
- BASIS OF BEARING DERIVED FROM COLORADO COORDINATE SYSTEM 1983 NORTH ZONE UNLESS OTHERWISE NOTED.
- ALL MEASURED DISTANCES ARE GRID.
COMBINED SCALE FACTOR: .99972779
- OPERATOR: ROB WILSON / PDOP = 1.6
- SURFACE USE OF LOCATION IS FLOOD IRRIGATED.
- SEE ADDENDUM TO WELL LOCATION CERTIFICATE FOR EXISTING IMPROVEMENTS WITHIN 500' OF THE WELL PAD.
- WELL FOOTAGES ARE MEASURED AT RIGHT ANGLES TO THE SECTION LINES.
- THE BOTTOM OF HOLE BEARS N08°46'22"E 4907' FROM THE SURFACE LOCATION.

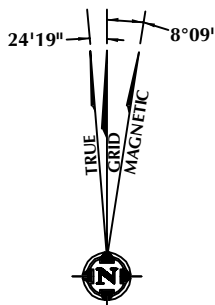

NOTE:
MAGNETIC NORTH IS CURRENT AS OF 12/8/2013.
MAGNETIC NORTH CHANGES WEST 0°08' PER YEAR.

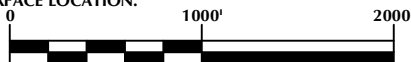

SCALE: 1" = 1000'

CERTIFICATE OF SURVEYOR:

THIS IS TO CERTIFY THAT THE ABOVE PLAT WAS PREPARED FROM FIELD NOTES OF ACTUAL SURVEY MADE BY ME OR UNDER MY SUPERVISION AND THAT THE SAME ARE TRUE AND CORRECT TO THE BEST OF MY KNOWLEDGE AND BELIEF. THIS CERTIFICATE DOES NOT REPRESENT A LAND SURVEY PLAT OR IMPROVEMENT SURVEY PLAT AS DEFINED BY C.S. 38-51-102 AND CANNOT BE RELIED UPON TO DETERMINE OWNERSHIP.

Benjamin J. Reenders
BENJAMIN J. REENDERS
PROFESSIONAL LAND SURVEYOR
COLORADO REGISTRATION NUMBER 48306
12/10/13

NOTICE:
ACCORDING TO COLORADO STATE LAW YOU MUST COMMENCE ANY LEGAL ACTION BASED UPON ANY DEFECT IN THIS SURVEY WITHIN THREE YEARS AFTER YOU FIRST DISCOVER SUCH DEFECT. IN NO EVENT MAY ANY ACTION BASED UPON ANY DEFECT IN THIS SURVEY BE COMMENCED MORE THAN TEN YEARS FROM THE DATE ON THE CERTIFICATION SHOWN HEREON.

WELL PAD - SICKLER 27N-34HZ

SICKLER 1N-34HZ
WELL LOCATION CERTIFICATE
399' FSL & 1449' FEL SWSE (SURFACE)
50' FNL & 660' FEL NENE (BOTTOM)
LOCATED IN SECTION 34
T2N, R67W, 6TH P.M.
WELD COUNTY, COLORADO

Kerr-McGee Oil &
Gas Onshore L.P.
1099 18th Street
Denver, Colorado 80202



CONSULTING, LLC

SHERIDAN OFFICE
2155 North Main Street
Sheridan, Wyoming 82801
Phone 307-674-0609

LOVELAND OFFICE
1635 Foxtrail Drive, Suite 204
Loveland, Colorado 80538
Phone 970-776-4331

DRAFTED BY:	LMO	CHECKED BY:	BJR
DATE DRAFTED:	12/10/13	DATE SURVEYED:	11/19/13
REVISED:		FILE NAME:	13-105

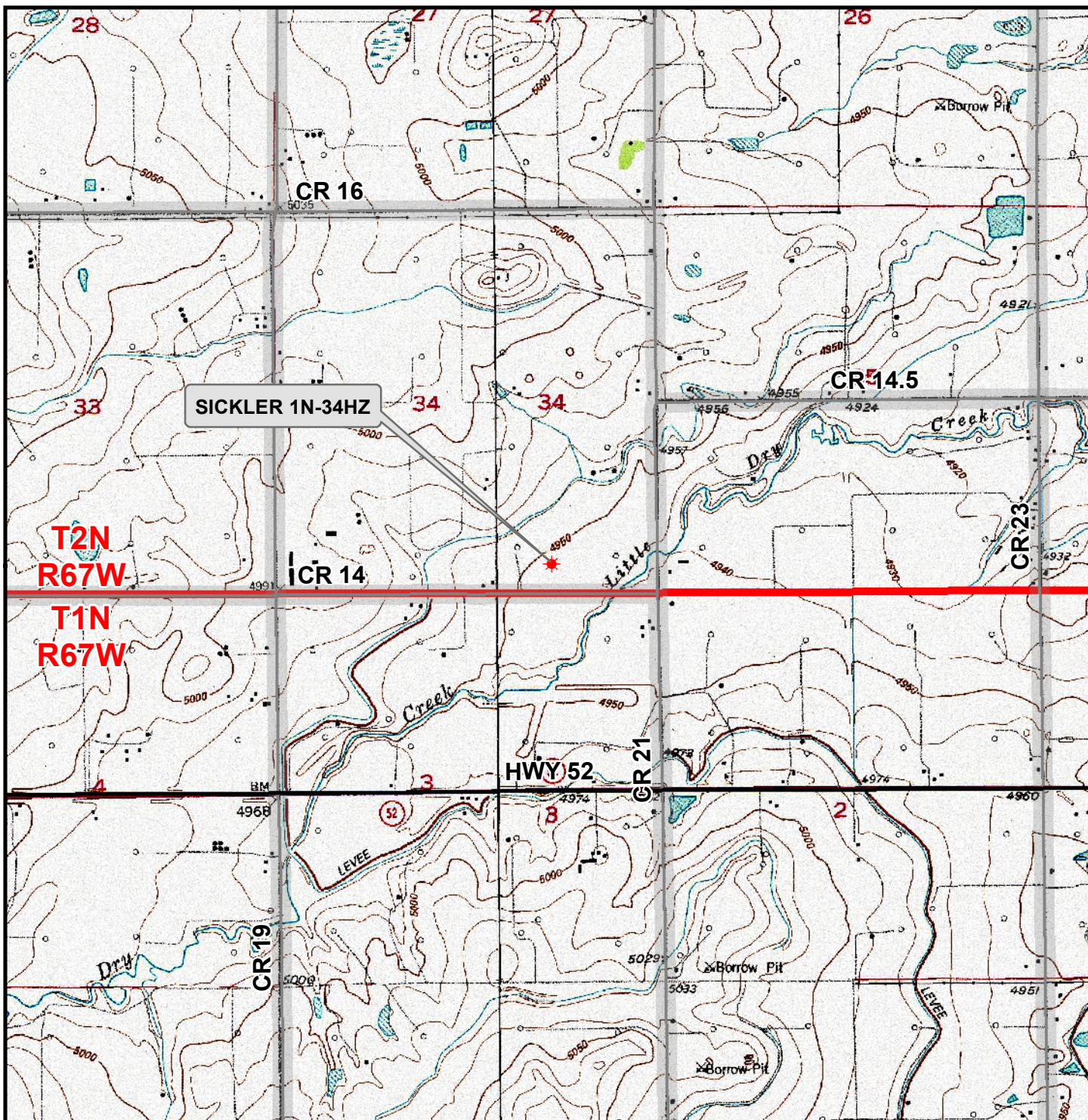

Legend

- * Well - Fee - Proposed === Road - Primitive - Existing — Road - County - Existing
 — Road - Improved - Existing — Road - Highway - Existing

WELL PAD - SICKLER 27N-34HZ

GENERAL LOCATION MAP
 SICKLER 1N-34HZ
 LOCATED IN SECTION 34
 T2N, R67W, 6th P.M.
 WELD COUNTY, COLORADO

**Kerr-McGee Oil &
 Gas Onshore L.P.**

1099 18th Street
 Denver, Colorado 80202



CONSULTING, LLC

SHERIDAN OFFICE
 2155 North Main Street
 Sheridan, Wyoming 82801
 Phone 307-674-0609

LOVELAND OFFICE
 1635 Foxtail Drive, Suite 204
 Loveland, Colorado 80538
 Phone 970-776-4331



SCALE: 1" = 2,000ft

NAD83 CO-Nft

DRAWN: JELO

DATE: 10 Dec 2013

REVISED:

DATE: