

ConocoPhillips Company
CONSTRUCTION LAYOUT FOR
PROPERTY RESERVE #4-65 3-4 1H
SECTION 3, T4S, R65W, 6th P.M.
425' FSL 800' FEL

FIGURE #1
SCALE: 1" = 60'
DATE: 11-18-13
DRAWN BY: J.W.

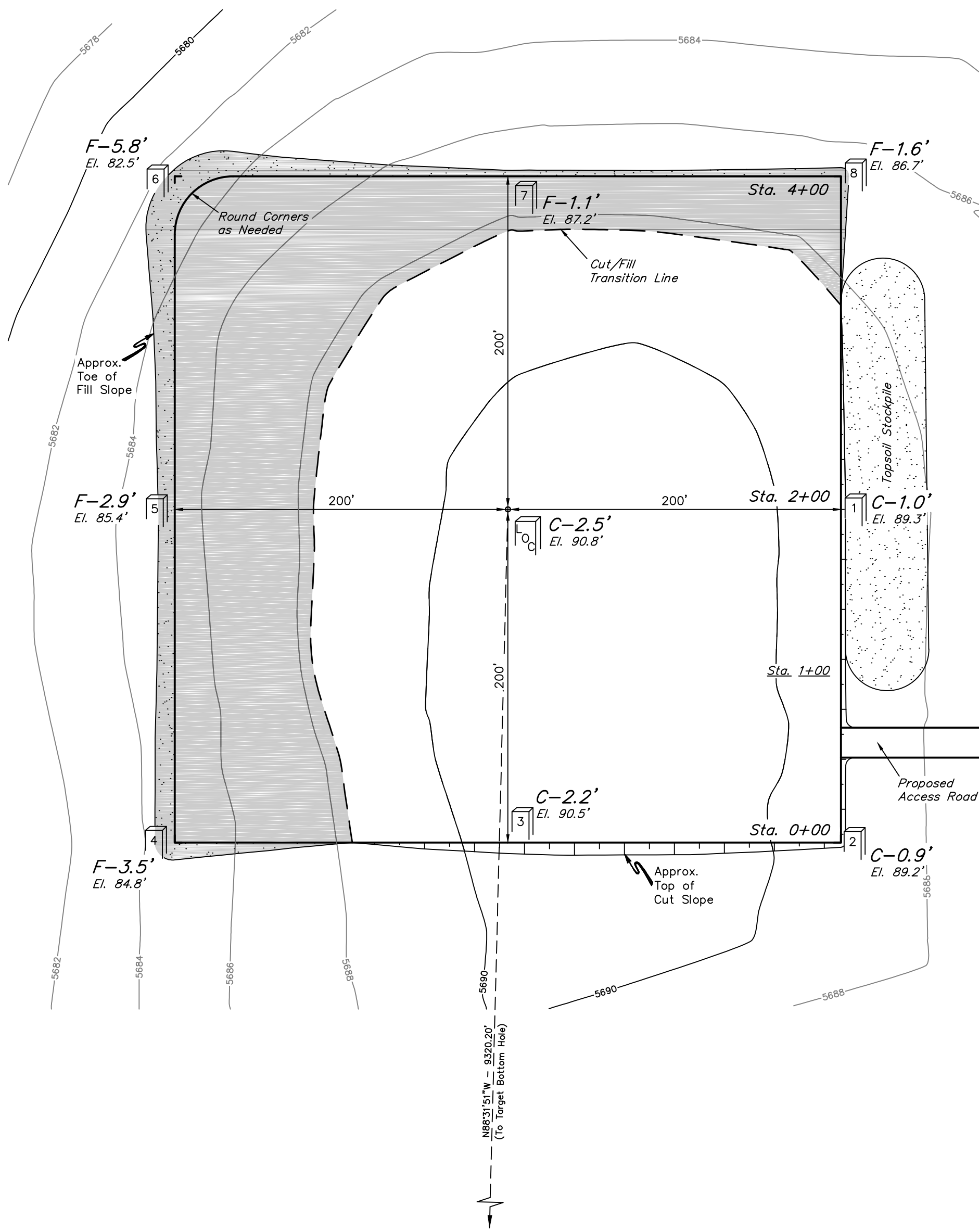
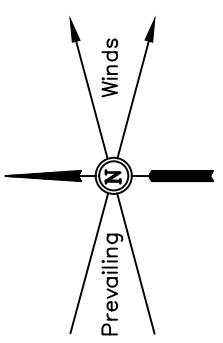
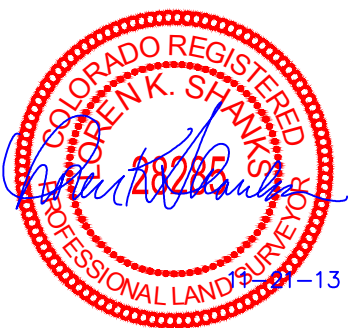

Elev. Ungraded Ground At Loc. Stake = 5690.8'
FINISHED GRADE ELEV. AT LOC. STAKE = 5688.3'

UINTAH ENGINEERING & LAND SURVEYING
85 So. 200 East * Vernal, Utah 84078 * (435) 789-1017

1" = 40'
X-Section
Scale
1" = 100'
DATE: 11-18-13
DRAWN BY: J.W.

ConocoPhillips Company
CONSTRUCTION LAYOUT CROSS SECTIONS FOR
PROPERTY RESERVE #4-65 3-4 1H
SECTION 3, T4S, R65W, 6th P.M.
425' FSL 800' FEL

FIGURE #2

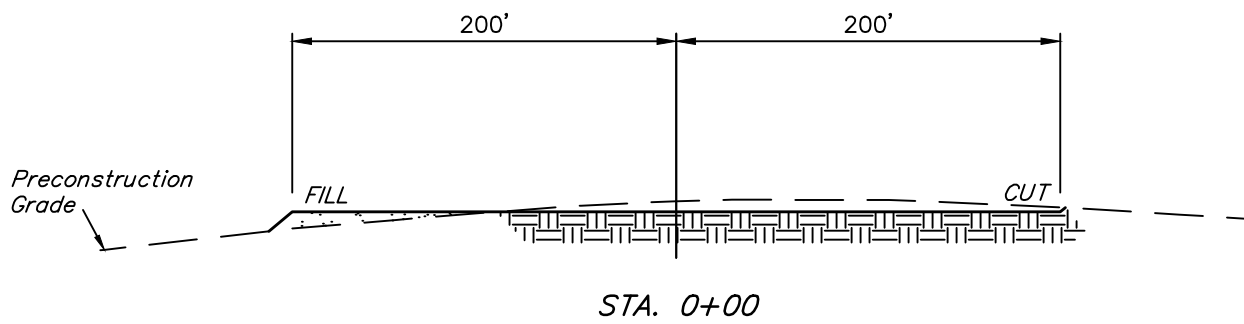
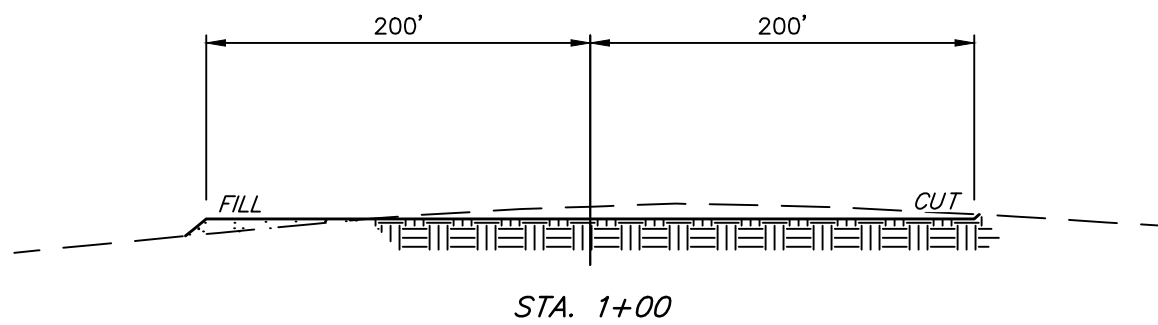
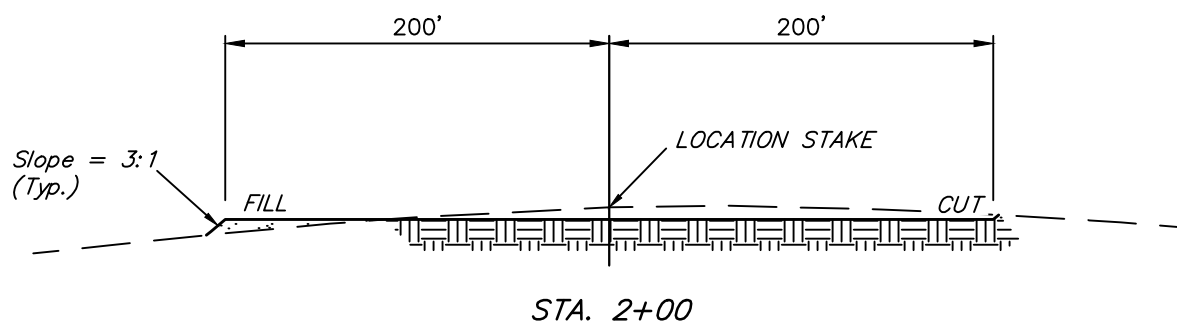
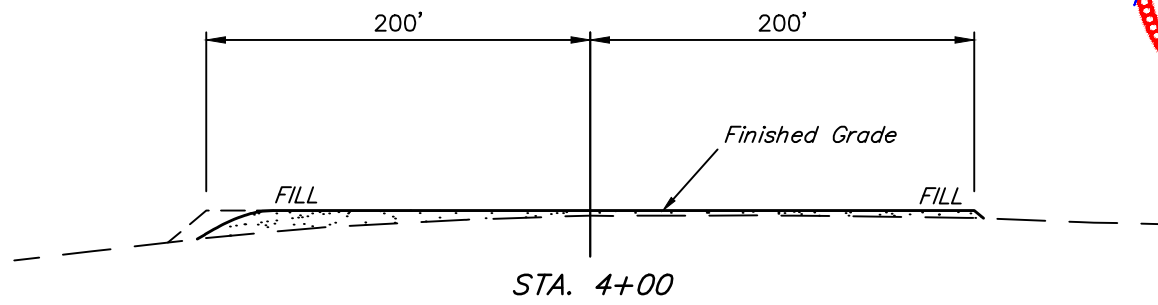

NOTE:
Topsoil should not be
Stripped Below Finished
Grade on Substructure Area.

* NOTE:
FILL QUANTITY INCLUDES
10% FOR COMPACTION

APPROXIMATE YARDAGES

(6") Topsoil Stripping = 3,160 Cu. Yds.
Remaining Location = 4,990 Cu. Yds.
TOTAL CUT = 8,150 CU. YDS.
FILL = 4,990 CU. YDS.

EXCESS MATERIAL = 3,160 Cu. Yds.
Topsoil = 3,160 Cu. Yds.
EXCESS UNBALANCE = 0 Cu. Yds.
(After Interim Rehabilitation)

APPROXIMATE ACREAGE
WELL SITE DISTURBANCE = ± 4.198 ACRES
ACCESS ROAD DISTURBANCE = ± 0.351 ACRES
TOTAL = ± 4.549 ACRES

UINTAH ENGINEERING & LAND SURVEYING
85 So. 200 East * Vernal, Utah 84078 * (435) 789-1017