

COLORADO DIVISION OF WATER RESOURCES
101 Columbine Bldg., 1845 Sherman Street, Denver, Colorado 80203

TYPE OR PRINT IN BLACK INK. APPLICATION MUST BE COMPLETED BEFORE ACCEPTANCE.

APPLICATION FOR:

☐ A PERMIT TO USE GROUND WATER
☐ A PERMIT TO CONSTRUCT A WELL
REPLACEMENT FOR NO. _____
☒ A PERMIT TO INSTALL A PUMP
OTHER _____

APPLICANT Bureau of Land Management

Craig District

Street Address Box 248

City & State Craig, Colorado 81625

Telephone No. 824-3289

NAME OF AQUIFER GROUND WATER IS TO BE OBTAINED

FROM: Sand in Mesa Verde

PROPOSED TOTAL DEPTH OF WELL 500 Ft.

ESTIMATED MAXIMUM PUMPING RATE 10 GPM

AVERAGE ANNUAL AMOUNT OF GROUND WATER TO BE

APPROPRIATED 16.06 Acre-feet

ANTICIPATED GROUT PROGRAM

Material _____

Intervals _____

Placement Method _____

PROPOSED CASING:

Plain _____ in. from _____ ft. to _____ ft.
_____ in. from _____ ft. to _____ ft.
Perf. _____ in. from _____ ft. to _____ ft.
_____ in. from _____ ft. to _____ ft.

Driller Licensed Willard Peace Drilling Co. No. Unknown

Address 2457 Industrial Blvd., Grand Junction, Colo.

IF WELL IS USED FOR IRRIGATION, BACK SIDE OF THIS APPLICATION MUST BE COMPLETED. 29360

CONDITIONS OF APPROVAL

FOR OFFICE USE ONLY

EXPIRED

DATE 5/31/74

GROUND WATER TO BE USED FOR:

DOMESTIC (1) _____ COMMERCIAL (4) _____
☒ LIVESTOCK (2) _____ INDUSTRIAL (5) _____
MUNICIPAL (8) _____ IRRIGATION (6) _____
OTHER Wildlife

WELL LOCATION

COUNTY Rio Blanco

NE $\frac{1}{4}$ of the NE $\frac{1}{4}$ of Section 30

T. 2 S, R. 98 W, 6th P.M.
IN ADDITION TO THE ABOVE, THE WELL MUST BE
LOCATED WITH REFERENCE TO GOVERNMENT SURVEY
CORNERS, MONUMENTS OR SECTION LINES BY DISTANCE
AND BEARING (DOMESTIC WELLS MAY BE LOCATED BY
LOT, BLOCK, & SUBDIVISION.)

610 ft. from North section line
(North or South)
610 ft. from East section line
(East or West)

LOT _____ BLOCK _____ FILING # _____

SUBDIVISION _____

Ground Water Basin _____

Water Mgmt. Dist. _____

Anticipated drilling date drilled 19 63
Owner of land on which well
is located:

Public Domain

Other water rights on this land None

✓ Charles W. Snicker
Signature of Applicant

APPLICATION APPROVED: VALID FOR ONE (1) YEAR
AFTER DATE ISSUED UNLESS EXTENDED FOR GOOD
CAUSE SHOWN TO THE ISSUING AGENCY.

PERMIT NO. 61389

DATE ISSUED MAY 31 1972

STATE ENGINEER E. J. Snicker

BY Barton W. Eder

THE LOCATION OF THE PROPOSED WELL MUST BE SHOWN AND THE AREA TO BE IRRIGATED MUST BE SHADED OR CROSS-HATCHED ON THE DIAGRAM BELOW

This diagram represents nine (9) sections. Use the CENTER SQUARE (one section) to indicate the location of the well, if possible.

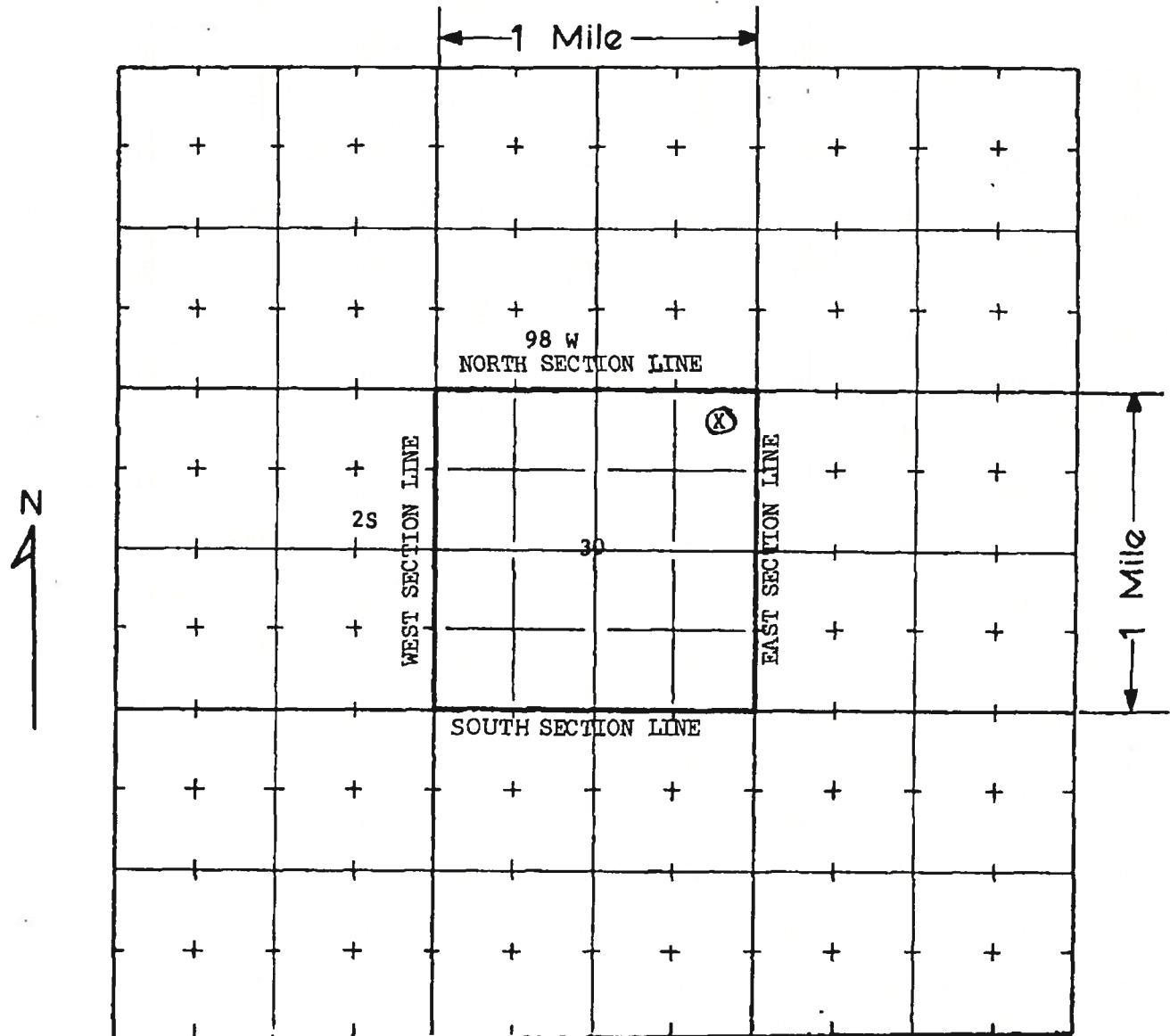

THE SCALE OF THE DIAGRAM IS TWO INCHES EQUALS ONE-MILE

Owner of irrigated land _____ Number of acres to be irrigated _____

Legal description of irrigated land _____

WATER EQUIVALENTS TABLE (Rounded Figures)

An acre-foot covers 1 acre of land 1 foot deep.
 1 cubic foot per second (cfs) 449 gallons per minute
 1 acre-foot 43,560 cubic feet 325,900 gallons.
 1,000 gpm pumped continuously for one day produces 4.42 acre-feet.
 100 gpm pumped continuously for one year produces 160 acre-feet.

RECEIVED

MAY 1972

WATER RESOURCES
STATE ENGINEER
COLO.

RECEIVED

WATER RESOURCES
STATE ENGINEER
COLO.

RELEASE OF WATER WELL

WHEREAS, that certain Oil and Gas Lease was made and entered into on 11-1-54, by and between the United States of America, Lessor, and Equity Oil Co. Lessee, bearing serial number C-09141; and

WHEREAS, Equity Oil Company whose address is Salt Lake City, Utah 84101 is the present Lessee of record; and

WHEREAS, said Lease provides that there is reserved by the Lessor all rights pursuant to Section 40 of the Mineral Leasing Act of February 25, 1920, (41 Stat. 437, as amended) to acquire casing and lease or operate valuable water wells located on said Lease and lands; and

WHEREAS, Equity Oil Company, as operator has drilled an oil or gas test well located 610 ft. from the North ~~South~~ line and 610 ft. from the ~~West~~ East line of Section 30 in Township 2S, Range 98W, and said well being located in ($\frac{1}{4}$ or lot) NE4 NE4 of the said Section 30, a portion of the above lease, which well appears to contain water of such quality and quantity to be valuable and useable at a reasonable cost for agriculture, domestic or other purposes; and

WHEREAS, the Equity Oil Company, as lessee and the Equity Oil Co., as operator desire to release, relinquish and quitclaim all right, title and interest in and to said well to the United States of America in lieu of plugging same to surface; and

WHEREAS, the United States of America, acting by and through the Secretary of the Interior desires, pursuant to said Lease and said Mineral Leasing Act of February 25, 1920, as amended, to take over said well with the express understanding and agreement that the taking over of such well will not restrict operations of said lease.

NOW, THEREFORE, for and in consideration of the premises, the undersigned has released, relinquished and quitclaimed, and does hereby release, relinquish and quitclaim unto the United States of America, acting by and through the Secretary of the Interior, all right, title and interest in and to said above described well, reserving only the right to operate said well for the production of water therefrom for other operations under this lease during the term thereof.

This instrument, regardless of the date of execution thereof, shall be effective as of 9-30-66 (expired).

IN WITNESS WHEREOF, the undersigned has executed this Release on this 30th day of September, 1968.

EQUITY OIL COMPANY

BY: 

President

1. How the reason:
Bureau of
Crim. Ident.

Please initial all changes

- (X) More complete data is required by statute for approval of Application/
Please complete where checked in RED.
- () Statute requires a \$ fee for this type of Application.
Please return with required fee.
- () The maximum allowable yield of this type of well is gallons per minute.
Please correct the application accordingly if that yield is acceptable.
- () The well location must be designated by $\frac{1}{4}$ of $\frac{1}{4}$ section, Township and Range
- () Signature of applicant is required on Application.

Other: Please fill out Form 1041 for wells already drilled.

To Informing Reason:					
Bureau of Craze, Detroit, Mo.					
MAY 9 1972					
of Application /					
COPY	EMPLOY	DN	G.R.M.	H.P.L.S	R.M.Y
gallons per minute.					
is acceptable.					
TOWNSHIP and Range.					
REALTY					
WATER					
MINERALS					
C. O.					
EQUINE					
ADM. OFF.					
CLM. R)					
CLM. (2)					
CLM. (3)					
REAR.					



United States Department of the Interior

IN REPLY REFER TO

BUREAU OF LAND MANAGEMENT
Room 700 Colorado State Bank Building
1600 Broadway
Denver, Colorado 80202

5-930
7153.1

April 19, 1972

Mr. C. J. Kuiper, State Engineer
Colorado Division of Water Resources
101 Columbine Building
1845 Sherman
Denver, Colorado 80203

Dear Mr. Kuiper:

Attached are two applications; one for a permit to construct a well and install a pump, and another for the installation of a pump. The United States of America, through the Bureau is applying to your office for these permits as a gesture of voluntary compliance with State Law. These applications are not, nor should they be construed as acknowledgment of any right of power of the Colorado State Engineer to permit or in any manner attach the rights to the United States fully to develop and utilize the ground water resources on its property. Additionally, these applications are not, nor should they be construed as a waiver of any of the reserved rights of the United States.

Attached to the application to install a pump is a release signed by the Equity Oil Company.

The oral purchase order number of 05910-PH2-0288 is to cover the \$10.00 processing fee. Upon completion of processing applications, please send an invoice with this purchase order number to expedite payment. Invoice should be sent to:

Bureau of Land Management
Denver Service Center
Building 50, Denver Federal Center
Denver, Colorado 80225

Attention: Division of Financial Management.

Sincerely yours,

Charles W. Loecker

ACTING State Director

RECEIVED
MAY 19 1972

Attachment

WATER RESOURCES
ST. JC ENGINEER
COLO.

RECEIVED

APR 21 1972

WATER RESOURCES
STATE ENGINEER
COLO.



United States Department of the Interior

BUREAU OF LAND MANAGEMENT
Room 700 Colorado State Bank Building
1600 Broadway
Denver, Colorado 80202

IN REPLY REFER TO

5-930
7153.1

May 11, 1972

Mr. C. J. Kuiper, State Engineer
Colorado Division of Water Resources
101 Columbine Building
1845 Sherman
Denver, Colorado 80203

Dear Mr. Kuiper:

This is the additional information required as discussed with Mr. Erker. Form WRJ-25-72 is not being completed. However, we would like to explain that this well was a dry hole drilled by Equity Oil Company. They did encounter water within 500 feet, so a release was obtained and the well conditioned and capped. The Bureau now needs the water for the management of the resources. This is the reason for asking for a permit to install a pump. The water from this well has never been put to beneficial use.

On our other application we do not, as of now, know who the driller will be since the drilling is let on a bid basis.

Sincerely yours,

Charles W. Lucker

ACTING State Director

Attachment

RECEIVED
MAY 1972

WATER RESOURCES
STATE ENGINEER
COLD.