

C:\FES PROJECTS\1319-01_BONANZA\5N-61W\dwg\5N-61W LAYOUT.dwg SAVED DATE 2014-03-17 08:23

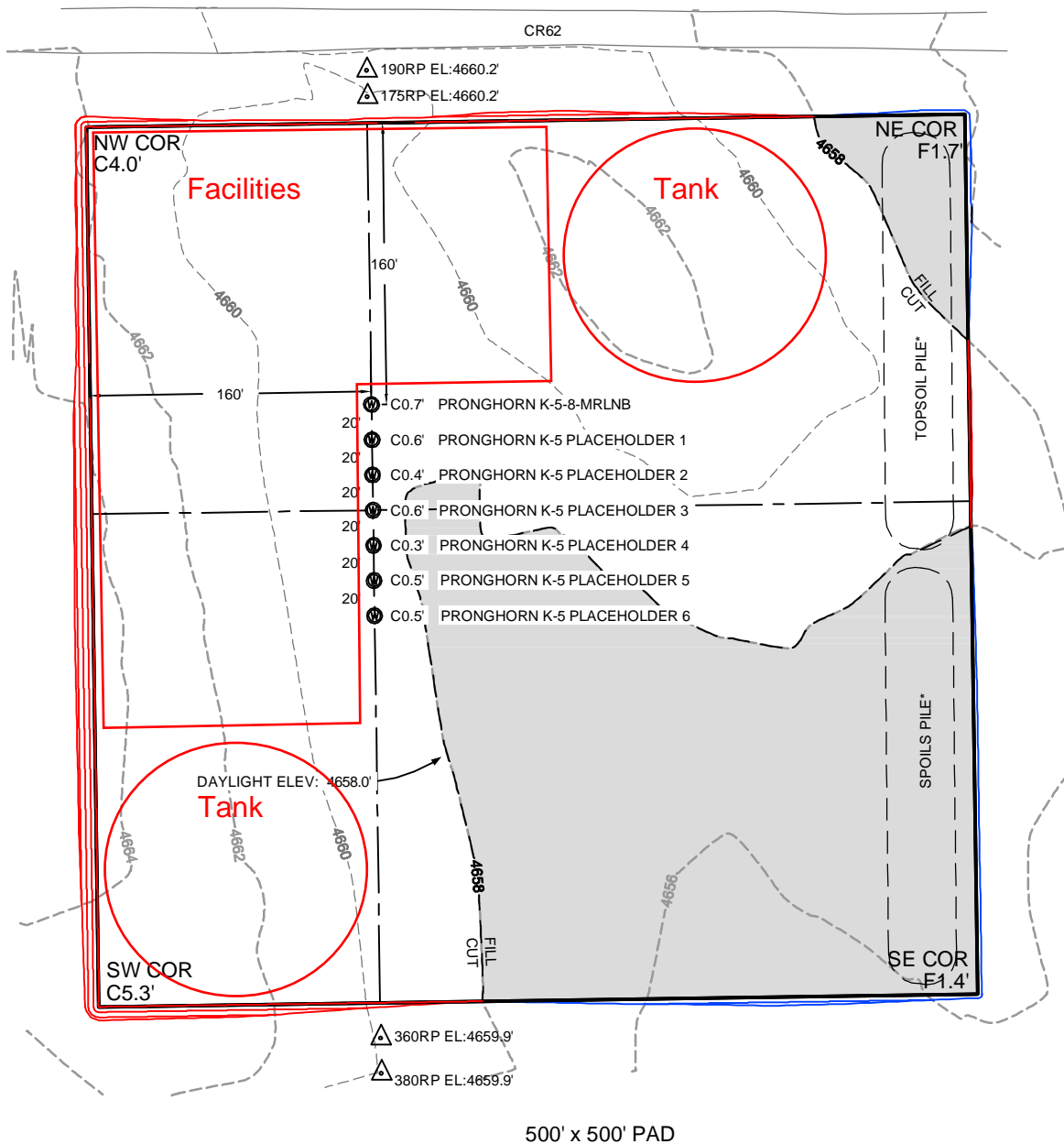

DESIGN INFORMATION & EARTH VOLUMES
EXISTING GRADE @ CENTER LOCATION = 4,658.6'
FINISHED GRADE ELEVATION = 4,658.0'
CUT SLOPES = 1.5:1
FILL SLOPES = 1.5:1
TOTAL CUT FOR WELL PAD = 15,995 C.Y.
TOTAL FILL FOR WELL PAD = 3,111 C.Y.
TOPSOIL @ 6" DEPTH (ESTIMATED) = 2,000 C.Y.
SHRINKAGE (10%) = 1,082 C.Y.
EXCESS MATERIAL = 9,802 C.Y.
* CONTRACTOR SHALL PLACE TOPSOIL & SPOILS
PILES ON PAD AT OWNERS DISCRETION

SHEET NO:
1 of 1

Fremont
ENGINEERING & SURVEYING
64 COAL MINE RD.
LANDER, WY 82520
307-349-0840
fes@wyoming.com

Drawn By: DAF
Checked By: DDF
Date: 3/17/14
Revision:
Date:
Explanation:

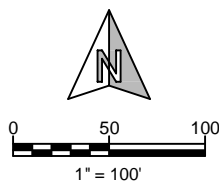

PAD CUT/FILL LAYOUT

PRONGHORN K-5 PAD
NW¼NE¼ (LOT 2), SECTION 5,
T.5N., R.61W., 6th PM
WELD COUNTY, COLORADO

BONANZA CREEK
410 17th Street
Denver, CO 80202
(720) 440-6100