

**BILL BARRETT CORP**  
**Merritt 6-66-9-0659CH**  
**WELD COUNTY, COLORADO**

**Geodetic System: US State Plane 1983**  
**Zone: Colorado Northern Zone**  
**KB @ 4845.0usft (Nabors #M22)**  
**Ground Level: 4822.0**  
**Latitude: 40° 30' 33.552 N**  
**Longitude: 104° 46' 51.528 W**

**Magnetic North is 8.61° East of True North (Magnetic Declination)**



Azimuths to True North  
Magnetic North: 8.61°

Magnetic Field  
Strength: 52975.1snT  
Dip Angle: 67.07°  
Date: 6/18/2013  
Model: IGRF2010

MD	Inc	Azi	TVD	+N/-S	+E/-W	Dleg	TFace	Vsect
0.0	0.00	0.00	0.0	0.0	0.0	0.00	0.00	0.0
1944.3	0.00	0.00	1944.3	0.0	0.0	0.00	0.00	0.0
2477.7	8.00	62.59	2475.9	17.1	33.0	1.50	62.59	-13.4
5693.5	8.00	62.59	5660.5	223.2	430.3	0.00	0.00	-174.6
6226.9	0.00	0.00	6192.1	240.3	463.3	1.50	180.00	-188.0
6726.9	0.00	0.00	6692.1	240.3	463.3	0.00	0.00	-188.0
7548.6	90.39	179.58	7213.0	-284.1	467.1	11.00	179.58	333.6
11778.4	90.39	179.58	7184.2	-4513.7	498.2	0.00	0.00	4541.1

**FORMATION TOP DETAILS**

TVDPath	MDPath	Formation
4470.0	4491.3	Sussex
4875.1	4900.5	Shannon
6890.3	6930.2	Sharon Springs
6957.1	7004.9	Niobrara
7185.2	7374.2	Top C Target

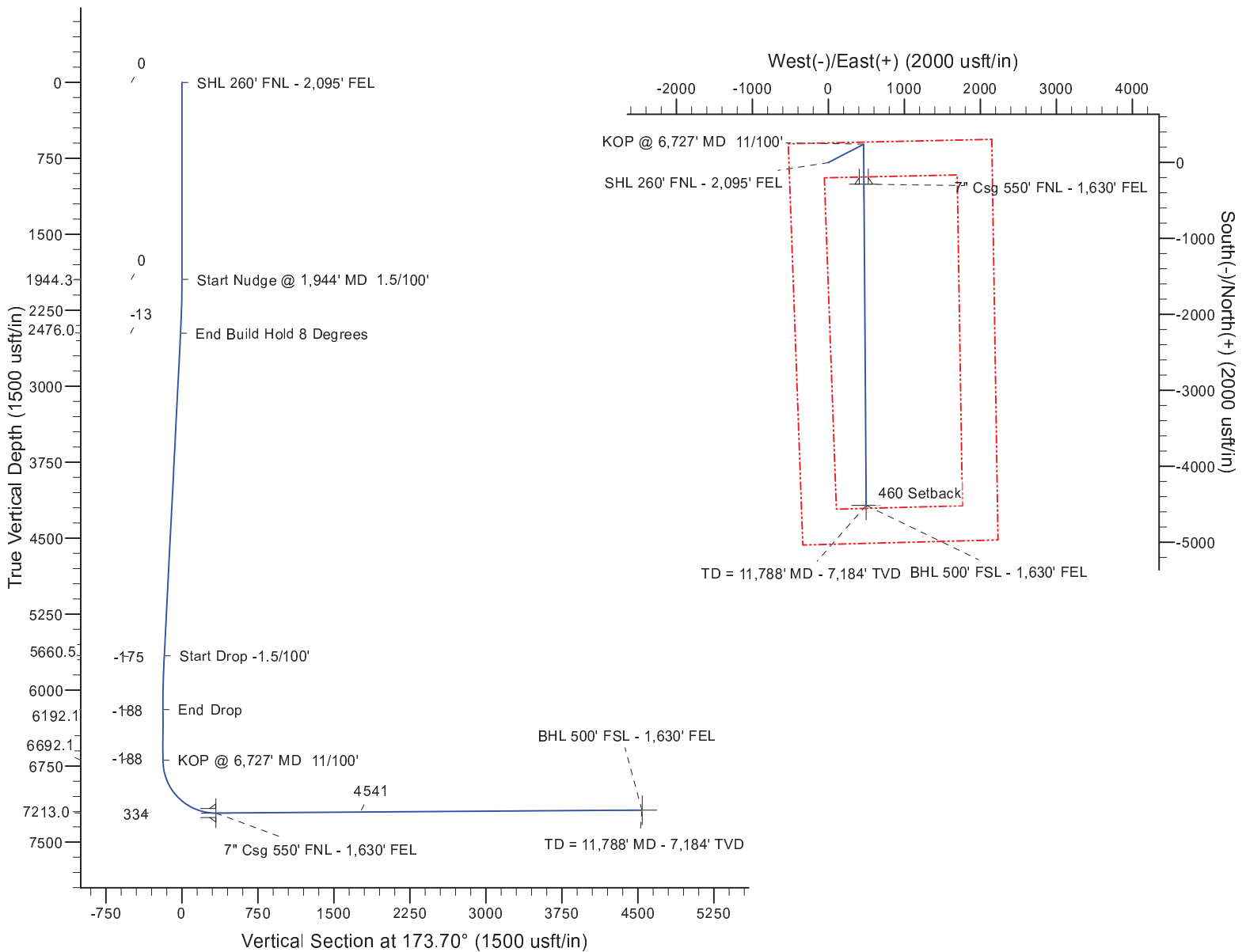

Plan: Revised 10-04-13 (Merritt 6-66-9-0659CH/Wellbore #1)

Created By: Mike Kirby Date: 13:11, October 04 2013  
Checked: Date:   
Reviewed: Date:   
Approved: x Date: x

## Survey Report

<b>Company:</b>	BILL BARRETT CORP	<b>Local Co-ordinate Reference:</b>	Well Merritt 6-66-9-0659CH
<b>Project:</b>	WELD COUNTY, COLORADO	<b>TVD Reference:</b>	Revised @ 4844.0usft (Nabors #M22)
<b>Site:</b>	Merritt 6-66-9 Pad	<b>MD Reference:</b>	Revised @ 4844.0usft (Nabors #M22)
<b>Well:</b>	Merritt 6-66-9-0659CH	<b>North Reference:</b>	True
<b>Wellbore:</b>	Nabors #M22	<b>Survey Calculation Method:</b>	Minimum Curvature
<b>Design:</b>	Nabors #M22	<b>Database:</b>	Rocky Mountain R5000 Database

<b>Project</b>	WELD COUNTY, COLORADO		
<b>Map System:</b>	US State Plane 1983	<b>System Datum:</b>	Mean Sea Level
<b>Geo Datum:</b>	North American Datum 1983		
<b>Map Zone:</b>	Colorado Northern Zone		

Site		Merritt 6-66-9 Pad					
Site Position:		Northing:	1,429,196.40	usft	Latitude:	40° 30' 33.552 N	
From:	Lat/Long	Easting:	3,199,929.40	usft	Longitude:	104° 46' 51.528 W	
Position Uncertainty:		0.0	usft	Slot Radius:	13-3/16 "	Grid Convergence:	0.46 °

Well	Merritt 6-66-9-0659CH					
Well Position	+N/-S	0.0 usft	Northing:	1,429,196.37 usft	Latitude:	40° 30' 33.552 N
	+E/-W	0.0 usft	Easting:	3,199,929.40 usft	Longitude:	104° 46' 51.528 W
Position Uncertainty		0.0 usft	Wellhead Elevation:	4,844.0 usft	Ground Level:	4,822.0 usft

<b>Wellbore</b>	Nabors #M22				
<b>Magnetics</b>	<b>Model Name</b>	<b>Sample Date</b>	<b>Declination (°)</b>	<b>Dip Angle (°)</b>	<b>Field Strength (nT)</b>
	IGRF2010	10/6/2013	8.57	67.06	52,943

<b>Design</b>	Nabors #M22				
<b>Audit Notes:</b>					
<b>Version:</b>	1.0	<b>Phase:</b>	ACTUAL	<b>Tie On Depth:</b>	0.0
<b>Vertical Section:</b>	<b>Depth From (TVD) (usft)</b>	<b>+N/-S (usft)</b>	<b>+E/-W (usft)</b>	<b>Direction (°)</b>	
	0.0	0.0	0.0	173.70	

<b>Survey Program</b>	<b>Date</b>	10/13/2013			
<b>From (usft)</b>	<b>To (usft)</b>	<b>Survey (Wellbore)</b>	<b>Tool Name</b>	<b>Description</b>	
877.0	11,770.0	Final Survey Report (Nabors #M22)	MWD	MWD - Standard	

<b>Survey</b>									
<b>Measured Depth (usft)</b>	<b>Inclination (°)</b>	<b>Azimuth (°)</b>	<b>Vertical Depth (usft)</b>	<b>+N/-S (usft)</b>	<b>+E/-W (usft)</b>	<b>Vertical Section (usft)</b>	<b>Dogleg Rate (°/100usft)</b>	<b>Build Rate (°/100usft)</b>	<b>Turn Rate (°/100usft)</b>
783.0	0.64	274.75	783.0	0.1	-5.3	-0.6	0.00	0.00	0.00
<b>Tie On to Gyro Survey</b>									
877.0	0.40	261.70	877.0	0.1	-6.1	-0.7	0.28	-0.26	-13.88
971.0	1.50	97.10	971.0	-0.1	-5.2	-0.4	2.01	1.17	-175.11
1,063.0	1.70	100.70	1,062.9	-0.5	-2.7	0.2	0.24	0.22	3.91
1,155.0	1.70	92.70	1,154.9	-0.9	0.0	0.9	0.26	0.00	-8.70
1,247.0	1.50	100.60	1,246.9	-1.1	2.5	1.4	0.32	-0.22	8.59
1,340.0	1.20	93.70	1,339.8	-1.4	4.7	1.9	0.37	-0.32	-7.42
1,432.0	1.10	94.40	1,431.8	-1.6	6.6	2.3	0.11	-0.11	0.76
1,526.0	0.90	88.60	1,525.8	-1.6	8.2	2.5	0.24	-0.21	-6.17
1,623.0	0.90	76.70	1,622.8	-1.4	9.7	2.5	0.19	0.00	-12.27

# Survey Report

<b>Company:</b>	BILL BARRETT CORP	<b>Local Co-ordinate Reference:</b>	Well Merritt 6-66-9-0659CH
<b>Project:</b>	WELD COUNTY, COLORADO	<b>TVD Reference:</b>	Revised @ 4844.0usft (Nabors #M22)
<b>Site:</b>	Merritt 6-66-9 Pad	<b>MD Reference:</b>	Revised @ 4844.0usft (Nabors #M22)
<b>Well:</b>	Merritt 6-66-9-0659CH	<b>North Reference:</b>	True
<b>Wellbore:</b>	Nabors #M22	<b>Survey Calculation Method:</b>	Minimum Curvature
<b>Design:</b>	Nabors #M22	<b>Database:</b>	Rocky Mountain R5000 Database

Survey									
Measured Depth (usft)	Inclination (°)	Azimuth (°)	Vertical Depth (usft)	+N/-S (usft)	+E/-W (usft)	Vertical Section (usft)	Dogleg Rate (°/100usft)	Build Rate (°/100usft)	Turn Rate (°/100usft)
1,718.0	0.70	43.50	1,717.8	-0.8	10.8	2.0	0.52	-0.21	-34.95
1,813.0	0.50	33.40	1,812.8	-0.1	11.4	1.3	0.24	-0.21	-10.63
1,908.0	0.30	24.40	1,907.8	0.5	11.8	0.8	0.22	-0.21	-9.47
2,002.0	1.60	53.80	2,001.8	1.5	12.9	-0.1	1.43	1.38	31.28
2,098.0	2.40	67.90	2,097.7	3.1	15.9	-1.3	0.97	0.83	14.69
2,193.0	3.70	61.30	2,192.6	5.3	20.4	-3.0	1.42	1.37	-6.95
2,287.0	5.20	64.00	2,286.3	8.6	26.9	-5.6	1.61	1.60	2.87
2,381.0	6.50	66.20	2,379.8	12.6	35.6	-8.6	1.40	1.38	2.34
2,476.0	7.80	63.20	2,474.0	17.7	46.3	-12.5	1.42	1.37	-3.16
2,571.0	7.50	61.10	2,568.2	23.6	57.5	-17.1	0.43	-0.32	-2.21
2,666.0	7.10	58.60	2,662.4	29.7	67.9	-22.0	0.54	-0.42	-2.63
2,762.0	7.00	60.30	2,757.7	35.6	78.0	-26.9	0.24	-0.10	1.77
2,857.0	9.30	65.60	2,851.7	41.7	90.1	-31.5	2.54	2.42	5.58
2,953.0	8.80	64.90	2,946.5	48.0	103.8	-36.3	0.53	-0.52	-0.73
3,049.0	7.80	62.00	3,041.5	54.2	116.2	-41.1	1.13	-1.04	-3.02
3,144.0	7.50	61.10	3,135.7	60.2	127.3	-45.9	0.34	-0.32	-0.95
3,238.0	6.90	59.20	3,228.9	66.1	137.5	-50.6	0.69	-0.64	-2.02
3,333.0	8.80	65.90	3,323.1	71.9	149.1	-55.2	2.22	2.00	7.05
3,428.0	7.60	67.90	3,417.1	77.3	161.5	-59.1	1.30	-1.26	2.11
3,523.0	6.40	66.30	3,511.4	81.8	172.2	-62.4	1.28	-1.26	-1.68
3,617.0	7.60	62.00	3,604.7	86.8	182.5	-66.2	1.39	1.28	-4.57
3,713.0	8.80	56.40	3,699.7	93.8	194.2	-72.0	1.50	1.25	-5.83
3,808.0	9.10	54.80	3,793.5	102.2	206.4	-78.9	0.41	0.32	-1.68
3,903.0	9.90	55.20	3,887.2	111.2	219.2	-86.4	0.84	0.84	0.42
3,999.0	9.00	62.60	3,981.9	119.3	232.7	-93.1	1.57	-0.94	7.71
4,094.0	9.30	62.50	4,075.7	126.3	246.1	-98.5	0.32	0.32	-0.11
4,189.0	6.90	64.50	4,169.8	132.3	258.0	-103.2	2.54	-2.53	2.11
4,284.0	6.20	67.90	4,264.1	136.7	267.9	-106.5	0.84	-0.74	3.58
4,379.0	7.40	62.30	4,358.5	141.5	278.1	-110.1	1.44	1.26	-5.89
4,475.0	6.50	57.00	4,453.8	147.3	288.1	-114.8	1.15	-0.94	-5.52
4,570.0	7.10	59.10	4,548.1	153.2	297.7	-119.7	0.68	0.63	2.21
4,665.0	7.80	59.00	4,642.3	159.6	308.3	-124.8	0.74	0.74	-0.11
4,760.0	6.90	55.70	4,736.5	166.1	318.5	-130.2	1.05	-0.95	-3.47
4,855.0	7.80	66.50	4,830.7	171.9	329.1	-134.8	1.73	0.95	11.37
4,950.0	7.40	65.70	4,924.9	177.0	340.6	-138.5	0.44	-0.42	-0.84
5,044.0	6.80	63.30	5,018.2	182.0	351.1	-142.4	0.71	-0.64	-2.55
5,139.0	8.50	82.60	5,112.4	185.4	363.1	-144.5	3.22	1.79	20.32
5,234.0	7.10	79.20	5,206.5	187.4	375.8	-145.0	1.55	-1.47	-3.58
5,329.0	6.10	66.00	5,300.8	190.6	386.2	-147.0	1.91	-1.05	-13.89
5,424.0	7.60	57.10	5,395.2	196.0	396.1	-151.4	1.93	1.58	-9.37
5,519.0	6.50	54.40	5,489.4	202.6	405.7	-156.8	1.21	-1.16	-2.84
5,614.0	7.10	43.00	5,583.8	210.0	414.1	-163.3	1.55	0.63	-12.00
5,710.0	6.00	35.20	5,679.2	218.4	421.0	-170.9	1.47	-1.15	-8.13

# Survey Report

<b>Company:</b>	BILL BARRETT CORP	<b>Local Co-ordinate Reference:</b>	Well Merritt 6-66-9-0659CH
<b>Project:</b>	WELD COUNTY, COLORADO	<b>TVD Reference:</b>	Revised @ 4844.0usft (Nabors #M22)
<b>Site:</b>	Merritt 6-66-9 Pad	<b>MD Reference:</b>	Revised @ 4844.0usft (Nabors #M22)
<b>Well:</b>	Merritt 6-66-9-0659CH	<b>North Reference:</b>	True
<b>Wellbore:</b>	Nabors #M22	<b>Survey Calculation Method:</b>	Minimum Curvature
<b>Design:</b>	Nabors #M22	<b>Database:</b>	Rocky Mountain R5000 Database

Survey										
Measured Depth (usft)	Inclination (°)	Azimuth (°)	Vertical Depth (usft)	+N/-S (usft)	+E/-W (usft)	Vertical Section (usft)	Dogleg Rate (°/100usft)	Build Rate (°/100usft)	Turn Rate (°/100usft)	
5,804.0	4.20	36.40	5,772.8	225.2	425.9	-177.1	1.92	-1.91	1.28	
5,899.0	4.10	51.30	5,867.5	230.2	430.6	-181.5	1.14	-0.11	15.68	
5,994.0	3.30	48.90	5,962.3	234.1	435.3	-184.9	0.86	-0.84	-2.53	
6,089.0	2.90	39.20	6,057.2	237.7	438.9	-188.1	0.69	-0.42	-10.21	
6,185.0	2.30	36.50	6,153.1	241.2	441.6	-191.3	0.64	-0.63	-2.81	
6,280.0	2.00	34.90	6,248.0	244.1	443.7	-193.9	0.32	-0.32	-1.68	
6,376.0	0.70	52.00	6,344.0	245.8	445.1	-195.5	1.40	-1.35	17.81	
6,472.0	0.40	46.70	6,440.0	246.4	445.8	-196.0	0.32	-0.31	-5.52	
6,567.0	0.40	60.10	6,535.0	246.8	446.3	-196.3	0.10	0.00	14.11	
6,662.0	0.60	71.60	6,630.0	247.1	447.1	-196.5	0.23	0.21	12.11	
6,694.0	0.70	85.80	6,662.0	247.2	447.5	-196.6	0.59	0.31	44.38	
6,726.0	1.80	132.20	6,694.0	246.8	448.0	-196.2	4.41	3.44	145.00	
6,758.0	5.40	149.20	6,725.9	245.2	449.2	-194.4	11.61	11.25	53.13	
6,790.0	9.90	151.70	6,757.6	241.5	451.2	-190.5	14.10	14.06	7.81	
6,821.0	14.20	154.30	6,787.9	235.7	454.2	-184.5	13.98	13.87	8.39	
6,853.0	18.50	153.30	6,818.6	227.6	458.1	-176.0	13.47	13.44	-3.13	
6,885.0	22.90	154.20	6,848.6	217.5	463.1	-165.4	13.79	13.75	2.81	
6,917.0	24.50	162.50	6,877.9	205.6	467.8	-153.0	11.55	5.00	25.94	
6,949.0	25.80	168.00	6,906.8	192.4	471.3	-139.5	8.35	4.06	17.19	
6,981.0	29.80	170.80	6,935.1	177.8	474.0	-124.7	13.15	12.50	8.75	
7,013.0	34.40	172.80	6,962.2	160.9	476.4	-107.7	14.75	14.38	6.25	
7,044.0	38.40	174.50	6,987.2	142.6	478.4	-89.3	13.31	12.90	5.48	
7,076.0	43.10	178.10	7,011.4	121.8	479.8	-68.4	16.42	14.69	11.25	
7,108.0	46.40	184.00	7,034.2	99.3	479.3	-46.1	16.57	10.31	18.44	
7,140.0	48.70	186.10	7,055.8	75.8	477.2	-23.0	8.67	7.19	6.56	
7,172.0	50.40	185.80	7,076.5	51.6	474.7	0.8	5.36	5.31	-0.94	
7,203.0	53.60	183.00	7,095.6	27.2	472.8	24.8	12.54	10.32	-9.03	
7,235.0	55.60	181.40	7,114.1	1.2	471.8	50.6	7.46	6.25	-5.00	
7,267.0	56.90	180.60	7,131.9	-25.4	471.4	77.0	4.56	4.06	-2.50	
7,298.0	60.10	181.70	7,148.1	-51.9	470.8	103.2	10.76	10.32	3.55	
7,329.0	64.10	181.40	7,162.6	-79.2	470.1	130.3	12.93	12.90	-0.97	
7,362.0	68.30	180.30	7,175.9	-109.4	469.7	160.3	13.09	12.73	-3.33	
7,394.0	71.30	180.30	7,187.0	-139.5	469.5	190.1	9.38	9.38	0.00	
7,425.0	74.50	179.30	7,196.1	-169.1	469.6	219.6	10.77	10.32	-3.23	
7,457.0	79.60	178.20	7,203.3	-200.2	470.3	250.6	16.29	15.94	-3.44	
7,489.0	84.20	178.60	7,207.8	-231.9	471.2	282.2	14.43	14.38	1.25	
7,520.0	87.00	179.40	7,210.1	-262.8	471.7	313.0	9.39	9.03	2.58	
7,530.0	87.60	179.90	7,210.6	-272.8	471.8	322.9	7.81	6.00	5.00	
7,541.5	87.95	180.28	7,211.1	-284.3	471.8	334.3	4.47	3.02	3.29	
M 0659CH LP										
7,606.0	89.90	182.40	7,212.3	-348.8	470.2	398.2	4.47	3.03	3.29	
7,701.0	91.20	182.30	7,211.4	-443.7	466.4	492.2	1.37	1.37	-0.11	
7,797.0	92.30	182.50	7,208.4	-539.5	462.3	587.0	1.16	1.15	0.21	

# Survey Report

<b>Company:</b>	BILL BARRETT CORP	<b>Local Co-ordinate Reference:</b>	Well Merritt 6-66-9-0659CH
<b>Project:</b>	WELD COUNTY, COLORADO	<b>TVD Reference:</b>	Revised @ 4844.0usft (Nabors #M22)
<b>Site:</b>	Merritt 6-66-9 Pad	<b>MD Reference:</b>	Revised @ 4844.0usft (Nabors #M22)
<b>Well:</b>	Merritt 6-66-9-0659CH	<b>North Reference:</b>	True
<b>Wellbore:</b>	Nabors #M22	<b>Survey Calculation Method:</b>	Minimum Curvature
<b>Design:</b>	Nabors #M22	<b>Database:</b>	Rocky Mountain R5000 Database

Survey									
Measured Depth (usft)	Inclination (°)	Azimuth (°)	Vertical Depth (usft)	+N/-S (usft)	+E/-W (usft)	Vertical Section (usft)	Dogleg Rate (°/100usft)	Build Rate (°/100usft)	Turn Rate (°/100usft)
7,891.0	91.80	181.80	7,205.1	-633.4	458.8	679.9	0.91	-0.53	-0.74
7,986.0	91.20	180.90	7,202.6	-728.3	456.6	774.0	1.14	-0.63	-0.95
8,018.0	90.30	180.60	7,202.2	-760.3	456.2	805.8	2.96	-2.81	-0.94
8,081.0	91.60	180.10	7,201.1	-823.3	455.8	868.4	2.21	2.06	-0.79
8,176.0	91.40	179.50	7,198.6	-918.3	456.1	962.8	0.67	-0.21	-0.63
8,208.0	90.80	179.00	7,198.0	-950.3	456.5	994.6	2.44	-1.88	-1.56
8,272.0	89.80	179.10	7,197.7	-1,014.3	457.6	1,058.4	1.57	-1.56	0.16
8,368.0	90.90	178.90	7,197.1	-1,110.3	459.3	1,153.9	1.16	1.15	-0.21
8,463.0	90.20	178.60	7,196.2	-1,205.2	461.3	1,248.6	0.80	-0.74	-0.32
8,558.0	90.90	178.50	7,195.3	-1,300.2	463.7	1,343.2	0.74	0.74	-0.11
8,654.0	89.80	178.70	7,194.7	-1,396.2	466.1	1,438.9	1.16	-1.15	0.21
8,749.0	89.70	178.20	7,195.1	-1,491.1	468.6	1,533.5	0.54	-0.11	-0.53
8,844.0	91.00	177.80	7,194.5	-1,586.1	472.0	1,628.3	1.43	1.37	-0.42
8,939.0	90.10	178.00	7,193.6	-1,681.0	475.4	1,723.0	0.97	-0.95	0.21
9,034.0	89.20	177.50	7,194.2	-1,775.9	479.2	1,817.8	1.08	-0.95	-0.53
9,130.0	90.60	177.40	7,194.4	-1,871.8	483.4	1,913.6	1.46	1.46	-0.10
9,226.0	89.10	178.90	7,194.6	-1,967.8	486.5	2,009.3	2.21	-1.56	1.56
9,321.0	88.00	179.60	7,197.0	-2,062.7	487.8	2,103.8	1.37	-1.16	0.74
9,416.0	89.50	180.40	7,199.1	-2,157.7	487.8	2,198.2	1.79	1.58	0.84
9,511.0	89.80	179.30	7,199.7	-2,252.7	488.0	2,292.6	1.20	0.32	-1.16
9,606.0	91.30	179.20	7,198.8	-2,347.7	489.3	2,387.2	1.58	1.58	-0.11
9,701.0	89.40	178.80	7,198.2	-2,442.7	490.9	2,481.8	2.04	-2.00	-0.42
9,797.0	88.70	181.10	7,199.8	-2,538.6	491.0	2,577.2	2.50	-0.73	2.40
9,892.0	89.50	181.40	7,201.3	-2,633.6	488.9	2,671.4	0.90	0.84	0.32
9,987.0	91.40	181.80	7,200.5	-2,728.6	486.3	2,765.4	2.04	2.00	0.42
10,082.0	93.10	180.90	7,196.8	-2,823.5	484.1	2,859.5	2.02	1.79	-0.95
10,177.0	92.30	181.10	7,192.3	-2,918.3	482.4	2,953.6	0.87	-0.84	0.21
10,272.0	91.80	180.60	7,188.9	-3,013.3	481.0	3,047.8	0.74	-0.53	-0.53
10,367.0	91.10	180.30	7,186.5	-3,108.2	480.2	3,142.2	0.80	-0.74	-0.32
10,462.0	91.00	180.70	7,184.8	-3,203.2	479.4	3,236.5	0.43	-0.11	0.42
10,557.0	90.00	180.60	7,183.9	-3,298.2	478.3	3,330.8	1.06	-1.05	-0.11
10,652.0	88.80	179.80	7,184.9	-3,393.2	478.0	3,425.2	1.52	-1.26	-0.84
10,747.0	86.90	179.80	7,188.5	-3,488.1	478.3	3,519.5	2.00	-2.00	0.00
10,842.0	87.10	179.40	7,193.5	-3,583.0	479.0	3,613.9	0.47	0.21	-0.42
10,938.0	87.40	178.90	7,198.1	-3,678.9	480.4	3,709.4	0.61	0.31	-0.52
11,033.0	88.10	178.40	7,201.8	-3,773.8	482.7	3,803.9	0.91	0.74	-0.53
11,128.0	88.70	177.30	7,204.5	-3,868.7	486.2	3,898.7	1.32	0.63	-1.16
11,223.0	89.60	176.60	7,205.9	-3,963.5	491.3	3,993.5	1.20	0.95	-0.74
11,318.0	91.10	176.00	7,205.3	-4,058.3	497.4	4,088.4	1.70	1.58	-0.63
11,413.0	90.90	175.60	7,203.6	-4,153.0	504.4	4,183.3	0.47	-0.21	-0.42
11,508.0	91.90	178.60	7,201.3	-4,247.9	509.2	4,278.1	3.33	1.05	3.16
11,603.0	92.90	179.30	7,197.3	-4,342.8	510.9	4,372.6	1.28	1.05	0.74
11,699.0	94.20	178.00	7,191.4	-4,438.6	513.2	4,468.1	1.91	1.35	-1.35
11,718.0	94.70	177.70	7,189.9	-4,457.5	513.9	4,487.0	3.07	2.63	-1.58

## Survey Report

<b>Company:</b>	BILL BARRETT CORP	<b>Local Co-ordinate Reference:</b>	Well Merritt 6-66-9-0659CH
<b>Project:</b>	WELD COUNTY, COLORADO	<b>TVD Reference:</b>	Revised @ 4844.0usft (Nabors #M22)
<b>Site:</b>	Merritt 6-66-9 Pad	<b>MD Reference:</b>	Revised @ 4844.0usft (Nabors #M22)
<b>Well:</b>	Merritt 6-66-9-0659CH	<b>North Reference:</b>	True
<b>Wellbore:</b>	Nabors #M22	<b>Survey Calculation Method:</b>	Minimum Curvature
<b>Design:</b>	Nabors #M22	<b>Database:</b>	Rocky Mountain R5000 Database

Survey									
Measured Depth (usft)	Inclination (°)	Azimuth (°)	Vertical Depth (usft)	+N/-S (usft)	+E/-W (usft)	Vertical Section (usft)	Dogleg Rate (°/100usft)	Build Rate (°/100usft)	Turn Rate (°/100usft)
11,770.0	94.70	177.70	7,185.6	-4,509.3	516.0	4,538.7	0.00	0.00	0.00
Projected Survey to 11,770' MD - M 0659CH PBHL									

Survey Annotations				
Measured Depth (usft)	Vertical Depth (usft)	Local Coordinates		Comment
		+N/-S (usft)	+E/-W (usft)	
783.0	783.0	-4,509.3	516.0	Tie On to Gyro Survey
11,770.0	7,185.6			Projected Survey to 11,770' MD

Checked By: \_\_\_\_\_ Approved By: \_\_\_\_\_ Date: \_\_\_\_\_