

BILL BARRETT CORP  
Merritt 6-66-9-0758BH  
Weld Cty, CO

Geodetic System: US State Plane 1983  
Zone: Colorado Northern Zone  
Rivised @ 4844.0usft (Nabors #M22)  
Ground Level: 4822.0  
Latitude: 40° 30' 33.552 N  
Longitude: 104° 46' 51.528 W

Magnetic North is 8.57° East of True North (Magnetic Declination)

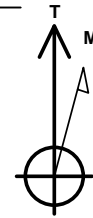

Azimuths to True North  
Magnetic North: 8.57°

Magnetic Field  
Strength: 52939.3snT  
Dip Angle: 67.06°  
Date: 10/20/2013  
Model: IGRF2010

Sec	MD	Inc	Azi	TVD	+N/-S	+E/-W	Dleg	TFace	VSect	Target
1	0.0	0.00	0.00	0.0	0.0	0.0	0.00	0.00	0.0	
2	1000.0	0.00	0.00	1000.0	0.0	0.0	0.00	0.00	0.0	
3	1573.8	8.61	69.18	1571.6	15.3	40.2	1.50	69.18	-9.1	
4	5581.8	8.61	69.18	5534.5	228.5	600.8	0.00	0.00	-136.6	
5	6155.5	0.00	0.00	6106.1	243.8	641.0	1.50	180.00	-145.8	
6	6655.5	0.00	0.00	6606.1	243.8	641.0	0.00	0.00	-145.8	
7	7477.0	90.36	179.55	7127.0	-280.4	645.1	11.00	179.55	373.2	
8	11707.0	90.36	179.55	7100.0	-4510.1	678.3	0.00	0.00	4560.8	

FORMATION TOP DETAILS

TVDPath	MDPath	Formation
4468.1	4503.2	Sussex
4869.2	4908.9	Shannon
6888.0	6953.4	Sharon Springs
6954.7	7037.4	Niobrara
7103.2	7315.7	Top B2 Target Rev1
7125.4	7433.7	Landing Point

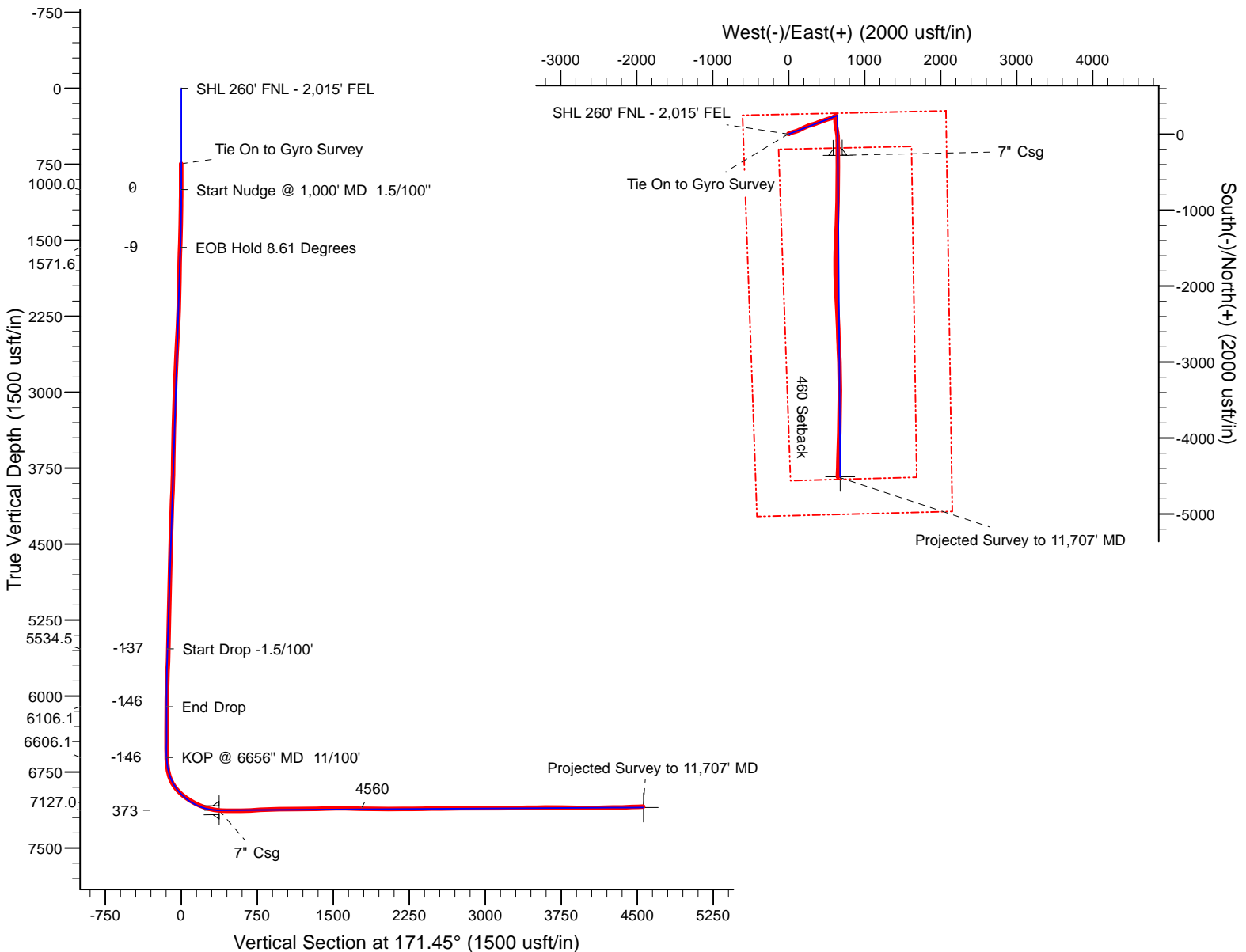

Plan: Revised 10-29-13 (Merritt 6-66-9-0758BH/Nabors #M22)

Created By: Mike Kirby Date: 11:09, November 06 2013  
Checked: Date:   
Reviewed: Date:   
Approved: x Date: x

## Survey Report

<b>Company:</b>	BILL BARRETT CORP	<b>Local Co-ordinate Reference:</b>	Well Merritt 6-66-9-0758BH
<b>Project:</b>	Weld Cty, CO	<b>TVD Reference:</b>	Rivised @ 4844.0usft (Nabors #M22)
<b>Site:</b>	Merritt 6-66-9 Pad	<b>MD Reference:</b>	Rivised @ 4844.0usft (Nabors #M22)
<b>Well:</b>	Merritt 6-66-9-0758BH	<b>North Reference:</b>	True
<b>Wellbore:</b>	Nabors #M22	<b>Survey Calculation Method:</b>	Minimum Curvature
<b>Design:</b>	Wellbore #1	<b>Database:</b>	Rocky Mountain R5000 Database

<b>Project</b>	Weld Cty, CO		
<b>Map System:</b>	US State Plane 1983	<b>System Datum:</b>	Mean Sea Level
<b>Geo Datum:</b>	North American Datum 1983		
<b>Map Zone:</b>	Colorado Northern Zone		

Site		Merritt 6-66-9 Pad				
Site Position:		Northing:	1,429,196.40 usft	Latitude:	40° 30' 33.552 N	
From:	Lat/Long	Easting:	3,199,929.40 usft	Longitude:	104° 46' 51.528 W	
Position Uncertainty:		0.0 usft	Slot Radius:	13-3/16 "	Grid Convergence:	0.46 °

Well	Merritt 6-66-9-0758BH					
Well Position	+N/-S	0.0 usft	Northing:	1,429,197.02 usft	Latitude:	40° 30' 33.552 N
	+E/-W	0.0 usft	Easting:	3,200,010.04 usft	Longitude:	104° 46' 50.484 W
Position Uncertainty		0.0 usft	Wellhead Elevation:	4,846.0 usft	Ground Level:	4,822.0 usft

<b>Wellbore</b>	Nabors #M22				
<b>Magnetics</b>	<b>Model Name</b>	<b>Sample Date</b>	<b>Declination (°)</b>	<b>Dip Angle (°)</b>	<b>Field Strength (nT)</b>
	IGRF2010	10/20/2013	8.57	67.06	52,939

<b>Design</b>	Wellbore #1				
<b>Audit Notes:</b>					
<b>Version:</b>	1.0	<b>Phase:</b>	ACTUAL	<b>Tie On Depth:</b>	0.0
<b>Vertical Section:</b>	<b>Depth From (TVD) (usft)</b>	<b>+N/-S (usft)</b>	<b>+E/-W (usft)</b>	<b>Direction (°)</b>	
	0.0	0.0	0.0	69.18	

<b>Survey Program</b>	<b>Date</b>	11/6/2013			
<b>From (usft)</b>	<b>To (usft)</b>	<b>Survey (Wellbore)</b>	<b>Tool Name</b>	<b>Description</b>	
745.0	11,707.0	Final Survey Report (Nabors #M22)	MWD	MWD - Standard	

<b>Survey</b>									
<b>Measured Depth (usft)</b>	<b>Inclination (°)</b>	<b>Azimuth (°)</b>	<b>Vertical Depth (usft)</b>	<b>+N/-S (usft)</b>	<b>+E/-W (usft)</b>	<b>Vertical Section (usft)</b>	<b>Dogleg Rate (°/100usft)</b>	<b>Build Rate (°/100usft)</b>	<b>Turn Rate (°/100usft)</b>
745.0	0.24	284.07	745.0	1.2	-3.2	-2.6	0.00	0.00	0.00
<b>Tie On to Gyro Survey</b>									
882.0	0.70	267.80	882.0	1.2	-4.3	-3.6	0.35	0.34	-11.88
975.0	0.70	270.10	975.0	1.2	-5.4	-4.7	0.03	0.00	2.47
1,067.0	1.10	67.50	1,067.0	1.5	-5.2	-4.3	1.92	0.43	171.09
1,159.0	2.50	69.80	1,158.9	2.6	-2.5	-1.4	1.52	1.52	2.50
1,251.0	3.80	68.00	1,250.8	4.4	2.2	3.6	1.42	1.41	-1.96
1,344.0	5.40	64.00	1,343.5	7.5	9.0	11.1	1.75	1.72	-4.30
1,435.0	6.70	68.90	1,434.0	11.3	17.8	20.7	1.54	1.43	5.38
1,530.0	8.40	71.30	1,528.1	15.5	29.6	33.1	1.82	1.79	2.53
1,625.0	7.90	68.40	1,622.2	20.1	42.2	46.6	0.68	-0.53	-3.05

# Survey Report

<b>Company:</b>	BILL BARRETT CORP	<b>Local Co-ordinate Reference:</b>	Well Merritt 6-66-9-0758BH
<b>Project:</b>	Weld Cty, CO	<b>TVD Reference:</b>	Rivised @ 4844.0usft (Nabors #M22)
<b>Site:</b>	Merritt 6-66-9 Pad	<b>MD Reference:</b>	Rivised @ 4844.0usft (Nabors #M22)
<b>Well:</b>	Merritt 6-66-9-0758BH	<b>North Reference:</b>	True
<b>Wellbore:</b>	Nabors #M22	<b>Survey Calculation Method:</b>	Minimum Curvature
<b>Design:</b>	Wellbore #1	<b>Database:</b>	Rocky Mountain R5000 Database

Survey									
Measured Depth (usft)	Inclination (°)	Azimuth (°)	Vertical Depth (usft)	+N/-S (usft)	+E/-W (usft)	Vertical Section (usft)	Dogleg Rate (°/100usft)	Build Rate (°/100usft)	Turn Rate (°/100usft)
1,721.0	8.60	67.60	1,717.2	25.3	55.0	60.4	0.74	0.73	-0.83
1,816.0	8.10	76.10	1,811.2	29.6	68.0	74.1	1.40	-0.53	8.95
1,911.0	8.70	76.90	1,905.2	32.8	81.5	87.9	0.64	0.63	0.84
2,006.0	7.70	77.10	1,999.2	35.9	94.7	101.3	1.05	-1.05	0.21
2,100.0	8.50	71.00	2,092.3	39.6	107.4	114.5	1.25	0.85	-6.49
2,195.0	9.30	66.30	2,186.1	44.9	121.1	129.2	1.14	0.84	-4.95
2,289.0	8.90	65.60	2,278.9	51.0	134.7	144.0	0.44	-0.43	-0.74
2,384.0	9.50	65.20	2,372.7	57.3	148.5	159.2	0.64	0.63	-0.42
2,480.0	8.70	61.60	2,467.5	64.1	162.1	174.3	1.02	-0.83	-3.75
2,575.0	9.80	65.40	2,561.3	70.9	175.7	189.5	1.32	1.16	4.00
2,670.0	8.50	63.80	2,655.1	77.3	189.4	204.5	1.39	-1.37	-1.68
2,766.0	7.70	60.50	2,750.1	83.6	201.4	217.9	0.96	-0.83	-3.44
2,862.0	9.10	67.80	2,845.1	89.7	214.0	231.9	1.83	1.46	7.60
2,957.0	7.90	63.90	2,939.0	95.4	226.8	245.9	1.40	-1.26	-4.11
3,052.0	9.60	68.70	3,032.9	101.1	240.1	260.3	1.95	1.79	5.05
3,146.0	9.50	68.70	3,125.6	106.8	254.6	275.9	0.11	-0.11	0.00
3,241.0	7.80	67.60	3,219.5	112.1	267.8	290.2	1.80	-1.79	-1.16
3,336.0	8.60	73.10	3,313.6	116.6	280.6	303.7	1.18	0.84	5.79
3,431.0	7.40	73.00	3,407.6	120.5	293.3	316.9	1.26	-1.26	-0.11
3,527.0	7.90	76.80	3,502.8	123.8	305.6	329.6	0.74	0.52	3.96
3,621.0	8.40	76.80	3,595.8	126.8	318.6	342.8	0.53	0.53	0.00
3,716.0	7.00	74.70	3,690.0	129.9	330.9	355.5	1.50	-1.47	-2.21
3,812.0	8.00	72.00	3,785.1	133.5	342.9	368.0	1.10	1.04	-2.81
3,908.0	10.00	69.10	3,880.0	138.6	357.0	383.0	2.14	2.08	-3.02
4,003.0	9.80	68.10	3,973.5	144.5	372.2	399.3	0.28	-0.21	-1.05
4,098.0	9.60	67.70	4,067.2	150.6	387.1	415.3	0.22	-0.21	-0.42
4,193.0	8.10	66.40	4,161.1	156.3	400.5	429.9	1.59	-1.58	-1.37
4,289.0	8.20	68.40	4,256.1	161.5	413.1	443.5	0.31	0.10	2.08
4,381.0	8.80	74.00	4,347.1	165.8	426.0	457.1	1.11	0.65	6.09
4,476.0	8.10	72.50	4,441.0	169.8	439.3	471.0	0.77	-0.74	-1.58
4,572.0	9.50	69.00	4,535.9	174.7	453.2	485.7	1.56	1.46	-3.65
4,666.0	8.70	69.10	4,628.7	180.0	467.1	500.6	0.85	-0.85	0.11
4,760.0	8.90	72.00	4,721.6	184.8	480.6	514.9	0.52	0.21	3.09
4,856.0	8.20	74.70	4,816.6	188.9	494.3	529.2	0.84	-0.73	2.81
4,950.0	8.20	73.40	4,909.6	192.6	507.2	542.5	0.20	0.00	-1.38
5,045.0	8.40	71.90	5,003.6	196.7	520.3	556.2	0.31	0.21	-1.58
5,140.0	7.80	72.50	5,097.7	200.8	533.0	569.6	0.64	-0.63	0.63
5,235.0	6.80	71.70	5,191.9	204.5	544.5	581.6	1.06	-1.05	-0.84
5,330.0	6.40	68.50	5,286.3	208.2	554.8	592.5	0.57	-0.42	-3.37
5,426.0	5.20	69.50	5,381.8	211.7	563.8	602.2	1.25	-1.25	1.04
5,520.0	4.60	70.20	5,475.4	214.5	571.4	610.3	0.64	-0.64	0.74
5,615.0	5.00	64.80	5,570.1	217.5	578.7	618.2	0.63	0.42	-5.68
5,710.0	6.00	55.80	5,664.6	222.1	586.5	627.2	1.39	1.05	-9.47

# Survey Report

<b>Company:</b>	BILL BARRETT CORP	<b>Local Co-ordinate Reference:</b>	Well Merritt 6-66-9-0758BH
<b>Project:</b>	Weld Cty, CO	<b>TVD Reference:</b>	Rivised @ 4844.0usft (Nabors #M22)
<b>Site:</b>	Merritt 6-66-9 Pad	<b>MD Reference:</b>	Rivised @ 4844.0usft (Nabors #M22)
<b>Well:</b>	Merritt 6-66-9-0758BH	<b>North Reference:</b>	True
<b>Wellbore:</b>	Nabors #M22	<b>Survey Calculation Method:</b>	Minimum Curvature
<b>Design:</b>	Wellbore #1	<b>Database:</b>	Rocky Mountain R5000 Database

Survey									
Measured Depth (usft)	Inclination (°)	Azimuth (°)	Vertical Depth (usft)	+N/-S (usft)	+E/-W (usft)	Vertical Section (usft)	Dogleg Rate (°/100usft)	Build Rate (°/100usft)	Turn Rate (°/100usft)
5,806.0	5.30	57.90	5,760.2	227.2	594.4	636.4	0.76	-0.73	2.19
5,901.0	4.40	59.30	5,854.8	231.4	601.3	644.3	0.96	-0.95	1.47
5,996.0	3.30	61.10	5,949.6	234.6	606.8	650.6	1.16	-1.16	1.89
6,092.0	2.40	60.80	6,045.5	236.9	611.0	655.3	0.94	-0.94	-0.31
6,188.0	1.70	67.70	6,141.4	238.5	614.1	658.7	0.77	-0.73	7.19
6,283.0	1.40	68.00	6,236.4	239.4	616.4	661.3	0.32	-0.32	0.32
6,378.0	1.30	76.90	6,331.4	240.1	618.6	663.5	0.24	-0.11	9.37
6,475.0	1.10	89.70	6,428.4	240.4	620.6	665.5	0.34	-0.21	13.20
6,571.0	0.60	105.90	6,524.3	240.2	622.0	666.7	0.57	-0.52	16.88
6,613.0	0.30	160.80	6,566.3	240.1	622.2	666.9	1.17	-0.71	130.71
6,664.0	1.40	170.20	6,617.3	239.3	622.4	666.8	2.17	2.16	18.43
6,727.0	7.30	185.00	6,680.1	234.6	622.2	664.9	9.46	9.37	23.49
6,758.0	7.60	186.30	6,710.9	230.6	621.8	663.1	1.11	0.97	4.19
6,790.0	11.10	193.20	6,742.4	225.5	620.8	660.4	11.47	10.94	21.56
6,822.0	15.20	190.60	6,773.6	218.3	619.4	656.5	12.94	12.81	-8.13
6,854.0	20.40	187.60	6,804.1	208.7	617.8	651.7	16.50	16.25	-9.38
6,886.0	25.10	186.30	6,833.6	196.4	616.4	645.9	14.77	14.69	-4.06
6,919.0	30.40	182.40	6,862.8	181.1	615.2	639.4	16.97	16.06	-11.82
6,950.0	36.20	177.90	6,888.7	164.1	615.2	633.4	20.33	18.71	-14.52
6,982.0	40.00	173.10	6,913.8	144.4	616.8	627.9	15.05	11.88	-15.00
7,014.0	42.80	170.80	6,937.8	123.5	619.8	623.2	9.96	8.75	-7.19
7,045.0	46.50	169.50	6,959.9	102.0	623.5	619.1	12.29	11.94	-4.19
7,077.0	50.60	168.90	6,981.1	78.5	628.0	614.9	12.89	12.81	-1.88
7,109.0	54.60	169.80	7,000.5	53.5	632.7	610.4	12.70	12.50	2.81
7,141.0	56.70	174.00	7,018.6	27.3	636.4	604.6	12.67	6.56	13.13
7,173.0	58.90	175.20	7,035.6	0.4	639.0	597.4	7.57	6.88	3.75
7,204.0	62.30	175.90	7,050.8	-26.5	641.1	589.8	11.14	10.97	2.26
7,236.0	63.30	177.40	7,065.5	-55.0	642.7	581.2	5.21	3.13	4.69
7,267.0	66.90	177.40	7,078.5	-83.0	644.0	572.4	11.61	11.61	0.00
7,299.0	69.70	177.50	7,090.3	-112.7	645.3	563.1	8.75	8.75	0.31
7,331.0	72.00	178.60	7,100.8	-142.9	646.4	553.3	7.89	7.19	3.44
7,363.0	74.70	179.30	7,110.0	-173.6	646.9	543.0	8.69	8.44	2.19
7,395.0	77.30	181.00	7,117.7	-204.6	646.8	531.9	9.62	8.13	5.31
7,422.0	80.70	180.40	7,122.9	-231.1	646.5	522.1	12.78	12.59	-2.22
7,471.5	85.08	180.65	7,129.0	-280.2	646.1	504.3	8.86	8.85	0.52
M 0758BH LP									
7,500.0	87.60	180.80	7,130.8	-308.7	645.7	493.8	8.86	8.85	0.51
7,596.0	89.40	180.30	7,133.4	-404.6	644.8	458.9	1.95	1.88	-0.52
7,690.0	91.50	179.60	7,132.6	-498.6	644.9	425.5	2.35	2.23	-0.74
7,786.0	92.40	179.60	7,129.3	-594.6	645.5	392.0	0.94	0.94	0.00
7,881.0	93.20	180.70	7,124.7	-689.5	645.3	358.1	1.43	0.84	1.16
7,975.0	93.10	180.60	7,119.5	-783.3	644.2	323.7	0.15	-0.11	-0.11
8,070.0	92.10	181.10	7,115.2	-878.2	642.8	288.7	1.18	-1.05	0.53

# Survey Report

<b>Company:</b>	BILL BARRETT CORP	<b>Local Co-ordinate Reference:</b>	Well Merritt 6-66-9-0758BH
<b>Project:</b>	Weld Cty, CO	<b>TVD Reference:</b>	Rivised @ 4844.0usft (Nabors #M22)
<b>Site:</b>	Merritt 6-66-9 Pad	<b>MD Reference:</b>	Rivised @ 4844.0usft (Nabors #M22)
<b>Well:</b>	Merritt 6-66-9-0758BH	<b>North Reference:</b>	True
<b>Wellbore:</b>	Nabors #M22	<b>Survey Calculation Method:</b>	Minimum Curvature
<b>Design:</b>	Wellbore #1	<b>Database:</b>	Rocky Mountain R5000 Database

Survey										
Measured Depth (usft)	Inclination (°)	Azimuth (°)	Vertical Depth (usft)	+N/-S (usft)	+E/-W (usft)	Vertical Section (usft)	Dogleg Rate (°/100usft)	Build Rate (°/100usft)	Turn Rate (°/100usft)	
8,166.0	89.10	181.60	7,114.2	-974.2	640.5	252.5	3.17	-3.13	0.52	
8,260.0	89.30	182.20	7,115.5	-1,068.1	637.4	216.2	0.67	0.21	0.64	
8,356.0	91.30	182.30	7,115.0	-1,164.0	633.7	178.6	2.09	2.08	0.10	
8,450.0	91.30	182.50	7,112.9	-1,257.9	629.7	141.5	0.21	0.00	0.21	
8,545.0	91.40	182.10	7,110.7	-1,352.8	625.9	104.2	0.43	0.11	-0.42	
8,641.0	91.60	181.70	7,108.2	-1,448.7	622.7	67.1	0.47	0.21	-0.42	
8,736.0	88.80	182.40	7,107.8	-1,543.6	619.3	30.2	3.04	-2.95	0.74	
8,832.0	88.00	179.80	7,110.5	-1,639.6	617.5	-5.6	2.83	-0.83	-2.71	
8,928.0	90.10	180.20	7,112.1	-1,735.6	617.5	-39.7	2.23	2.19	0.42	
9,023.0	89.10	179.10	7,112.8	-1,830.6	618.1	-72.9	1.56	-1.05	-1.16	
9,117.0	89.10	177.80	7,114.2	-1,924.5	620.6	-103.9	1.38	0.00	-1.38	
9,212.0	90.80	178.20	7,114.3	-2,019.4	623.9	-134.6	1.84	1.79	0.42	
9,308.0	89.40	176.80	7,114.2	-2,115.4	628.1	-164.8	2.06	-1.46	-1.46	
9,403.0	91.30	175.80	7,113.6	-2,210.1	634.2	-192.7	2.26	2.00	-1.05	
9,499.0	90.80	178.50	7,111.8	-2,306.0	639.0	-222.3	2.86	-0.52	2.81	
9,594.0	90.10	177.20	7,111.1	-2,400.9	642.6	-252.7	1.55	-0.74	-1.37	
9,690.0	91.30	177.70	7,109.9	-2,496.8	646.9	-282.8	1.35	1.25	0.52	
9,784.0	90.50	177.90	7,108.4	-2,590.7	650.5	-312.8	0.88	-0.85	0.21	
9,878.0	90.70	177.70	7,107.4	-2,684.7	654.1	-342.9	0.30	0.21	-0.21	
9,975.0	90.90	177.10	7,106.1	-2,781.6	658.5	-373.2	0.65	0.21	-0.62	
10,071.0	89.20	178.50	7,106.0	-2,877.5	662.2	-403.8	2.29	-1.77	1.46	
10,165.0	91.00	178.70	7,105.8	-2,971.5	664.5	-435.1	1.93	1.91	0.21	
10,260.0	89.20	178.70	7,105.7	-3,066.4	666.6	-466.8	1.89	-1.89	0.00	
10,355.0	90.40	178.40	7,106.0	-3,161.4	669.0	-498.3	1.30	1.26	-0.32	
10,450.0	91.60	178.20	7,104.3	-3,256.3	671.8	-529.4	1.28	1.26	-0.21	
10,545.0	90.20	179.20	7,102.8	-3,351.3	674.0	-561.2	1.81	-1.47	1.05	
10,640.0	89.50	179.90	7,103.1	-3,446.3	674.7	-594.3	1.04	-0.74	0.74	
10,735.0	91.20	179.90	7,102.5	-3,541.3	674.9	-627.9	1.79	1.79	0.00	
10,830.0	90.90	181.50	7,100.8	-3,636.3	673.7	-662.7	1.71	-0.32	1.68	
10,926.0	88.60	183.00	7,101.2	-3,732.2	670.0	-700.3	2.86	-2.40	1.56	
11,020.0	88.80	182.30	7,103.3	-3,826.0	665.6	-737.7	0.77	0.21	-0.74	
11,116.0	89.10	181.00	7,105.1	-3,922.0	662.9	-774.4	1.39	0.31	-1.35	
11,211.0	90.70	180.50	7,105.2	-4,017.0	661.6	-809.4	1.76	1.68	-0.53	
11,306.0	92.70	181.10	7,102.4	-4,111.9	660.3	-844.3	2.20	2.11	0.63	
11,401.0	89.70	182.10	7,100.4	-4,206.9	657.6	-880.6	3.33	-3.16	1.05	
11,496.0	91.70	182.10	7,099.3	-4,301.8	654.2	-917.6	2.11	2.11	0.00	
11,591.0	92.20	181.80	7,096.0	-4,396.7	650.9	-954.3	0.61	0.53	-0.32	
11,655.0	92.80	182.10	7,093.3	-4,460.6	648.7	-979.0	1.05	0.94	0.47	
11,703.0	92.80	182.10	7,090.9	-4,508.5	647.0	-997.7	0.00	0.00	0.00	
M 0758BH PBHL										
11,707.0	92.80	182.10	7,090.7	-4,512.5	646.8	-999.3	0.00	0.00	0.00	
Projected Survey to 11,707' MD										

## Survey Report

<b>Company:</b>	BILL BARRETT CORP	<b>Local Co-ordinate Reference:</b>	Well Merritt 6-66-9-0758BH
<b>Project:</b>	Weld Cty, CO	<b>TVD Reference:</b>	Rivised @ 4844.0usft (Nabors #M22)
<b>Site:</b>	Merritt 6-66-9 Pad	<b>MD Reference:</b>	Rivised @ 4844.0usft (Nabors #M22)
<b>Well:</b>	Merritt 6-66-9-0758BH	<b>North Reference:</b>	True
<b>Wellbore:</b>	Nabors #M22	<b>Survey Calculation Method:</b>	Minimum Curvature
<b>Design:</b>	Wellbore #1	<b>Database:</b>	Rocky Mountain R5000 Database

### Survey Annotations

Measured Depth (usft)	Vertical Depth (usft)	Local Coordinates		Comment
		+N/-S (usft)	+E/-W (usft)	
745.0	745.0	1.2	-3.2	Tie On to Gyro Survey
11,707.0	7,090.7	-4,512.5	646.8	Projected Survey to 11,707' MD

Checked By: _____	Approved By: _____	Date: _____
-------------------	--------------------	-------------