

EXISTING CONTOURS HAAS 1-29

SECTION 29, TOWNSHIP 7 SOUTH, RANGE 62 WEST OF THE 6TH PRINCIPAL MERIDIAN

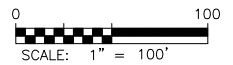
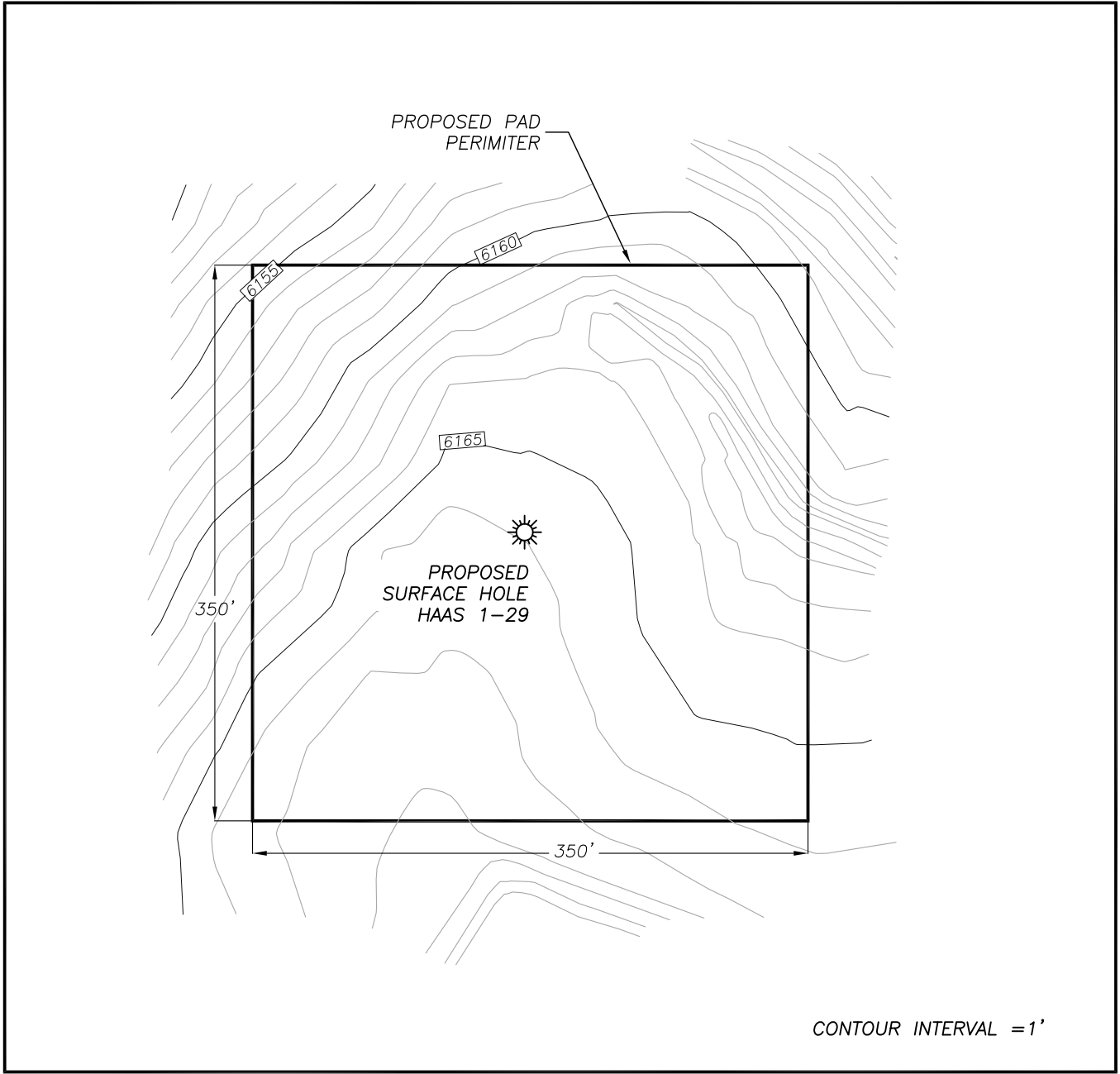

PROPOSED PAD CONTOURS
HAAS 1-29

SECTION 29, TOWNSHIP 7 SOUTH, RANGE 62 WEST OF THE 6TH PRINCIPAL MERIDIAN

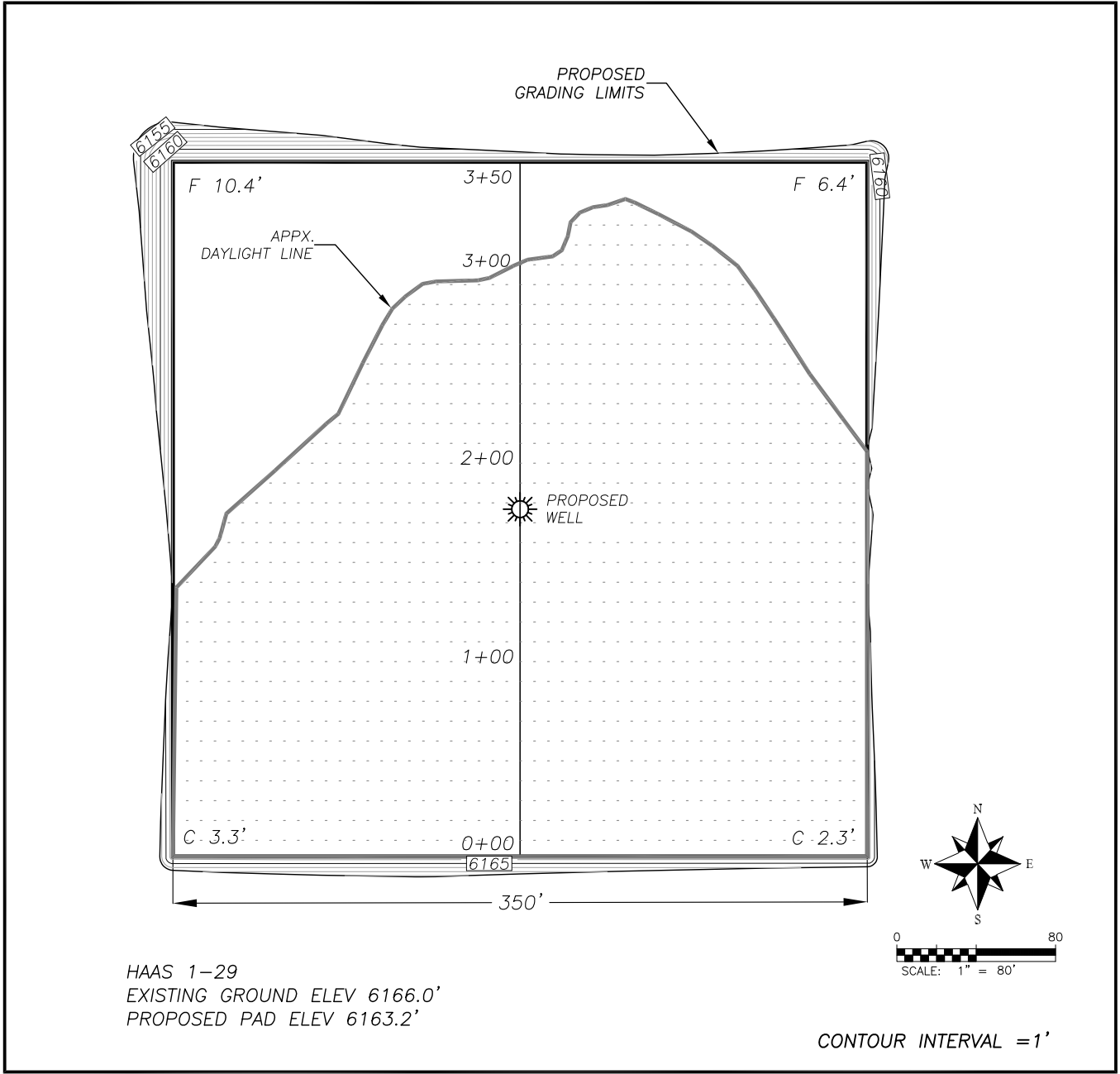

HAAS 1-29
EXISTING GROUND ELEV 6166.0'
PROPOSED PAD ELEV 6163.2'

CONTOUR INTERVAL = 1'

Top of pad elevation: 6163.2'
Cut slope ratio: 2.0
Fill slope ratio: 2.0
Cut Swell Factor: 1.00
Fill Shrink Factor: 1.00

Pad Earthwork Volumes:
Total cut: 7657 C.Y.
Total fill: 3707 C.Y.
Balance Export: 3950 C.Y. (8" Topsoil)
Area: 2.8 Acres

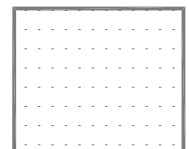

AREA OF PROPOSED CUT

PROPOSED PAD CROSS SECTIONS HAAS 1-29

SECTION 29, TOWNSHIP 7 SOUTH, RANGE 62 WEST OF THE 6TH PRINCIPAL MERIDIAN

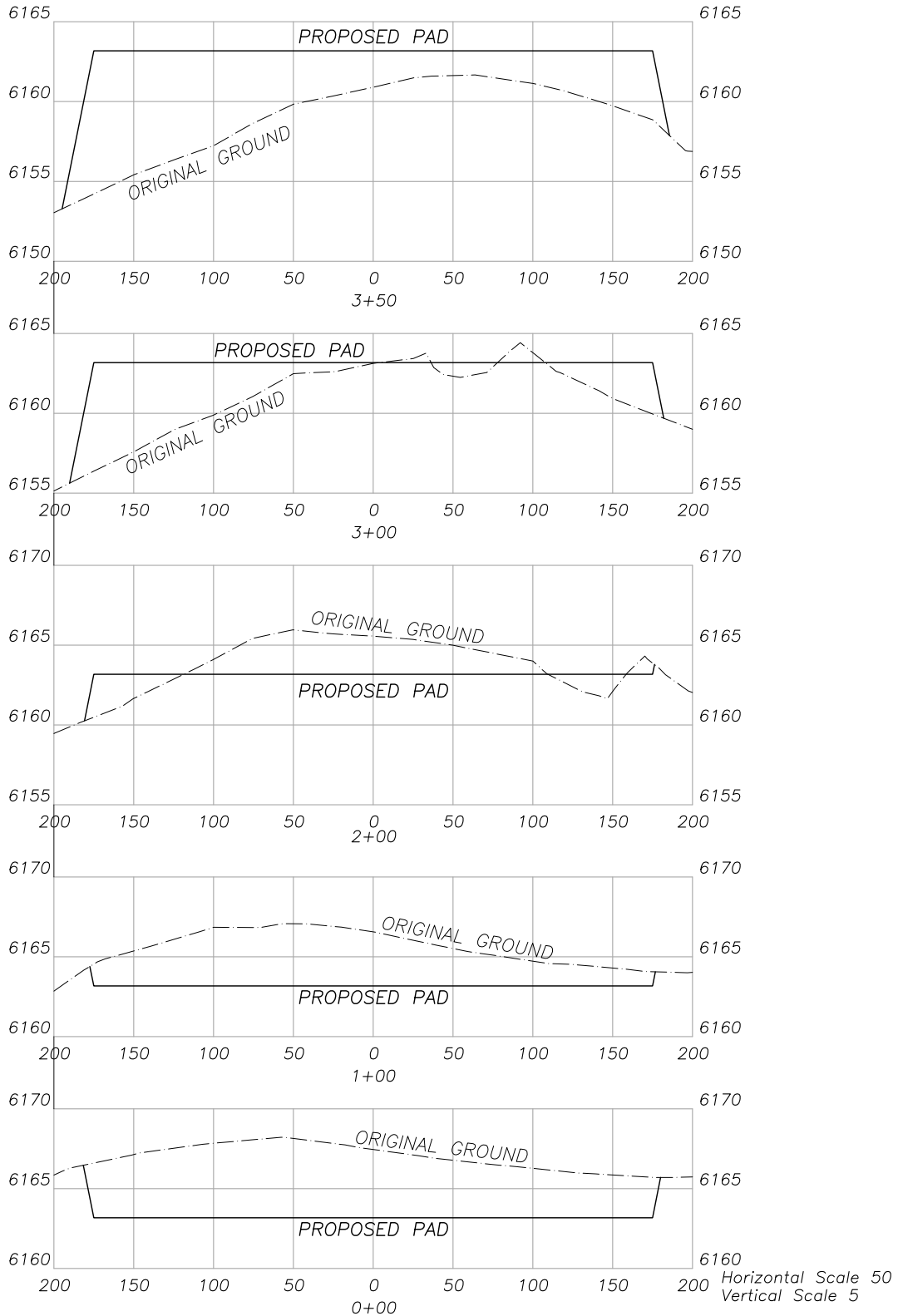

PROPOSED RIG LAYOUT HAAS 1-29

SECTION 29, TOWNSHIP 7 SOUTH, RANGE 62 WEST OF THE 6TH PRINCIPAL MERIDIAN

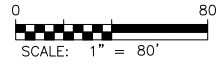
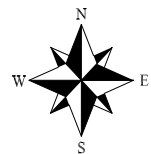
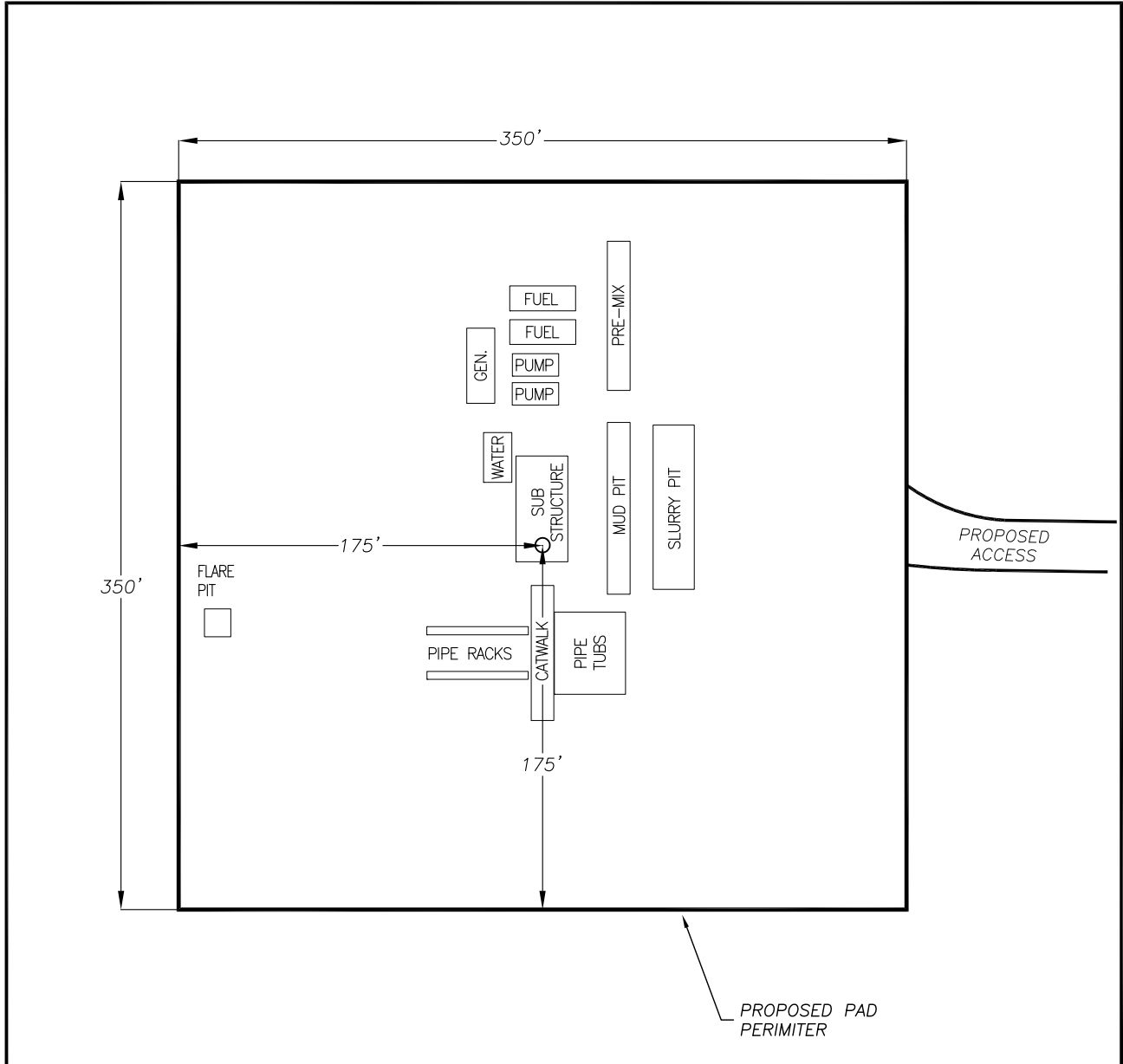

PROPOSED PRODUCTION FACILITY HAAS 1-29

SECTION 29, TOWNSHIP 7 SOUTH, RANGE 62 WEST OF THE 6TH PRINCIPAL MERIDIAN

