



# WHITING OIL & GAS CORP.

## LOCATION DRAWING FOR

HORSETAIL #30F-1948, #30F-1947, #30F-1946, #30F-1945,  
#30F-1944, #30F-1943, #30F-1942, #30F-1941, #30F-3108,  
#30F-3107, #30F-3106 & #30F-3105  
SECTION 30, T10N, R57W, 6th P.M.  
SE 1/4 NW 1/4

SCALE: 1" = 300'  
DATE SURVEYED: 10-14-13  
SURVEYED BY: DAVE SWANSON  
DATE DRAWN: 10-25-13  
DRAWN BY: J.S.  
REV: 01-14-14 J.K.W.

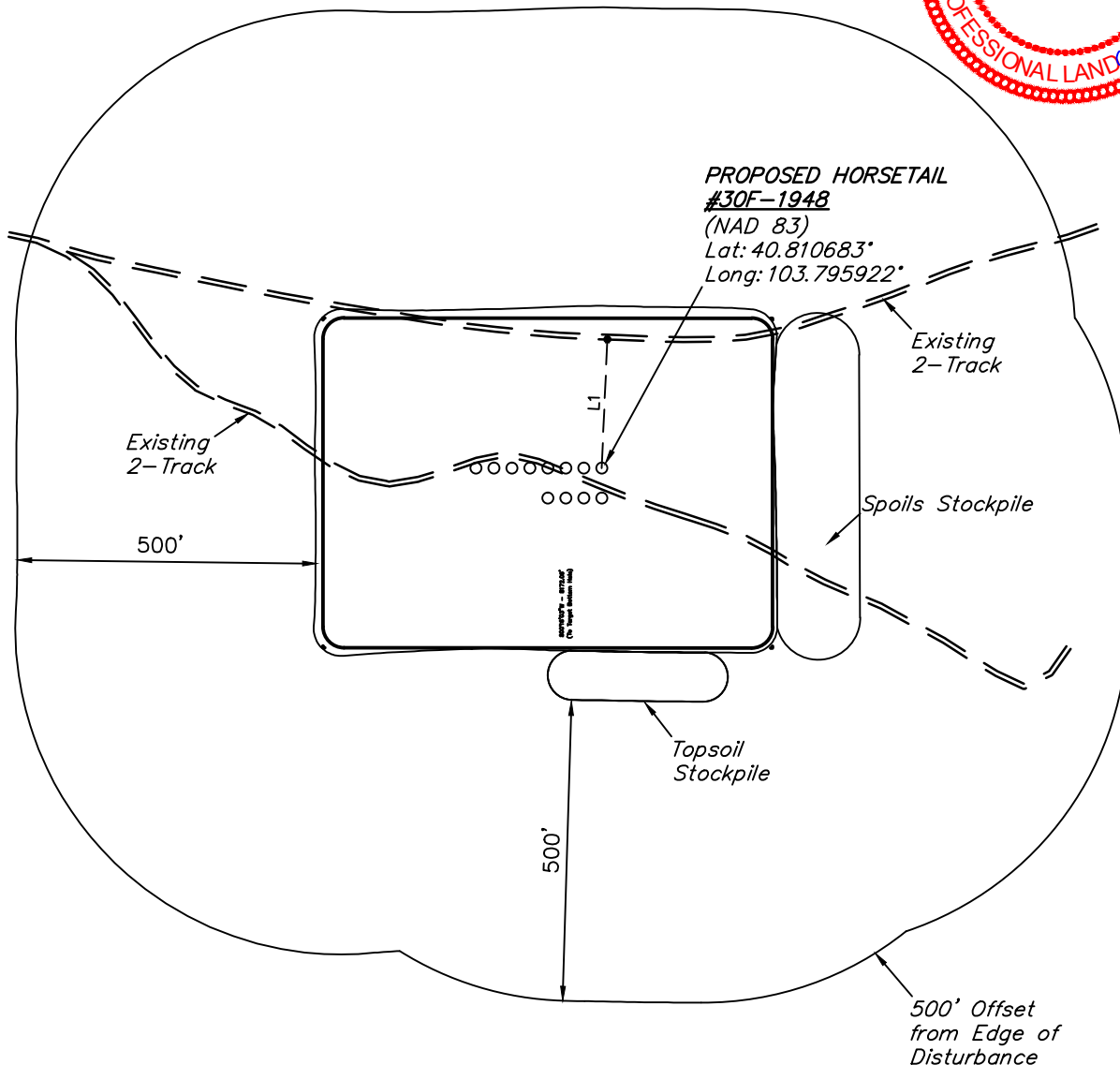

LINE TABLE		
LINE	DIRECTION	LENGTH
L1	N03°E	215'