

LEGEND:

 PROPOSED LOCATION

GREAT WESTERN OIL & GAS COMPANY

JBL OFF-SITE TANK BATTERY
 SECTION 34, T7N, R67W, 6th P.M.
 2404' FNL 1567' FEL



Uintah Engineering & Land Surveying
 85 South 200 East Vernal, Utah 84078
 (435) 789-1017 * FAX (435) 789-1813



ACCESS ROAD
MAP

08 **31** **12**
 MONTH DAY YEAR

SCALE: 1:100,000 DRAWN BY: J.L.H. REV: 02-13-14 J.L.G.



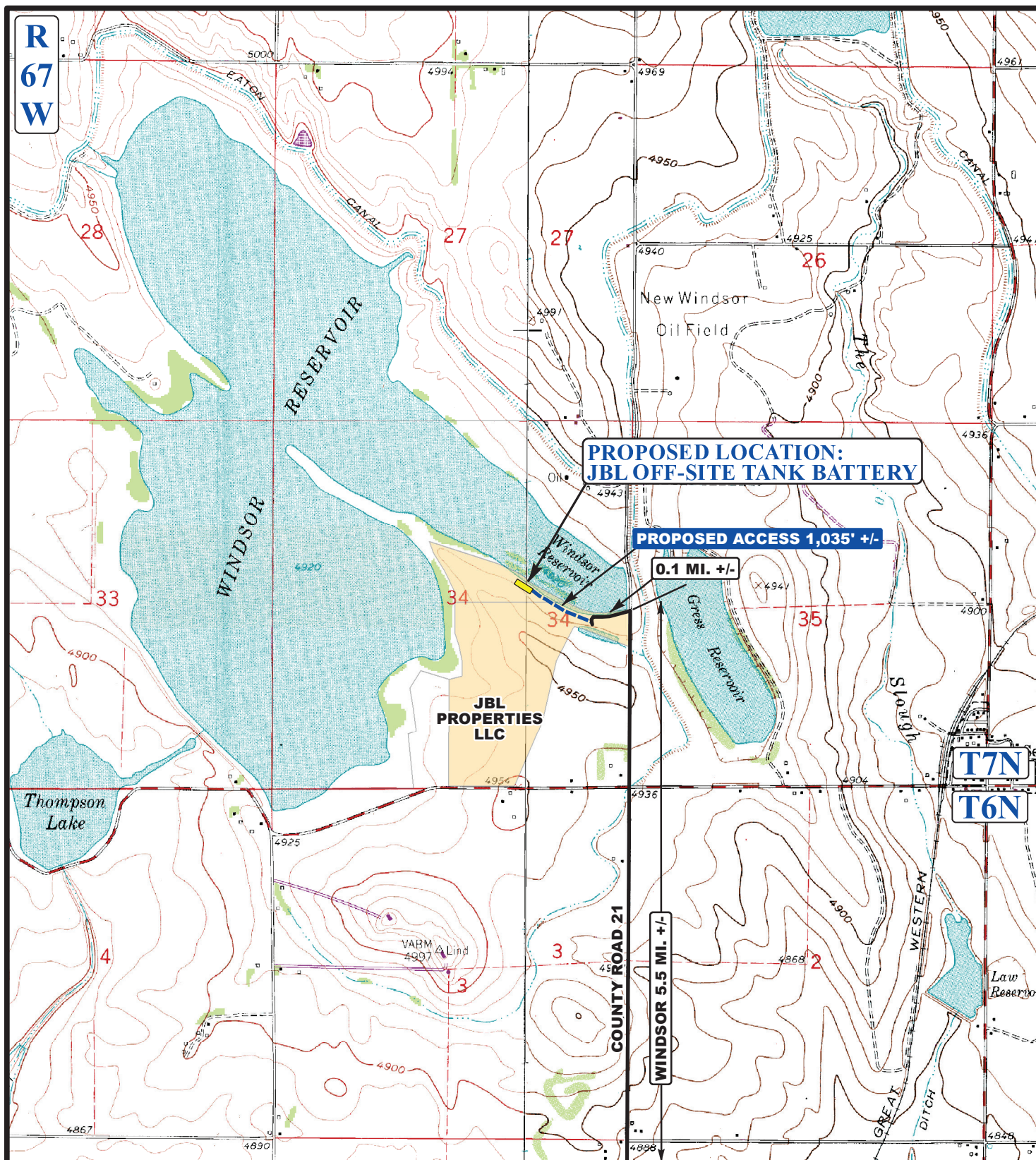

LEGEND:

EXISTING ROADS
 PROPOSED ACCESS ROAD

GREAT WESTERN OIL & GAS COMPANY

JBL OFF-SITE TANK BATTERY
SECTION 34, T7N, R67W, 6th P.M.
2404' FNL 1567' FEL



Uintah Engineering & Land Surveying
 85 South 200 East Vernal, Utah 84078
 (435) 789-1017 * FAX (435) 789-1813



ACCESS ROAD
MAP

08 **31** **12**
 MONTH DAY YEAR

SCALE: 1"=2000' DRAWN BY: J.L.H. REV: 02-13-14 J.L.G.

