

Surface:
CSF 44B-09-07-91
 1456' FSL
 2515 FWL
 Gnd El= 6807
 Pad El= 6807
NAD83
 Lat: 39.458558595°N
 Long: 107.558838650°W
NAD27
 Lat: 39.458577915°N
 Long: 107.558227674°W
 UTM 13 NORTH
NAD 1983
 NORTHING
 14339835.793
 EASTING
 918137.137

Bottom Hole:
CSF 44B-09-07-91
 856' FSL
 708' FEL
NAD83
 Lat: 39.456914494°N
 Long: 107.551467223°W
NAD27
 Lat: 39.456933801°N
 Long: 107.550856500°W

Notes:

1. LATITUDE AND LONGITUDE COORDINATES ARE DIFFERENTIALLY CORRECTED AND BASED ON PUBLISHED NGS CONTROL STATION "WDP-5". SYSTEM: UTM ZONE: 13 NORTH DATUM: NAD 1983 (CONUS)
2. ELEVATIONS ARE BASED ON NAVD OF 1929.
3. ALL BOTTOM AND TOP HOLE LOCATIONS ARE MEASURED 90 DEGREES FROM SECTION LINE.
4. USGS QUADRANGLE MAP "GIBSON GULCH".
5. CURRENT SURFACE LAND USE: WELL PAD.
6. PDOP AT THE TIME OF LOCATION OF SURFACE WELL = 1.8

Legend

- ◈ - Field Surveyed Section Corner
- ◈ - Field Surveyed Quarter Corner
- ⊙ - Calculated Section Corner Location
- ⊕ - Field Surveyed 1/16 Corner

SURVEYOR'S CERTIFICATE

I, SCOTT E. AIBNER, A REGISTERED LAND SURVEYOR, LICENSED UNDER THE LAWS OF THE STATE OF COLORADO, DO HEREBY CERTIFY THAT THE SURVEY SHOWN HEREON WAS PREPARED BY RIVER VALLEY SURVEY, INC. FOR Ursa OPERATING COMPANY, LLC, BY ME OR UNDER MY DIRECT SUPERVISION, AND THAT THIS PLAT IS A TRUE REPRESENTATION THEREOF.

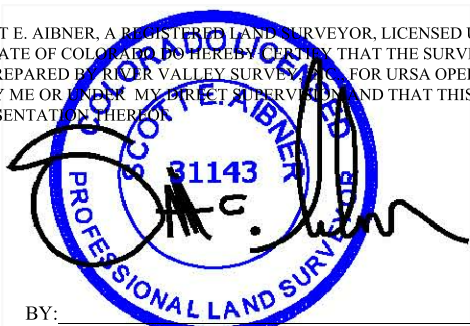

BY:
 SCOTT E. AIBNER, COLORADO REG. NO. 31143

Prepared For: Ursa Operating Company LLC
Proposed Castle Springs Federal 44B-09-07-91 Well
Situate in The SE 1/4 Section 9, Township 6 South, Range 91 West of the 6 th. Principal Meridian, County of Garfield, State of Colorado.



River Valley Survey, Inc.
 110 East 3rd. Street, Suite 213
 Rifle, Colorado 81650
 Ph: 970-379-7846

Project: RVS 06001-41E

Field Date: 11-05-10

Date: 01-07-14

Scale: 1"= 1000'

Sheet: 1 of 1

303.a Form 2
Castle Springs Federal E Pad
Well CSF 44B-09-07-91

Section 9, Township 7 South, Range 91 West