

PROPOSED LOCATION:
ANSCHUTZ STATE 5-61-19_20 SWSW PAD
#5-61-19-6457CH2, #5-61-19-6457BH2,
#5-61-19-4956CH2 & #5-61-19-4956BH2

SEE TOPO "B"

LEGEND:

 **PROPOSED LOCATION**

BILL BARRETT CORPORATION

ANSCHUTZ STATE 5-61-19_20 SWSW PAD #5-61-19-6457CH2,
#5-61-19-6457BH2, #5-61-19-4956CH2 & #5-61-19-4956BH2
SECTION 19, T5N, R61W, 6th P.M.
LOT 4



Utah Engineering & Land Surveying
 85 South 200 East Vernal, Utah 84078
 (435) 789-1017 * FAX (435) 789-1813



ACCESS ROAD
MAP

01 **27** **14**
 MONTH DAY YEAR

SCALE: 1:100,000 DRAWN BY: J.L.G. REVISED: 00-00-00



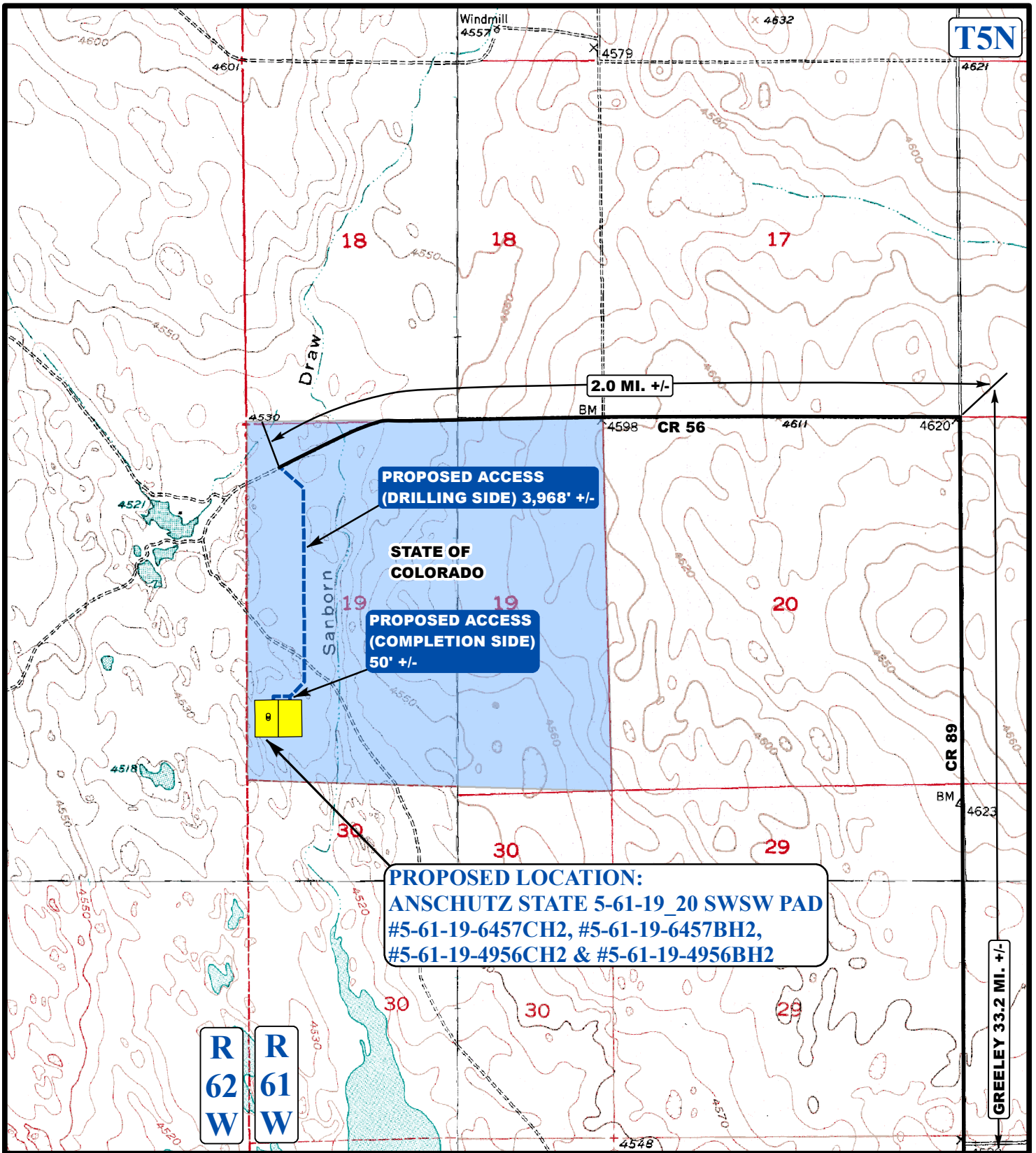

T5N

**PROPOSED ACCESS
(DRILLING SIDE) 3,968' +/-**

**STATE OF
COLORADO**
**PROPOSED ACCESS
(COMPLETION SIDE)
50' +/-**

**PROPOSED LOCATION:
ANSCHUTZ STATE 5-61-19_20 SWSW PAD
#5-61-19-6457CH2, #5-61-19-6457BH2,
#5-61-19-4956CH2 & #5-61-19-4956BH2**

**R
62
W** **R
61
W**

GREELEY 33.2 MI. +/-

LEGEND:

- EXISTING ROADS
- PROPOSED ACCESS ROAD

BILL BARRETT CORPORATION

**ANSCHUTZ STATE 5-61-19_20 SWSW PAD #5-61-19-6457CH2,
#5-61-19-6457BH2, #5-61-19-4956CH2 & #5-61-19-4956BH2
SECTION 19, T5N, R61W, 6th P.M.
LOT 4**

U&L S **Utah Engineering & Land Surveying**
85 South 200 East Vernal, Utah 84078
(435) 789-1017 * FAX (435) 789-1813



**ACCESS ROAD
MAP** **01** **27** **14**
MONTH DAY YEAR

SCALE: 1"=2000' DRAWN BY: J.L.G. REVISED: 00-00-00



BILL BARRETT CORPORATION

ANSCHUTZ STATE 5-61-19_20 SWSW PAD #5-61-19-6457CH2,
#5-61-19-6457BH2, #5-61-19-4956CH2 & #5-61-19-4956BH2
SECTION 19, T5N, R61W, 6th P.M.

PROCEED IN AN EASTERLY, THEN SOUTHEASTERLY DIRECTION FROM GREELEY, COLORADO ALONG HIGHWAY 34 APPROXIMATELY 25.4 MILES TO THE JUNCTION OF THIS ROAD AND COUNTY ROAD 87 TO THE NORTH; TURN LEFT AND PROCEED IN A NORTHERLY, THEN EASTERLY DIRECTION APPROXIMATELY 3.4 MILES TO THE JUNCTION OF THIS ROAD AND COUNTY ROAD 89 TO THE NORTH; TURN LEFT AND PROCEED IN A NORTHERLY DIRECTION APPROXIMATELY 4.4 MILES TO JUNCTION OF THIS ROAD AND AN EXISTING ROAD TO THE WEST; TURN LEFT AND PROCEED IN A WESTERLY, THEN SOUTHWESTERLY DIRECTION APPROXIMATELY 2.0 MILES TO THE BEGINNING OF THE PROPOSED ACCESS TO THE SOUTHEAST; FOLLOW ROAD FLAGS IN A SOUTHEASTERLY, THEN SOUTHERLY, THEN SOUTHWESTERLY DIRECTION APPROXIMATELY 3,968' TO THE PROPOSED LOCATION.

TOTAL DISTANCE FROM GREELEY, COLORADO TO THE PROPOSED LOCATION IS APPROXIMATELY 36.0 MILES.