

HIRSCH 24-G PAD PRODUCTION FACILITY LAYOUT

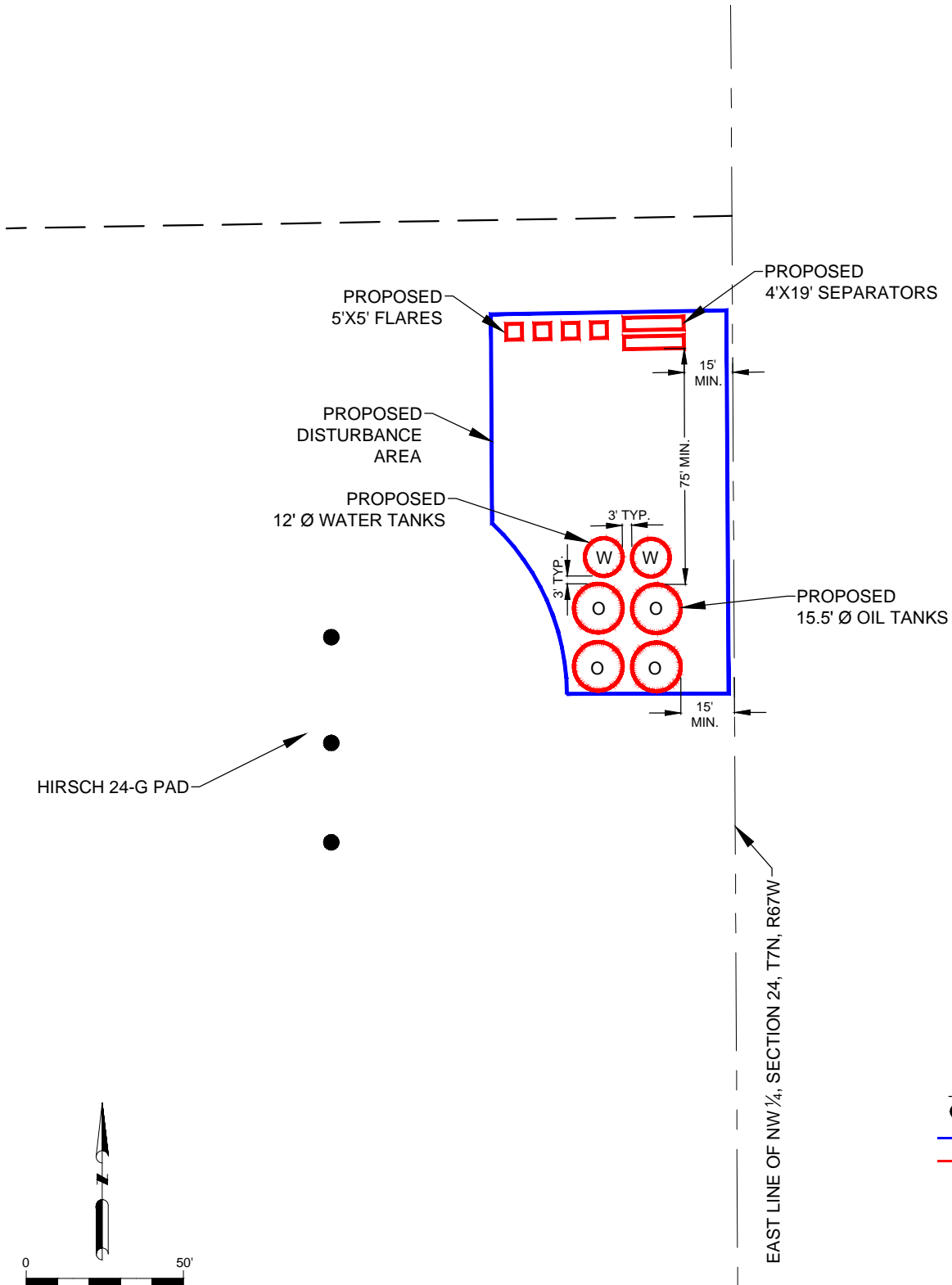

LEGEND

- = PROPOSED WELL
- = PROPOSED DA
- = PROPOSED FACILITIES

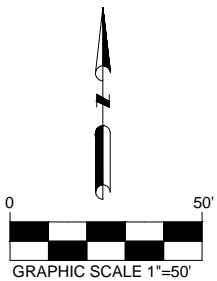

PREPARED BY:



FIELD DATE:

05-23-13

DRAWING DATE:

02-17-14

BY:

KAD

CHECKED BY:

MLP

SITE NAME:

HIRSCH 24-G PAD

SURFACE LOCATION:

SE 1/4, NW 1/4, SEC. 24, T7N, R67W, 6TH P.M.
WELD COUNTY, COLORADO

PREPARED FOR:

BAYSWATER
EXPLORATION &
PRODUCTION, LLC