

FORM 19
Rev 6/99

**State of Colorado
Oil and Gas Conservation Commission**

1120 Lincoln Street, Suite 801, Denver, Colorado 80203 Phone: (303)894-2100 Fax:(303)894-2109



FOR OGCC USE ONLY

RECEIVED
1/10/2014

SPILL/RELEASE REPORT

This form is to be submitted by the party responsible for the oil and gas spill or release. Any spill or release which may impact waters of the State must be reported as soon as practicable; any spill over 20 bbls must be reported within 24 hours and all spills over five bbls must be reported within ten days. Submit a Site Investigation and Remediation Workplan (Form 27) when requested by the Director.

Spill report taken by:

FACILITY ID:

OPERATOR INFORMATION

Name of Operator: <u>WPX Energy Rocky Mountain, LLC</u>	OGCC Operator No: <u>96850</u>	Phone Numbers
Address: <u>1058 County RD 215</u>		No: <u>970-683-2295</u>
City: <u>Parachute</u> State: <u>CO</u> Zip: <u>81625</u>		Fax: <u>970-285-5973</u>
Contact Person: <u>Karolina Blaney</u>		Email: Karolina.Blaney@wpxenergy.com

DESCRIPTION OF SPILL OR RELEASE

Date of Incident: <u>01/03/2014</u> Facility Name & No: <u>HM 32-33 (COGCC Fac ID 324290)</u>	County: <u>Garfield</u>
Type of Facility (well, tank battery, flow line, pit): <u>Well pad</u>	QtrQtr: <u>NW/NE</u> Section: <u>33</u>
Well Name and Number: <u>HM 32-33</u>	Township: <u>5S</u> Range: <u>93W</u>
API Number: <u>05-045-10518</u>	Meridian: <u>6th</u>
Specify volume spilled and recovered (in bbls) for the following materials:	
Oil spilled: _____ Oil recov'd: _____	Water spilled: <u>1.5 bbls</u> Water recov'd: <u>1 bbl</u> Other spilled: _____ Other recov'd: _____
Ground Water impacted? <input type="checkbox"/> Yes <input checked="" type="checkbox"/> No	Surface Water impacted? <input type="checkbox"/> Yes <input checked="" type="checkbox"/> No
Contained within berm? <input type="checkbox"/> Yes <input checked="" type="checkbox"/> No	Area and vertical extent of spill: <u>2498 square feet, depth TBD</u>
Current land use: <u>Open Rangeland</u>	Weather conditions: <u>Clear, Cold, Frozen ground conditions</u>
Soil/geology description: <u>Arvada loam - loam to silty clay loam</u>	
IF LESS THAN A MILE , report distance IN FEET to nearest ... Surface water: <u>~578 feet</u> wetlands: <u>none</u> buildings: <u>none</u>	
Livestock: <u>none</u> Water wells: <u>~1014 feet</u> Depth to shallowest ground water: <u>>90 feet</u>	
Cause of spill (e.g. equipment failure, human error, etc.): <u>Equipment failure</u> Detailed description of the spill/release incident:	
A valve on the separator froze, cracking the valve. This allowed produced water and condensate to spray out onto the well pad in the immediate vicinity of the separator unit.	

CORRECTIVE ACTION

Describe immediate response (how stopped, contained and recovered): Production personnel on site shut the well in thus preventing any additional fluid loss from the compromised valve. The entire release was contained on the well pad. No fluids migrated off site. A vac truck was dispatched to the location to vacuum off the impacted snow and free liquid.
Describe any emergency pits constructed: None
How was the extent of contamination determined? By field measurements and mapping with a Trimble GPS unit.
Further remediation activities proposed (attach separate sheet if needed): As noted above, all free liquids and impacted snow were removed utilizing a vac truck. The impacted area was treated with a bioremediation product. The impacted area will be sampled in the spring of 2014 to assess any residual hydrocarbon impact. Remedial options, if warranted, will be evaluated at that time.
Describe measures taken to prevent problem from reoccurring: The compromised valve will be replaced with a more durable valve that is resistant to breaking/cracking in freezing conditions.

OTHER NOTIFICATIONS

List the parties and agencies notified (County, BLM, EPA, DOT, Local Emergency Planning Coordinator or other).

Date	Agency	Contact	Phone	Response
01/03/2014	COGCC	Alex Fischer	303-894-2100	Verbal Notification 17:00 hrs
01/03/2014	Surface Owner	Withheld to protect privacy of surface owner		Verbal
01/03/2014	County	Kirby Wynn	970-625-5905	Email
01/03/2014	Fire Department	Chad Harris	970-625-1243	Email

Spill/Release Tracking No: 2147648





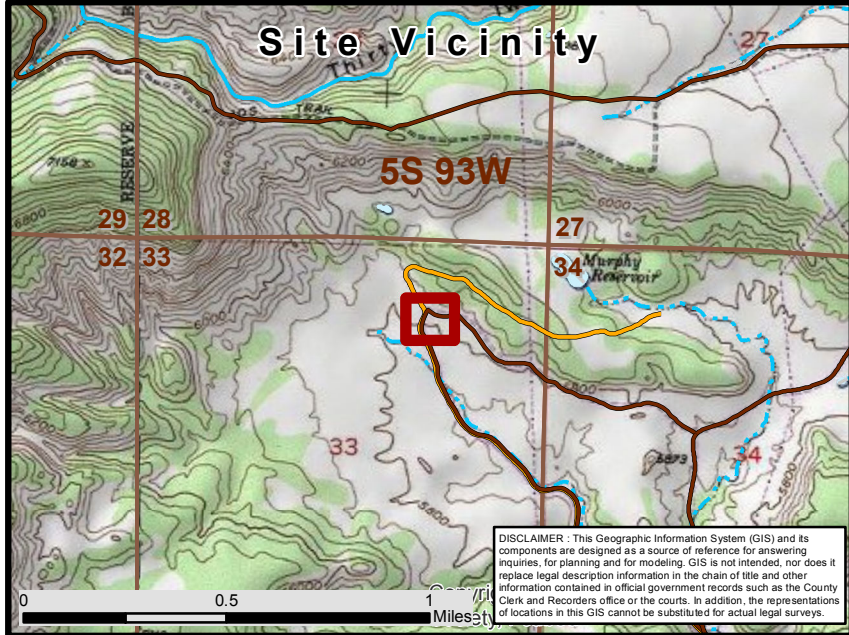



Source: Esri, DigitalGlobe, GeoEye, i-cubed, USDA, USGS, AEX, Getmapping, Aerogrid, IGN, IGP, swisstopo, and the GIS User Community



DISCLAIMER: This Geographic Information System (GIS) and its components are designed as a source of reference for answering inquiries, for planning and for modeling. GIS is not intended, nor does it replace legal description information in the chain of title and other information contained in official government records such as the County Clerk and Records office or the courts. In addition, the representations of locations in this GIS cannot be substituted for actual legal surveys.

Form 19 Map
Location: HM 32-33
39.575277 -107.831612
WPX Energy

-  Impacted Area
-  Public Roads
-  Access Roads
- PLSS**
-  Township
-  Section
- Hydrographic Features**
-  Perennial Stream
-  Intermittent Stream

