

# VAL ENERGY, INC.

## CHRISTINA #1-2

LOCATED IN CROWLEY COUNTY, COLORADO  
SECTION 2, T20S, R56W, 6th P.M.

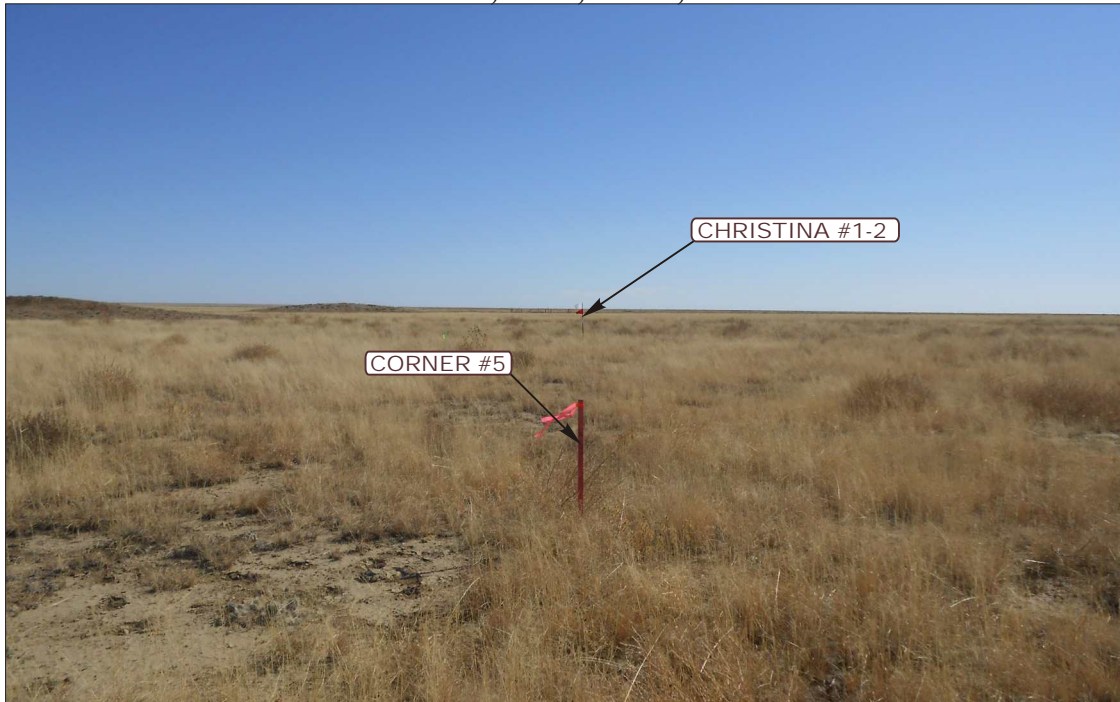

PHOTO: VIEW FROM CORNER #5 TO LOCATION STAKE

CAMERA ANGLE: SOUTHEASTERLY



PHOTO: VIEW FROM BEGINNING OF PROPOSED ACCESS

CAMERA ANGLE: SOUTHERLY



- Since 1964 -

U  
E  
S

Uintah Engineering & Land Surveying

85 South 200 East Vernal, Utah 84078  
(435) 789-1017 \* FAX (435) 789-1813

LOCATION PHOTOS

10 31 13  
MONTH DAY YEAR

TAKEN BY: D.N..

DRAWN BY: J.C.

REVISED: 00-00-00.

PHOTO  
P1

# VAL ENERGY, INC.

## CHRISTINA #1-2

LOCATED IN CROWLEY COUNTY, COLORADO  
SECTION 2, T20S, R56W, 6th P.M.



PHOTO: VIEW OF LOCATION STAKE

CAMERA ANGLE: NORTHERLY



PHOTO: VIEW OF LOCATION STAKE

CAMERA ANGLE: EASTERLY



- Since 1964 -

**UELS**

Uintah Engineering & Land Surveying

85 South 200 East Vernal, Utah 84078  
(435) 789-1017 \* FAX (435) 789-1813

**LOCATION PHOTOS**

**10** **31** **13**  
MONTH DAY YEAR

TAKEN BY: D.N.

DRAWN BY: J.C.

REVISED: 00-00-00

**PHOTO**  
**P2**



# VAL ENERGY, INC.

## CHRISTINA #1-2

LOCATED IN CROWLEY COUNTY, COLORADO  
SECTION 2, T20S, R56W, 6th P.M.



PHOTO: VIEW OF LOCATION STAKE

CAMERA ANGLE: SOUTHERLY



PHOTO: VIEW OF LOCATION STAKE

CAMERA ANGLE: WESTERLY



- Since 1964 -



Uintah Engineering & Land Surveying

85 South 200 East Vernal, Utah 84078  
(435) 789-1017 \* FAX (435) 789-1813

LOCATION PHOTOS

10 31 13  
MONTH DAY YEAR

TAKEN BY: D.N.

DRAWN BY: J.C.

REVISED: 00-00-00

PHOTO  
P3