

LEGEND:

● PROPOSED LOCATION



VAL ENERGY, INC.

CHRISTINA #1-2
SECTION 2, T20S, R56W, 6th P.M.
1550' FNL 1010' FEL



Utah Engineering & Land Surveying
85 South 200 East Vernal, Utah 84078
(435) 789-1017 * FAX (435) 789-1813

**ACCESS ROAD
MAP**

10 31 13
MONTH DAY YEAR

SCALE: 1:100,000 DRAWN BY: J.C. REVISED: 00-00-00



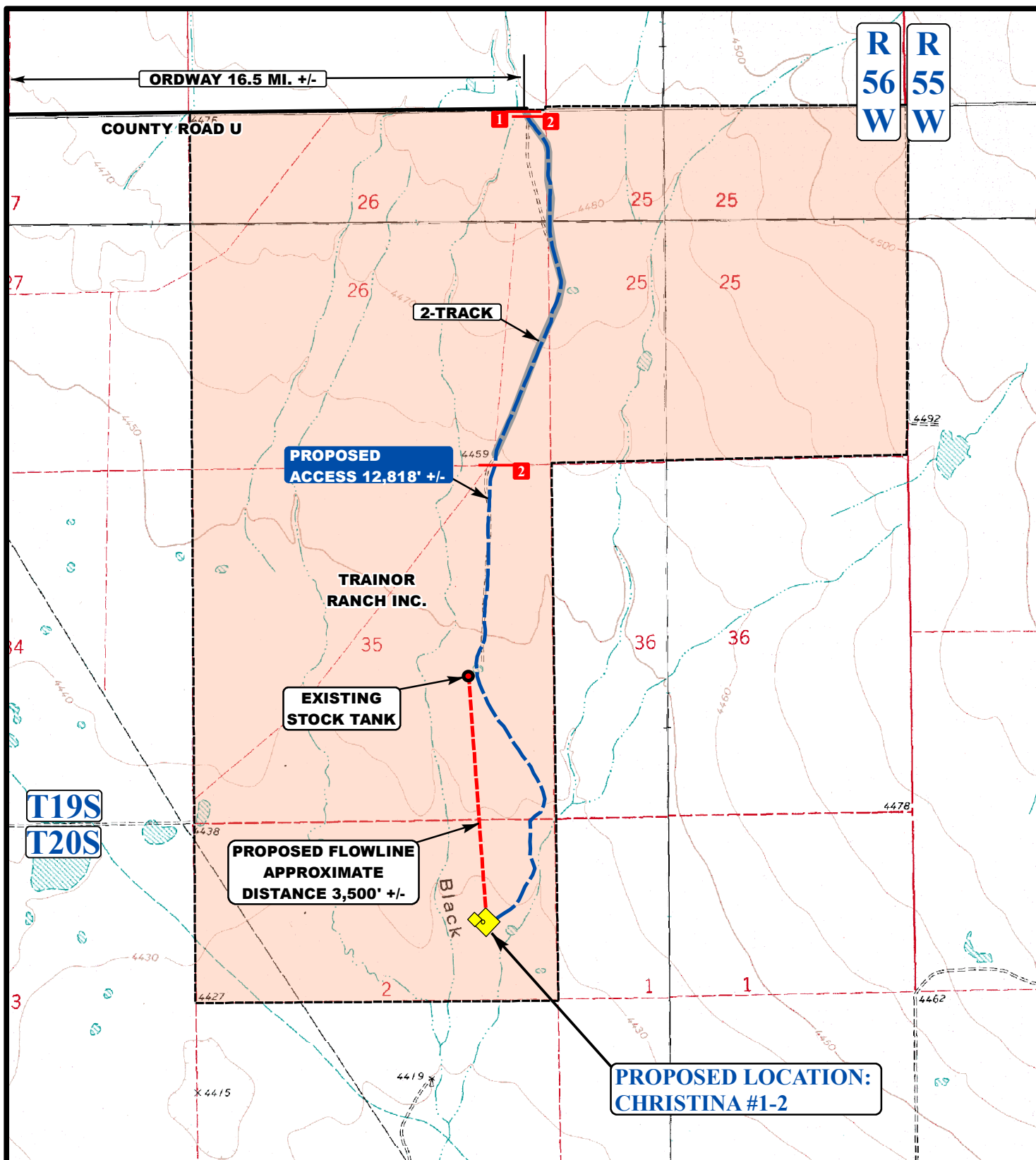

LEGEND:

- EXISTING ROADS
- PROPOSED ACCESS ROAD
- EXISTING 2-TRACK
- 18" CMP REQUIRED
- CATTLE GUARD REQUIRED



VAL ENERGY, INC.

CHRISTINA #1-2
SECTION 2, T20S, R56W, 6th P.M.
1550' FNL 1010' FEL



Utah Engineering & Land Surveying
 85 South 200 East Vernal, Utah 84078
 (435) 789-1017 * FAX (435) 789-1813

ACCESS ROAD
MAP

10 31 13
 MONTH DAY YEAR

SCALE: 1"=2000' DRAWN BY: J.C. REVISED: 11-26-13

