

State of Colorado
Oil and Gas Conservation Commission

1120 Lincoln Street, Suite 801, Denver, Colorado 80203 Phone: (303)894-2100 Fax: (303)894-2109



FOR OGCC USE ONLY

RECEIVED
2/5/2014

SPILL/RELEASE REPORT

This form is to be submitted by the party responsible for the oil and gas spill or release. Any spill or release which may impact waters of the State must be reported as soon as practicable; any spill over 20 bbls must be reported within 24 hours and all spills over five bbls must be reported within ten days. Submit a Site Investigation and Remediation Workplan (Form 27) when requested by the Director.

Spill report taken by:

FACILITY ID:

OPERATOR INFORMATION

Name of Operator: <u>WPX Energy Rocky Mountain, LLC</u>	OGCC Operator No: <u>96850</u>	Phone Numbers
Address: <u>1058 County Road 215</u>		No: <u>970-683-2295</u>
City: <u>Parachute</u>	State: <u>CO</u> Zip: <u>81635</u>	Fax: <u>970-285-9573</u>
Contact Person: <u>Karolina Blaney</u>		Email: <u>Karolina.Blaney@wpxenergy.com</u>

DESCRIPTION OF SPILL OR RELEASE

Date of Incident: <u>01/16/2013</u>	Facility Name & No: <u>Unocal 67S96W1SENE (COGCC # 324062)</u>	County: <u>Garfield</u>
Type of Facility (well, tank battery, flow line, pit): <u>GM 42-1 Tank Battery</u>		QtrQtr: <u>SENE</u> Section: <u>1</u>
Well Name and Number: <u>GM 42-1</u>		Township: <u>7S</u> Range: <u>96W</u>
API Number: <u>05-045-07370</u>		Meridian: <u>6th</u>
Specify volume spilled and recovered (in bbls) for the following materials:		
Oil spilled: _____	Oil recov'd: _____	Water spilled: <u>unknown</u> Water recov'd: <u>0</u> Other spilled: _____ Other recov'd: _____
Ground Water impacted? <input type="checkbox"/> Yes <input checked="" type="checkbox"/> No		Surface Water impacted? <input type="checkbox"/> Yes <input checked="" type="checkbox"/> No
Contained within berm? <input type="checkbox"/> Yes <input checked="" type="checkbox"/> No		Area and vertical extent of spill: <u>current excavation ~165 sq. feet x 3 feet deep</u>
Current land use: <u>Open rangeland</u>		Weather conditions: <u>Clear, cold, frozen ground conditions</u>
Soil/geology description: <u>Arvada loam - loam grading to a silty clay loam with depth</u>		
IF LESS THAN A MILE , report distance IN FEET to nearest ... Surface water: <u>~684 feet</u> wetlands: <u>None</u> buildings: <u>~275 feet</u>		
Livestock: <u>None</u> Water wells: <u>~3,618 feet</u> Depth to shallowest ground water: <u>50 feet</u>		
Cause of spill (e.g. equipment failure, human error, etc.): <u>Historical Release</u>		Detailed description of the spill/release incident:
During remediation of a non E&P release, discolored soil was encountered in the dump line trench and above ground produced water tank indicating a potential historical release. The cause of the release is currently under investigation.		

CORRECTIVE ACTION

Describe immediate response (how stopped, contained and recovered): As an active remediation was already in progress, production personnel had already halted the flow of water to the production tank. Initial investigation of the release indicated that the area of impact is located within the confines of the earthen containment structure and along the dump line trench. Initial pot holing around the containment structure and dump line trench confirmed the released fluids have not migrated off the facility. No surface water or groundwater was impacted by either release.

Describe any emergency pits constructed: None were constructed.

How was the extent of contamination determined? By field measurements and mapping with a Trimble GPS unit.

Further remediation activities proposed (attach separate sheet if needed): The dump line trench has been excavated to a depth of approximately 3 feet. At 3 feet, stained soil was encountered indicating the possibility of a historical release as noted above. The above ground produced water tank will be removed from the earthen containment structure. The suspected area of the historical release, including the dump line trench, will be excavated to a depth which complies with COGCC Table 910-1 standards. When the black stained soil has been removed, confirmation soil samples will be collected from the walls and from the bottom of the excavation to ensure compliance with COGCC Table 910-1. If the excavated area complies with COGCC Table 910-1 the excavation will be backfilled with clean material to the original pad grade. The impacted soil will be treated on-site with bio remediation product. As noted above no surface water or groundwater has been impacted by the release.

Describe measures taken to prevent problem from reoccurring: As the exact cause of the release has not been accurately determined to date. Further excavation of the impacted area will aid determining a cause. After the cause is determined appropriate corrective actions can then be implemented.

OTHER NOTIFICATIONS

List the parties and agencies notified (County, BLM, EPA, DOT, Local Emergency Planning Coordinator or other).

Date	Agency	Contact	Phone	Response
01/17/2014	COGCC	Alex Fischer	970-894-2100	Verbal Notification of the Release
01/17/2014	Landowner	WPX is the surface owner		
01/17/2014	Town/City Officials	Stuart McArthur	970-285-7630	Email
01/17/2014	Water Intake	Mark King	970-285-7630	Email
01/17/2014	County	Kirby Wynn	970-625-5905	Email
01/17/2014	County	Morgan Hill	970-625-5200	Email
01/17/2014	Town/City Officials	Steve Rippey	970-285-9050	Email
01/17/2014	Town/City Officials	Roger Bulla	970-285-7000	Email
01/17/2014	Fire Department	David Blair	970-285-9119	Email

Spill/Release Tracking No: 2147616

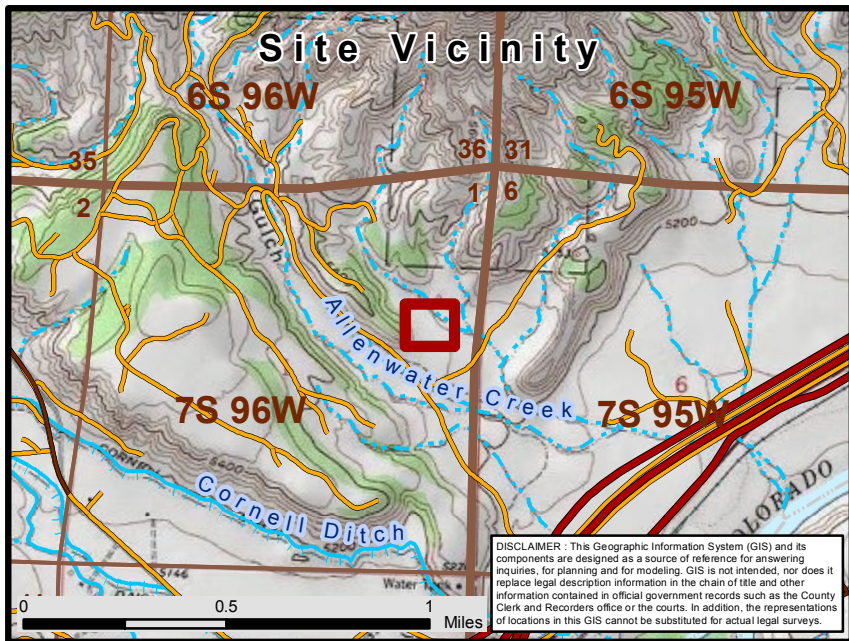

Form 19 Map
Location: GM 42-1
 39.468578 -108.051459
 WPX Energy

- | | |
|---------------|--------------------------------|
| Impacted Area | Transportation Features |
| PLSS | Public Roads |
| Township | Access Roads |
| Section | Hydrographic Features |
| | Perennial Stream |
| | Intermittent Stream |

