

State of Colorado
Oil and Gas Conservation Commission

1120 Lincoln Street, Suite 801, Denver, Colorado 80203 Phone: (303)894-2100 Fax:(303)894-2109



FOR OGCC USE ONLY

RECEIVED 2/3/2014

SPILL/RELEASE REPORT

This form is to be submitted by the party responsible for the oil and gas spill or release. Any spill or release which may impact waters of the State must be reported as soon as practicable; any spill over 20 bbls must be reported within 24 hours and all spills over five bbls must be reported within ten days. Submit a Site Investigation and Remediation Workplan (Form 27) when requested by the Director.

Spill report taken by:

FACILITY ID:

OPERATOR INFORMATION

Name of Operator: <u>WPX Energy Rocky Mountain, LLC</u>	OGCC Operator No: <u>96850</u>	Phone Numbers
Address: <u>1058 County Road 215</u>		No: <u>970-683-2295</u>
City: <u>Parachute</u>	State: <u>CO</u> Zip: <u>81635</u>	Fax: <u>970-285-9573</u>
Contact Person: <u>Karolina Blaney</u>	Email: Karolina.Blaney@wpxenergy.com	

DESCRIPTION OF SPILL OR RELEASE

Date of Incident: <u>01/28/2014</u>	Facility Name & No: <u>GM66S96W27SENE (COGCC # 335430)</u>	County: <u>Garfield</u>
Type of Facility (well, tank battery, flow line, pit): <u>GM 42-27 Tank Battery</u>	QtrQtr: <u>SENE</u>	Section: <u>27</u>
Well Name and Number: <u>GM 42-27</u>	Township: <u>6S</u>	Range: <u>96W</u>
API Number: <u>05-045-07593</u>	Meridian: <u>6th</u>	
Specify volume spilled and recovered (in bbls) for the following materials:		
Oil spilled: _____	Oil recov'd: _____	Water spilled: <u>~ 15 bbls</u>
		Water recov'd: <u>~15 bbls</u>
		Other spilled: _____
		Other recov'd: _____
Ground Water impacted? <input type="checkbox"/> Yes <input checked="" type="checkbox"/> No	Surface Water impacted? <input type="checkbox"/> Yes <input checked="" type="checkbox"/> No	
Contained within berm? <input checked="" type="checkbox"/> Yes <input type="checkbox"/> No	Area and vertical extent of spill: <u>~2,876 sq. feet x <1 inch deep</u>	
Current land use: <u>Open Rangeland</u>		Weather conditions: <u>Clear, cold, semi frozen ground conditions</u>
Soil/geology description: <u>Badland - Unweathered bedrock</u>		
IF LESS THAN A MILE, report distance IN FEET to nearest ... Surface water: <u>~170 feet</u>		
wetlands: <u>None</u> buildings: <u>None</u>		
Livestock: <u>None</u> Water wells: <u>None</u> Depth to shallowest ground water: <u>> 40 feet</u>		
Cause of spill (e.g. equipment failure, human error, etc.): <u>Equipment Failure</u>		
Detailed description of the spill/release incident: <u>A valve froze and cracked on a produced water tank unloading line. This allowed produced water to flow out of the compromised valve and out into the impervious plastic lined SPCC containment structure.</u>		

CORRECTIVE ACTION

Describe immediate response (how stopped, contained and recovered): <u>When the release was discovered, production personnel halted the flow of water to the tank with the compromised valve. Vac trucks were dispatched to the location to pull the tank and vacuum off the free standing liquids in the lined SPCC containment structure. The entire release was contained within the lined SPCC containment structure. No fluids migrated out of the containment or off the facility.</u>
Describe any emergency pits constructed: <u>None were constructed.</u>
How was the extent of contamination determined? <u>By field measurements and mapping with a Trimble GPS unit.</u>
Further remediation activities proposed (attach separate sheet if needed): <u>None are currently planned. The lined SPCC containment structure performed as it was designed and captured all of the fluids from the release allowing for 100 percent recovery.</u>
Describe measures taken to prevent problem from reoccurring: <u>No procedural changes are planned as the frozen valve was the result of a very long period of prolonged cold weather conditions. The compromised valve was replaced with a new heavier duty valve which is lees susceptible to freezing during prolonged cold conditions</u>

OTHER NOTIFICATIONS





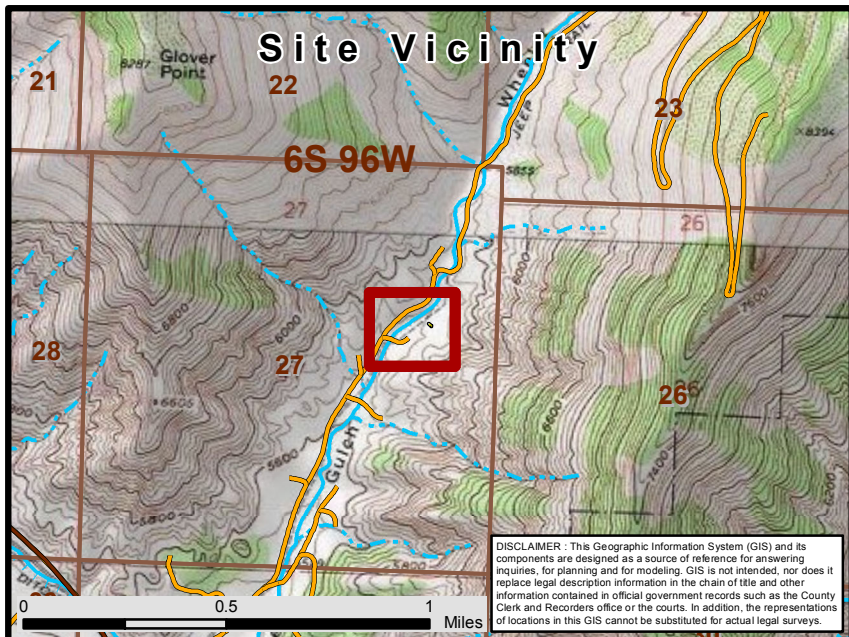

List the parties and agencies notified (County, BLM, EPA, DOT, Local Emergency Planning Coordinator or other).

Date	Agency	Contact	Phone	Response
01/28/2014	COGCC	Alex Fischer	970-894-2100	Verbal Notification of the Release
01/28/2014	County	Kirby Wynn	970-285-9119	Email
01/28/2014	Fire Department	David Blair	970-625-1243	Email

Spill/Release Tracking No: 2147610



Form 19 Map
Location: GM 42-27
 39.496688 -108.088295
 WPX Energy

- | | | |
|--|---------------|---|
|  | Impacted Area | Transportation Features |
| | |  Public Roads |
| | |  Access Roads |
| PLSS | | Hydrographic Features |
|  | Township |  Perennial Stream |
|  | Section |  Intermittent Stream |

