

REYNOLDS CATTLE 31C-23HZ MULTI-WELL PLAN

SECTION 23, TOWNSHIP 3 NORTH, RANGE 68 WEST, 6TH P.M.

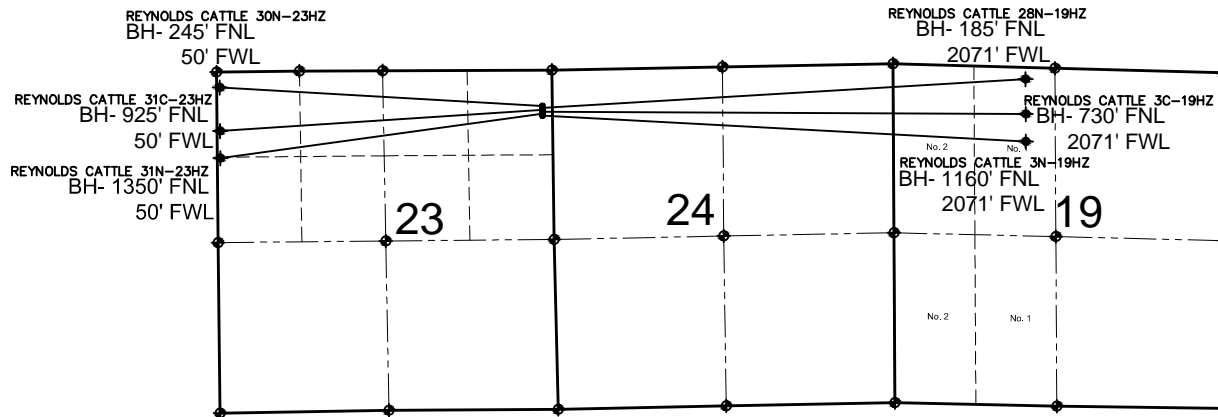

NOTES:

REYNOLDS CATTLE 30N-23HZ TO BE AT 560' FNL, 155' FEL.
 BOTTOM HOLE AT 245' FNL & 50' FWL.
 REYNOLDS CATTLE 28N-19HZ TO BE AT 590' FNL, 155' FEL.
 BOTTOM HOLE AT 185' FNL & 2071' FWL.
 REYNOLDS CATTLE 31C-23HZ TO BE AT 620' FNL, 155' FEL.
 BOTTOM HOLE AT 925' FNL & 50' FWL.
 REYNOLDS CATTLE 3C-19HZ TO BE AT 650' FNL, 155' FEL.
 BOTTOM HOLE AT 730' FNL & 2071' FWL.
 REYNOLDS CATTLE 31N-23HZ TO BE AT 680' FNL, 155' FEL.
 BOTTOM HOLE AT 1350' FNL & 50' FWL.
 REYNOLDS CATTLE 3N-19HZ TO BE AT 710' FNL, 155' FEL.
 BOTTOM HOLE AT 1160' FNL & 2071' FWL.

LEGEND

= EXISTING MONUMENT
 = PROPOSED WELL
 = BOTTOM HOLE
 BH= BOTTOM HOLE
 = EXISTING WELL

PREPARED BY:

PFS

Petroleum Field Services, LLC
 7535 Hilltop Circle
 Denver, CO 80221

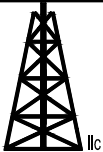

KERR-MCGEE OIL & GAS ONSHORE LP

FIELD DATE:
09-23-13

DRAWING DATE:
11-04-13

SURFACE LOCATION:

NE 1/4 NE 1/4, SEC. 23, T3N, R68W, 6TH P.M.
 WELD COUNTY, COLORADO

